

Engine Stand Assembly Instructions

555-80042

2000 lb. Capacity



JEGS.com

1-800-345-4545

Parts List

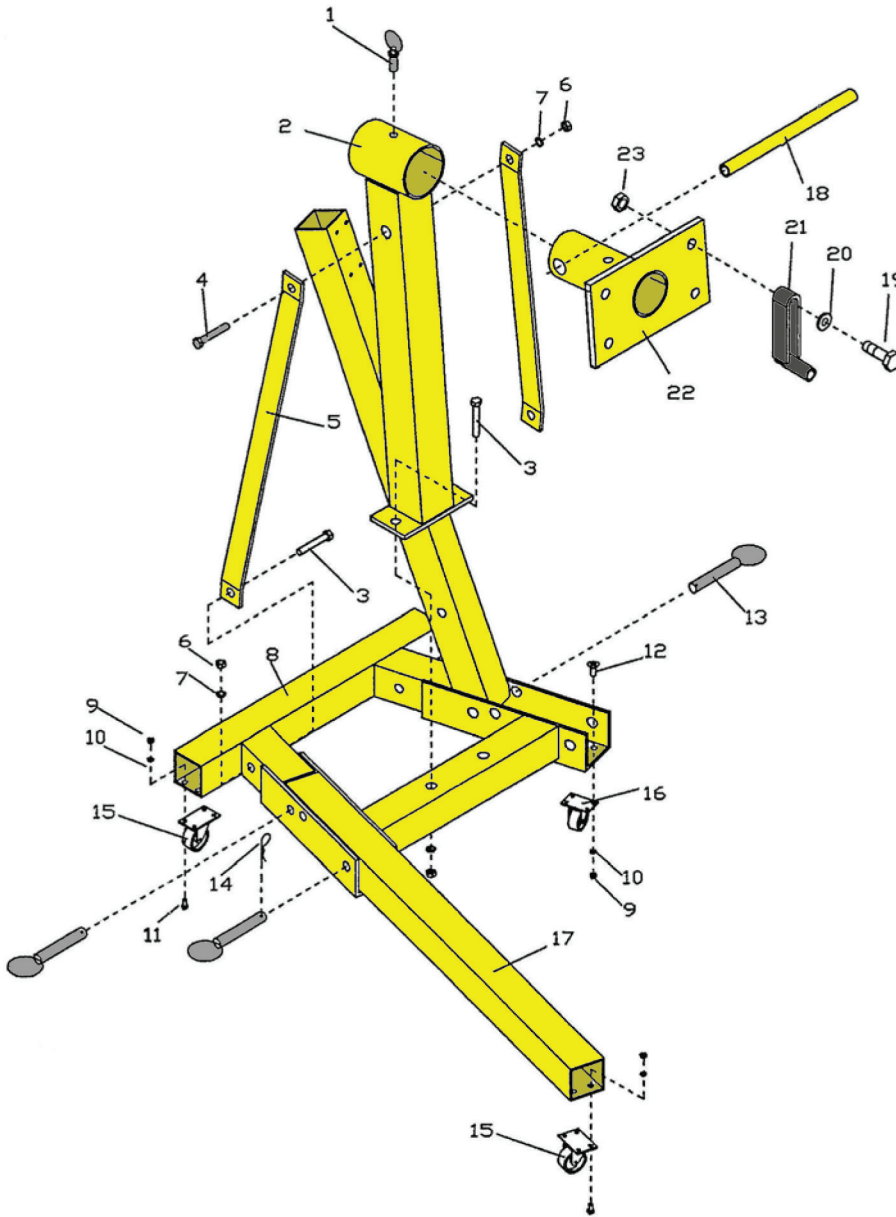

PART#	DESCRIPTION	QTY
1	Pin	1
2	Vertical Column	1
3	Bolt (M14x90)	4
4	Bolt (M14x100)	1
5	Support	2
6	Nut (M14)	5
7	Washer (M14)	5
8	Base Frame	1
9	Nut (M8)	24
10	Spring Washer (M8)	24
11	Bolt (M8x16)	16
12	Bolt (M8x18)	8
13	Lock Pin	4
14	"R" Pin	4
15	Caster (3 1/2 in.)	4
16	Caster (3 in.)	2
17	Leg	2
18	Handle	1
19	Bolt (M16x80)	4
20	Washer (M16)	4
21	Shifting Stand	4
22	Turning Plate	1
23	Nut (M16)	4

Assembly

1. Attach two 3 in. swivel casters (16) and four 3 1/2 in. swivel caster (15) to the base frame (8) using bolts (11), washers (10), and nuts (9).
2. Assemble legs (17) to the base frame (8) using the ringed lock pins (13) and "R" pin (14).
3. Attach the vertical column (2) to the base frame's (8) cross-member between the open channels using bolts (3), flat washers (7), and nuts (6).
4. Attach the top of the supports (5) to the vertical column using bolt (4), flat washer (7), and nut (6). Then connect the lower end of the supports to the base frame using bolts (3), flat washers (7), and nuts (6).
5. Insert the turning plate (22) through the tube at the top of the vertical column (2). Rotate the plate until one of the holes in the inner tube is aligned with the hole in the outer tube and insert the pin (1).
6. Insert the handle (18) through the hole at the end of the turning plate (22) that protrudes past the vertical column.
7. Attach the shifting stands (21) to the turning plate (22) using bolts (19), washers (20), and nuts (23).
8. To fold the legs upward, remove the "R" clips from the lock pins closest to the fixed wheels and then remove the pins. Fold the legs up. Always secure the legs in the upright position by reinserting the lock pins through the holes in the frame directly in front of the legs. Secure the lock pins with the "R" clips.

Operation

1. Do not exceed the engine stand's maximum capacity of 2000 lb.
2. Use only on hard level surfaces.
3. Never attempt to move a loaded engine stand across floors that have cracks or other obstacles which may impede movement of the wheels.
4. Never work directly under a supported engine.
5. Be sure that the load and stand are stable.
6. Periodically inspect the stand to ensure its safe operation. Re-tighten hardware as needed.
7. Failure to follow any of these instructions may result in property damage or personal injury.

Warning

ENSURE THAT ALL BOLTS ARE SECURELY TIGHTENED BEFORE OPERATING.