



Installation Instructions

For Airaid Jr. Part Numbers:

250-715 850-427 Airaid Oiled Media Filter
251-715 851-427 SynthaMax Dry Media Filter
And M.I.T. Part Number:

250-915 Airaid Modular Intake Tube only

2010-15 Chevrolet Camaro
3.6L V6

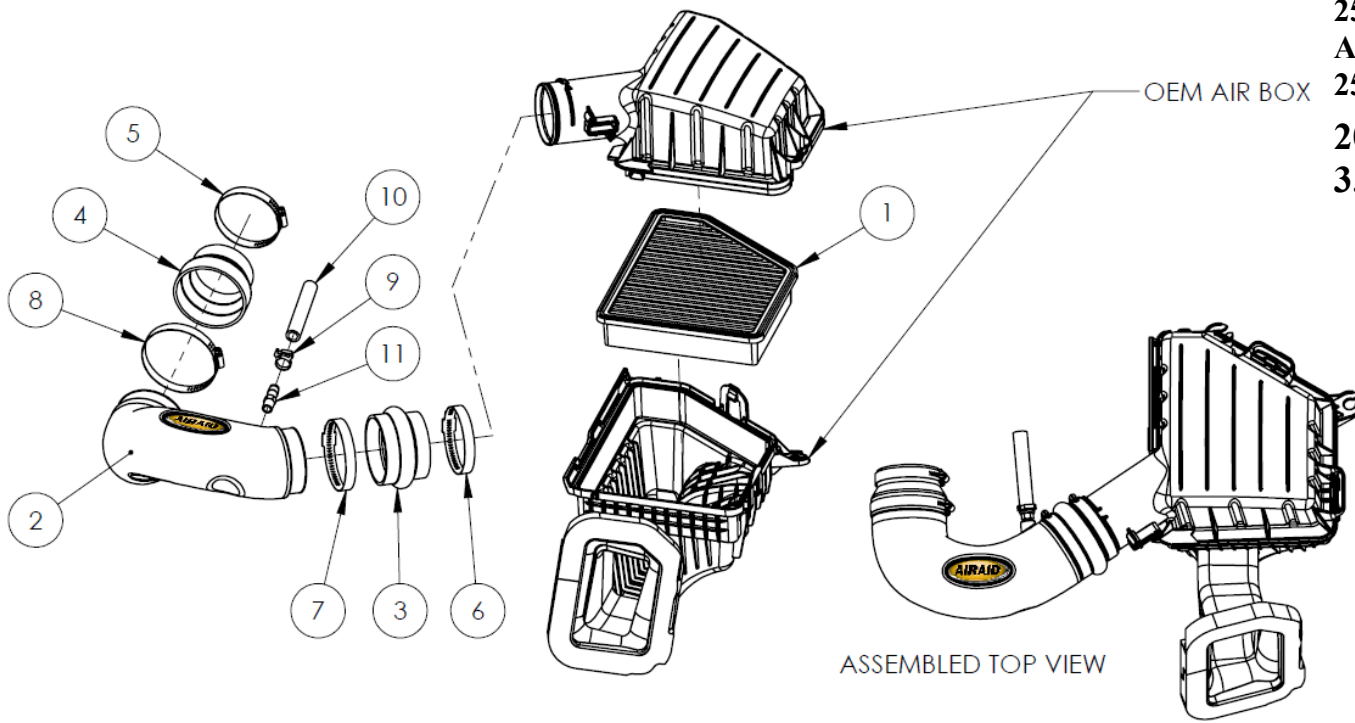

Component Identification

1.	*Airaid Premium Filter	1
2.	Modular Intake Tube	1
3.	Hump Hose	1
4.	Reducing Coupler	1
5.	#48 Hose Clamp	1
6.	#52 Hose Clamp	1
7.	#56 Hose Clamp	1
8.	#60 Hose Clamp	1
9.	Speed Clamp	1
10.	1/2" Breather Hose	1
11.	1/2" Hose Fitting	1
12.	Airaid Decal	1

Full color instructions can be viewed on our web site at Airaid.com.

*Filter included only in Jr. Kits



1. Disconnect the negative battery terminal. Remove the oil cap and lift up on the engine cover to unseat it from the mounting grommet. Replace the oil cap for now to prevent debris from entering the valve cover.

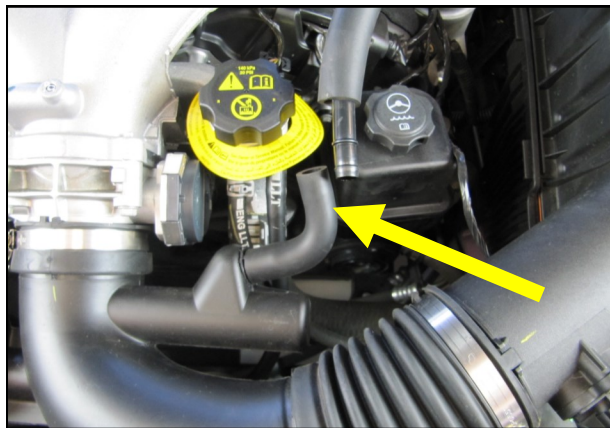

2. Disconnect the crank case breather at the elbow on the factory intake tube.

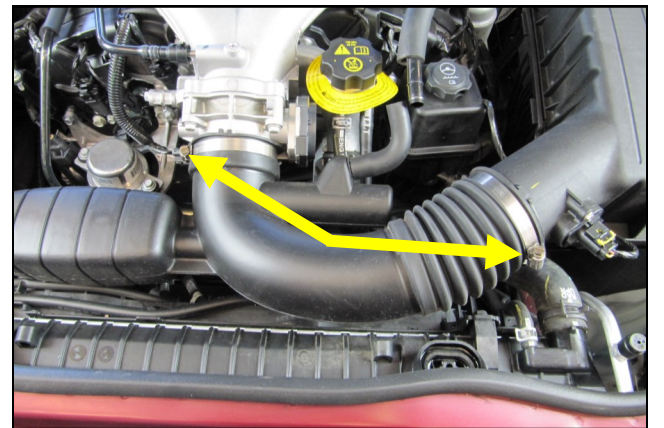

3. Loosen the clamps at both ends of the factory intake tube and remove it.

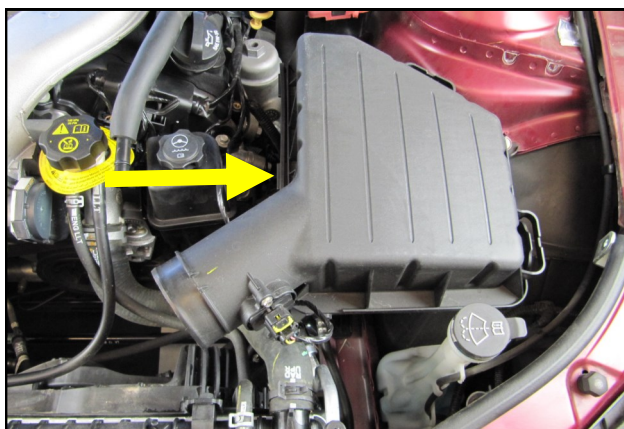

4. If installing an Airaid JR kit, install the Airaid Premium filter into the factory air box at this time.

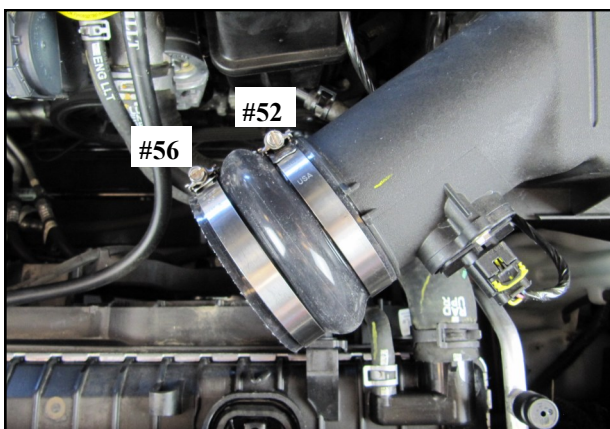

5. Install the Hump Hose and Clamps onto the throttle body as shown. Do not tighten the Clamps at this time.

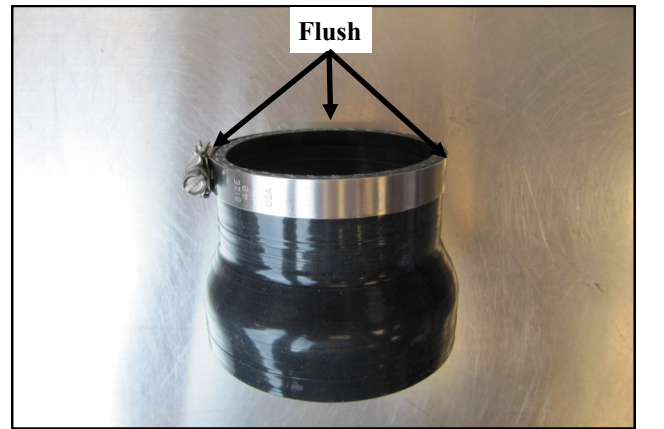

6. **2010 and 2011 Models Only:** The Coupler will need to be re sized. Slide the # 48 clamp onto throttle body side of the coupler and flush with the edge. Tighten the Clamp but do not over tighten, causing collapse. This is to be used as the blade guide.



7. Using a utility knife or equivalent, trim the Coupler in one single pass.

HINT: Keep the blade tight against the clamp while cutting and deeply inserted into the Coupler for a clean cut.



8. Remove excess Coupler length from the Clamp and discard it. It will not be used.

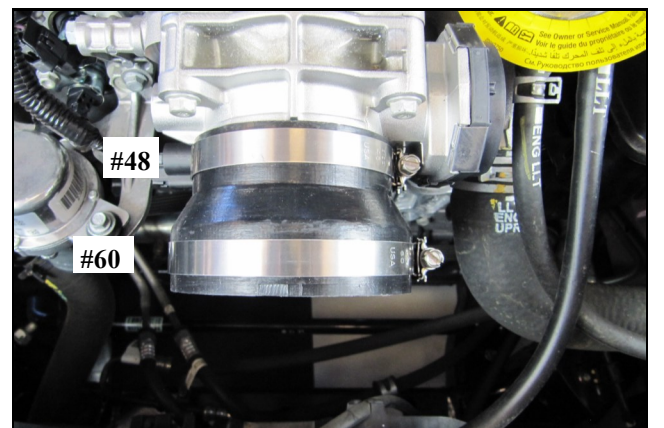

9. **All Model Years:** Install the Coupler and Clamps onto the throttle body as shown. Do not tighten the Clamps at this time.



10. Install the Barbed Fitting into the Airaid Intake tube. Apply the Airaid Bubble Decal onto the Intake Tube as shown.



11. Insert the Intake Tube assembly into the Hump Hose first then into the Coupler on the throttle body. Align the components and tighten the Clamps.

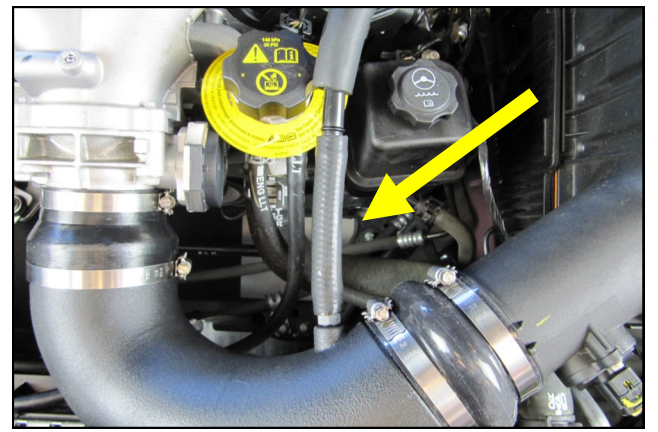

12. Connect the breather line from step 2. to the Airaid Intake Tube using the 1/2" hose.

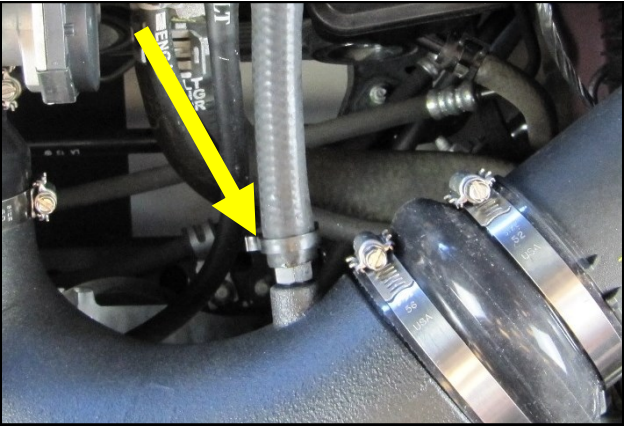

13. Secure the Breather Hose using the plastic Speed Clamp.



14. Reinstall the engine cover and oil cap. Reconnect the Battery.

Thank you for purchasing the Airaid Intake System. Contact Airaid @ (800) 498-6951 8:00 AM - 5:00 PM MST weekdays for questions regarding fit or instructions that are not clear to you. Your Airaid Intake System was carefully inspected and packaged. Check that no parts are missing, or were damaged during shipping. If any parts are missing, contact Airaid. The air filter element is protected from direct exposure to water and debris; care should be taken not to drive through deep water. WATER INGESTION IS THE DRIVERS RESPONSIBILITY! The air filter is reusable and should be cleaned periodically.

FILTER IDENTIFICATION

850-427 Airaid Oiled Media

851-427 Airaid SynthaMax Dry Media

For your Oiled media filter we suggest using the AIRAID Filter Tune-Up Kit!

SynthaMax[®]

Do Not Oil



P/N 790-551 Aerosol Spray
P/N 790-550 Squeeze Spray

Synthamax Air Filters do not require oil. Service air filter as needed by cleaning with common non-petroleum all-purpose household cleaner and water. Simple Green[®], Formula 409[®] or equivalent works great. Apply cleaner to outside of air filter and allow to soak. Then flush filter clean from the inside out with a garden hose and repeat steps if necessary. Do not apply high pressure water or air to clean filter. Allow filter to air dry and reinstall.

