

Airaid

Installation Instructions

For Part Numbers:

454-356 704-495 Airaid Oiled Media Filter - Yellow

455-356 705-495 SynthaMax Dry Media Filter - Yellow

2018-20 FORD Mustang GT

V8-5.0L

NOT LEGAL FOR SALE OR USE ON ANY POLLUTION CONTROLLED MOTOR VEHICLE IN CALIFORNIA OR STATES ADOPTING CALIFORNIA EMISSION PROCEDURES.

See Airaid.com for CARB status on each part for a specific vehicle

Component Identification

Description	Qty.	Part #
A HOSE CLAMP #56	2	08620
B COUPLER; 3.5"ID X 2"L	1	KITCOUPLER09
C FITTING; VENT; STRT, 3/8"	1	82631
D GROMMET; 15/16"OD, 3/8"ID	1	08100
E INTAKE TUBE	1	KIT356A
F GASKET; 3/16	1	09069
G ADAPTER; MAF SENSOR	1	088032
H WASHER; 6MM FLAT, SS	2	08269
I BOLT; M6 X 1.00 X 16MM, SS	2	07730
J BOLT; M4 X .7 X 8MM, SS	2	07741
K GROMMET; 1"OD, 1/2"ID	1	08064
L FITTING; VENT 1/2" BARB	1	82629
M HOSE CLAMP #72	2	08671
N HUMP HOSE; 4.25"ID X 3"L	1	KITHUMPHS05EPDM
O BOLT; 1/4-20 X 1/2 BUTTON	9	07706
P WASHER; 1/4"ID X 5/8"OD	9	08275
Q ADAPTER; MAF PLASTIC 112-1	1	KIT1121MAFADA
R CLAMP; #104, 9/16" SS	1	KITHS104
S FILTER	1	704/705-495
T INSERT; LID 328 BLANK	1	KIT328LIDINSERTBLANK
U LID; 45%-328	1	KIT328LID
V AIRBOX	1	KIT328CAB
W MAF EXTENSION HARNESS	1	21780
X CAPPLUG; 15/16" ID, 3/4" L	1	08246

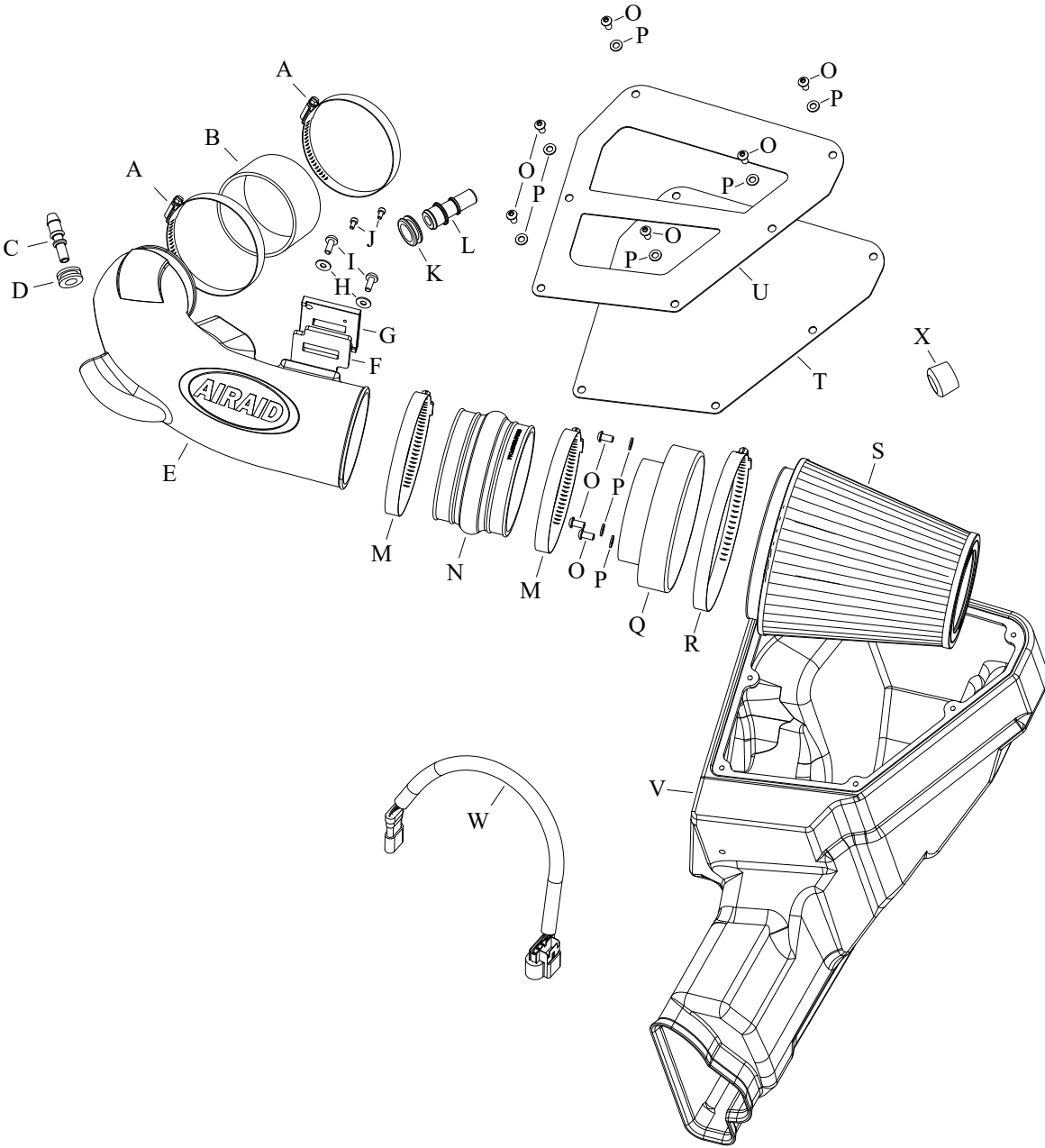

Full color instructions can be viewed on our web site at Airaid.com. If you need any assistance please call 1-800-498-6951 to speak with a representative in our Customer Service Center before returning the product.

TO START:

1. Turn off the ignition and disconnect the negative battery cable.

NOTE: Disconnecting the negative battery cable erases pre-programmed electronic memories. Write down all memory settings before disconnecting the negative battery cable. Some radios will require an anti-theft code to be entered after the battery is reconnected. The anti-theft code is typically supplied with your owner's manual. In the event your vehicles anti-theft code cannot be recovered, contact an authorized dealership to obtain your vehicles anti-theft code.



2. Remove the four nuts that secure the strut tower brace and then remove the strut tower brace from the vehicle.



3. Remove the two covers to access the nuts that secure the engine cover, then remove the two nuts and engine cover.



4. Disconnect the mass air sensor electrical connection.



5. Disconnect the two vent lines attached to the factory intake tube, loosen the hose clamps that secure the intake tube to the throttle body and air filter housing.



6. Release the clamp that secures the sound tube to the sound drum and then disconnect the sound tube from the drum. Remove the factory intake tube assembly from the vehicle.

Continued...



7. Install the provided cap onto the sound drum as shown.



8. Release the two clips that secure the upper air filter housing and remove the upper housing from the vehicle.



9. Remove the bolt that secures the lower air filter housing to the inner fender and then remove the lower housing from the vehicle.

NOTE: AIRAID recommends that customers do not discard factory air intake.



10. Install the provided filter adapter into the AIRAID® air filter housing and secure with the provided hardware.



11. Install the small quick disconnect fitting into the AIRAID® intake tube using the provided grommet.



12. Install the large quick disconnect fitting into the AIRAID® intake tube using the provided grommet.



13. Remove the mass air sensor from the factory air filter housing and then install it into the provided adapter along with the provided gasket.



14. Install the mass air sensor assembly into the AIRAID® intake tube as shown and secure with the provided hardware.



15. Install the AIRAID® air filter assembly into the vehicle and secure with the provided hardware.



16. Install the provided coupling hose onto the throttle body and secure with the provided hose clamp.



17. Install the provided hump coupler onto the filter adapter and secure with the provided hose clamp.



18. Install the AIRAID® intake tube into the coupler at the filter adapter and then into the coupler at the throttle body, adjust the tube for best fit and then secure with the provided hose clamps.



19. Connect the EVAP and crankcase vent lines to the fittings installed into the AIRAID® intake tube.



20. Install the AIRAID® air filter onto the filter adapter and secure with the provided hose clamp.



21. Install the clear and aluminum lids onto the air filter housing and secure with the provided hardware.

Continued...



22. Reinstall the engine cover and strut tower brace and secure with the factory hardware.



23. Double check your work!

Make sure there is no foreign material in the intake path. Make sure all clamps, hoses, bolts, and screws are tight. Double check the hood clearance!

Reconnect the negative battery cable!

Thank you for purchasing the Airaid Intake System. Contact Airaid @ (800) 498-6951 8:00 AM - 5:00 PM MST weekdays for questions regarding fit or instructions that are not clear to you. Your Airaid Intake System was carefully inspected and packaged. Check that no parts are missing, or were damaged during shipping. If any parts are missing, contact Airaid. The air filter element is protected from direct exposure to water and debris; care should be taken not to drive through deep water.

WATER INGESTION IS THE DRIVERS RESPONSIBILITY! The air filter is reusable and should be cleaned periodically.

For your Oiled media filter we offer the
Airaid Tune Up Kit!



P/N 790-551 Aerosol Spray
P/N 790-550 Squeeze Spray



NOT LEGAL FOR SALE OR USE ON ANY POLLUTION CONTROLLED MOTOR VEHICLE IN CALIFORNIA OR STATES ADOPTING CALIFORNIA EMISSION PROCEDURES.

See Airaid.com for CARB status on each part for a specific vehicle



Synthamax Air Filters **do not** require oil. Service air filter as needed by cleaning with common non-petroleum all-purpose household cleaner and water. Simple Green®, Formula 409® or equivalent works great. Apply cleaner to outside of air filter and allow to soak. Then flush filter clean from the inside out with a garden hose and repeat steps if necessary. Do not apply high pressure water or air to clean filter. Allow filter to air dry and reinstall.