

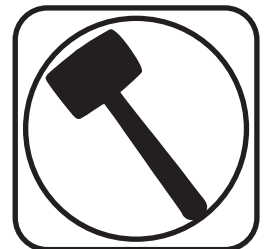

### Part # 11389611 - 1999-2006 Silverado 1500 Rear C-Notch Kit

#### Recommended Tools

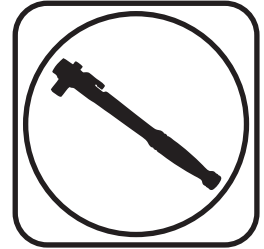

## 1999-2006 Silverado Rear C-Notches Installation Instructions

#### Table of contents

Page 2.....	Included Components & Hardware List
Page 3.....	Disassembly
Page 4-8.....	C-Notch Installation
Page 8-9.....	Bed Modification





### Major Components .....In the box

Item #	Part #	Description	QTY
1	90003244	Driver C-Notch	1
2	90003245	Passenger C-Notch	1
3	90002804	C-Notch Nut Plate - Driver	1
4	90002805	C-Notch Nut Plate - Passenger	1
5	90000311	C-Notch Spacer Plate - <b>1999 &amp; 2000 Trucks</b>	2
6	70013322	Short Bumpstops with Hardware	2

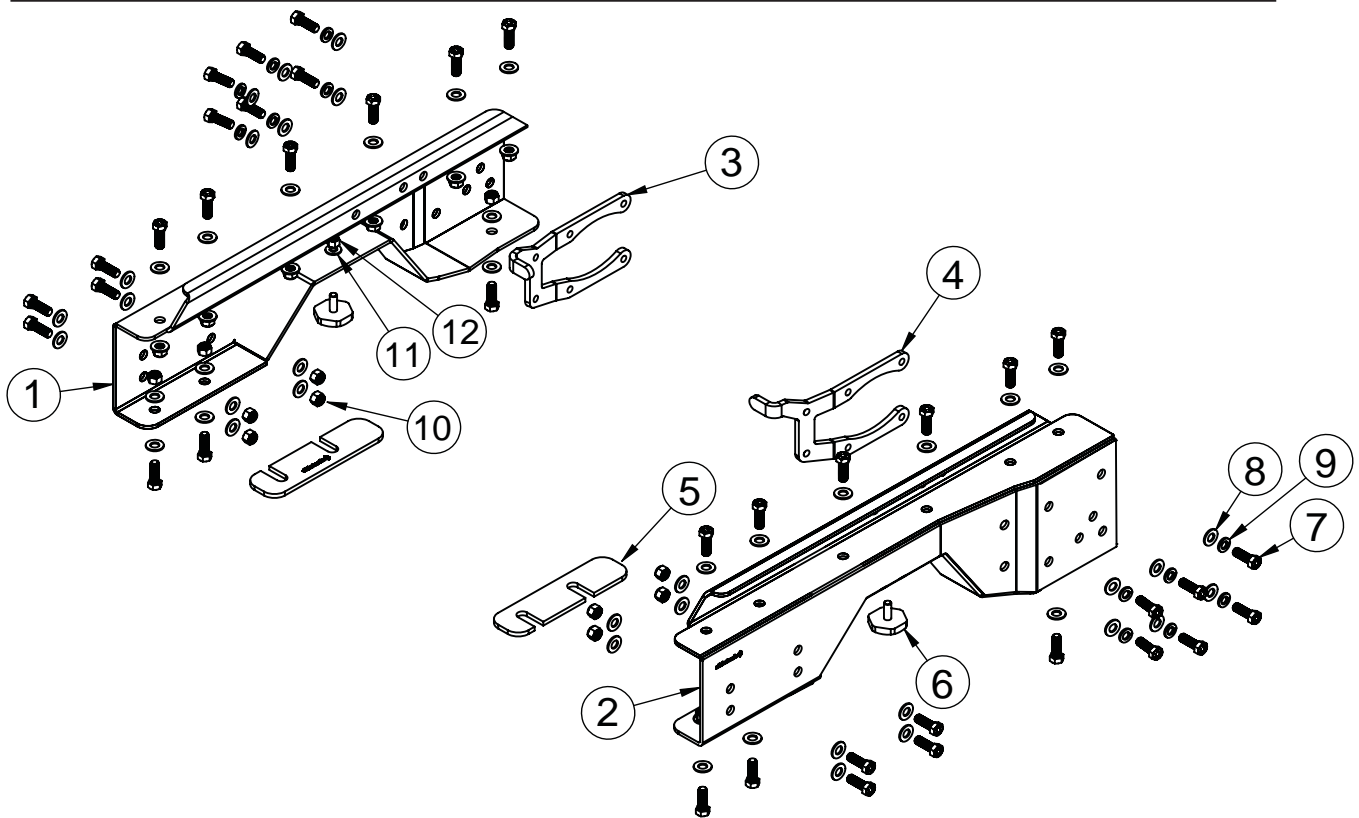

### Hardware List .....In the box (Kit# 99010167)

The Hardware Kit contains bags to help aid in selecting the correct hardware for the component being installed. The hardware list shows how the hardware is bagged.

Item #	Part Number	Description	QTY	Item #	Part Number	Description	QTY
<b>"C" NOTCH MOUNTING -</b>				<b>BUMPSTOP</b>			
7	99431021	7/16" x 1 1/4" USS Bolt	38	11	99373003	3/8" SAE Flat Washer	2
8	99433005	7/16" SAE Flat Washer	26	12	99372002	3/8"-16 Nylok Nut	2
9	99433003	7/16" Split Lock Washer	12				
10	99432010	7/16" USS Nylok Nut	26				



### Disassembly

1. Raise the vehicle to a safe and comfortable working height and support it by the frame. You will need to be able to move the rear differential up and down. Use a jack under the rear axle so it can be raised and lowered as needed during the install.
2. **Remove the bed, retaining the hardware for reassembly. This kit can NOT be installed with the bed on. The bed requires minor modifications before reinstalling it.**
3. Refer to the factory service manual for proper disassembly procedures.



4. The Brake Line Bracket will need to be removed from the top of the driver side frame rail. This will be reattached later.

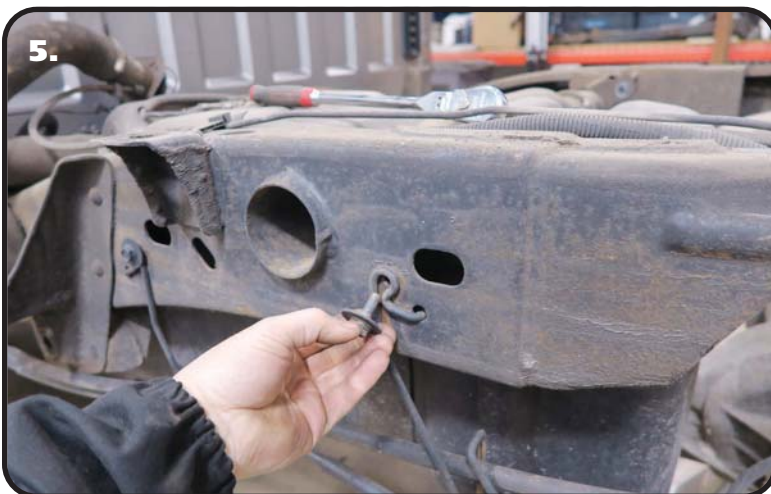

5. Unbolt the emergency brake cable bracket from the driver side frame rail. It is located between the axle and the front leaf spring hanger. Retain the hardware for reassembly.



### "C" Notch Installation



6. To allow maximum drop on this truck, the frame must be notched. The template for the notch will locate off of the 2 large oval holes. Use the supplied "C" Notch template to mark out the frame for cutting. Before cutting out the frame, support the frame in front of and behind the "C" Notch area. We suggest doing one side at a time. The tall end of the template is located to the front of the truck.

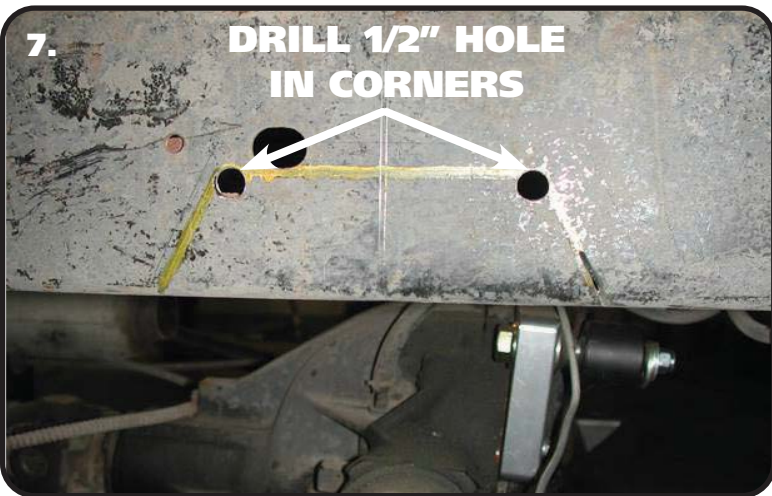

7. Use the supplied Template to mark the cut lines on the frame, then drill out the two corners with a 1/2" drill bit. This will give the cut a round edge and eliminate the possibility for stress fractures. Then cut the notch with a saw-z-all, cutoff wheel, or plasma cutter. Grind all edges smooth. Check the inside of the frame for wires or lines before drilling or cutting.



#### 99 ONLY!!!

8. We have come across some frames that have a protrusion stamped in the frame above the axle. This will need to be flattened out to get the c-notch fitting tightly. We did this by extending the horizontal cut forward to the end of the protrusion then cutting straight down to the bottom of the frame. After the frame is cut, use a hammer or vise grips to bend the protrusion flat. Refer to **Image 8**.



### "C" Notch Installation



9. After cutting, slip the c-notch over the frame to check the fitment.



10. The front edge of the C-Notch should be 4 1/2" from the oval hole in front of it. Trim the opening to move the c-notch forward or backward to achieve 4 1/2".



11. Use a 7/16" Drill bit to drill the holes in the side of the frame. DO NOT DRILL THE HOLES WHERE THE EMERGENCY BRAKE CABLE BRACKET IS BOLTED OR THE TOP AND BOTTOM OF THE C-NOTCH. There are 10 holes in the side that need to be drilled.



### "C" Notch Installation



**12.** After drilling the holes in the side for the frame, remove the C-notch to insert the front nut plate. **Image 12** shows the Driver Nut Plate. The top tab is bent to the inside of the frame to allow it to be held in place. After inserting the nut plate, reinstall the C-notch. Install a 7/16" Lock Washer, & 7/16" Flat Washer on (6) 7/16" x 1 1/4" Bolts. Hold the nut plate in place and insert the bolts/washer through the c-notch and frame threading them into the nut plate. Repeat on the other side. LEAVE THE HARDWARE LOOSE.

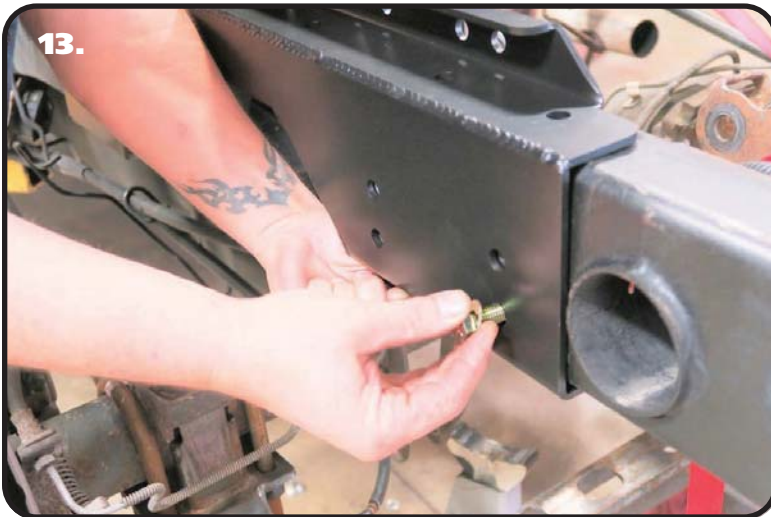

**13.** Install a 7/16" Lock Washer, & 7/16" Flat Washer on (4) 7/16" x 1 1/4" Bolts. Install them in the rear 4 holes of the c-notch. Install a 7/16" Flat Washer and 7/16" Nylok Nut on each bolt sticking through the frame. Repeat on the other side. LEAVE THE HARDWARE LOOSE.

**Repeat Steps 6-13 on the other side.**

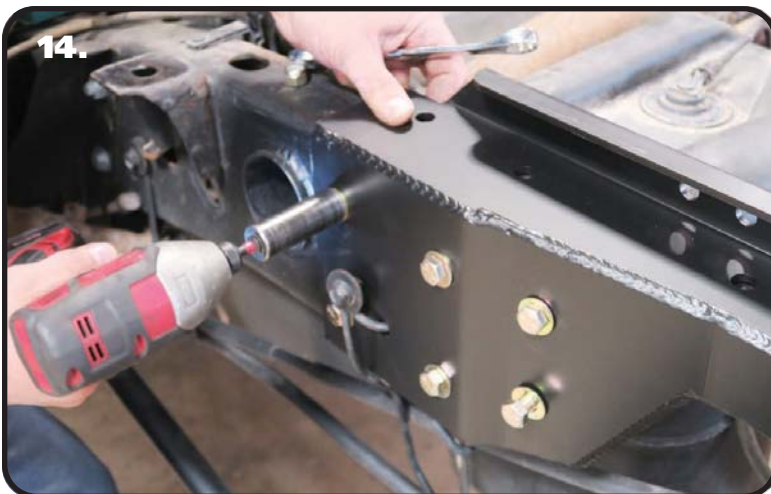

**14.** Tighten all of the c-notch side bolts. After tightening the side bolts, tighten the crossmember bolts. Torque to 50 ftlbs.



### "C" Notch Installation



**15.** Reinstall the emergency brake cable bracket using the OEM hardware.



**16.** Use a 7/16" Drill bit to drill the remaining holes in the top and bottom of the frame. Install a 7/16" Flat Washer on the remaining 7/16" x 1 1/4" Bolts. Insert bolt/washers in the drilled holes of the c-notch. Install a 7/16" Flat washer and 7/16" Nylok Nut on the threads sticking through the c-notch/frame. DO NOT TIGHTEN.

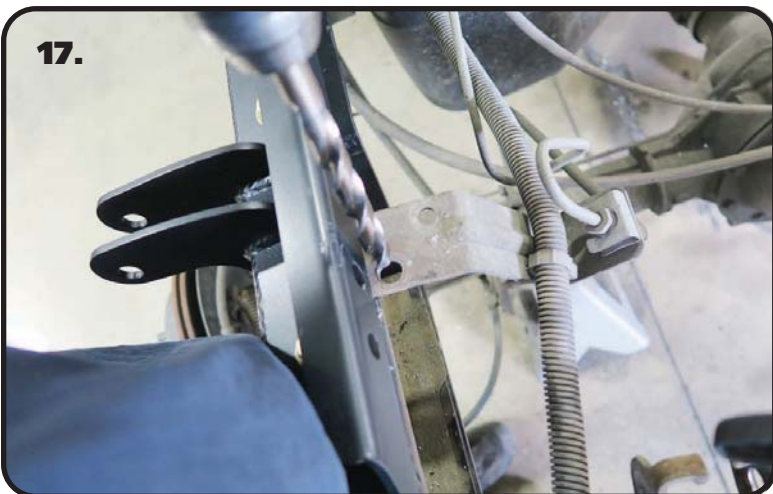

**17.** Use a 7/16" drill bit to drill out the rear hole of the OEM Brake Line Bracket.



### "C" Notch Installation & Bed Modification



**18.** Remove the nut and washer from the 2nd from rear top bolt of the driver side c-notch. Install the brake line bracket on the bolt and reinstall the nut and washer. **If 1999 - 2000, continue on step 20.** If your truck is 2001 and newer, tighten the top and bottom c-notch hardware to 50 ftlbs then skip to step 21. If 1999 - 2000, continue on step 20.



#### 1999-2000 ONLY

**19.** The 1999 & 2000 model year trucks have a slightly shorter frame rail height than the newer trucks. The kit includes (2) spacers to fill the gap that is on the bottom rear of the c-notch. Insert a spacer in the gap of the driver and passenger side c-notches. Tighten the top and bottom hardware to 50 ftlbs.

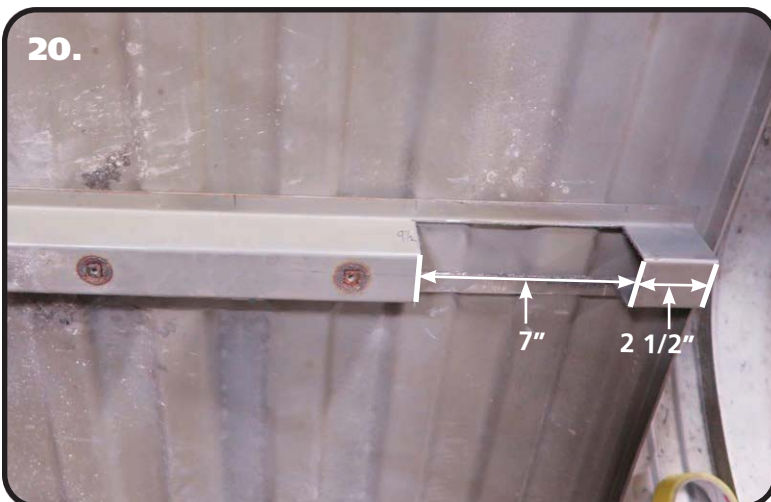

**20.** Trimming of the bed brace that is in between the wheel wells is necessary to clear the c-notches and wishbone. We cut ours with a die-grinder. **Image 54** shows the passenger side, the dimensions are the same for both driver and passenger. The first notch starts 2 1/2" from the end of the brace. The notch is 7" long. Trim the driver and passenger side using these dimensions. **Image 55** shows the driver and passenger sides cut out.





### Bed Modification & Bumpstop Installation



**21.** Your bed brace should look like **Image 21** after cutting.



**22.** Install the Bumpstops into the C-Notch above the axle using the 3/8" Flat Washer and 3/8"-16 Nylok Nut supplied. A bumpstop will need to be installed in each c-notch.

**23.** Reinstall the bed.

**24.** Verify all hardware is tight.