



CAT BACK EXHAUST SYSTEM

PART NO. 50100

Fits: 2007-2013 Chevrolet Silverado 1500
: 2007-2013 GMC Sierra 1500
Engine Size: 4.8L & 5.3L 07-08 / 5.3L 09-13
Cab Size: Extended Cab / Crew Cab



ALLOW VEHICLE TO COOL DOWN BEFORE WORKING ON ANY ENGINE / EXHAUST COMPONENTS.



REMOVE CONTENTS FROM BOX. VERIFY ALL PARTS ARE PRESENT.



READ INSTALLATION INSTRUCTIONS COMPLETELY BEFORE BEGINNING REMOVAL AND INSTALLATION



LIMITED LIFETIME WARRANTY



60-120 min



Cutting May be Required



PPE Kit Recommended



support@trailfx.com



1 866 638 4870

REMOVAL:

1. Allow plenty of time for your vehicle to cool down prior to starting. Exhaust systems reach high temperatures and may cause serious burns. Always wear appropriate safety equipment including goggles and gloves.
2. Read instructions prior to installation. Use a penetrating lubricant and spray the exhaust clamp nuts and all the isolation rubber mounts before removal and re-installation.
3. For easier installation, lay out the exhaust system according to the diagram.
4. Use a vehicle hoist to raise vehicle to proper working height. If a vehicle hoist is not available, raise the vehicle and securely support using jack stands. Use of a jack or stand to support the muffler when removing or installing is recommended.
5. 09-13 models, remove factory ball clamp behind the catalytic converter. A new clamp is provided with the hardware kit of the system. Remove the hangers from the rubber mounts on the vehicle and carefully lower the inlet pipe, muffler, front and rear tail pipe down and out towards the front of the vehicle. (See Image 1)
6. 07-08 models, remove the two nuts on the flanged connection behind the catalytic converter, keeping the nuts for re-installation. Remove the hangers from the rubber mounts on the vehicle and carefully lower the inlet pipe, muffler, front and rear tail pipe down and out towards the front of the vehicle.

INSTALLATION:

1. For 09-13 models – Put the adapter pipe #1 onto the ball connection behind catalytic converter. Install the ball clamp removed in removal step #5 and loosely tighten clamp for possible later adjustment. Slide a clamp onto the front of the inlet pipe #3 and install inlet pipe onto the back of the adapter pipe #1. Insert the hanger on the inlet pipe #3 to the rubber mounts on the vehicle. Loosely tighten clamp for possible later adjustment. Note – the hanger on the inlet pipe is not used on 8' bed models. (IMAGE 1 & IMAGE 2)
2. If installing exhaust system on vehicle with an 8' bed, extension pipe #6 must be used. Slide a clamp over the expanded end of the extension pipe and then onto the end of the inlet pipe #3. Slide hanger on extension pipe #6 into the OEM rubber hanger. Loosely tighten clamp for possible later adjustment. Skip installation step #2 if your vehicle does not have an 8' bed.
3. For 07-08 models – Put adapter pipe #2 into position behind catalytic converter and reinstall nuts removed in Removal step 6. Loosely tighten for possible later adjustment. Slide a clamp onto the front of the inlet pipe #3 and install onto the back of adapter pipe #2. Slide front clamp hanger onto the back of the inlet pipe #3 and insert wire hanger into the OEM rubber hanger on the vehicle. Loosely tighten front hanger clamp for possible later adjustment. Note – the hanger on inlet pipe #3 is not used.
4. Slide provided 3" exhaust clamp over the muffler inlet. Slide the inlet of the muffler onto the back of inlet pipe using a stand to support the muffler. Loosely tighten the clamp for possible later adjustments.

**IMAGE 1****IMAGE 2**

INSTALLATION CONTINUED:

5. Slide rubber hanger #10 onto L bracket #9 and then mount the bracket with supplied bolts, washers, nuts, and backing plates to the left side of the vehicle on the frame using elongated holes. Use of both backing plates on both sides of the frame is important to cover the elongated holes. (IMAGE 3)
6. Slide provided 2 ½" exhaust clamps over the muffler outlets. Position the right tailpipe #8 into position over the rear axle and slide into the right muffler outlet. Insert the two hangers from the right tailpipe #8 into the OEM rubber mounts on the vehicle. Loosely tighten clamp for possible later adjustments. Right tailpipe should have about ¾" clearance from shock after final adjustments. (IMAGE 4)
7. Slide the left front tailpipe #7 over the rear axle and into the left muffler outlet. Slide provided 2 ½" exhaust clamp over the end of the pipe. Install left rear tailpipe #11 onto front tailpipe. Insert hanger of rear tailpipe into rubber hanger installed in step #5. Tailpipe should be positioned between shock and spare tire at final adjustment. Loosely tighten clamps for possible later adjustment. (IMAGE 5)
8. Slide the supplied 2 ½" exhaust clamps onto either the side exits pipes #12 or the rear exit pipes #13 and then install onto ends of both rear tailpipes #8 and #11. Loosely tighten clamps for possible later adjustment. (IMAGE 6)

**IMAGE 3****IMAGE 4****IMAGE 5****IMAGE 6**

INSTALLATION CONTINUED:

9. Install both black powder coat tips #14 on the exits pipes and loosely tighten for possible adjustment later. Adjust the tips and pipes for desired clearances and proper position. (IMAGE 7)
10. Make all necessary adjustments for the pipes and muffler for proper clearances. From front to rear, fully tighten each clamp until connections are secure.
11. Install supplied 1/2" hanger keepers onto inlet pipe and tailpipe hangers. Install 7/6" hanger keeper onto left rear hanger installed in step #5 above. Hanger keeper are important to keep the system from shifting and allowing a hanger to come free from holder. (IMAGE 8)



IMAGE 7



IMAGE 8

Please consider these complementary SpeedFX products.

www.Speed-FX.com



PARTS DIAGRAM

PART NO. 50100

PARTS LIST:

Qty	Part Description	Qty	Part Description
1	09-13 Adapter (#1)	1	Hardware Kit***
1	07-08 Adapter (#2)	1	Steel Frame Hanger (#9)
1	Inlet Pipe (#3)	2	Steel Back Plates
1	Front Clamp Hanger (#4)	1	Rubber Hanger (#10)
1	Muffler (#5)	3	3" Exhaust Clamps (#15)
1	Extension Pipe – for 8' beds only (#6)	5	2 1/2" Exhaust Clamps (#15)
1	Left Front Tailpipe (#7)	1	Bolt – 3/8" X 1 1/4"
1	Right Tailpipe (#8)	1	3/8" Nut, Washer, Lock Washer
1	Left Rear Tailpipe (#11)	1	7/16" Hanger Keeper
2	R / L Side Exit Pipes (#12)	5	1/2" Hanger Keeper
2	R / L Rear Exit Pipes (#13)	1	3" Ball Clamp (09-13) models (#16)
2	Black Powder Coat Tips (#14)		

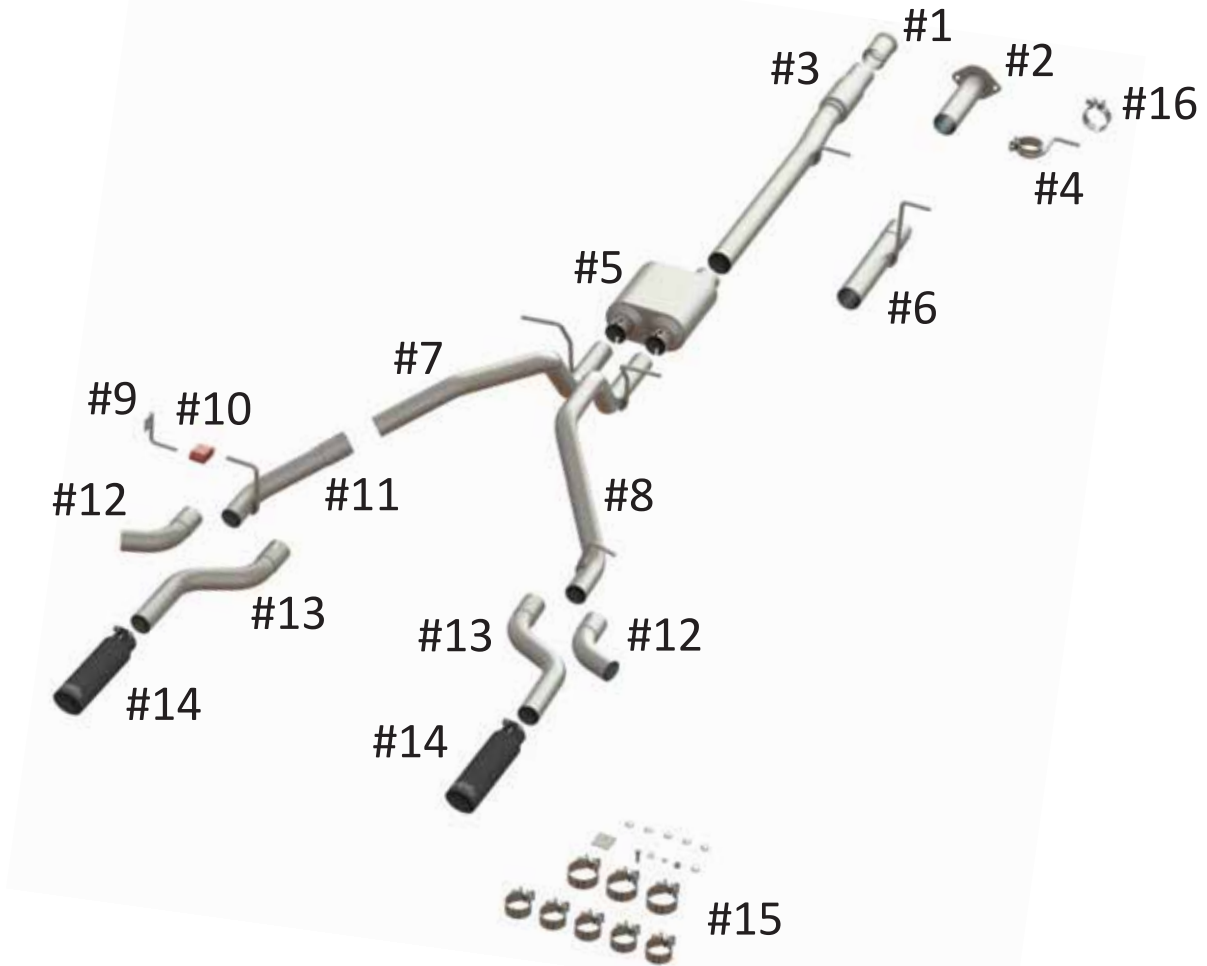

Keystone Automotive Operations (KAO) warrants this product to be free of defects in material and workmanship at the time of purchase by the original retail consumer. KAO disclaims any other warranties, express or implied, including the warranty of fitness for a particular purpose or an intended use. If the product is found to be defective, KAO may replace or repair the product at our option, when the product is returned prepaid, with proof of purchase. Alteration to, improper installation, or misuse of this product voids the warranty. KAO's liability is limited to repair or replacement of products found to be defective, and specifically excludes liability for any incidental or consequential loss or damage.