

banks

with Installation Instructions
Owner's Manual

Banks Ram-Air[®] Super-Scoop[®]

2003-07 Chevy/GMC 6.6L Duramax Turbo-Diesel Pickups

THIS MANUAL IS FOR USE WITH KITS 42168 AND 42169

Gale Banks Engineering
546 Duggan Avenue • Azusa, CA 91702
(626) 969-9600 • Fax (626) 334-1743

Product Information & Sales: (888) 635-4565

bankspower.com

General Installation Practices

Dear Customer,

If you have any questions concerning the installation of your Banks Ram-Air Super Scoop, please call our Technical Service Hotline at (888) 839-2700 between 7:00 am and 5:00 pm (PT). If you have any questions relating to shipping or billing, please contact our Customer Service Department at (888) 839-5600.

Thank you.

1. For ease of installation of your Banks Ram-Air Super-Scoop, familiarize yourself with the procedure by reading the entire manual before starting work. This manual contains 14 pages of copy, illustrations and parts listing. If any pages are missing from this manual please call Gale Banks Engineering immediately for a replacement.
2. The exploded view of the Ram-Air Super-Scoop assembly (pages 4-5) provides only general guidance. Refer to each step and section diagram in this manual for proper instruction.
3. Throughout this manual, the left side of the vehicle refers to the driver's side, and the right-side to the passenger's side.
4. Disconnect the ground cable from the battery before beginning work. If there are two batteries, disconnect both.
5. Route and tie wires and hoses a minimum of 6 inches away from exhaust heat, moving parts and sharp edges. Clearance of 8 inches or more is recommended where possible.

6. During installation, keep the work area clean. If foreign debris is transferred to any Banks system component, clean it thoroughly before installing.

7. When raising the vehicle, support it on properly weight-rated safety stands, ramps or a commercial hoist. Follow the manufacturer's safety precautions. Take care to balance the vehicle to prevent it from slipping or falling. When using ramps, be sure the front wheels are centered squarely on the topsides; put the transmission in park; set the parking brake; and place blocks behind the rear wheels.

Caution! Do not use floor jacks to support the vehicle while working under it. Do not raise the vehicle onto concrete blocks, masonry or any other item not intended specifically for this use.

Warning: This product is intended for general highway use. Do not use this product when fording streams or crossing bodies of water. Although this product is designed to separate water from entering the engine during normal highway driving in rainy conditions, it is not intended to be submerged under water for any amount of time. Regularly check the inlet of the Super-Scoop for any obstruction or debris that may impede the flow of air. After the installation of the Super-Scoop be aware of the decreased ride height and drive accordingly to avoid damage to the Super-Scoop. Regularly check to make sure the Super-Scoop is fastened securely and that all hardware and fasteners are tight and in good condition.

Tools Required:

- 3/8" drive ratchets with metric sockets
- Standard and Phillips head screwdrivers
- Standard and needle-nose pliers
- Clean shop towels or rags
- Electric Drill
- Drill 1/8, 1/4

Table of Contents

Section 1 **4**
General Assembly

Section 2 **6**
Super-Scoop Installation

Section 1

GENERAL ASSEMBLY

Figure 1

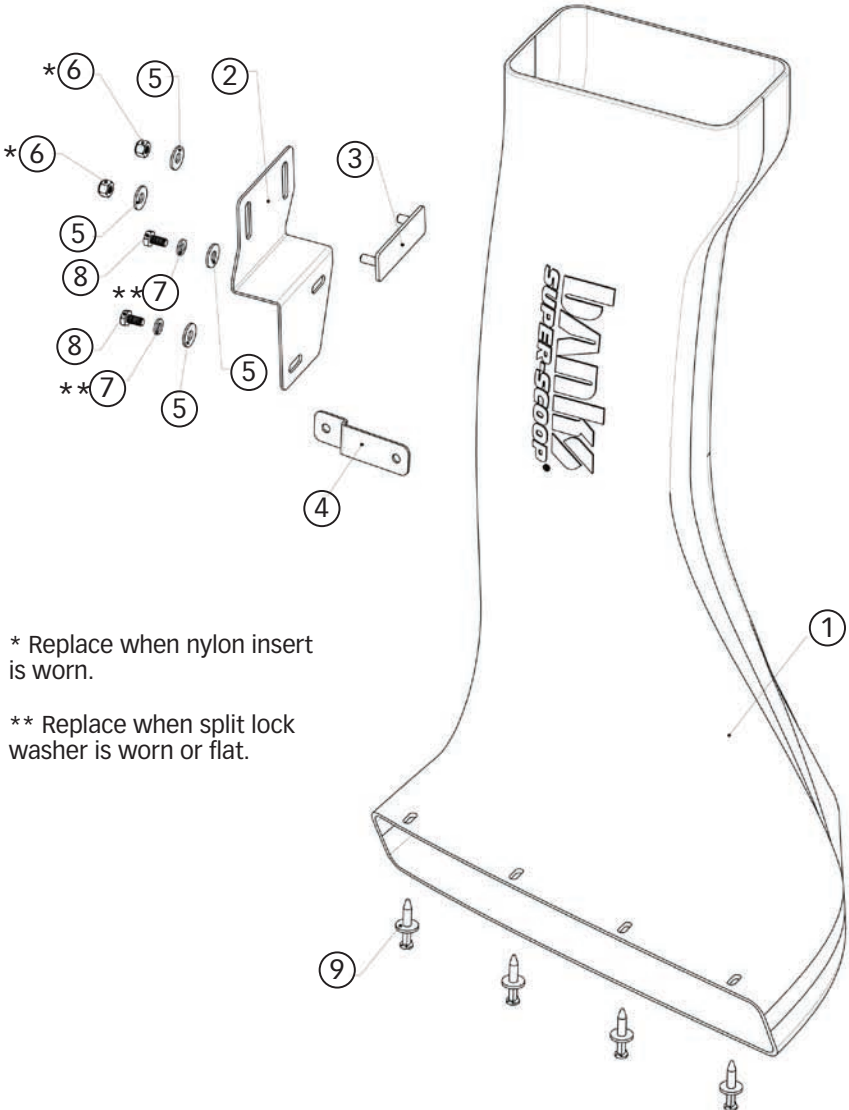

* Replace when nylon insert is worn.

** Replace when split lock washer is worn or flat.

Item	Description	Part#	Qty
1	SUPER-SCOOP, RAM-AIR SYSTEM, CHEVY, 6.6L DURAMAX, '03-'07	42160	1
	SUPER-SCOOP, RAM-AIR SYSTEM, GMC, 6.6L DURAMX, '03-'07	42161	1
2	BRACKET, SUPER-SCOOP	42162	1
3	STUD PLATE, SUPER-SCOOP	42163	1
4	BRACKET, HORN RELOCATION	42164	1
5	WASHER, USS, ZINC, 1/4	91103	4
*6	NUT, NYLOCK, 1/4-20 UNC	91110	2
**7	WASHER, SPLIT LOCK, ZINC, 1/4 "	91104	2
8	HEX BOLT, GR 5, ZINC, 1/4-20 X 1/2	91115	2
9	RETAINER, PUSH-TYPE, 1 1/16" HEAD X 1/4" DIA	92020	4

Section 2

SUPER-SCOOP INSTALLATION

NOTE: Before installing the Banks Super-Scoop make sure to have a completely installed Banks Ram-Air Intake System in your vehicle.

1. Remove all plastic retainer pins attached to the fender lining then remove the wheel liner and set aside. See **Figure 2**

Note: Detach the wire harness clip from the fender well liner and lay the wire harness out of the way.

2. The wire harness that connects to the horn on the passenger front side of the truck needs to be relocated to facilitate the addition of the Super-Scoop. Unclip the harness retainer located below the horn and remove the retainer.

3. Unclip the harness retainer above the horn and move the wire harness (take up the slack) until positioned as shown in **Figure 3**. Make sure the

wire harness is repositioned above the lower frame.

4. Remove the stock horn bracket and replace with the supplied horn bracket (reuse stock fasteners). Make sure to orient the horn bracket towards the front of the vehicle. See **Figure 4**.

5. Install the Banks Super-Scoop from beneath the front bumper and place the Super-Scoop's opening over the bottom of the Banks Ram-Air housing down spout.

*Note: Some vehicles, depending on year and equipment options, may require the A/C line to be bent slightly to provide additional clearance to fit the Banks Super-Scoop. See **Figure 5**.*

6. Locate the supplied Super-Scoop Stud Plate and Super-Scoop Bracket in your kit. Install the Stud Plate and Bracket to the side of the inner fender as shown in **Figure 6**. Lightly fasten

Figure 2



Figure 3

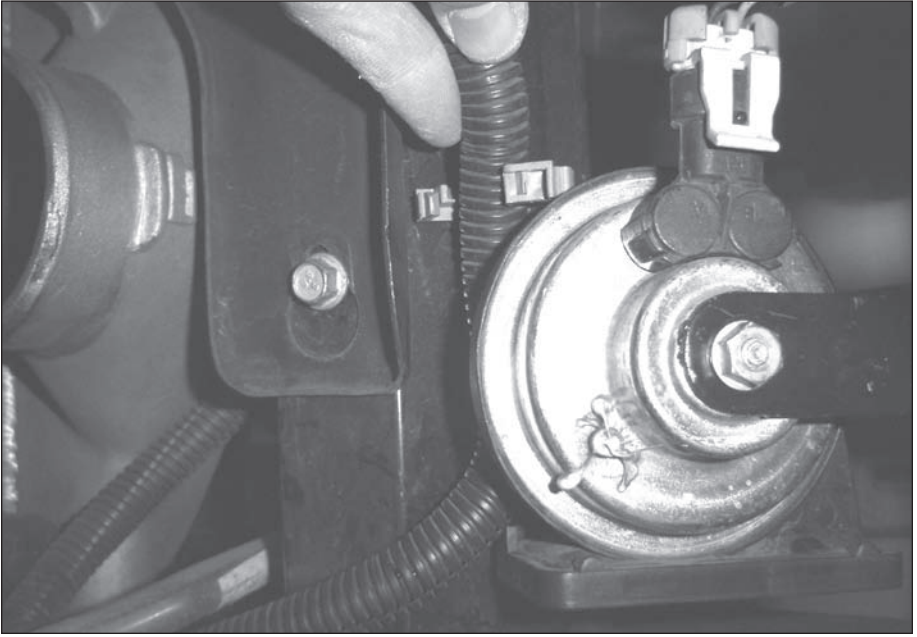

Figure 4

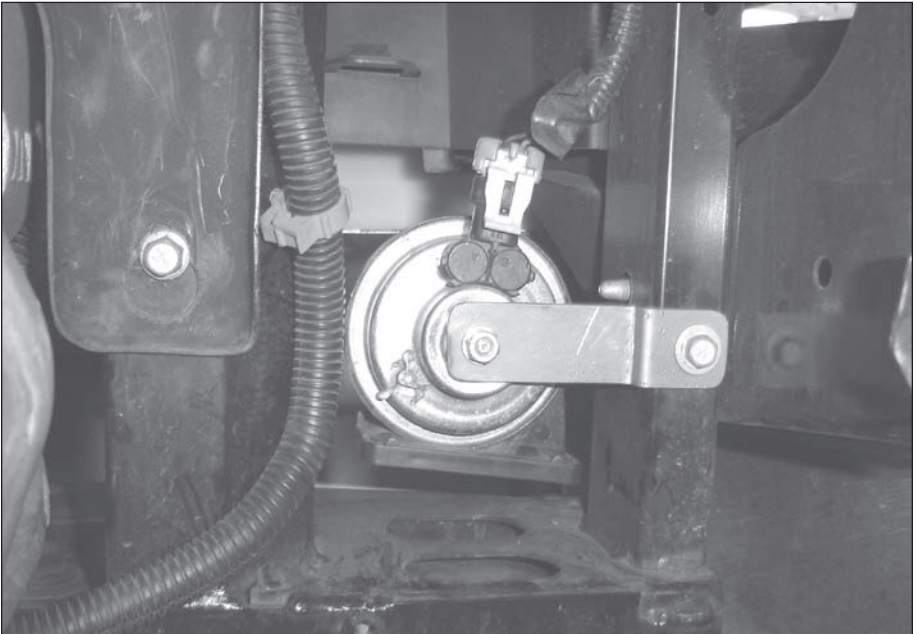

Figure 5 Provide A/C line clearance if necessary.

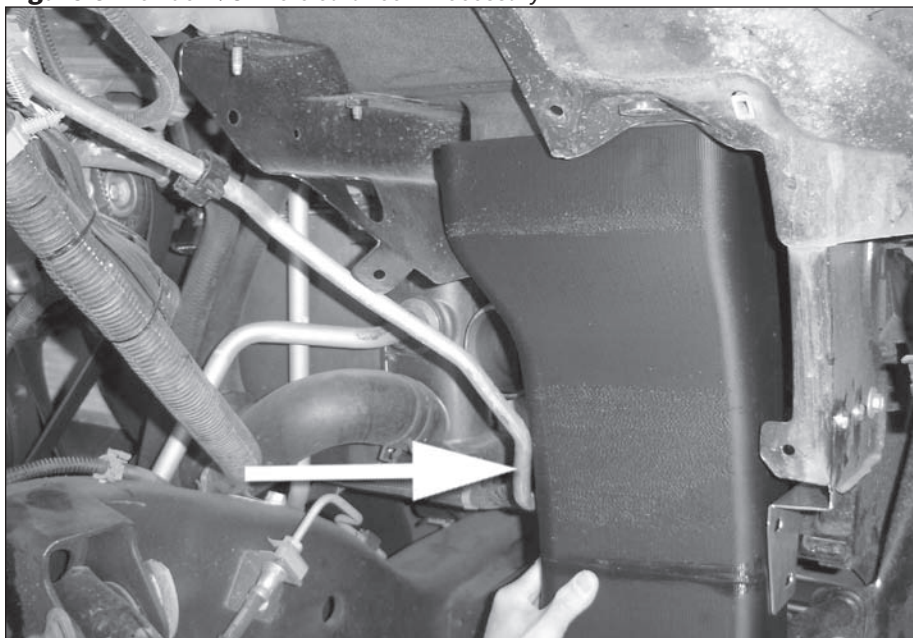

Figure 6



the Stud Plate and Bracket with the supplied nylock nuts and washers to the inner fender. See **Figure 7**. Do not reuse the nylock nuts if the nylon insert is worn.

7. Lift up, align and fit the Banks Super-Scoop into position. Fasten the supplied screws and washers to the side of Banks Super-Scoop. Do not reuse the split lock washers if they are worn or flat.

*Note: Hand tighten only at this time. See **Figure 7***

8. Now go to the inlet of the Super-Scoop and align the inlet to fit the contour of the spoiler. Using the holes in the Banks Super-Scoop as a template, center punch then drill the holes through the spoiler. Use a 1/8 pilot drill then a finish off with a 1/4 drill. See **Figure 8**.

9. After drilling the spoiler make sure to remove any debris and align the Super-Scoop to fit the spoiler's contour. Insert the supplied plastic retainers and push in the retaining pin to expand the retainer and fasten the Super-Scoop.

10. Now go back to the fender well and tighten all the fasteners making sure that the Super-Scoop is positioned as far into the bottom of the Ram-Air housing down spout as possible.

Warning: If the Super Scoop is not positioned properly it will interfere with the wheel or wheel liner. Make sure there is adequate clearance between the Super-Scoop and wheel at all extreme positions of the wheel. (Full steering and suspension travel).

Figure 7

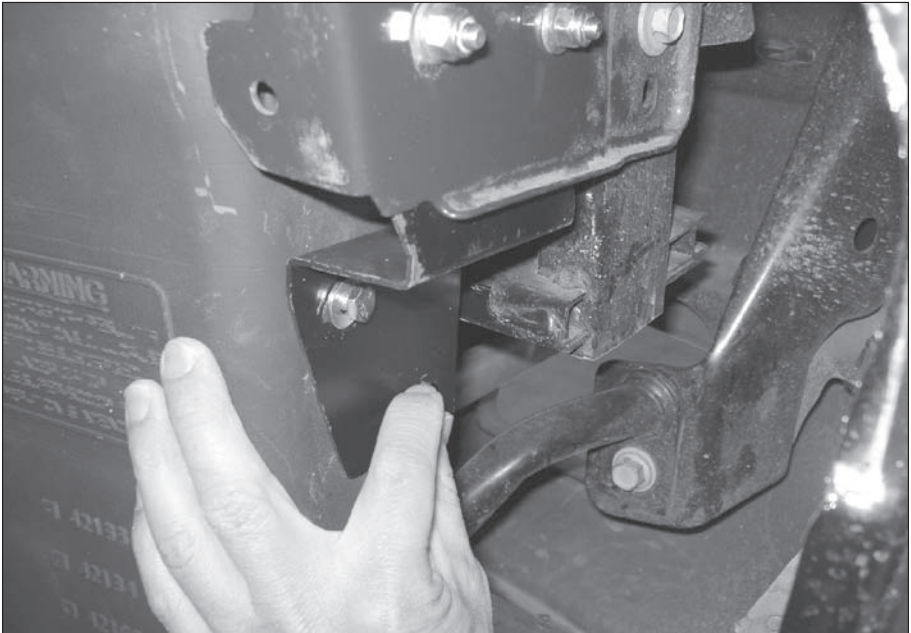
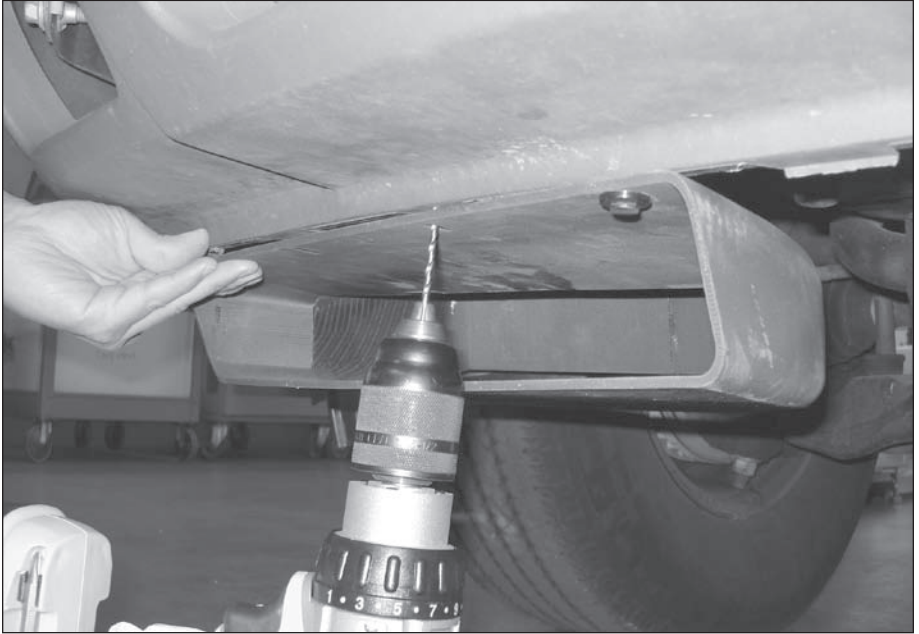

Figure 8



11. Position the fender well liner into the wheel well. Attach the previously removed wire harness to the fender well liner. Install the fender well liner and secure it using the previously removed plastic retaining pins.

12. You have now successfully installed the Banks Super-Scoop to your vehicle.

Notes

Gale Banks Engineering
546 Duggan Avenue • Azusa, CA 91702
(626) 969-9600 • Fax (626) 334-1743

Product Information & Sales: (888) 635-4565

bankspower.com