



INSTALLATION GUIDE

PART NUMBER: 5575
REAR ANTI-SWAY BAR
FORD BRONCO 4WD | 2021+

300 W. PONTIAC WAY. CLOVIS, CA 93612
PHONE: 800-445-3767 | EMAIL: INFO@BELLTECH.COM

THANK YOU

Thank you for choosing our high quality Belltech product. We have spent a great deal of time developing our line of products so that you will receive maximum performance with minimal difficulty during installation. Soon your vehicle will be on the road looking and feeling much improved.

Please take a moment to read all instructions and warnings prior to installation of your new Belltech product and before operating your vehicle. If you have any questions or concerns regarding any step in the installation process, please do not hesitate to call or email our customer support specialists who are trained to help you through any portion of this process.

Before You Begin:

It is of the utmost importance that you confirm all of the components listed on the parts list is in the kit. You can find this list located on the last page(s) of your instructions. Do not begin installation if any part is missing. Instead, please call our Belltech customer service specialists.

Belltech Customer Support:

Phone: 1-800-445-3767

Email: info@belltech.com

Safety Information:

Warning: Do not work under a vehicle supported only by a jack. Place support stands securely under the vehicle in the manufacturer's specified locations unless otherwise instructed.

Proper use of safety equipment and eye/face/hand protection is absolutely necessary when performing any of the following instructions.

We strive for an exceptional experience for all our valued customers. If for any reason you need assistance with your Belltech products, please do not return the product to the store you purchased from, but rather call our dedicated customer service experts, from 7am to 5pm PST.

We recommend that a qualified mechanic, at a properly equipped facility, perform this installation.

It is very helpful to have an assistant available during installation.

Before Driving Your Vehicle:

It is important to double check all brake hoses, cables, and other components to be sure there is no interference. You must also check for wheel/tire to chassis/body interference. If any issues are found, review your installation instructions to be sure no steps were missed and any problems are corrected.

Make sure your vehicle is aligned immediately following installation.

Check all hardware and re-torque at intervals for the first 10, 100, and 1000 miles.

Some of Belltech's products are designed to improve your vehicle's off-road performance. Leveling/lifting your vehicle may result in an altered center of gravity. It is crucial to use extreme care when operating your vehicle to prevent rollover and/or loss of control.

Any changes in your vehicle's suspension may result in transformed handleability. Please test-drive your vehicle in a remote location so you can become accustomed to the revised driving characteristics.

Perform headlight check and adjustment.

Failure to drive any modified vehicle in a safe manner may result in harm or death.

Never operate your modified vehicle under the influence of drugs, alcohol, or lack of adequate sleep.

Always wear your seatbelt.



DIFFICULTY:

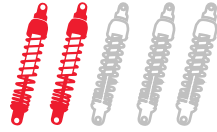

INSTALLATION TIME: 1-2 Hours

RECOMMENDED TOOLS:

- Properly rated floor jack
- Transmission jack
- Support stands
- Ratcheting socket wrench and socket set
- Combination wrench set



Installation Note:

It is suggested to begin this procedure with the vehicle fuel tank on low to reduce the weight needing to be supported on the transmission jack during installation.

JACKING, SUPPORTING, AND PREPARING THE VEHICLE

1. Park your vehicle on a smooth, level, concrete or seasoned asphalt surface.
2. Block the front wheels of the vehicle using wheel chocks. Make sure the vehicle's transmission is in "PARK" (automatic) or 1st gear (manual).
3. Activate the parking brake.
4. Break loose, but do not spin the wheel lug nuts to ease in removal when the wheels are in the air.
5. Lift the rear of the vehicle off the ground using a properly rated floor jack. Lift the vehicle so the rear tires are approximately 6-8 inches off the ground.
6. Place support stands rated for the vehicles weight. The stands should be positioned in the factory specified locations (Refer to owners manual). Prior to lowering the vehicle onto stands, make sure the support stands will contact the chassis. It is very important that the vehicle is properly supported to prevent any harm to ones self or to the vehicle.
7. Lower the vehicle slowly onto the stands.
8. Remove the rear wheels.



Technician reminder:

Never work under a vehicle supported only by a jack. It is necessary to place support stands securely under the vehicle in the manufacturer's specified locations unless otherwise instructed.

OEM ANTI-SWAY BAR REMOVAL ****IF EQUIPPED****

9. Remove the two bolts securing the anti sway bar bushing brackets on either side of the rear axle and let the OEM anti sway bar hang.
10. Remove the nuts securing the OEM anti sway bar to the end links.
11. Remove and guide the OEM anti sway bar up and over the drive line.
12. Lay it on the ground to be used as a reference for mounting the Belltech bushings and brackets to the Belltech anti sway bar. Pay close attention to the orientation of the bushings and mount them on the outside of the locator rings.

BELLTECH END LINK ASSEMBLY

13. Assemble the adjustable Belltech endlinks in the same order as shown in the images below.

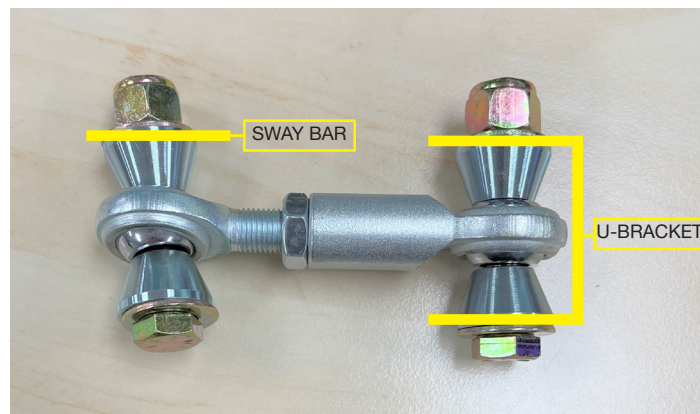

BELLTECH ANTI-SWAY BAR INSTALLATION

14. Attach your new Belltech adjustable end links to the Belltech U-brackets as shown in the end link assembly guide on page 3.



15. Start on the driver's side of the vehicle. Install the Belltech U-bracket onto the empty mount above the lower control using the provided hardware. Torque to 59 lb.ft

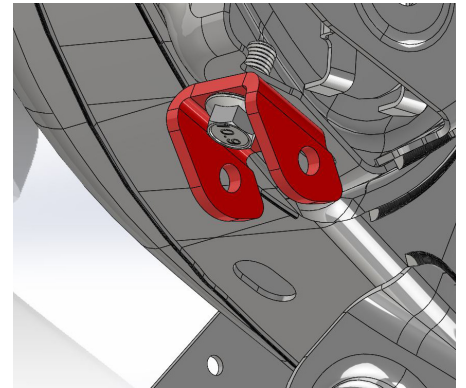
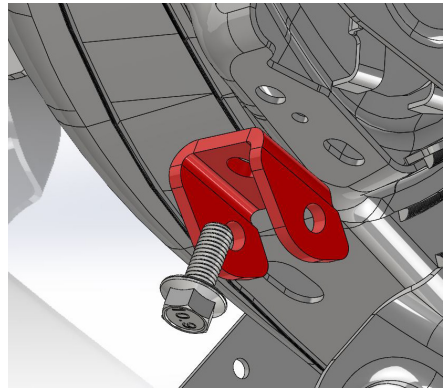
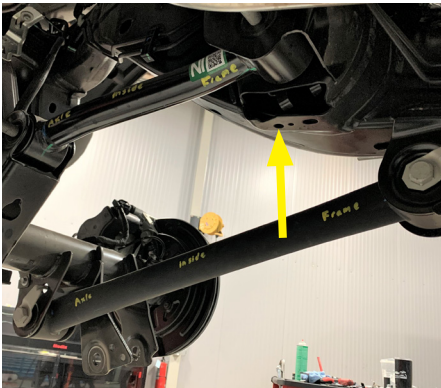

16. On the passenger's side of the vehicle, remove the fuel tank skid plate to observe the way your gas tank is held into place. If your gas tank is held in place by a strap, use a transmission jack to support the tank before removing the bolt that holds the strap in place above the lower control arm.



Installation Note:

It is suggested to install the sway bar with the fuel tank on low to reduce the weight being supported on the transmission jack during this step.

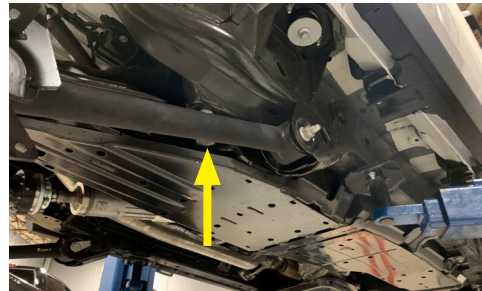

17. Use the Belltech provided bolt to slide through the Belltech U-bracket and gas tank strap. Tighten the bolt to 59 lb.ft
18. Grease the bushings using the supplied grease pack to help slide on with ease.
19. Guide the sway bar over the drive line. Place the bar over the driveline by lining up the bushings with the existing brackets on the axle where they will be mounted.

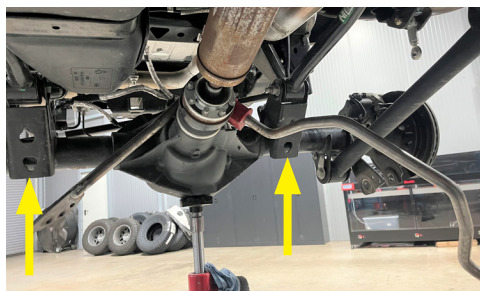

BELLTECH ANTI-SWAY BAR INSTALLATION CONTINUED

20. Install the Belltech threaded support plates between the axle and existing brackets.

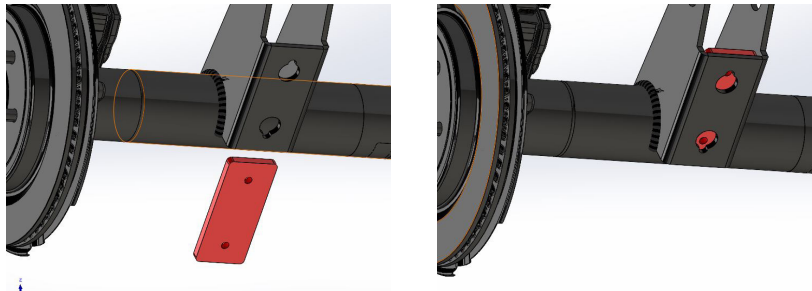

21. Slide the bushing support plates in front of the existing brackets before bolting the pivot bushing bracket and bar to the axle. Torque to 66 lb.ft

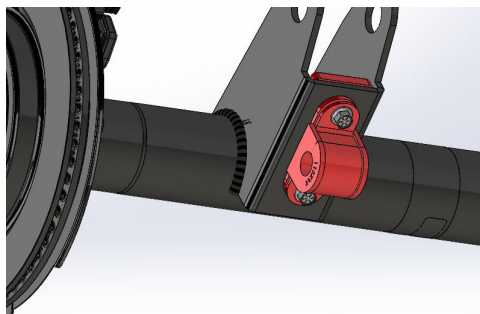

22. Swing the bar's arms upward and connect the bar ends to the endlinks using the supplied hardware as shown below. Torque to 45 lb.ft



23. Please choose a sway bar setting for your vehicle: OEM+, SPORT, TOW/HAUL (OEM+ is softer and TOW/HAUL is stiffer)

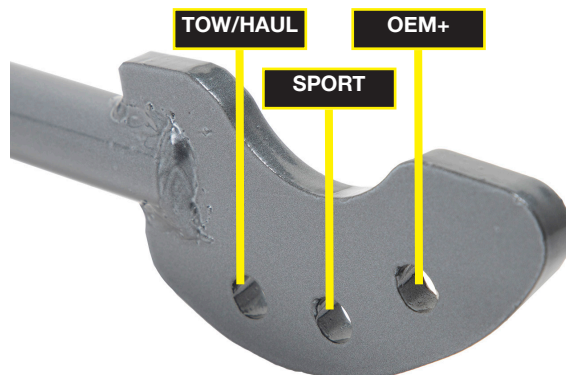

FINALIZING THE INSTALLATION

24. Re-install the wheels and tighten the lug nuts.
25. Lift the vehicle and remove the support stands.
26. Carefully lower the vehicle onto the flat ground.
27. Torque the lug nuts to manufacturer's specifications.
28. Check that all components and fasteners have been properly installed and torqued.
29. Re-read and perform all tasks in the "Before Driving Your Vehicle" section of page 1 of your instructions.

THANK YOU FOR CHOOSING BELLTECH.

You are now a part of the Belltech family and we are eager to catch a glimpse of your newly modified vehicle. Give us a shout out and let us know how much you love our product. Don't forget, we offer other Belltech related merchandise for you and your vehicle on our website www.belltech.com

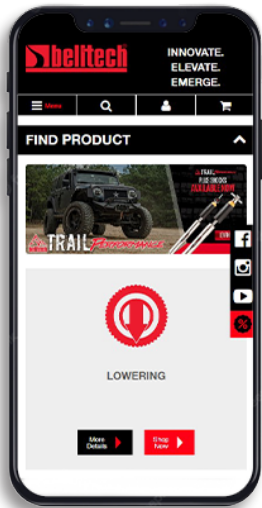

belltechsuspension



Belltech Suspension



@belltechsuspension

If you have any questions, concerns, or warranty related issues regarding your Belltech product, please call or email our experienced customer service specialists.

Belltech Customer Support:

Phone: 1-800-445-3767

Email: info@belltech.com

KIT CONTENTS



Anti-Sway Bar Kit		
Part number	Description	Qty
5575-300	Rear Anti-Sway Bar	1
5575-777	Hardware Kit	1

Hardware Kit (5575-777)		
Part number	Description	Qty
113205	Pivot Bushing	2
5575-004-991	Threaded Support Plate	2
112142	Bolt Ser. Flanged M10x1.5	7
110280	Nut Nylock Flanged M10x1.5	3
115003-95	Zinc Plated Support Bushing	2
112242	Spherical Bearing 3/8" Female	2
112316	Jam Nut 3/8"	2
112108	Bolt 3/8 16x2.5	4
110625	Flat Washer 3/8"	8
110255	Nylon Insert Lock Nut 3/8"	4
112244	Spherical Bearing 3/8" Male	2
5575-003-991	U-Bracket	2
57402-045-954	Bearing Spacer	8
112089	Low-Profile Socket M10x1.5	3
110282	Screw M12x1.75	1
114032-95	Zinc-Plated Bushing Bracket	2
55000-10	Grease Pack	1



INSTALLATION GUIDE

PART NUMBER: 15126
0" TO 4" FRONT LIFT COILOVER KIT
FORD BRONCO | 2021+

300 W. PONTIAC WAY. CLOVIS, CA 93612
PHONE: 800-445-3767 | EMAIL: INFO@BELLTECH.COM

THANK YOU

Thank you for choosing our high quality Belltech product. We have spent a great deal of time developing our line of products so that you will receive maximum performance with minimal difficulty during installation. Soon your vehicle will be on the road looking and feeling much improved.

Please take a moment to read all instructions and warnings prior to installation of your new Belltech product and before operating your vehicle. If you have any questions or concerns regarding any step in the installation process, please do not hesitate to call or email our customer support specialists who are trained to help you through any portion of this process.

Before You Begin:

It is of the utmost importance that you confirm all of the components listed on the parts list is in the kit. You can find this list located on the last page(s) of your instructions. Do not begin installation if any part is missing. Instead, please call our Belltech customer service specialists.

Belltech Customer Support:

Phone: 1-800-445-3767

Email: info@belltech.com

Safety Information:

Warning: Do not work under a vehicle supported only by a jack. Place support stands securely under the vehicle in the manufacturer's specified locations unless otherwise instructed.

Proper use of safety equipment and eye/face/hand protection is absolutely necessary when performing any of the following instructions.

We strive for an exceptional experience for all our valued customers. If for any reason you need assistance with your Belltech products, please do not return the product to the store you purchased from, but rather call our dedicated customer service experts, from 6am to 5pm PST.

We recommend that a qualified mechanic, at a properly equipped facility, perform this installation.

It is very helpful to have an assistant available during installation.

Before Driving Your Vehicle:

It is important to double check all brake hoses, cables, and other components to be sure there is no interference. You must also check for wheel/tire to chassis/body interference. If any issues are found, review your installation instructions to be sure no steps were missed and any problems are corrected.

Make sure your vehicle is aligned immediately following installation.

Check all hardware and re-torque at intervals for the first 10, 100, and 1000 miles.

Some of Belltech's products are designed to improve your vehicle's off-road performance. Leveling/lifting your vehicle may result in an altered center of gravity. It is crucial to use extreme care when operating your vehicle to prevent rollover and/or loss of control.

Any changes in your vehicle's suspension may result in transformed handleability. Please test-drive your vehicle in a remote location so you can become accustomed to the revised driving characteristics.

Perform headlight check and adjustment.

Failure to drive any modified vehicle in a safe manner may result in harm or death.

Never operate your modified vehicle under the influence of drugs, alcohol, or lack of adequate sleep.

Always wear your seatbelt.



DIFFICULTY:

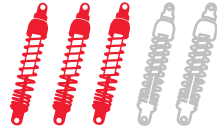

INSTALLATION TIME:

2-4 Hours + Alignment

RECOMMENDED TOOLS:

- Properly rated floor jack
- Support stands
- Wheel chocks
- Metric socket wrench set
- Metric wrench set
- Tape measure
- Marking Pen

SPECIALTY TOOLS:

- High quality spring compressor
- Torque wrench up to 150ft/lbs



Technician note:

Before making any adjustments to your new Belltech coilover, please be sure to loosen the set screw on the lower spring perch. Failure to do so will damage the threads. After the adjustments are made, you may then tighten the set screw to keep the settings in place.



INSTALLATION PREPARATION:

Before beginning the installation process, measure the hub to fender heights for your vehicle and record them in the “Before” section. After your vehicle has been modified, record the new measurements in the, “After” section. This way, you can compare the resulting height to the original. When taking the measurements, measure vertically from the center of the wheel to the inner edge of the fender.

Before:

LF: _____

RF: _____

LR: _____

RR: _____



After:

LF: _____

RF: _____

LR: _____

RR: _____

JACKING, SUPPORTING, AND PREPARING THE VEHICLE

1. Park your vehicle on a smooth, level, concrete or seasoned asphalt surface.
2. Block the rear wheels of the vehicle using wheel chocks. Make sure the vehicle's transmission is in "PARK" (automatic) or 1st gear (manual).
3. Activate the parking brake.
4. Loosen, but do not remove, the front wheel lug nuts.
5. Lift the front of the vehicle off the ground using a properly rated floor jack. Lift the vehicle so the front tires are approximately 6-8 inches off the ground.
6. Place support stands rated for the vehicles weight. The stands should be positioned in the factory specified locations. (Refer to owners manual). Prior to lowering the vehicle onto stands, make sure the support stands will contact the chassis. It is very important that the vehicle is properly supported to prevent any harm to ones self or to the vehicle.
7. Lower the vehicle slowly onto the stands.
8. Remove the front wheels.



Technician reminder:

Never work under a vehicle supported only by a jack. It is necessary to place support stands securely under the vehicle in the manufacturer's specified locations unless otherwise instructed.

OEM STRUT REMOVAL

9. You will need to remove the front anti-sway bar. If your model includes electronic sway bars, it is important to remove the bar extra carefully to prevent damage to any wires or connectors.
10. Using a marking pen, mark the alignment cams to reference placement later.



11. Working on one side at a time, loosen and remove the crossmember bolts that connect the lower control arm and frame.



12. Loosen and remove the nuts securing the lower strut mount to the control arm.



13. Push the spindle and lower control arm down and back until the lower shock studs are clear of the control arm.



OEM STRUT REMOVAL CONTINUED

14. Remove the three nuts securing the top of the strut to the chassis.



STRUT DISASSEMBLY

15. Mount the entire spring/strut assembly in the fixture. To ease the installation of the new strut, mark the position of the top mount in relationship to the upper spring isolator and strut body.
16. Compress the spring until tension is relieved from the strut.



Technician note:

It is important to use a spring compressor to compress the spring before removing the top mount nut. Failure to do so may result in serious injury.



17. Remove top mount. You will use this with your new Belltech coilover later.
18. Remove the upper rubber isolator from the top mount. It will not be reused later.
19. Remove the spring and strut from the fixture.



BELLTECH COILOVER HEIGHT SETUP AND ASSEMBLY

20. The coilover comes as shown below. Remove the nylock nut from the top of the Belltech coilover.

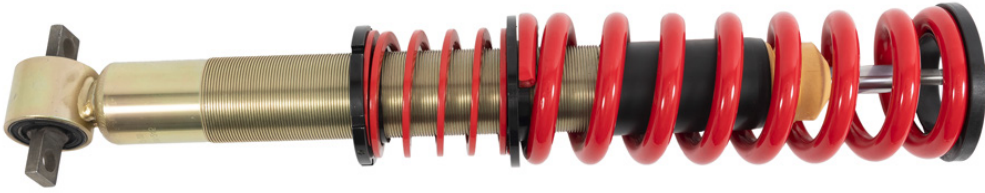

21. Confirm the vent disk is located on the strut, under the dust boot. If for any reason your vent disk is not present, please call our technical support staff before proceeding, as driving on the strut without it could cause the shock to fail.

22. Using the table below as reference, remove the main spring and slide the required packers onto the strut rod.



Technician note:

Belltech uses packers to maintain the correct bump stop engagement at various height ranges. Using the appropriate packer will prevent excessive body roll. If a packer is needed, according to the charts to the right, please place the packer on top of the vent disc, channel side down, as shown by the image below this text box.

2021+ Ford Bronco 4WD	
Lift (Inches)	15mm Packer
0"	0 *1 if using 35" tires
1"	1
2"	2
3"	3
4"	4

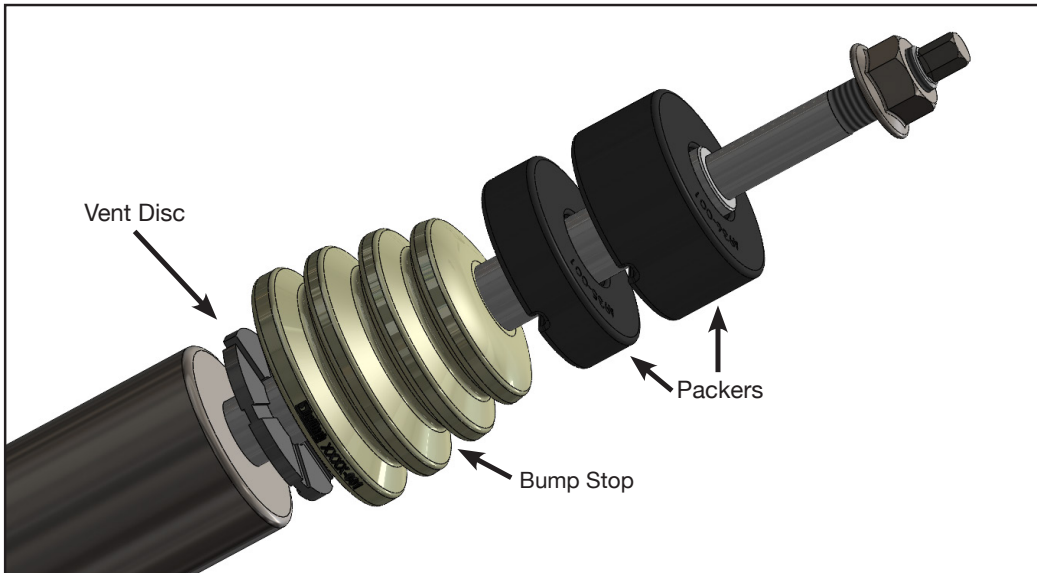

BELLTECH COILOVER HEIGHT SETUP AND ASSEMBLY

23. Loosen the set screw on the spring perch.



24. Using the provided spanner wrench, turn the bottom spring perch to obtain desired spring perch height, measuring from the top of the perch to the center of the bushing. Find the appropriate spring perch height by referencing the table below. We do not recommend adjusting outside of the specified height range, as the performance of the shock may decrease greatly.

2021+ Ford Bronco 4WD	
Lift (Inches)	Perch height (milli-meters/inches)
0"	176mm/6.9in
1"	194mm/7.6in
2"	212mm/8.3in
3"	230mm/9.1in
4"	248mm/9.8in



Technician note:

Your vehicle's exact ride heights may vary due to differences in chassis and trim levels. The perch heights depicted on our tables are a suggested starting point.

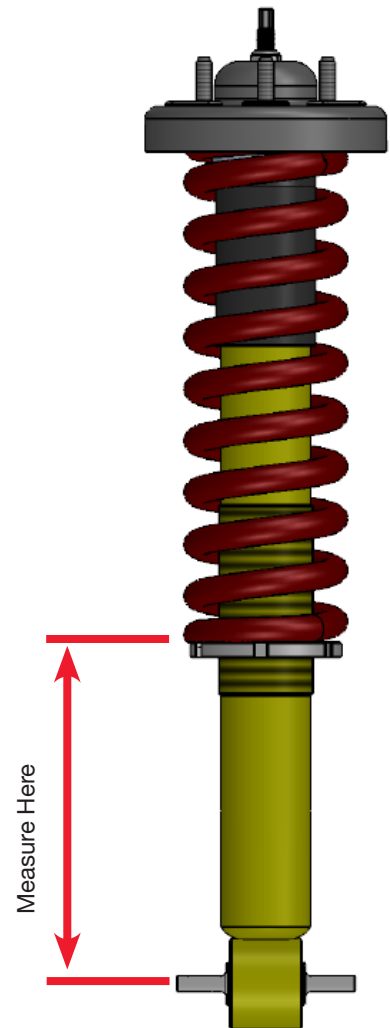

25. Tighten the set screw. Do not over tighten the set screw. Max torque is 1-2 Nm (1.5 ft-lbs.)

26. Assemble the helper spring, intermediate ring, main spring, upper spring seat, and OE top mount onto the Belltech coilover.

27. Reference the OE strut markings and ensure the top mount is oriented in the same direction it was before dis assembly.

28. Torque the supplied Nylock nut onto the strut. Torque to 41 ft-lbs.

COILOVER INSTALLATION

29. Install the top mount into the chassis and secure using the 3 OE nuts. Torque to 41ft-lbs.



30. Attach the lower coilover mount to the lower control arm using the supplied bolts and Nylock nuts. Torque the supplied nuts to 66 ft-lbs.



31. Reattach the lower control arm to the frame using the OE alignment hardware. Do not tighten or torque until your vehicle is back on the ground. Torque to 210 ft-lbs.



32. Set the alignment settings to the markings made before installation.



33. Reinstall the sway bar. The bushing bracket will be torqued to 66 lb.ft and the end link nuts will be torqued to 111 ft-lbs.

FINALIZING THE INSTALLATION

34. Re-install the wheels and tighten the lug nuts.
35. Lift the vehicle and remove the support stands.
36. Carefully lower the vehicle onto the flat ground.
37. Torque the lug nuts to manufacturer's specifications.
38. Check that all components and fasteners have been properly installed and torqued.
39. Re-read and perform all tasks in the "Before Driving Your Vehicle" section of page 1 of your instructions.



belltechsuspension



Belltech Suspension



@belltechsuspension

THANK YOU FOR CHOOSING BELLTECH.

You are now a part of the Belltech family and we are eager to catch a glimpse of your newly modified vehicle. Give us a shout out and let us know how much you love our product. Don't forget, we offer other Belltech related merchandise for you and your vehicle on our website www.belltech.com

If you have any questions, concerns, or warranty related issues regarding your Belltech product, please call or email our experienced customer service specialists.

Belltech Customer Support:

Phone: 1-800-445-3767

Email: info@belltech.com

KIT CONTENTS

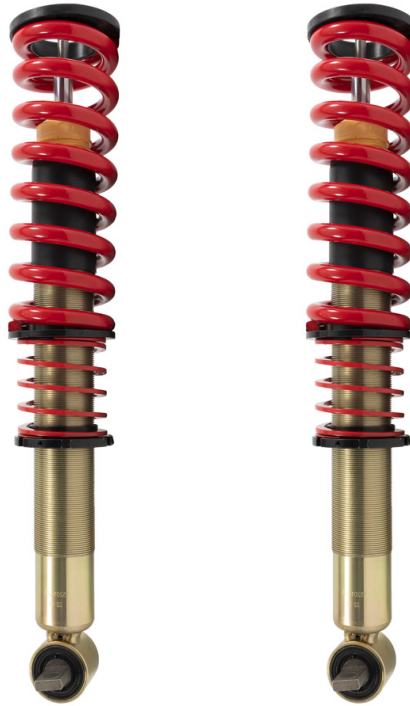

15126		
Part number	Description	Qty
15126-100	Belltech Coilover	2
68510039	Spanner Wrench	1
25007-777	Hardware Kit	2

25007-777 Hardware Kit		
Part number	Description	Qty
112307	Bolt Flanged Hex	2
112308	Flanged Nylock Nut	2

15126-100		
Part number	Description	Qty
152600-003	Upper Spring Adapter	1
65210800	Dust Boot	1
15002105	Vent Disc	1
65210799	Bump Stop	1
4935-001	15mm Packer	4
65050018	Spring Perch	1
15000-013-961	Intermediate Ring	1
4001-001	Helper Spring	1
68320103	Set Screw M5x12	1
15126-245	Threaded Damper	1
76080-400-993	Linear Spring	1



INSTALLATION GUIDE

PART NUMBER: 15129
0" TO 4" REAR LIFT COILOVER KIT
FORD BRONCO 4WD | 2021+

300 W. PONTIAC WAY. CLOVIS, CA 93612
PHONE: 800-445-3767 | EMAIL: INFO@BELLTECH.COM

THANK YOU

Thank you for choosing our high quality Belltech product. We have spent a great deal of time developing our line of products so that you will receive maximum performance with minimal difficulty during installation. Soon your vehicle will be on the road looking and feeling much improved.

Please take a moment to read all instructions and warnings prior to installation of your new Belltech product and before operating your vehicle. If you have any questions or concerns regarding any step in the installation process, please do not hesitate to call or email our customer support specialists who are trained to help you through any portion of this process.

Before You Begin:

It is of the utmost importance that you confirm all of the components listed on the parts list is in the kit. You can find this list located on the last page(s) of your instructions. Do not begin installation if any part is missing. Instead, please call our Belltech customer service specialists.

Belltech Customer Support:

Phone: 1-800-445-3767

Email: info@belltech.com

Safety Information:

Warning: Do not work under a vehicle supported only by a jack. Place support stands securely under the vehicle in the manufacturer's specified locations unless otherwise instructed.

Proper use of safety equipment and eye/face/hand protection is absolutely necessary when performing any of the following instructions.

We strive for an exceptional experience for all our valued customers. If for any reason you need assistance with your Belltech products, please do not return the product to the store you purchased from, but rather call our dedicated customer service experts, from 6am to 5pm PST.

We recommend that a qualified mechanic, at a properly equipped facility, perform this installation.

It is very helpful to have an assistant available during installation.

Before Driving Your Vehicle:

It is important to double check all brake hoses, cables, and other components to be sure there is no interference. You must also check for wheel/tire to chassis/body interference. If any issues are found, review your installation instructions to be sure no steps were missed and any problems are corrected.

Make sure your vehicle is aligned immediately following installation.

Check all hardware and re-torque at intervals for the first 10, 100, and 1000 miles.

Some of Belltech's products are designed to improve your vehicle's off-road performance. Leveling/lifting your vehicle may result in an altered center of gravity. It is crucial to use extreme care when operating your vehicle to prevent rollover and/or loss of control.

Any changes in your vehicle's suspension may result in transformed handleability. Please test-drive your vehicle in a remote location so you can become accustomed to the revised driving characteristics.

Perform headlight check and adjustment.

Failure to drive any modified vehicle in a safe manner may result in harm or death.

Never operate your modified vehicle under the influence of drugs, alcohol, or lack of adequate sleep.

Always wear your seatbelt.



DIFFICULTY:

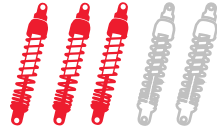

INSTALLATION TIME:

2-4 Hours + Alignment

RECOMMENDED TOOLS:

- Properly rated floor jack
- Support stands
- Wheel chocks
- Metric socket wrench set
- Metric wrench set
- Tape measure
- Marking Pen

SPECIALTY TOOLS:

- High quality spring compressor
- Torque wrench up to 350ft/lbs



Technician note:

Before making any adjustments to your new Belltech coilover, please be sure to loosen the set screw on the lower spring perch. Failure to do so will damage the threads. After the adjustments are made, you may then tighten the set screw to keep the settings in place.



INSTALLATION PREPARATION:

Before beginning the installation process, measure the hub to fender heights for your vehicle and record them in the “Before” section. After your vehicle has been modified, record the new measurements in the, “After” section. This way, you can compare the resulting height to the original. When taking the measurements, measure vertically from the center of the wheel to the inner edge of the fender.

Before:

LF: _____

RF: _____

LR: _____

RR: _____



After:

LF: _____

RF: _____

LR: _____

RR: _____

JACKING, SUPPORTING, AND PREPARING THE VEHICLE

1. Park your vehicle on a smooth, level, concrete or seasoned asphalt surface.
2. Block the front wheels of the vehicle using wheel chocks. Make sure the vehicle's transmission is in "PARK" (automatic) or 1st gear (manual).
3. Activate the parking brake.
4. Loosen, but do not remove, the rear wheel lug nuts.
5. Lift the rear of the vehicle off the ground using a properly rated floor jack. Lift the vehicle so the front tires are approximately 6-8 inches off the ground.
6. Place support stands rated for the vehicles weight. The stands should be positioned in the factory specified locations. (Refer to owners manual). Prior to lowering the vehicle onto stands, make sure the support stands will contact the chassis. It is very important that the vehicle is properly supported to prevent any harm to ones self or to the vehicle.
7. Lower the vehicle slowly onto the stands.
8. Remove the rear wheels.



Technician reminder:

Never work under a vehicle supported only by a jack. It is necessary to place support stands securely under the vehicle in the manufacturer's specified locations unless otherwise instructed.

OEM STRUT REMOVAL

9. Remove the rear fender liners using a Philips screw driver. There will be 10 clips and 3 screws holding each liner in place.



10. Support the axle with a jack.
11. Remove lower strut bolts with a 27mm socket.



12. Remove upper strut bolts with a 15mm wrench.

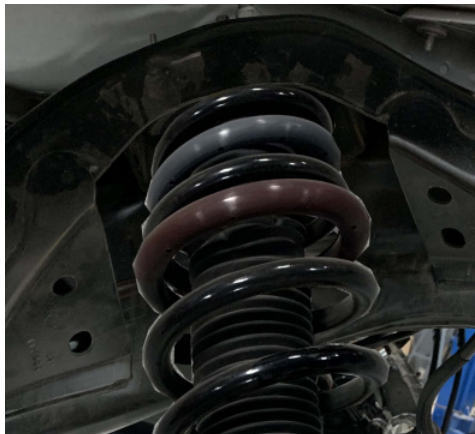

13. Remove the strut from the vehicle.



STRUT DISASSEMBLY

14. Mount the entire spring/strut assembly in the fixture. To ease the installation of the new strut, mark the position of the top mount in relationship to the upper spring isolator and strut body.
15. Compress the spring until tension is relieved from the strut.



Technician note:

It is important to use a spring compressor to compress the spring before removing the top mount nut. Failure to do so may result in serious injury.



16. Remove top mount. You will use this with your new Belltech coilover later.
17. Remove the rubber upper spring isolator from the OE top mount. This will not be reused.
18. Remove the spring and strut from the fixture.



BELLTECH COILOVER HEIGHT SETUP AND ASSEMBLY

19. The coilover comes as shown below. Remove the Nylock nut from the top of the Belltech coilover to proceed.



20. Confirm the vent disk is located on the strut, under the dust boot. If for any reason your vent disk is not present, please call our technical support staff before proceeding, driving on the strut without it could cause premature shock to failure.

21. Using the table below as reference, remove the main spring and slide the required packers onto the strut rod.



Technician note:

Belltech uses packers to maintain the correct bump stop engagement at various height ranges. Using the appropriate packer will prevent excessive body roll. If a packer is needed, according to the charts to the right, please place the packer on top of the vent disc, channel side down, as shown by the image below this text box.

2021+ Ford Bronco 4WD	
Lift (Inches)	15mm Packer
0"	0 *1 if using 35" tires
1"	1
2"	2
3"	3
4"	4

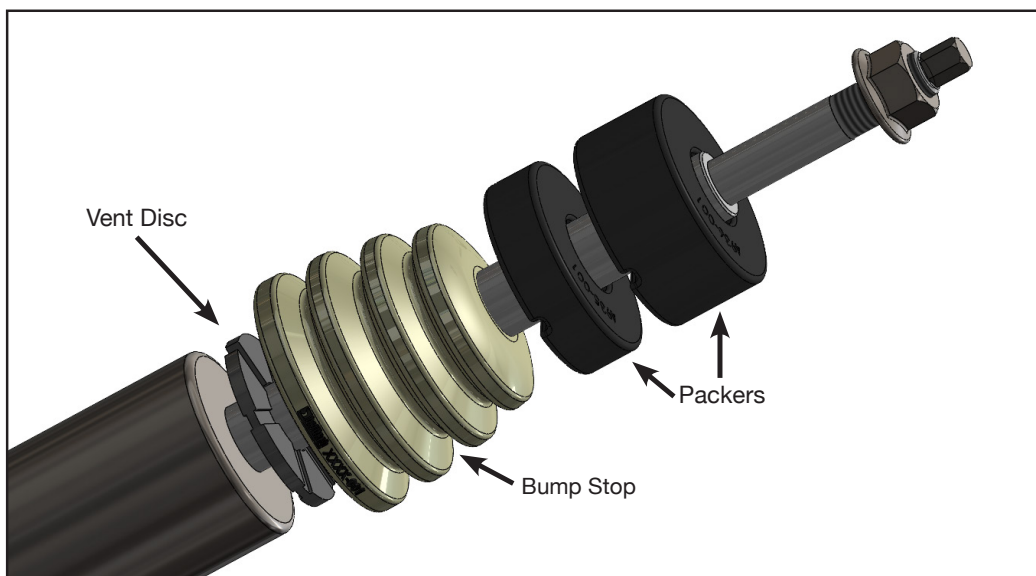

BELLTECH COILOVER HEIGHT SETUP AND ASSEMBLY

23. Loosen the set screw on the spring perch.



23. Using the provided spanner wrench, turn the bottom spring perch to obtain desired spring perch height, measuring from the top of the perch to the center of the bushing. Find the appropriate spring perch height by referencing the table below. We do not recommend adjusting outside of the specified height range, as the performance of the shock may decrease greatly.

2021+ Ford Bronco 4WD	
Lift (Inches)	Perch height (milli-meters/inches)
0"	176mm/6.9in
1"	194mm/7.6in
2"	212mm/8.3in
3"	230mm/9.1in
4"	248mm/9.8in



Technician note:

Your vehicle's exact ride heights may vary due to differences in chassis and trim levels. The perch heights depicted on our tables are a suggested starting point.

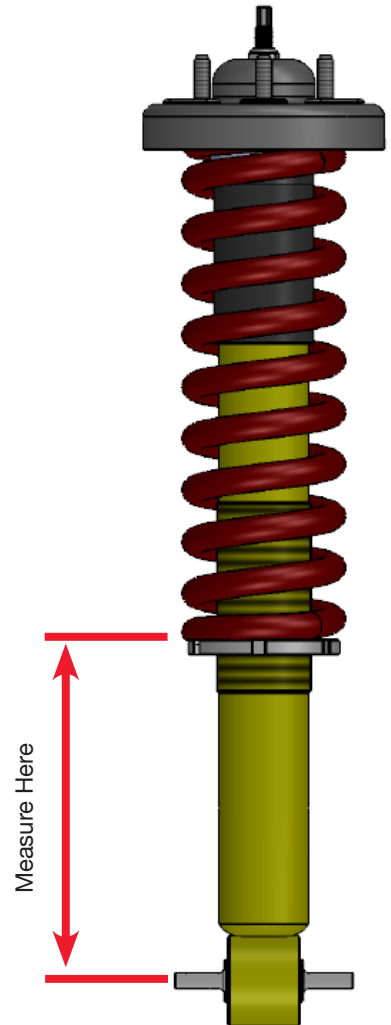

- 25. Tighten the set screw. Do not over tighten the set screw. Max torque is 1-2 Nm (1.5 ft-lbs.)
- 26. Assemble the helper spring, intermediate ring, main spring, upper spring seat, and OE top mount onto the Belltech coilover.
- 27. Reference the OE strut markings and ensure the top mount is oriented in the same direction it was before dis assembly.
- 28. Torque the supplied Nylock nut onto the strut. Torque to 41 ft-lbs.

STRUT INSTALLATION

26. Install the Belltech coilover into the chassis strut tower and secure the 3 OE nuts with a 15mm wrench. Torque to 41 lb.ft.



27. Reattach the lower strut bolts with a 27mm socket and torque to 350 lb.ft.



28. Remove the jack that was supporting the axle.

29. Replace the rear fender liners using a Philips head screw driver.



FINALIZING THE INSTALLATION

31. Re-install the wheels and tighten the lug nuts.
32. Lift the vehicle and remove the support stands.
33. Carefully lower the vehicle onto the flat ground.
34. Torque the lug nuts to manufacturer's specifications.
35. Check that all components and fasteners have been properly installed and torqued.
36. Re-read and perform all tasks in the "Before Driving Your Vehicle" section of page 1 of your instructions.



belltechsuspension



Belltech Suspension



@belltechsuspension

THANK YOU FOR CHOOSING BELLTECH.

You are now a part of the Belltech family and we are eager to catch a glimpse of your newly modified vehicle. Give us a shout out and let us know how much you love our product. Don't forget, we offer other Belltech related merchandise for you and your vehicle on our website www.belltech.com

If you have any questions, concerns, or warranty related issues regarding your Belltech product, please call or email our experienced customer service specialists.

Belltech Customer Support:

Phone: 1-800-445-3767

Email: info@belltech.com

KIT CONTENTS



15129		
Part number	Description	Qty
15129-100	Belltech Rear Coilover	2
68510039	Spanner Wrench	1

15129-100		
Part number	Description	Qty
15129-245	Threaded damper	1
4001-001	Helper Spring	1
76060-400-993	Linear Spring	1
15002105	Vent Disc	1
65210799	Bump Stop	1
65210800	Dust Boot	1
4935-001	15mm Packer	1
4936-001	25mm Packer	3
152600-003	Upper Spring Adapter	1
68320103	Set Screw	1
15000-013-961	Intermediate Ring	1
65050018	Threaded Spring Perch	1