



1999-2006 Dodge Ram 5.9L Cummins **LOW FUEL PRESSURE ALARM LIGHT**

- Installation Manual -

Part Number Sequence:

1081130	Red
1081133	Amber

NOTE: If this kit is being installed in conjunction with a BD X-Monitor or Cool Engine Shutdown (CES) and you wish to split the power connection off of the control module, order part # 1801119 for a Y-wire.

***PLEASE READ ALL INSTRUCTIONS BEFORE INSTALLATION.
Please read the disclaimer before proceeding to install this unit.***

BD Engine Brake Inc.

Plant Address: Unit A10, 33733 King Rd, Abbotsford, BC, Canada V2S 7M9

U.S. Shipping Address: 88-446 Harrison St, Sumas, WA 98295 U.S. Mailing Address: P.O. Box 231, Sumas, WA 98295

Phone: 604-853-6096 Fax: 604-853-8749 Internet: www.bd-power.com

Introduction

The purpose of this kit is to indicate to the driver with the red/amber LED, if the supply fuel pressure of the VP44 injection pump is dropping below 5psi. Also note that damage may result to the VP44 if it is starved for fuel. If you are finding that your existing setup cannot supply enough fuel for the VP44, you may want to look at some additional kits to protect your system.

On newer ISBe engines the purpose of the kit is to alarm the driver once the fuel pressure drops below 5psi, indicating that an auxiliary pusher pump is needed. For safety anything over about 400 HP will need an auxiliary pusher pump.

Reasons For Low Supply Pressures

- *Plugged filter*
- *Plugged fuel tank pickup*
- *Weak or dead factory lift pump*
- *Too much demand and not enough supply (High horsepower)*

Available Accessories

- *BD High flow banjo bolts (gains of > psi fuel pressure)*
- *BD High flow auxiliary lift pump kit (gains of 15psi, supports +500HP)*

Kit Contents

Part Number	Description	Qty.
1801130	5psi Pressure Switch	1
108112x *	LED Assembly w/ 2 pc. Bezel	1
1300353	Female Blade Connector	1
1300337	Mini-Fuse Tapper	1
2-520334-2	Flag Connector (for use with mini-fuse tapper)	1
1502017	Tapped Banjo Bolt (<i>2000+ Dodges only</i>)	1
1502019	Sealant Washer	2

**Depending on which color LED you have, the "x" in the LED number will be "1" – Red or "3" – Amber*

BD Engine Brake Inc.

Plant Address: Unit A10, 33733 King Rd, Abbotsford, BC, Canada V2S 7M9

U.S. Shipping Address: 88-446 Harrison St, Sumas, WA 98295 U.S. Mailing Address: P.O. Box 231, Sumas, WA 98295

Phone: 604-853-6096 Fax: 604-853-8749 Internet: www.bd-power.com

Installation

1. Disconnect the battery terminals before starting installation.
2. Find an installation point for the LED and bezel assembly. Typically, a close proximity to the optional X Monitor or auxiliary gauges is a good idea or even somewhere visible. Use a ¼" drill bit to drill a hole for the bezel and LED to fit into.

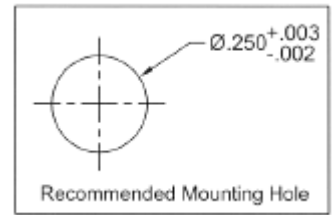

IT IS CRITICAL THAT YOU CORRECTLY DRILL THE ¼" PERFECTLY 90° OR PERPENDICULAR TO THE DRILLING SURFACE.

3. Insert LED & wiring assembly through the ¼" hole, route the black and red wire first and pull the entire six feet through. Before inserting and locking the LED bezel in the hole, place a small amount of silicone on the bezel. Now firmly insert the LED bezel as it should lock in place. The silicone should lock the bezel in place and resist any movement from vibration.
4. Route the Red 18ga wire to 12V switched power, a supplied fuse tapper is provided for easy installation in the factory fuse panel. An accessory fuse is adequate, as the LED will draw less than 0.5 Amp. Use a 90° pink flag connector (supplied) for a much easier installation.
5. You will need to locate the appropriate fuel port for your application. Please note that closer to the actual injection or high pressure pump the better. Use the new supplied sealing washer to ensure a tight seal and eliminate any fuel leaks. Note factory torque specs are 18 ft-lbs for the banjo bolt.
 - a. On 1998-99 model year ISB trucks, there will be a 1/8" NPT test port located on the fuel filter cap. Unscrew the cap closest to the engine and thread in the pressure switch.

BD Engine Brake Inc.

Plant Address: Unit A10, 33733 King Rd, Abbotsford, BC, Canada V2S 7M9

U.S. Shipping Address: 88-446 Harrison St, Sumas, WA 98295 U.S. Mailing Address: P.O. Box 231, Sumas, WA 98295

Phone: 604-853-6096 Fax: 604-853-8749 Internet: www.bd-power.com

- b. On later 2000-2002 ISB trucks, thread the supplied banjo bolt into the inlet of the VP44; you'll need to remove the factory Schrader valve.
 - c. On 2003+ ISBe HPCR engines you will need to use the supplied banjo bolt to replace the factory front most banjo bolt located directly on the side of the CP3 pump. To locate this bolt just follow the larger fuel supply line from the fuel filter.
6. With the supplied 5psi pressure switch, coat the threads with liquid pipe sealant or Teflon tape and install into the fuel pressure port. Be careful not to contaminate the fuel system with using too much tape or sealant.
 7. Now route the black 18 AWG wire through the firewall into the engine compartment and attach the supplied female blade connector. Slide the blade connector onto the male blade connector on the back of the pressure switch.
 8. Start the truck and check for leaks around the pressure switch.
 9. To verify operation the LED should light for a brief second before the truck is started.

The theory behind the unit is that the pressure switch will provide a ground when the fuel pressure drops below 5 psi. With 12 volts supplied through the LED, a ground now supplied, the LED will illuminate warning the driver.

1998½-2002 VP44 Engines

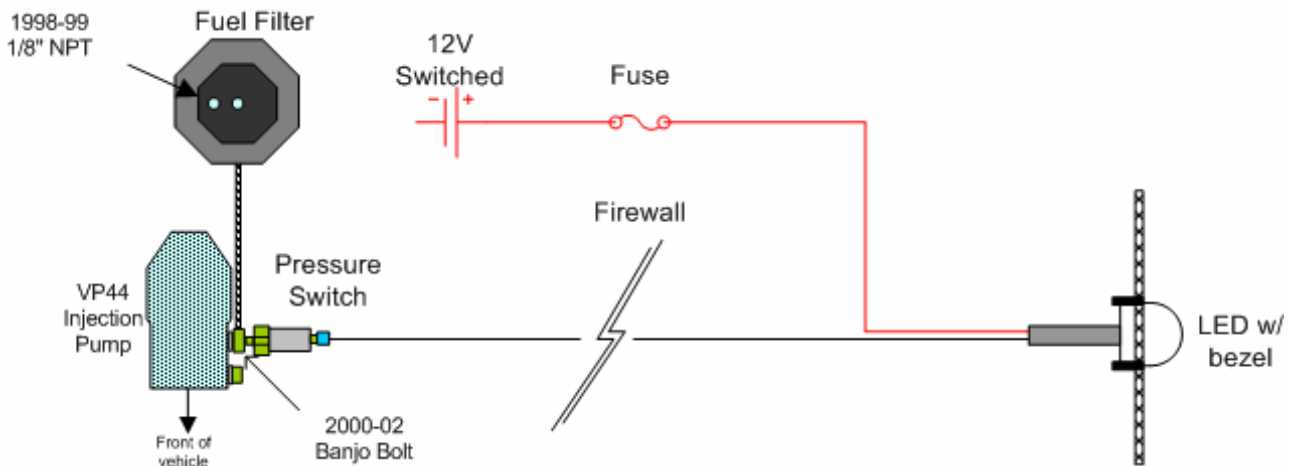

2003+ HPCR Engines

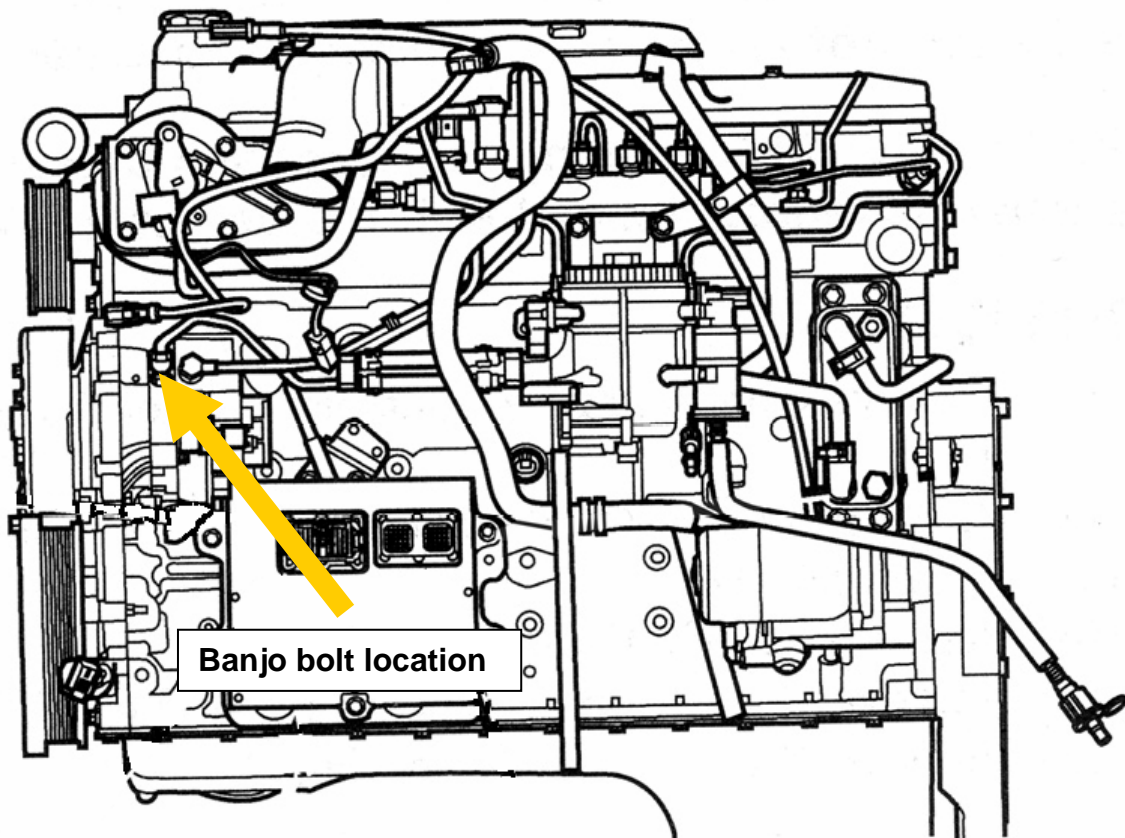

If you have any technical problems or concerns, please give our Technical Support hotline a call at (800) 887-5030, Monday to Friday, 8:30am-4:30pm, Pacific Standard Time (PST).

BD Engine Brake Disclaimer of Liability

Other than as expressly set forth herein, BD ENGINE BRAKE, Inc. (hereafter collectively, "SELLER"), together with its distributors, jobbers and dealers shall in no way be responsible for the PRODUCT'S proper use and service. In no event shall SELLER be liable for any special, incidental, indirect or consequential damages of any kind or nature, whether or not BUYER was advised of the possibility of damage, arising or resulting from the use or performance of the PRODUCT, and BUYER hereby waives any and all such claims.

BUYER acknowledges that he/she/it is not relying on SELLER'S skill or judgment to select or furnish goods suitable for any particular purpose and that SELLER has no liability that will extend beyond the scope of the limited warranty contained herein, and BUYER hereby waives all remedies or liabilities, expressed or implied, arising by operation of law or otherwise, (including, without limitation, any obligations of SELLER with respect to fitness for any particular purpose; merchantability; and special, incidental, indirect or consequential damages) or whether or not occasioned by SELLER'S negligence.

SELLER disclaims any warranty and expressly disclaims any liability for personal injury or damages related to BUYER'S use of the PRODUCT. BUYER acknowledges and agrees that the disclaimer of any liability for personal injury is a material term for this agreement and BUYER agrees to indemnify SELLER and hold SELLER harmless from any claim related to the PRODUCT and its use or performance. Under no circumstances will SELLER be liable for any damages, liabilities, costs or expenses incurred as a result of by reason of the use, performance or sale of the PRODUCT, including, without limitation, any damages, liabilities, costs or expenses incurred by reason of BUYER'S negligence related to those uses of the PRODUCT.

SELLER assumes no liability regarding the improper installation or misapplication of the PRODUCT. It is the installer's responsibility to check for proper installation, and, if in doubt, contact the manufacturer.

LIMITATION OF WARRANTY

SELLER hereby provides the following limited warranty as to description, quality, merchantability, fitness for any product's purpose, productiveness, or any other matter of SELLER'S product sold herewith. The SELLER shall be in no way responsible for the product's open use and service and the BUYER hereby waives all rights other than those expressly written herein. This Warranty shall not be extended or varied except by a written instrument signed by SELLER and BUYER.

The Warranty is Limited to one (1) year from the date of sale and limited solely to the parts contained within the product's kit. All products that are in question of Warranty must be returned shipping prepaid to the SELLER and must be accompanied by a dated proof of purchase receipt. All Warranty claims are subject to approval by BD ENGINE BRAKE, Inc.

Under no circumstances shall the SELLER be liable for any labor charged or travel time incurred in diagnosis for defects, removal, or reinstallation of this product, or any other contingent expenses.

Under no circumstances will the SELLER be liable for any damage or expenses insured by reason of the use or sale of any such equipment.

IN THE EVENT THAT THE BUYER DOES NOT AGREE WITH THIS AGREEMENT: THE BUYER MAY PROMPTLY RETURN THIS PRODUCT, IN A NEW AND UNUSED CONDITION, WITH A DATED PROOF OF PURCHASE, TO THE PLACE OF PURCHASE WITHIN THIRTY (30) DAYS FROM DATE OF PURCHASE FOR A FULL REFUND. THE INSTALLATION OF THIS PRODUCT INDICATES THAT THE BUYER HAS READ AND UNDERSTANDS THIS AGREEMENT AND ACCEPTS ITS TERMS AND CONDITIONS.

BD Engine Brake Inc.

Plant Address: Unit A10, 33733 King Rd, Abbotsford, BC, Canada V2S 7M9

U.S. Shipping Address: 88-446 Harrison St, Sumas, WA 98295 U.S. Mailing Address: P.O. Box 231, Sumas, WA 98295

Phone: 604-853-6096 Fax: 604-853-8749 Internet: www.bd-power.com