

# A.C. COMPRESSOR MOUNT 123R

**Small block Chevy, Long water pump  
Passenger side - wide mount.**

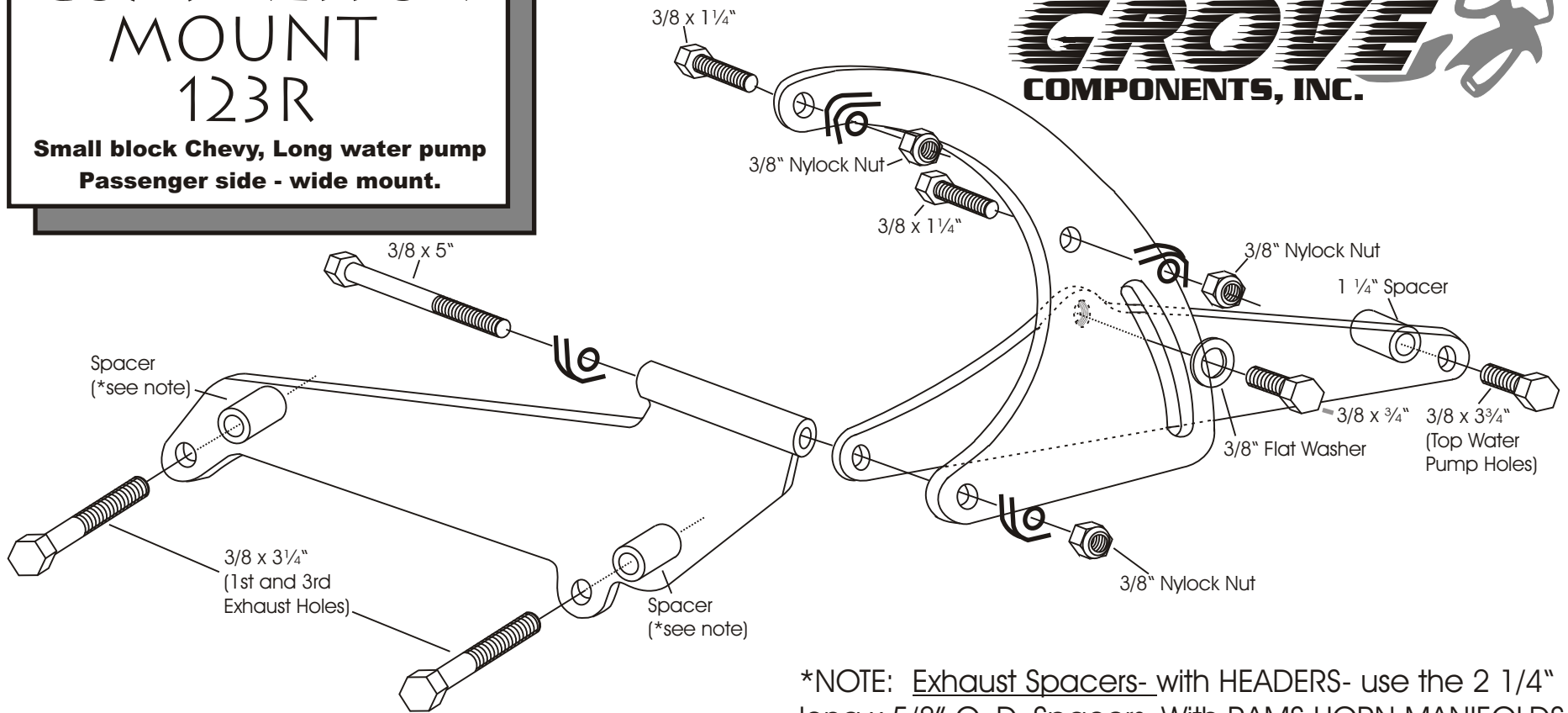

The compressor belt will run in the outer grooves of the crank and water pump pulleys originally used for the factory alternator. It was designed to be used with our 223L Driver's Side Alternator Mount.

We use a belt length of 60-61" with this mount on installations in our shop. However; this can vary with the diameter of your pulleys.

**\*NOTE:** Exhaust Spacers- with HEADERS- use the 2 1/4" long x 5/8" O. D. Spacers. With RAMS HORN MANIFOLDS use the 1/4" long x 3/4" O. D. Spacer at rear hole of bracket and a 1 1/16" long x 3/4" O. D. Spacer at front hole of bracket. With the later DROP-TYPE manifolds use the 1 1/16" long x 3/4" O. D. spacers at both bracket holes. As with any mount system, assemble all of the brackets to engine BEFORE TIGHTENING THE BOLTS.

**As with any part of this nature, make sure it fits your application before painting or plating.**

A.C.  
COMPRESSOR  
MOUNT  
123R

**Small block Chevy, Long water pump  
Passenger side - wide mount.**

**ALAN GROVE COMPONENTS, INC.  
27070 METCALF ROAD  
LOUISBURG, KS 66053**