

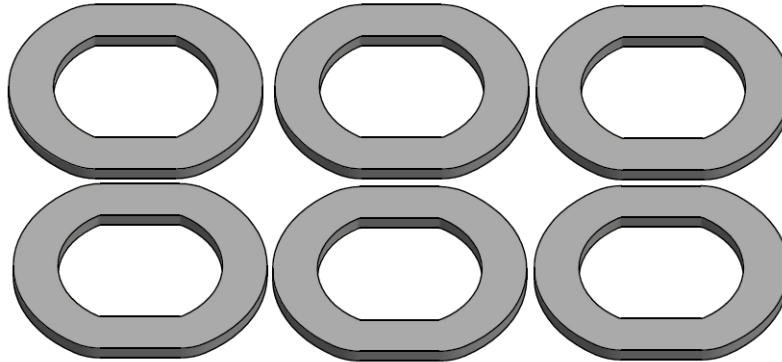

# INSTALLATION INSTRUCTIONS

**Part #6480**  
**Body Mount Repair**  
**1973-1987 GM Trucks**

UMI Performance Inc,  
509 Hemlock Street  
Philipsburg, PA 16866  
814-343-6315  
support@umiperformance.com



## Applications

1973-1987 GM Trucks, Suburban, Blazer  
1988-1991 GM Suburban/Blazer 2wd

### Notes

Welding Required  
Cutting/Drilling Required

## Included Parts

Part #	Quantity	Description
6480A	6	Body Mount Repair

## Installation

1. Body Repair Washer is cut to fit the factory mount for the Front Core Support, Front Cab Mount, and Rear Cab Mount. This is a common rust area for 73-91 GM Trucks
2. Gain Access to the rusted body mount by removing the Cab or Core support.
3. Use the Repair mount as a template to layout the area to be cut. The flats on the mounts are perpendicular (90 degree) to the frame.
4. Cut the frame until the repair piece fits flush on the top side of the frame.
5. Tack weld the mount and check correct location with the cab or core support. There is some tolerance for fitment, but it is a good idea to confirm dimensions before final welding
6. Once fitment is good, final weld the body repair piece
7. Grind the weld on the top side flush

8. Paint the repaired area to prevent future rust.



Chassis Dimensions can be found online. Measurements are provided for each body mount location. Front body and Cab mounts are same for Short bed and Long bed trucks

[http://www.73-87chevytrucks.com/techinfo/chassis/Chassis\\_dim4.jpg](http://www.73-87chevytrucks.com/techinfo/chassis/Chassis_dim4.jpg)

**UMI Performance**  
**6480**  
Body Mount Repair

509 Hemlock Street  
Philipsburg, PA 16866  
814.343.6315

***Proudly made in the U.S.A***

#### Warranty Information

UMI Performance warrants all UMI Performance products for a period of two (2) years from the original date of purchase.

This warranty is valid against defects in materials and workmanship for the two (2) year warranty period. It is not valid against defect resulting from, but not limited to: Misuse and/or abuse, neglect or accident, Exceeding the item's design limits, improper installation. Acts of God, including lightning, floods, earthquakes, fire or high winds. Damage in handling, including damage encountered during shipment.

This warranty is valid for the original purchaser of the UMI Product. Warranty is not transferable or valid for second ownership.

This warranty shall be considered void if the warranted product is in any way altered, adjusted, tampered with or defaced.

The two (2) year warranty does not apply to normal wear and tear (the gradual deterioration of an asset which results naturally from use and/or age, i.e. bearings, bushings, etc.).

Non UMI manufactured parts are not covered or valid under this UMI Performance warranty. UMI Performance cannot guarantee compatibility or performance of its products with other components used in conjunction with UMI Performance products.

UMI Performance cannot assume responsibility for any damages to UMI Products nor for claims for personal injury or property damage resulting from the use of UMI Performance products or the improper operation thereof or consequential damages arising from the products or use of the products.

UMI Performance two (2) year warranty excludes incidental charges incurred by the end user in the event of breakage (towing, labor, installation, etc.). By their very nature, competition suspension parts are continuously expected to exceed to their limits (either by race or road use). UMI suspension components are designed to withstand intense race conditions, although it is impossible to control the quality of installation or the varying conditions in which they are used.

This warranty supersedes all other warranties and may only be modified by statement in writing, signed by UMI Performance owners/principals.

All Warranties implied by law, including the warranties of merchantability and fitness for a particular purpose, are hereby limited to the warranty period herein and shall expire at the end of such period.