

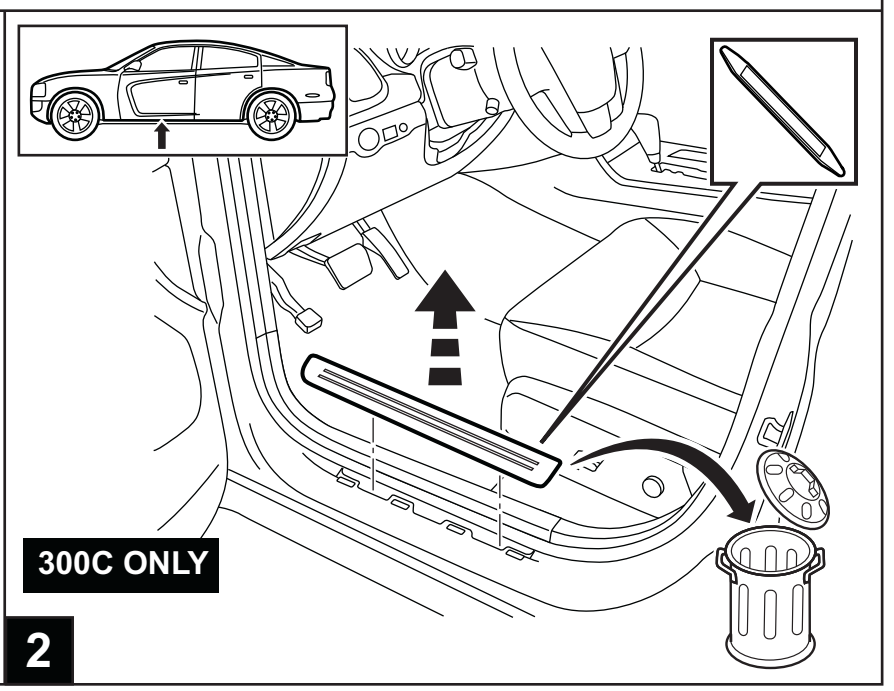

# DODGE CHARGER CHRYSLER 300 Illuminated Sill Plates

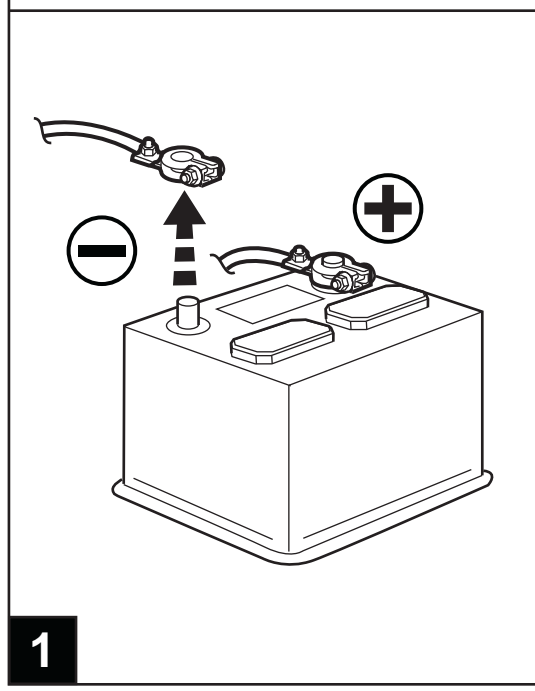

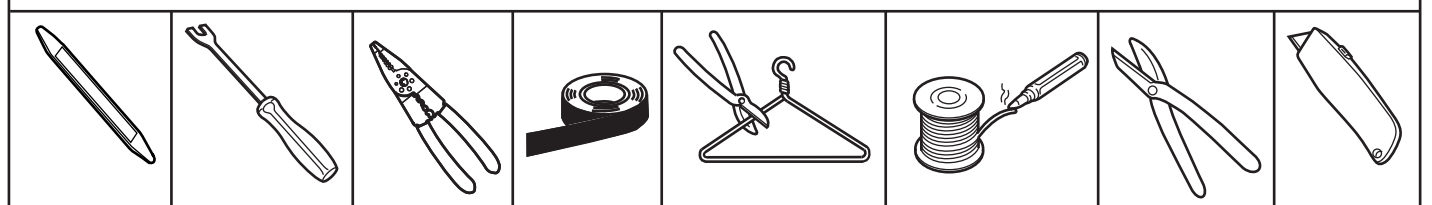

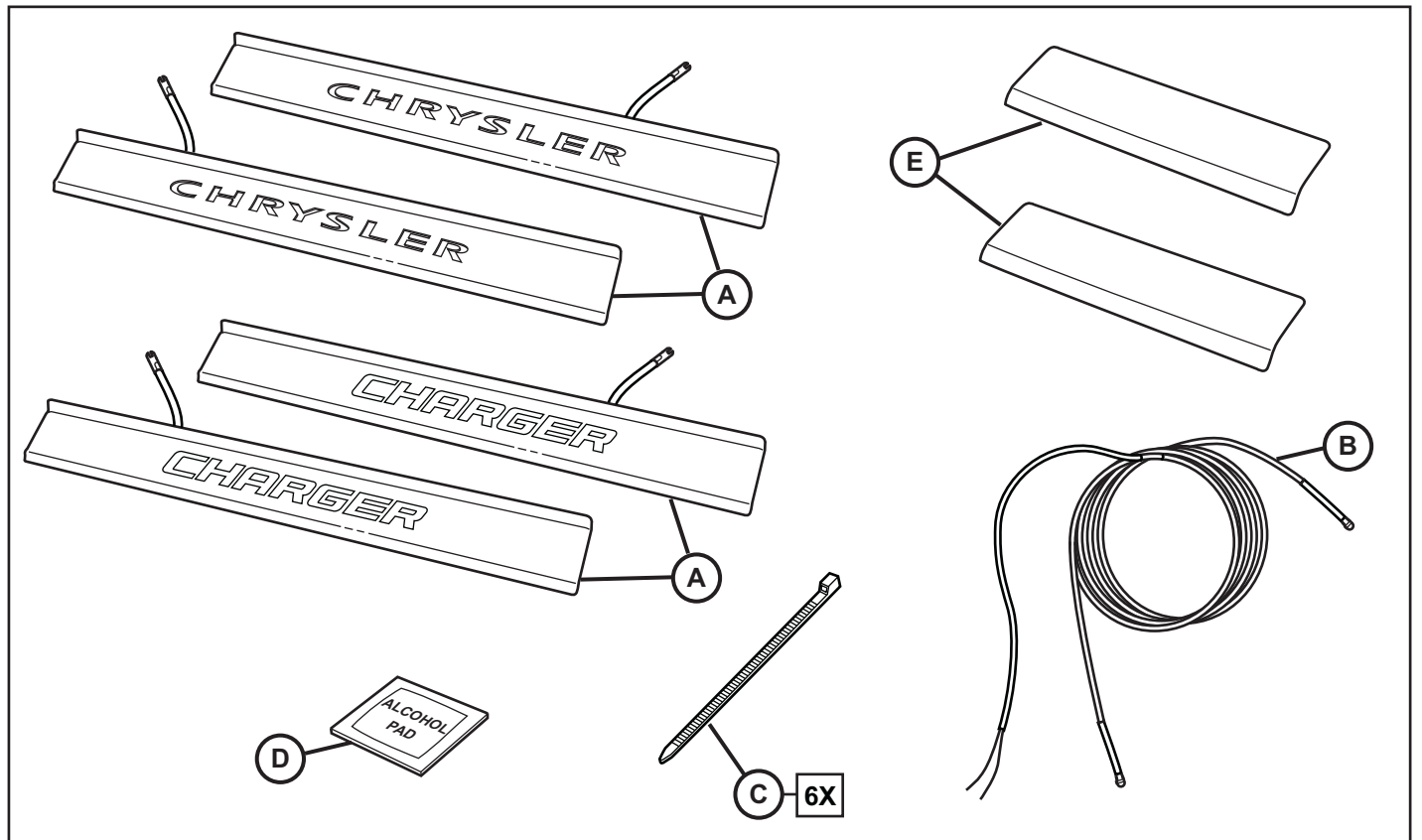
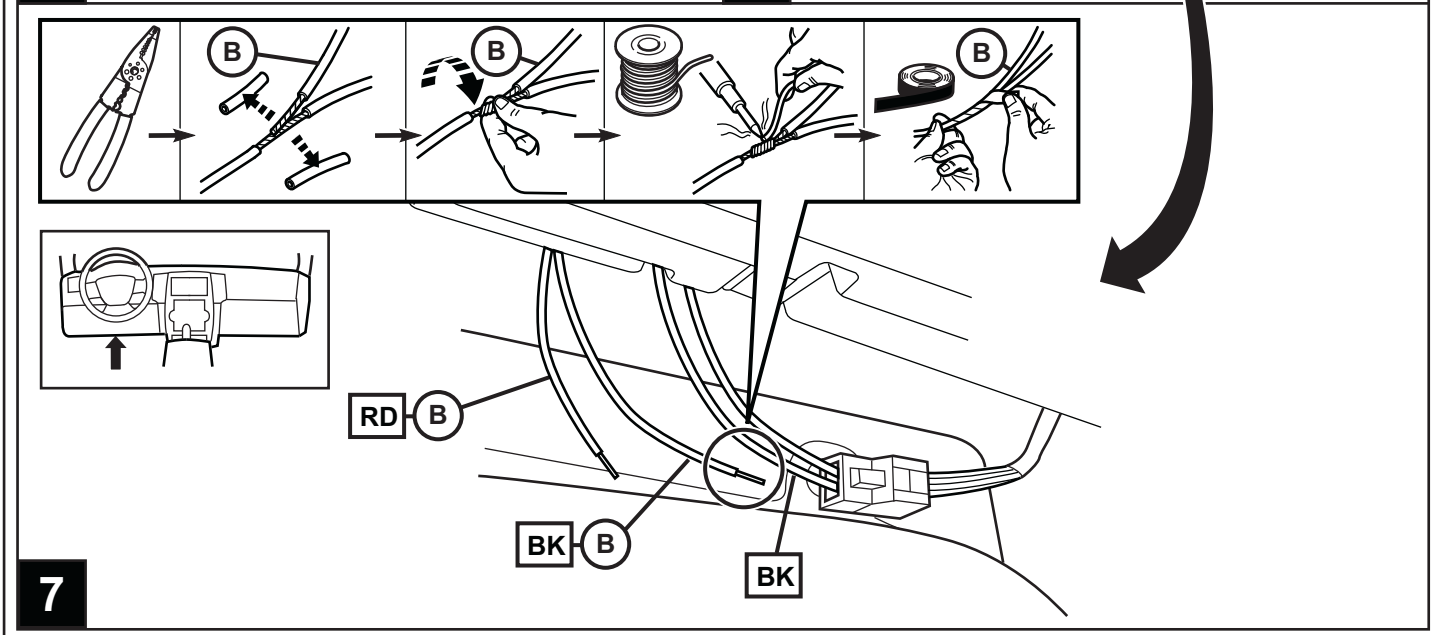
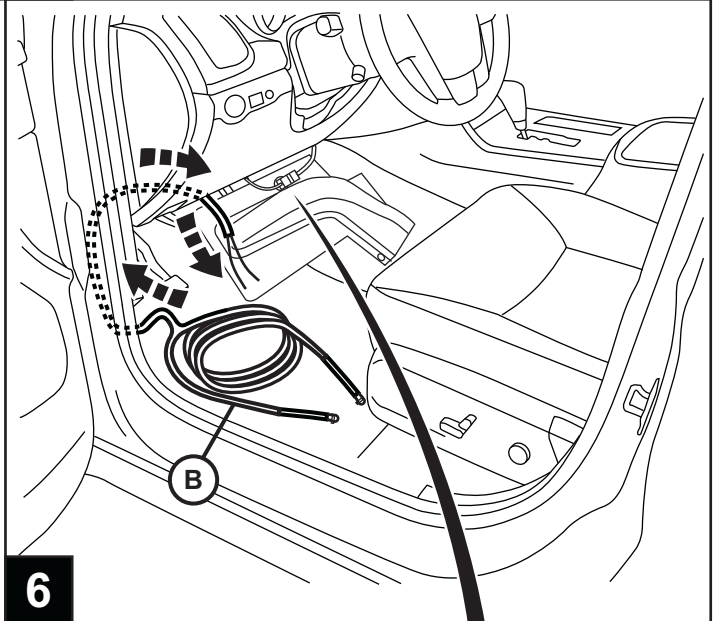
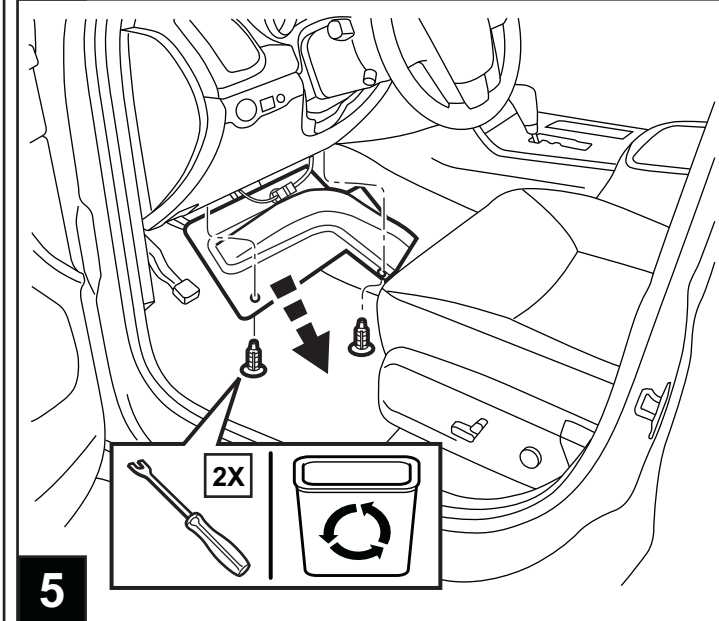
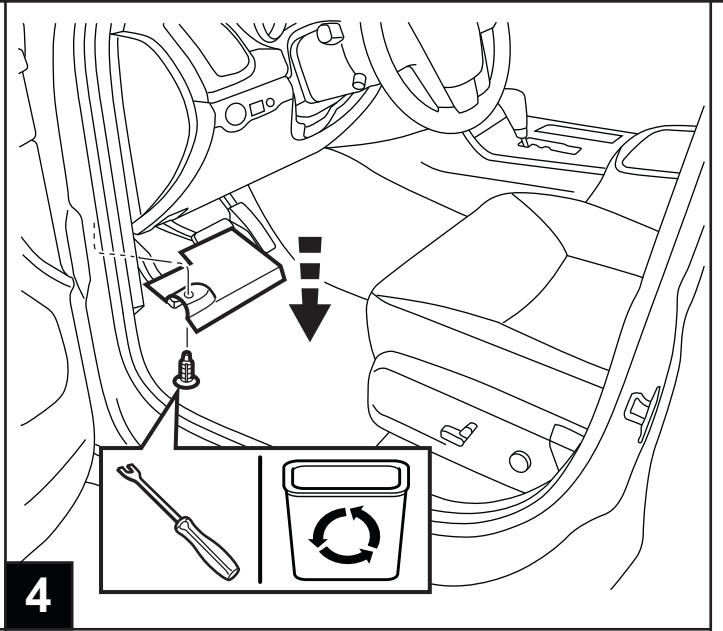
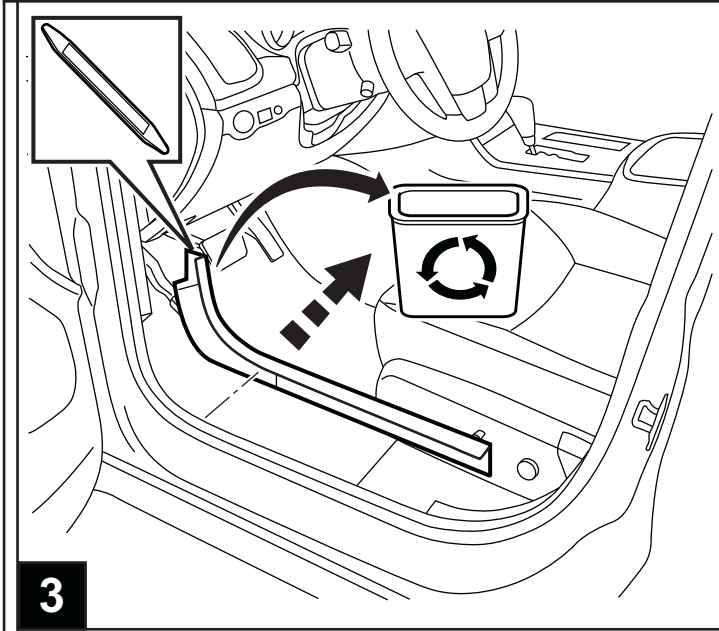
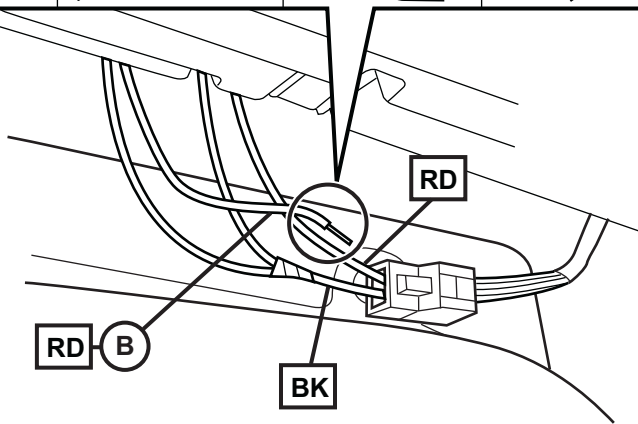
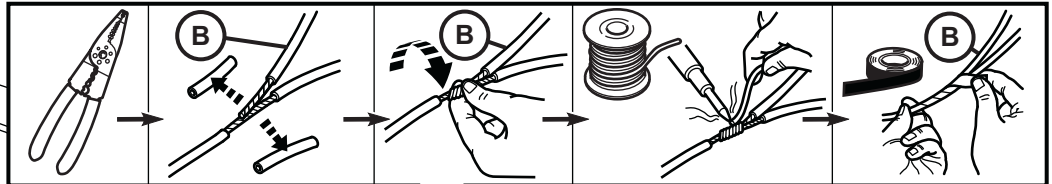
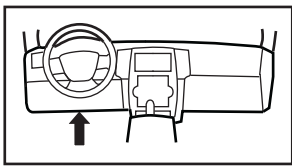

8

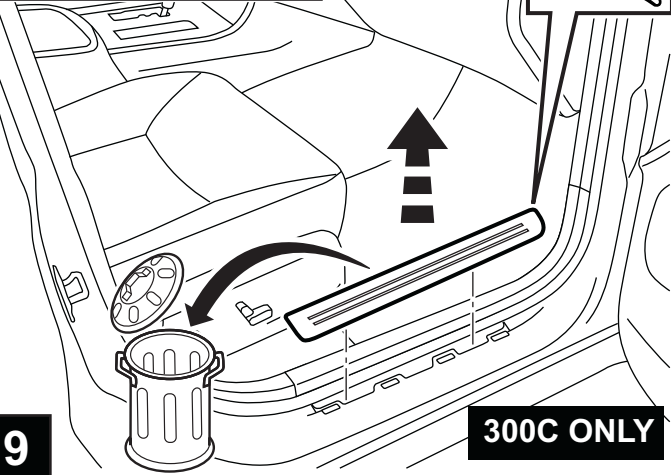
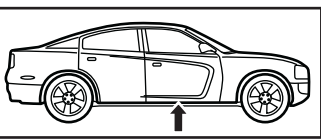

9

300C ONLY

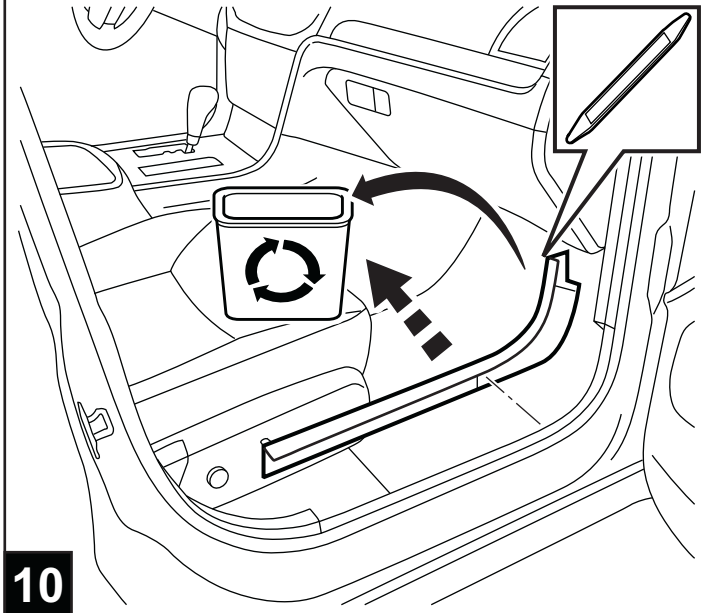

10

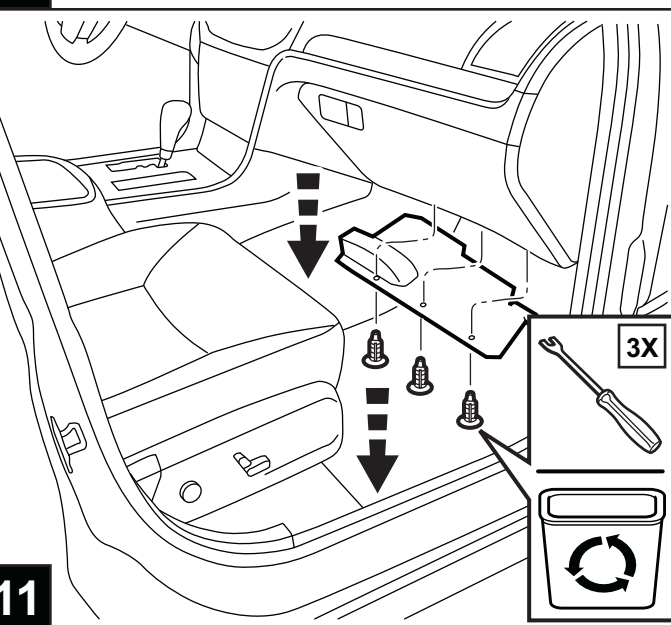

11

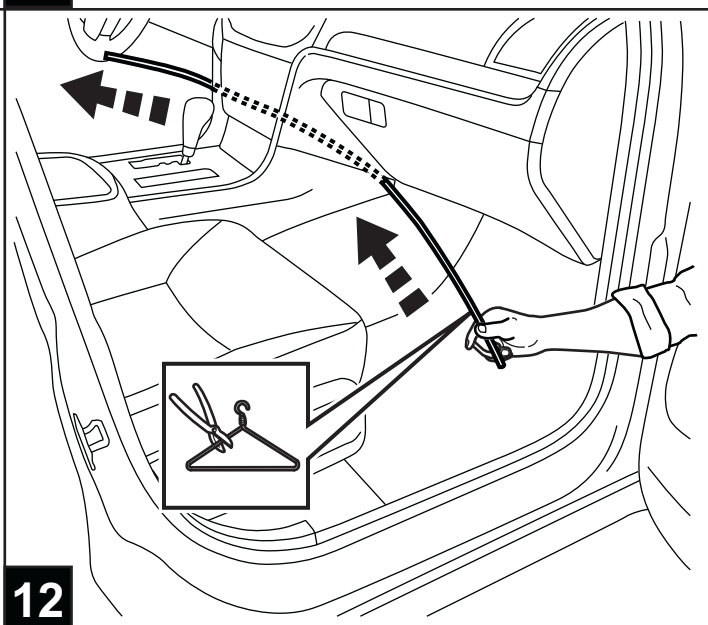

12

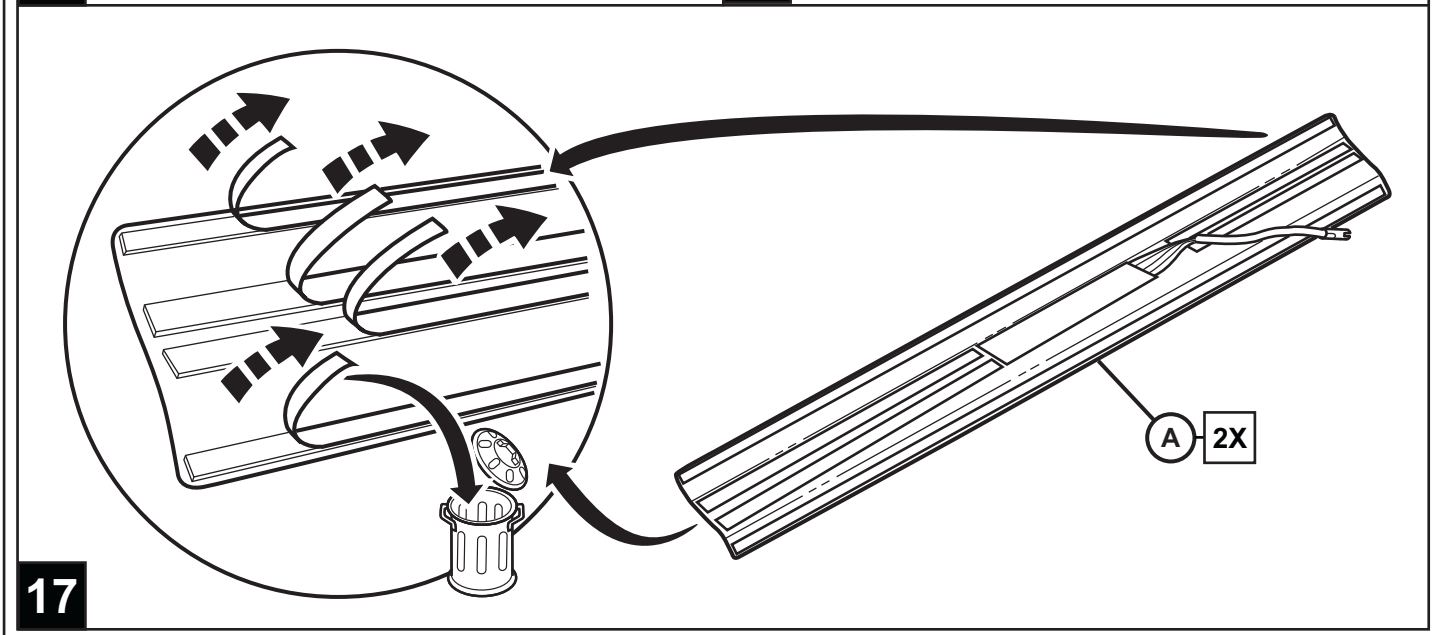
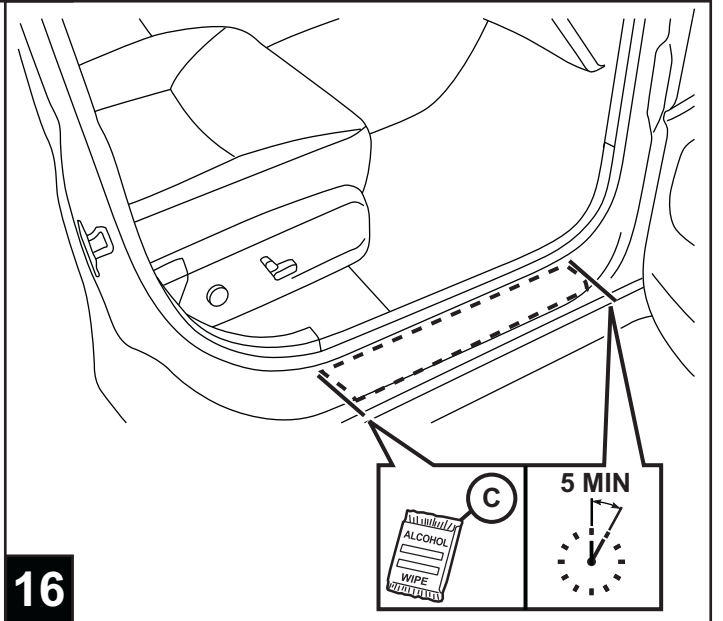
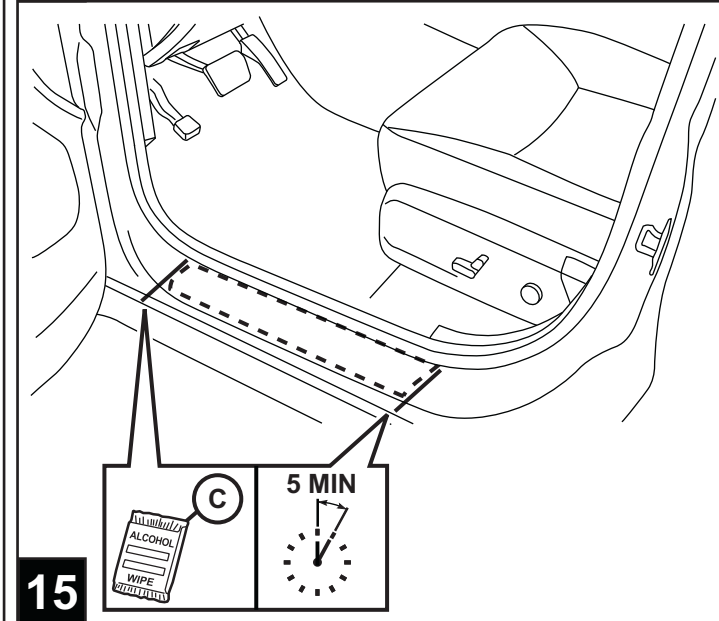
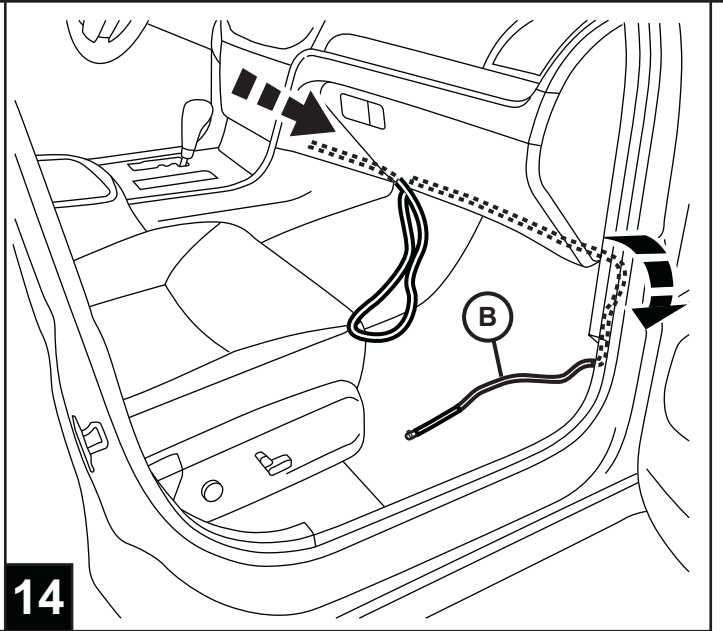
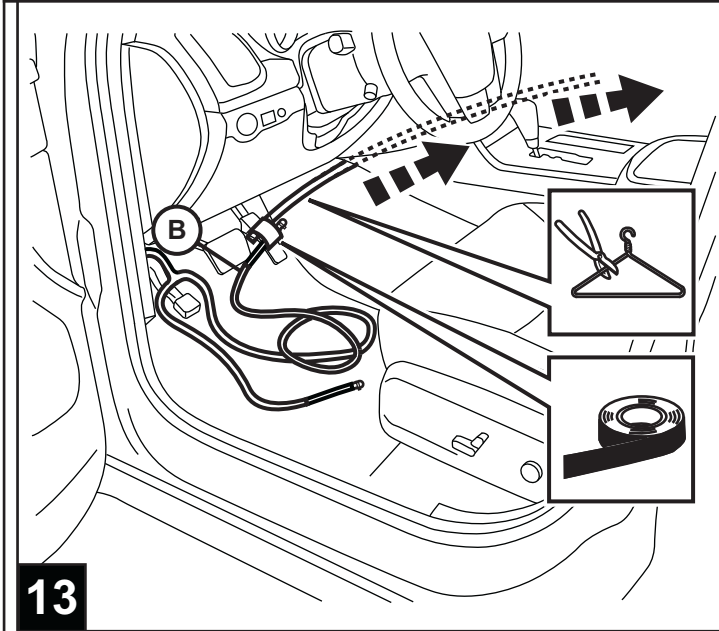

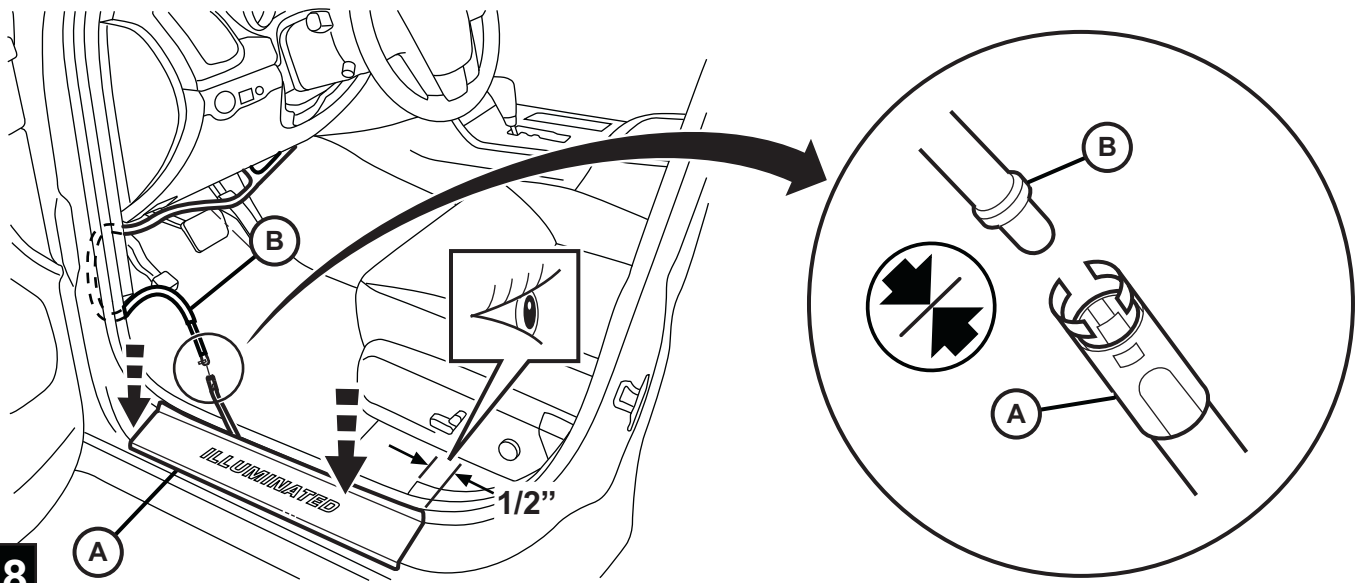

18

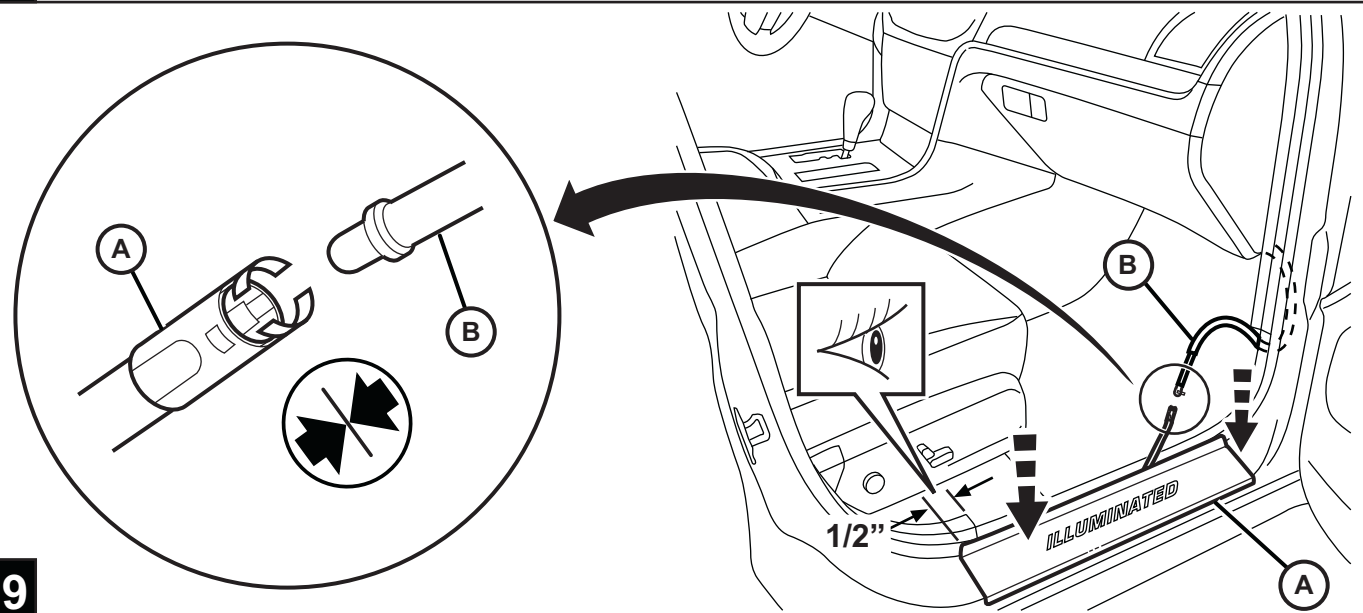

19

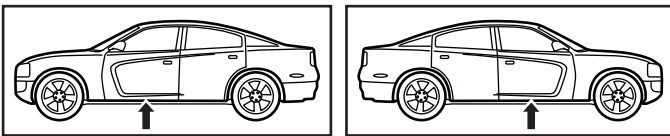

**NOTE:** PLACE 2 LAYERS OF TAPE ON METAL FLANGE TO REDUCE SHARP EDGES.

FAN OUT FIBER OPTICS OVER TAPED AREA AND REPLACE WEATHERSTRIP.

DRIVER SIDE SHOWN.  
REPEAT ON PASSENGER SIDE.

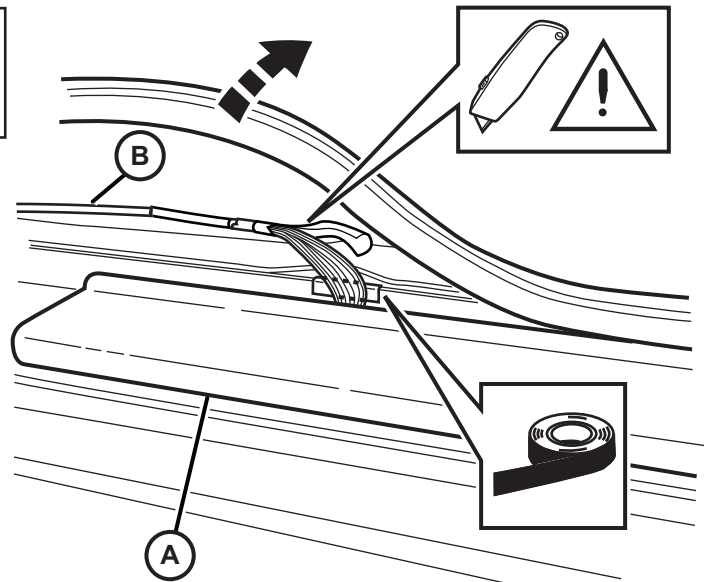

20

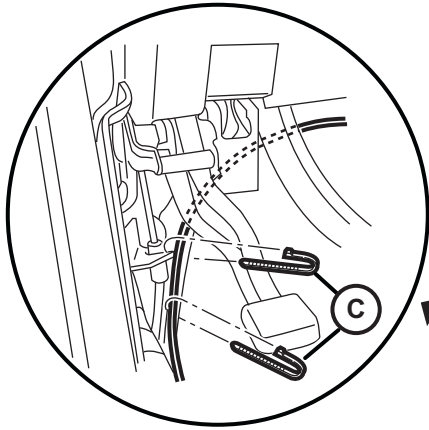

**NOTE: SECURE HARNESS  
BEHIND BRAKE PEDAL**

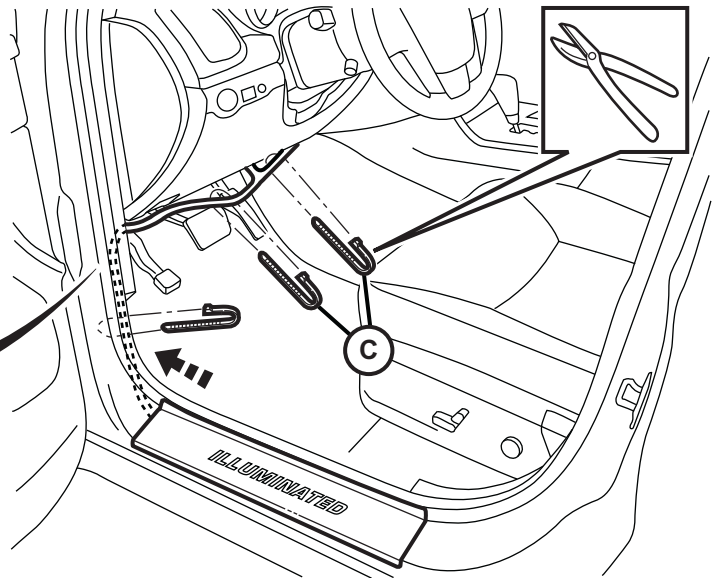

**21**

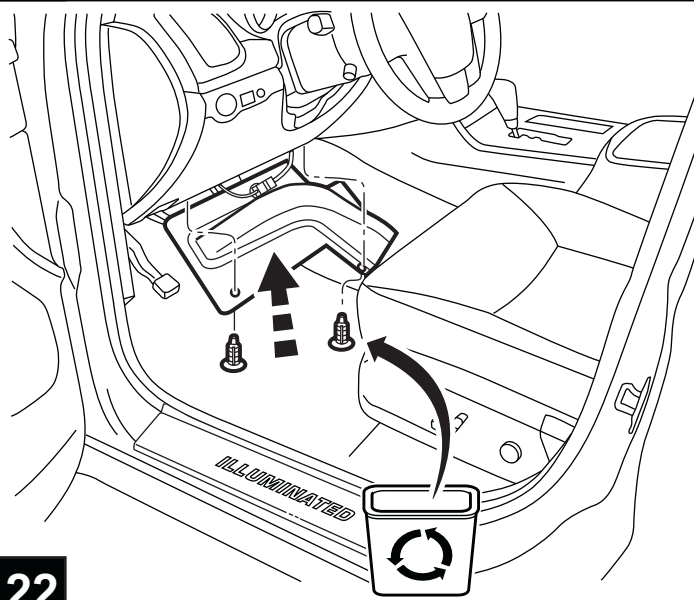

**22**

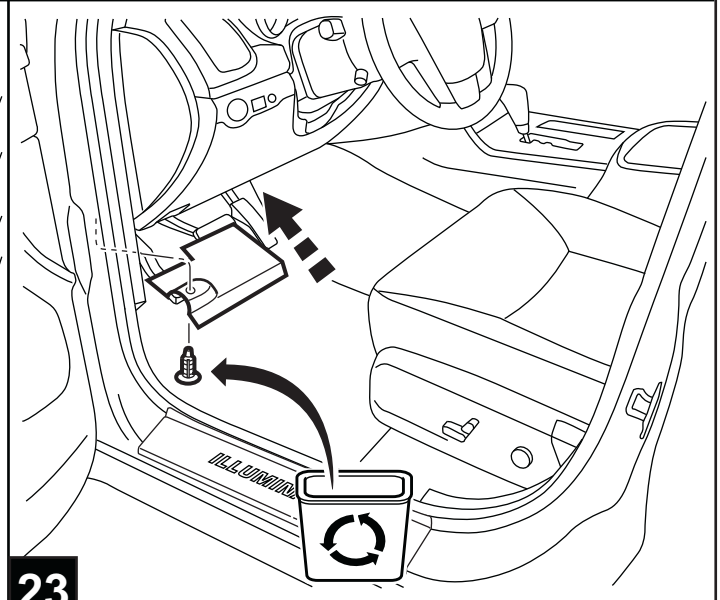

**23**

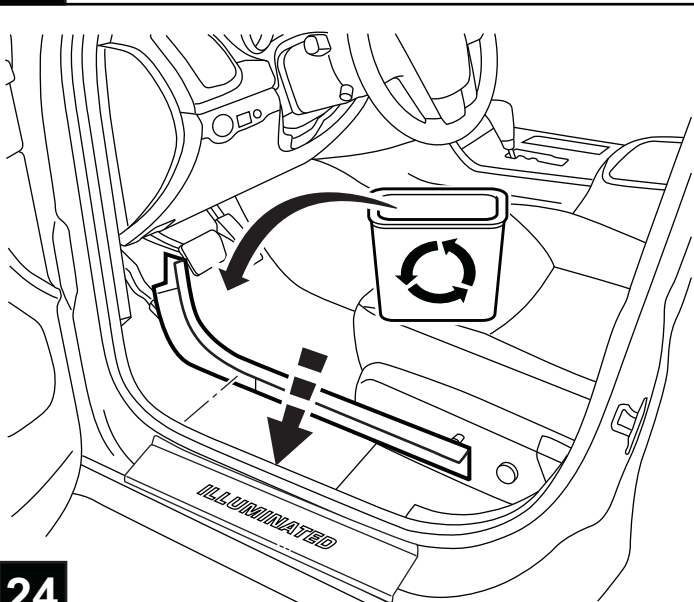

**24**

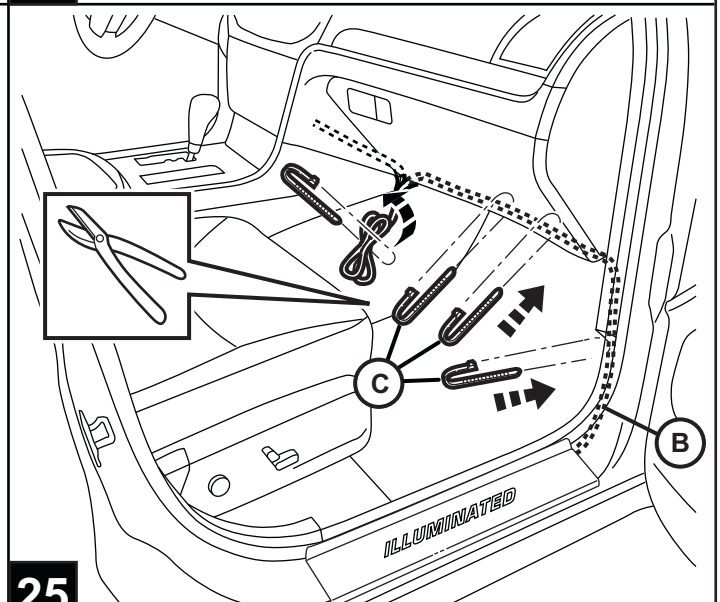

**25**

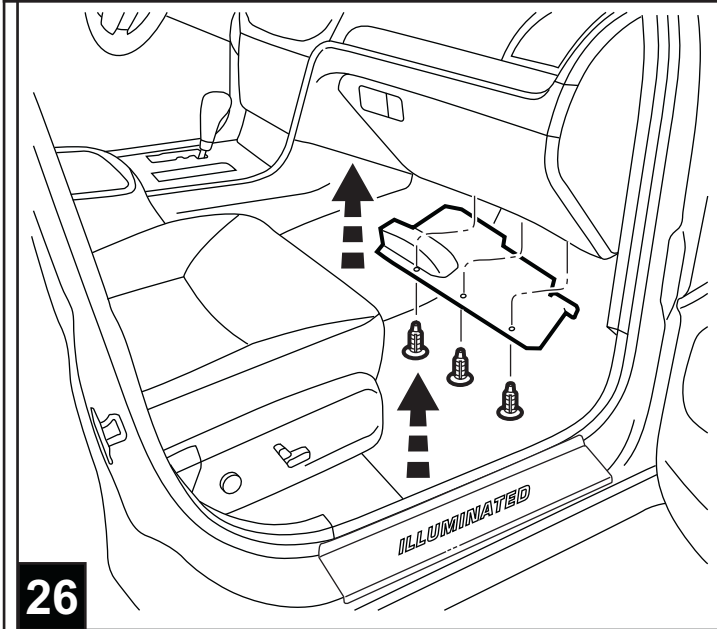

26

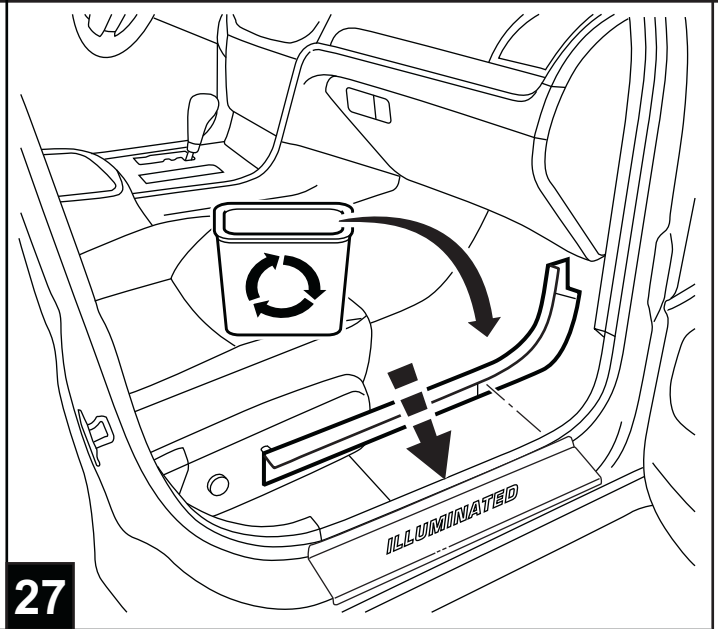

27

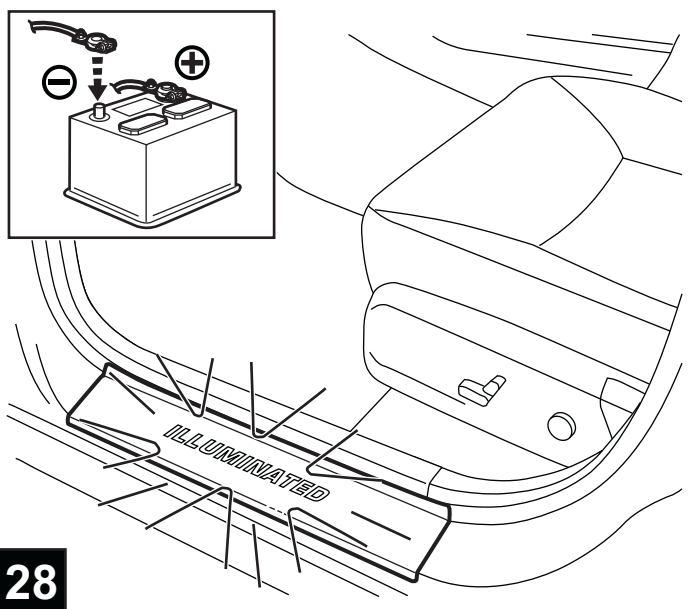

28

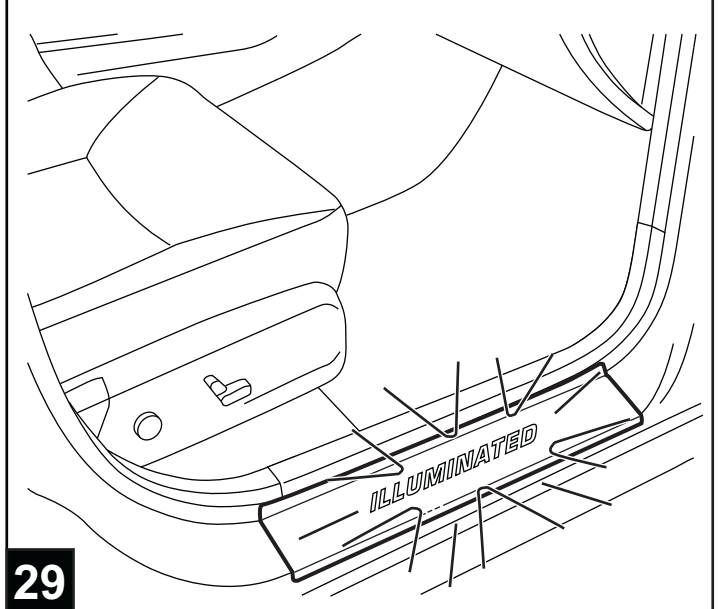

29

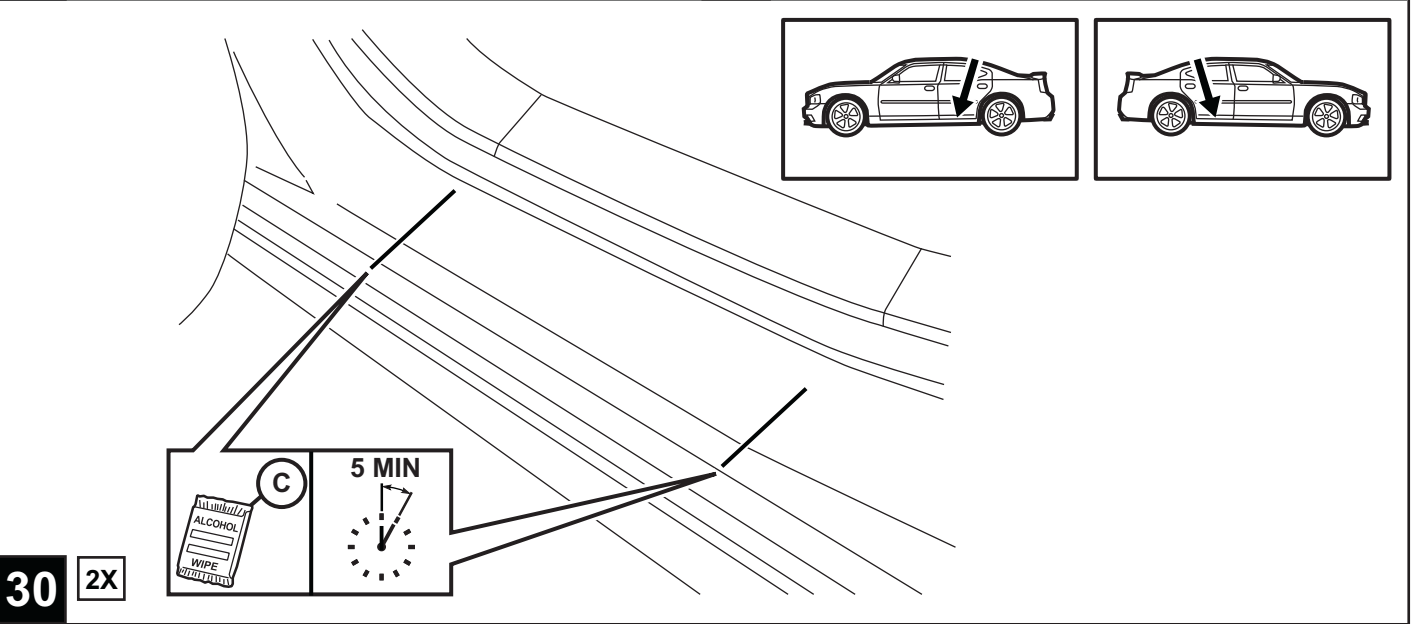

30

2X

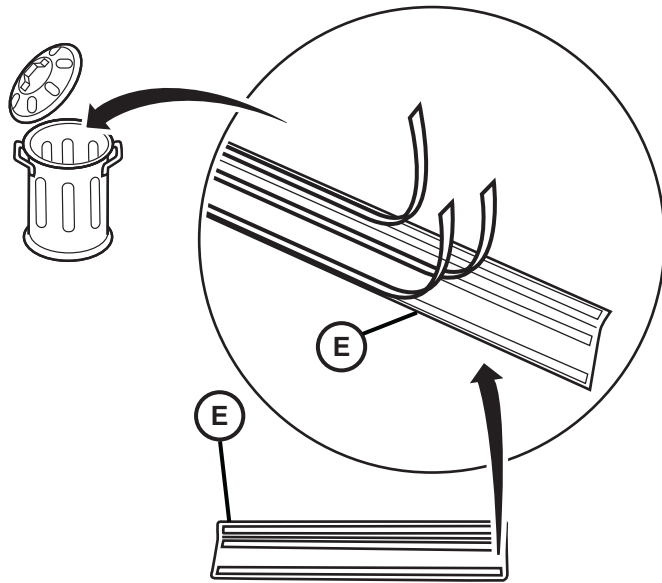

**31** 2X

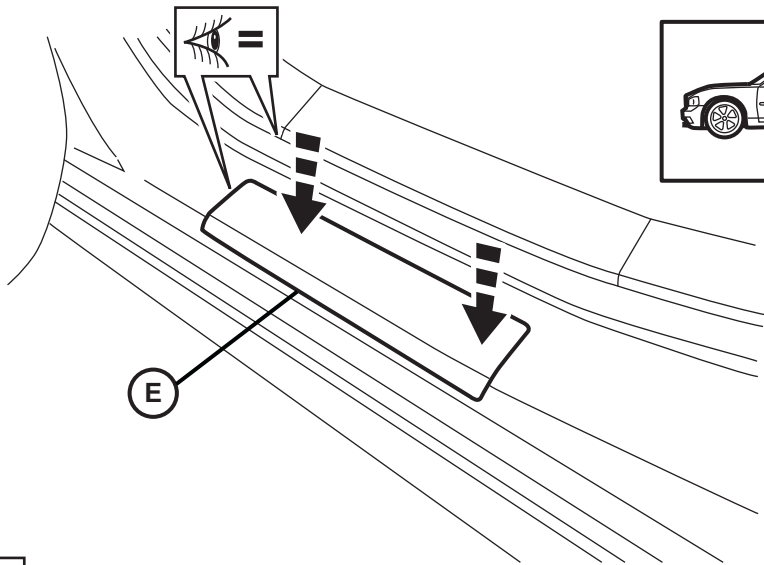

**32** 2X