

3

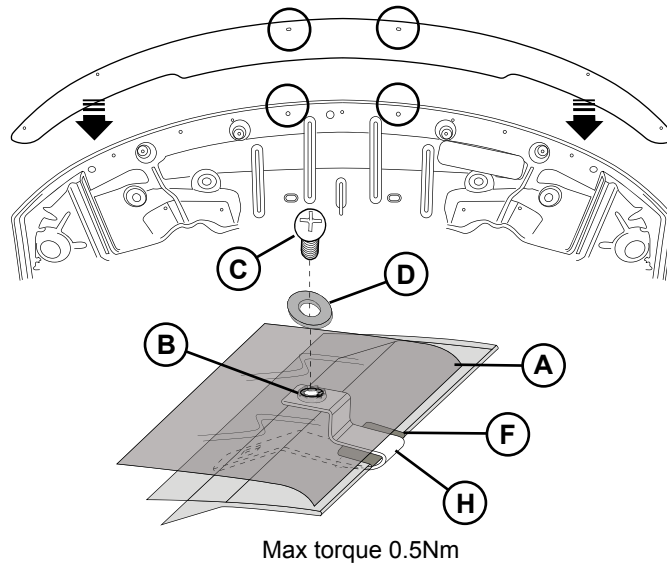

4

**\*\*2012 MODEL ONLY\*\***



Cover exposed metal with Anti-Corrosion / Rust Inhibitor



DO NOT DRILL THROUGH BONNET SURFACE

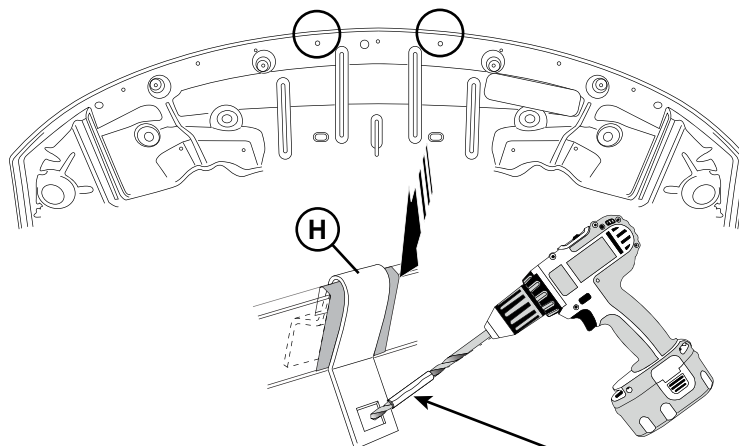

Use 6.0mm or 15/64 Drill Bit.  
DO NOT USE EXCESSIVE FORCE.

Wrap tape around Drill Bit  
Approximatley 10mm from tip.

5

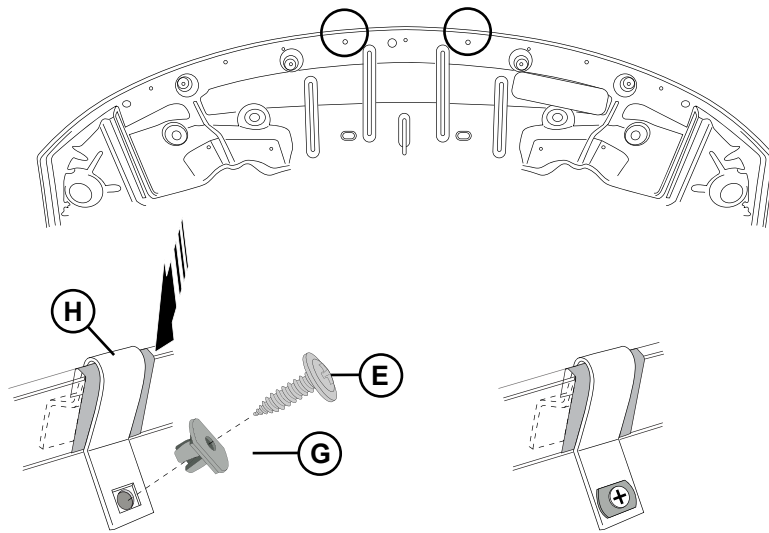

5

Max torque 0.5Nm

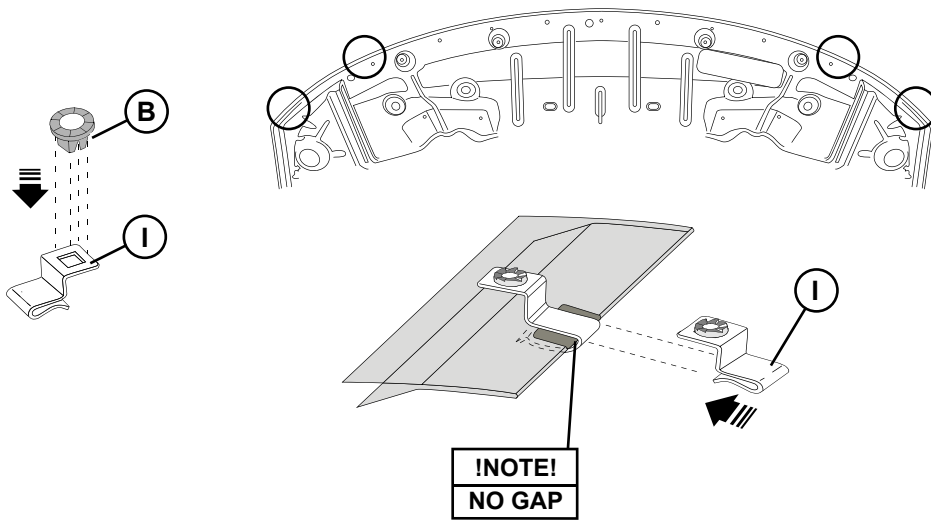

5

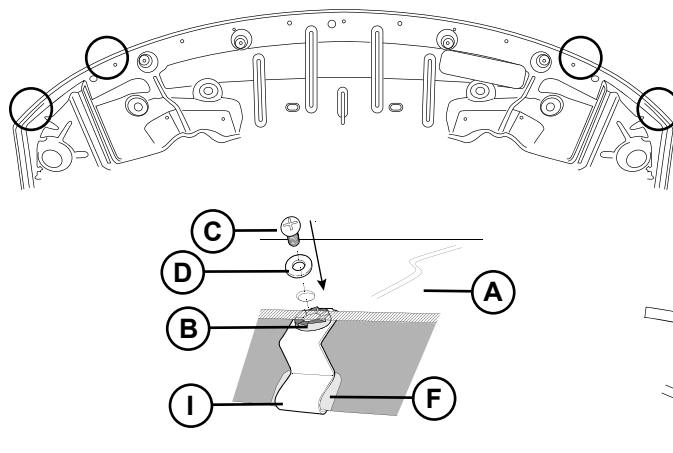

6

Max torque 0.5Nm



MOPAR®

# CHRYSLER JEEP COMPASS

## Front Air Deflector

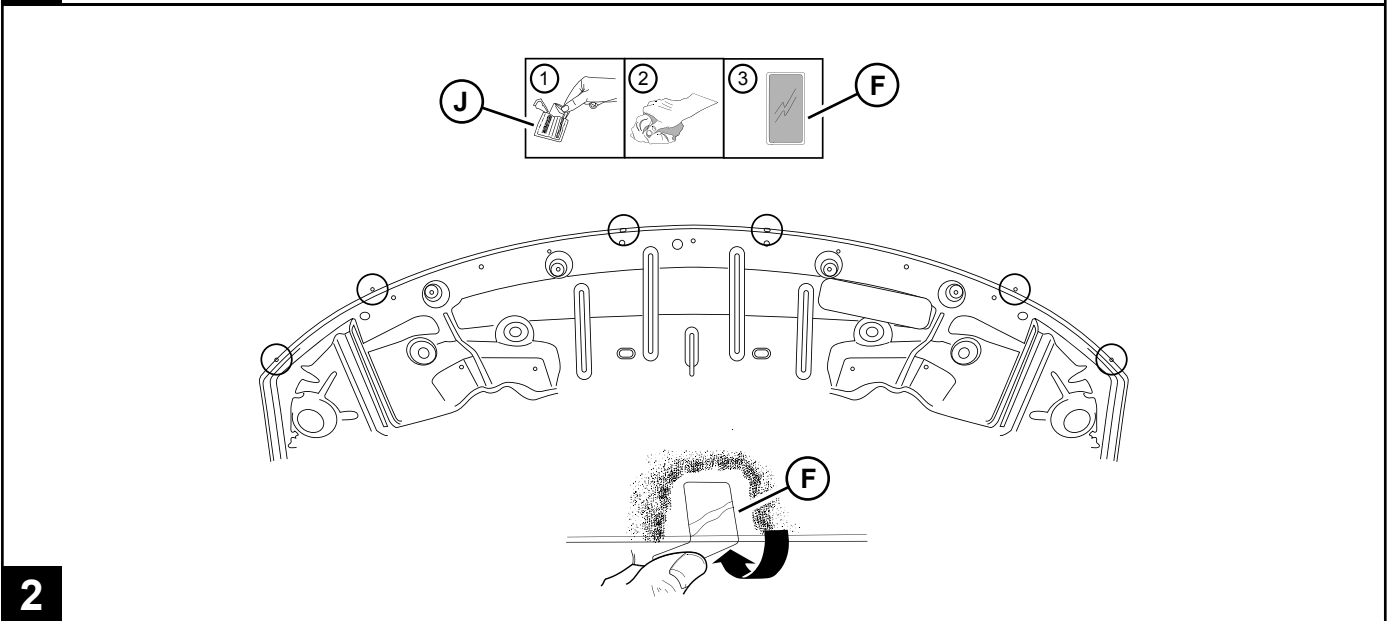
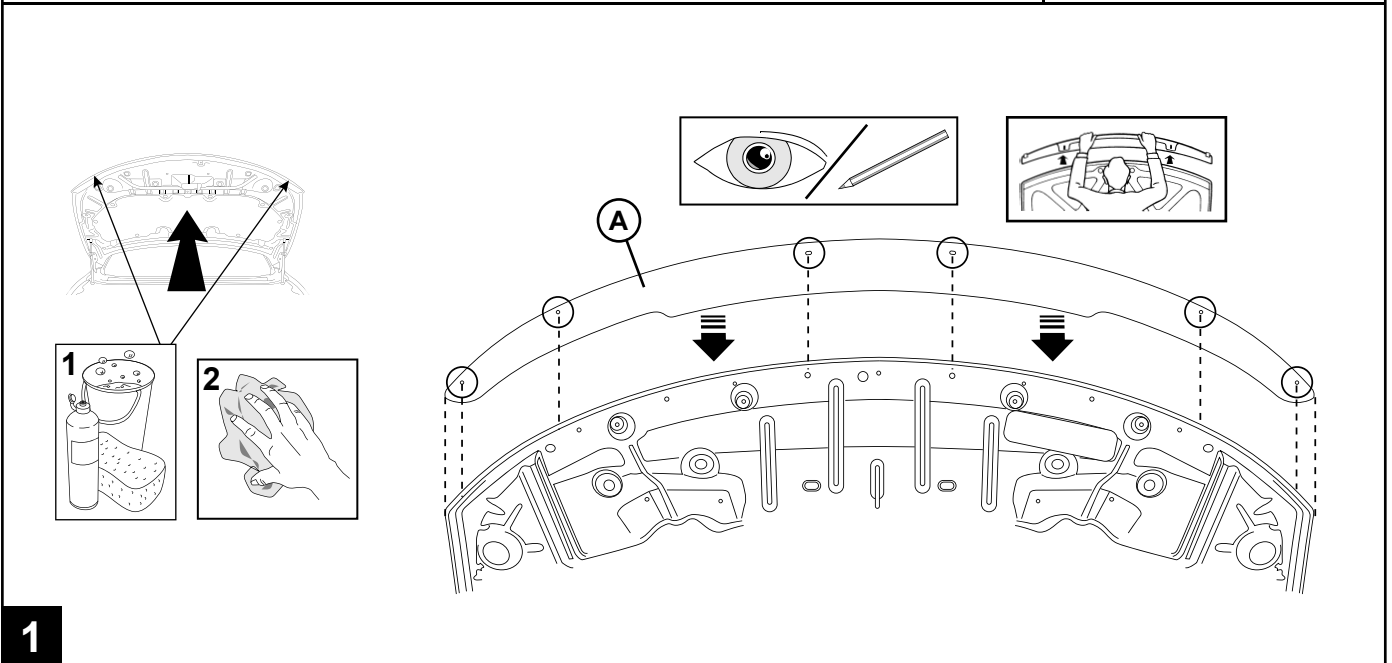
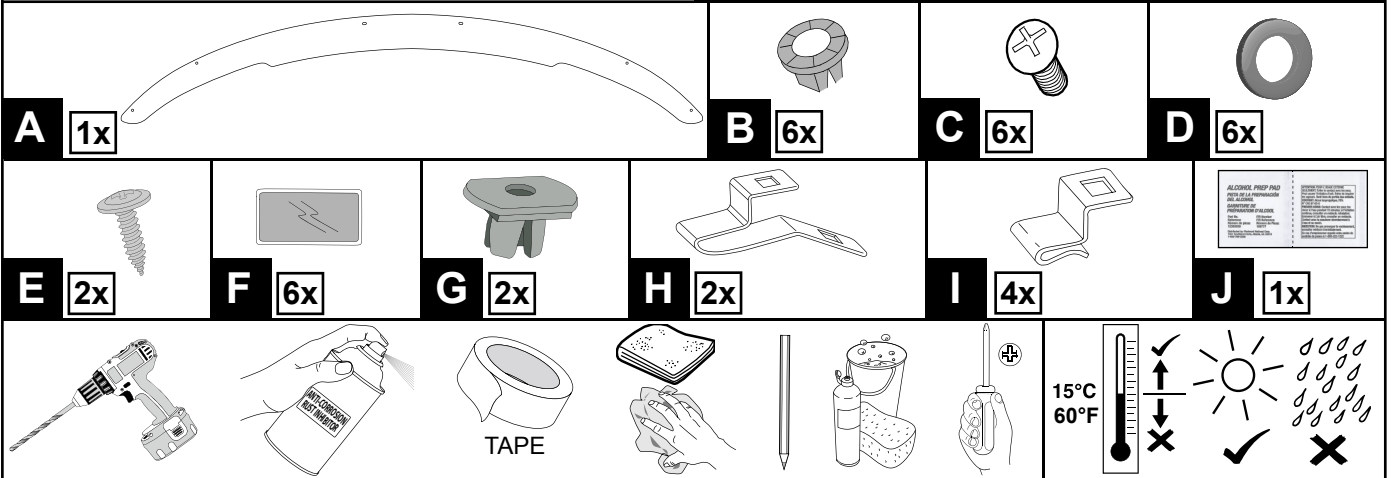

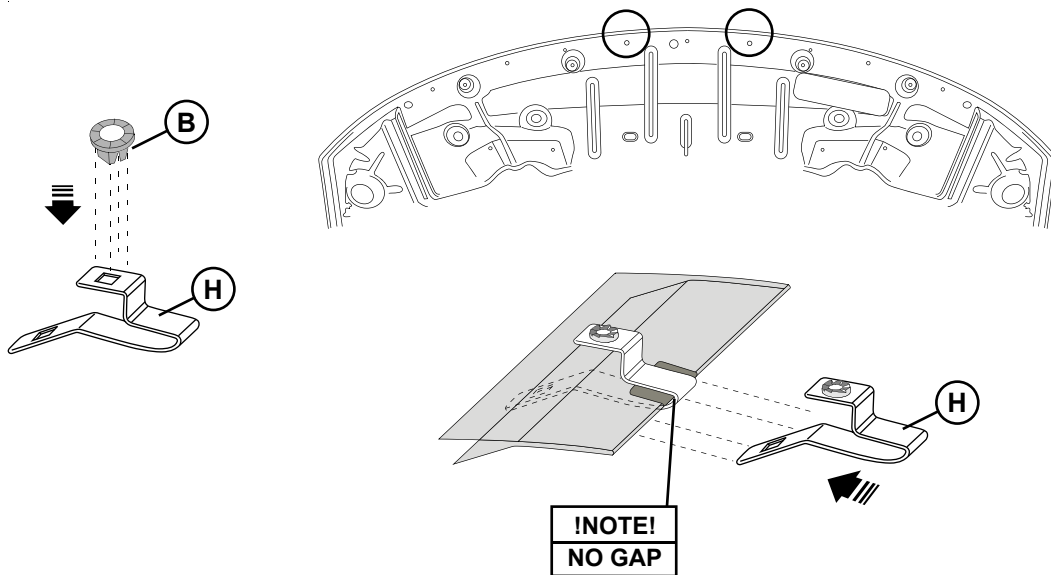

3

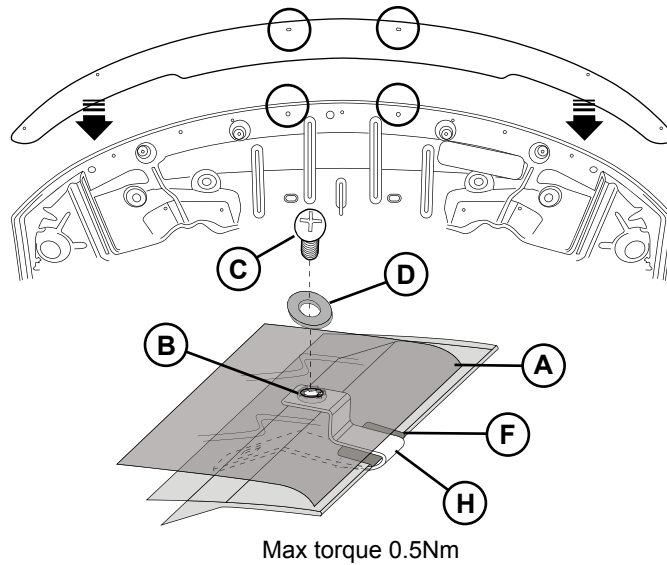

4

**\*\*MODÈLE 2012 UNIQUEMENT\*\***



Couvrir le métal exposé d'un prévenant la corrosion/antirouille.



NE PAS PERCER LA SURFACE DU BONNET.

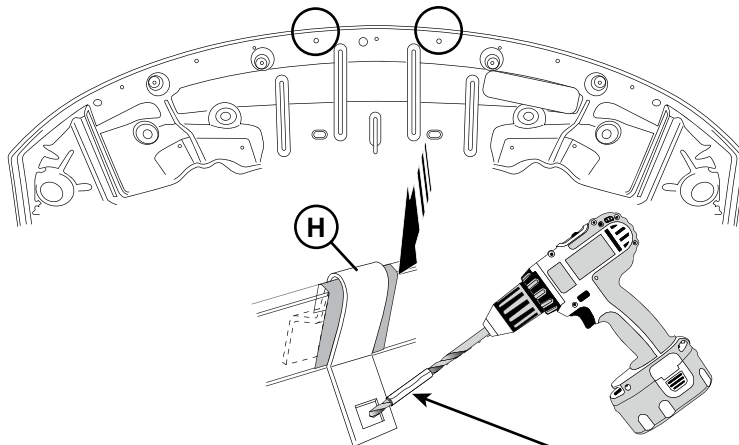

Utiliser un trépan de 6,0mm ou 15/64.  
NE PAS UTILISER DE FORCE EXCESSIVE.

Enrouler du ruban autour du trépan environ 10mm du bout.

5

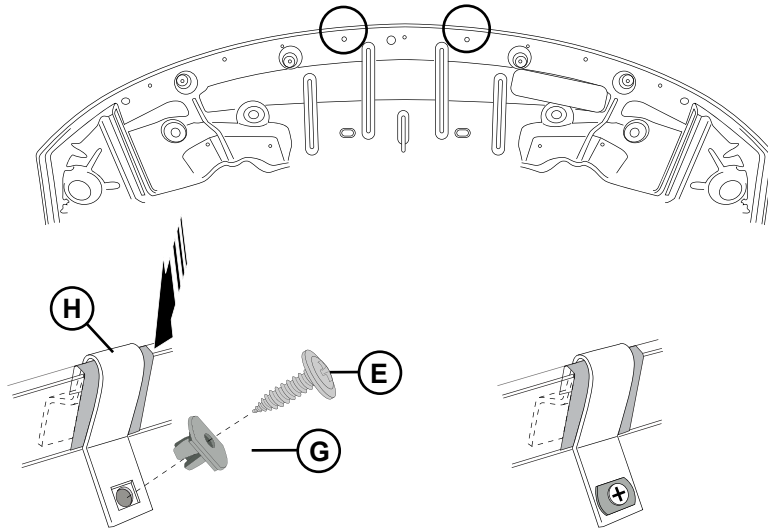

5

Max torque 0.5Nm

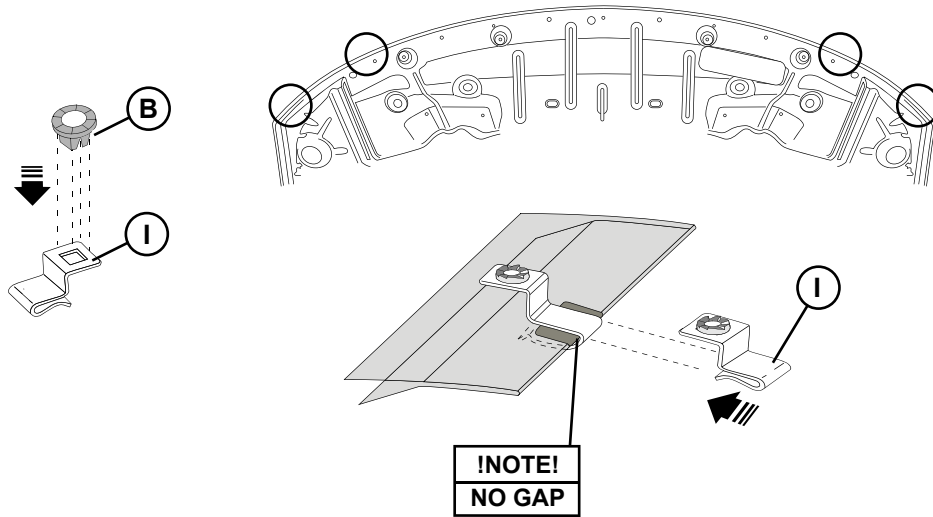

5

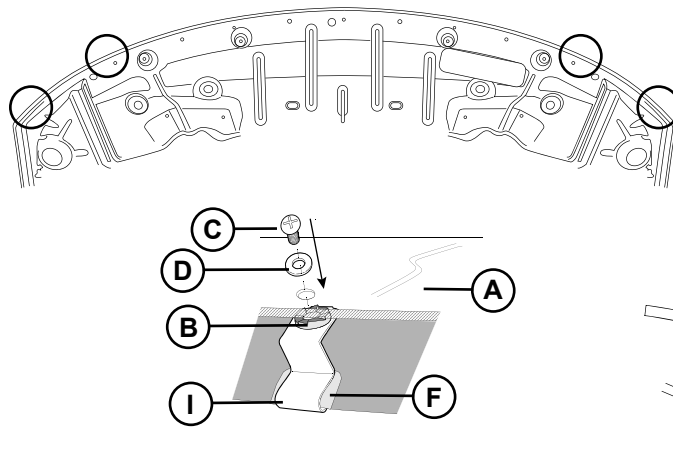

6

Max torque 0.5Nm



# CHRYSLER JEEP COMPASS

## Front Air Deflector

<b>A</b> 1x	<b>B</b> 6x	<b>C</b> 6x	<b>D</b> 6x						
<b>E</b> 2x	<b>F</b> 6x	<b>G</b> 2x	<b>H</b> 2x	<b>I</b> 4x	<b>J</b> 1x				

**1**

**2**

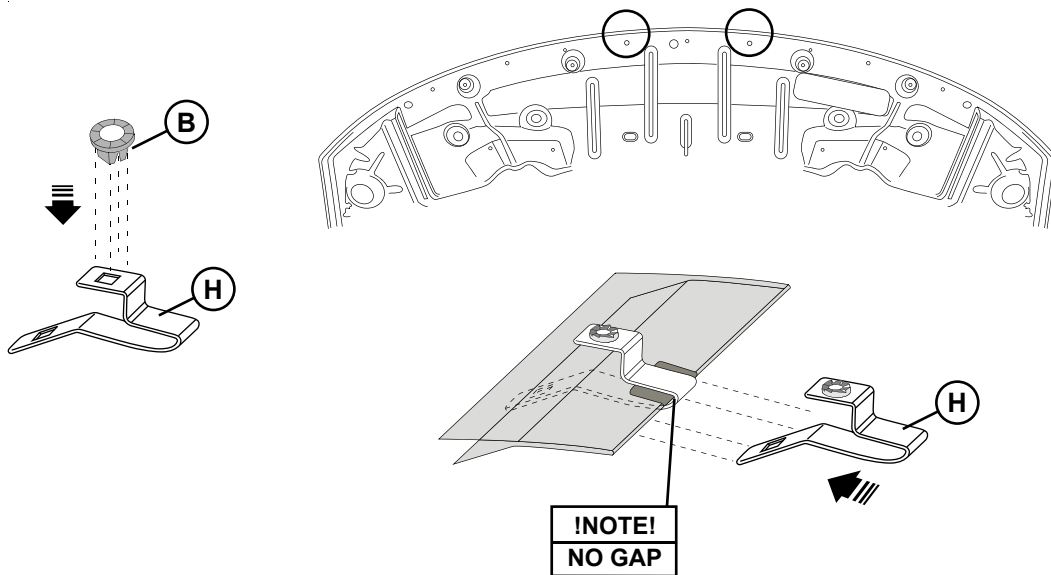

3

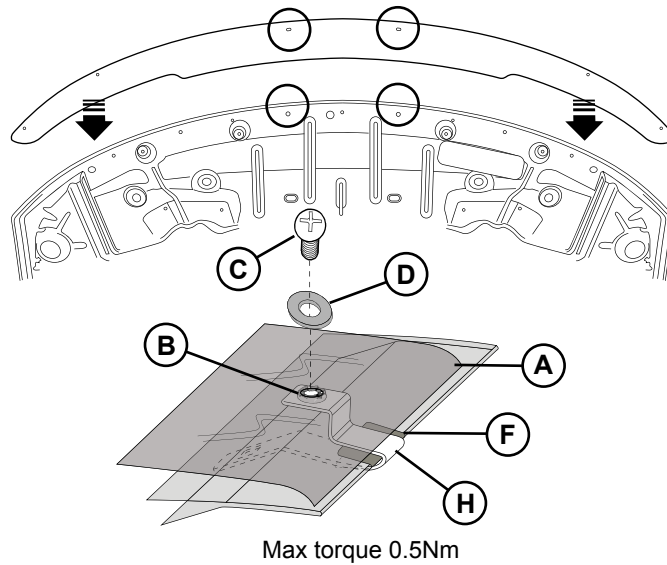

4

**\*\*SOLO MODELO 2012\*\***



Cubra el metal expuesto con anticorrosivo inhibidor de óxido.



NO PERFORE A TRAVÉS DE LA SUPERFICIE DEL CAPÓ.

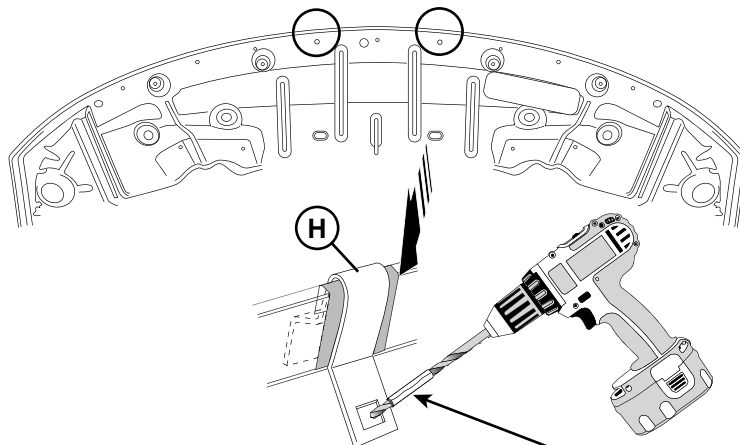

Use una broca de 6,0mm o 15/64.  
NO APLIQUE FUERZA EXCESIVA.

Envuelva la broca con cinta adhesiva aproximadamente a 10mm de la punta.

5



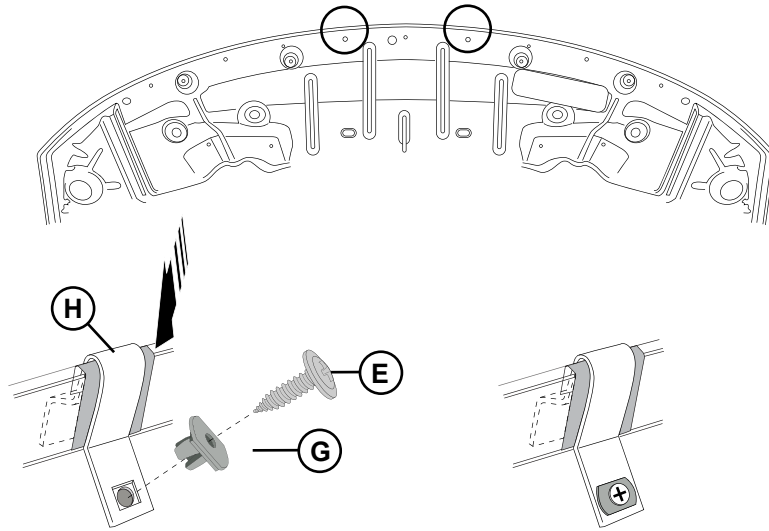

5

Max torque 0.5Nm

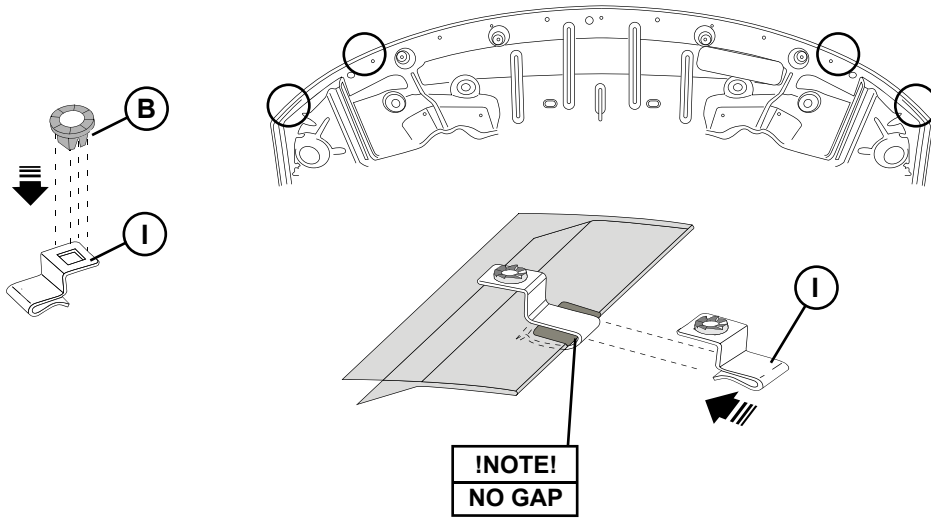

5

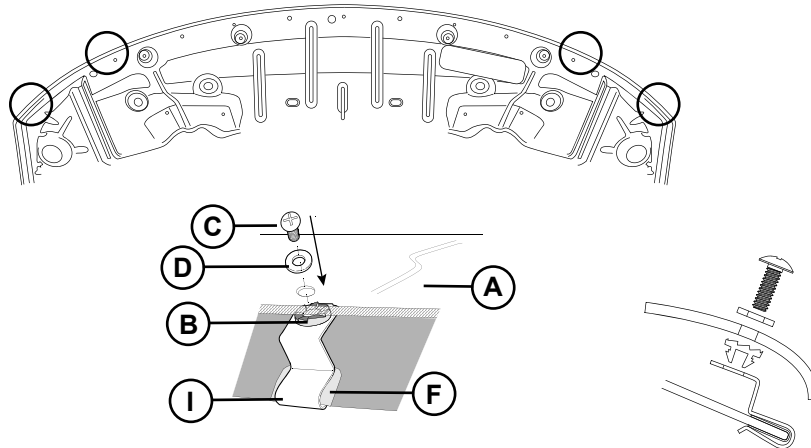

6

Max torque 0.5Nm