

PARTS INCLUDED

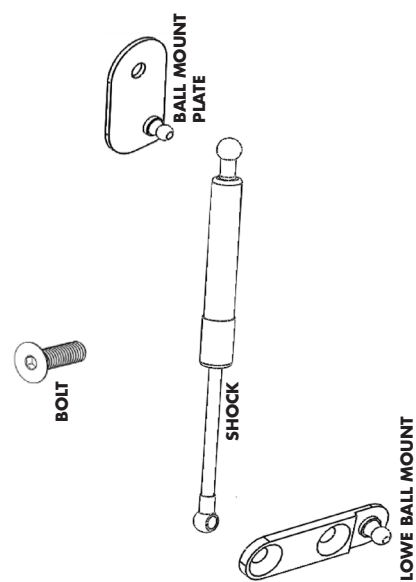

PARTS LIST

- THREAD LOCK TUBE 1
- SHOCK 1
- BALL MOUNT PLATE 1
- LOWER BALL MOUNT 1
- BOLT 1

TOOLS REQUIRED:
 T-50 TORX
 M6 ALLEN WRENCH
 FLATHEAD SCREWDRIVER

STEP 1

*** NOTE: THIS PRODUCT CAN ONLY BE INSTALLED ON THE DRIVER'S SIDE.**

Remove the rear bolt using the T-50 Torx wrench. DO NOT REMOVE THE FRONT BOLT.



STEP 2

Install the lower part of the shock onto the lower ball mount.



STEP 3

Install supplied flathead bolt through the hole in the bracket as shown. Then thread the bolt into the rear bolt location from step 1. DO NOT FULLY TIGHTEN.



STEP 4

Remove the front bolt and install supplied flathead bolt through the bracket and into the hole. FULLY TIGHTEN BOTH BOLDS USING AN M6 ALLEN WRENCH AT THIS TIME.



STEP 5

Using a flathead screwdriver, pry the spring clip out and remove the tailgate cable from the bolt. Use the T50 torx socket to remove the cable bolt.



STEP 6

Install the bolt removed from the previous step through the hole in the ball mount plate back into the hole.



Tighten the bolt with the T50.

STEP 7

Install the cable back onto the cable bolt

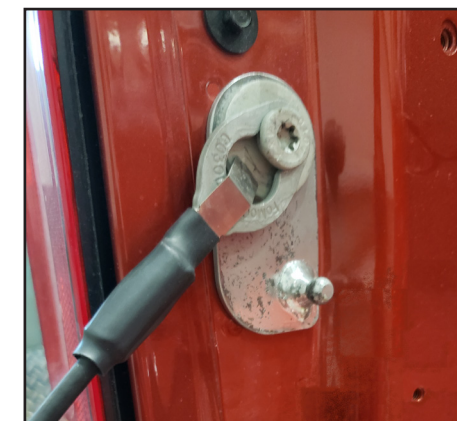

STEP 8

Install the larger part of the shock on the ball mount plate



*Periodically check the upper and lower mounting locations to insure that parts have not loosened through repeated use. If either mounting location is found to be loose, re-tighten the hardware as needed.

FAQ's

Can the Tailgate Assist be installed on the passenger's side?

No. The unit will not work on the passenger side of the truck bed. Installing the tailgate assist on the passenger side can cause the tailgate to come off the truck.

Are there installation videos?

Yes. All installation videos can be viewed at: www.deezee.com/tailgateassist

DEE ZEE, INC. WARRANTY COVERAGE

Dee Zee, Inc. guarantees the original purchaser a limited warranty against manufacturer defects in materials, workmanship, and design under normal use.

Tailgate Assist has a 3-year limited warranty. Operational and wear items such hardware have a one-year (1) warranty. To read the complete warranty policy for your product visit: www.deezee.com/warranty

Buyer assumes all risk, liability, and cost for the installation and use of Dee Zee products. Dee Zee, Inc. assumes no liability for injury, loss, incidental or consequential damages in the event of an accident.

WARRANTY & RETURN SUBMISSION PROCEDURE

Please contact the original point of purchase for: shipping damage, returns, or warranty claims. Contact Dee Zee directly for missing parts or hardware.

All warranty claims will be initiated at the place of purchase. The original purchaser will be required to present the original sales receipt with purchase date shown and provide photographs of the defect.

DZ 43206 FORD TAILGATE ASSIST RANGER 2019+



INSPECT YOUR PRODUCT FOR DAMAGE & MISSING PARTS BEFORE PROCEEDING TO INSTALLATION

1-800-779-2102

Mon – Thurs: 8:00am - 5:00pm | Friday: 8:00am - 4:00pm (CST)

WWW.DEEZEE.COM

**REGISTER YOUR PRODUCT ONLINE: www.deezee.com/registration
VIEW INSTRUCTIONS ONLINE: www.deezee.com/instructions**

⚠️ WARNING: Cancer and Reproductive Harm
www.P65Warnings.ca.gov