

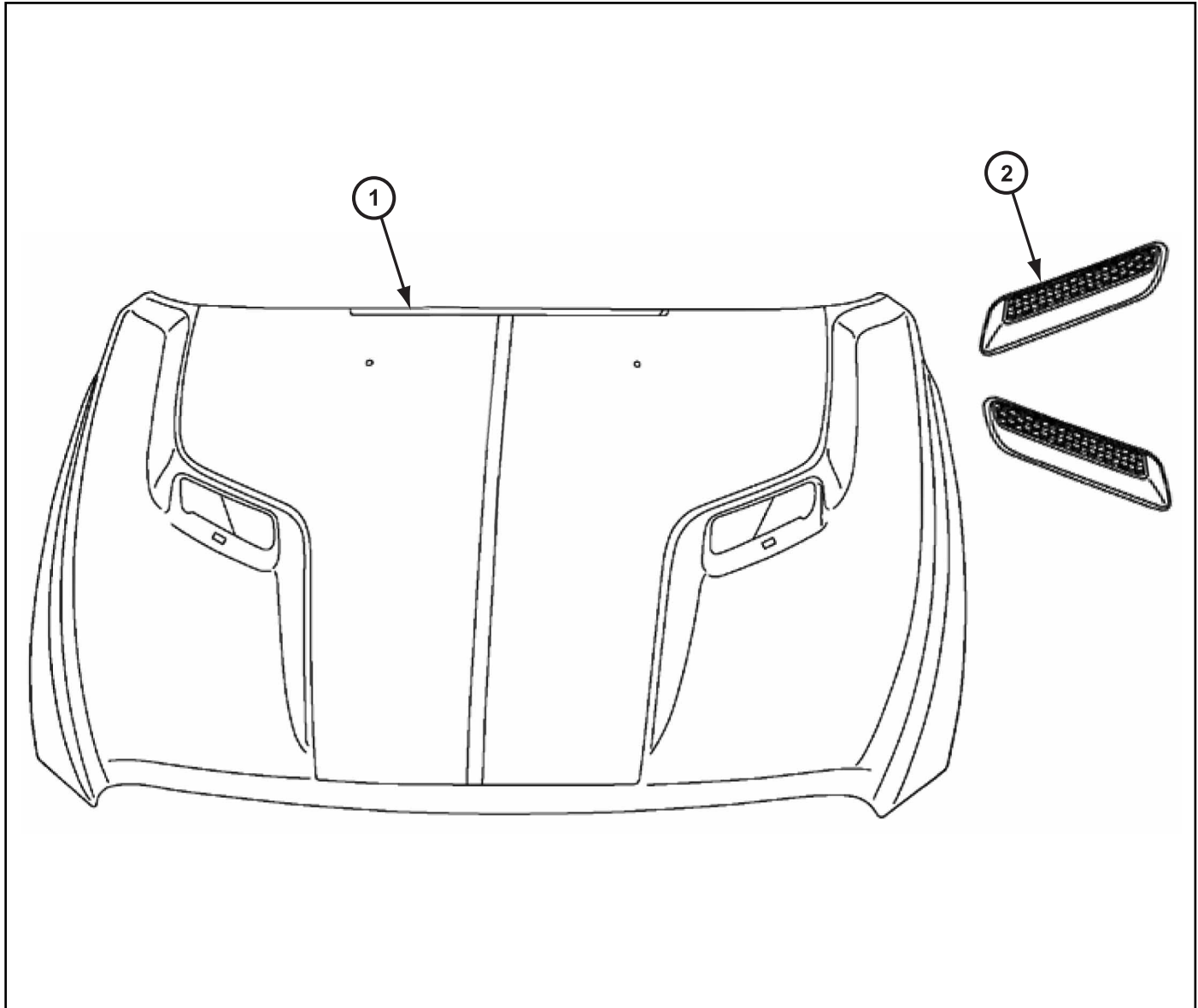

# ACCESSORY HOOD

## DODGE RAM



Call Out	Description	Parts	Quantity
1	Hood	Supplied in kit	1
2	Bezel	Supplied in kit	2

**PROCEDURE STEPS:**

1. Disconnect the washer fluid hose (1) and release the hose from the retaining clips (2).

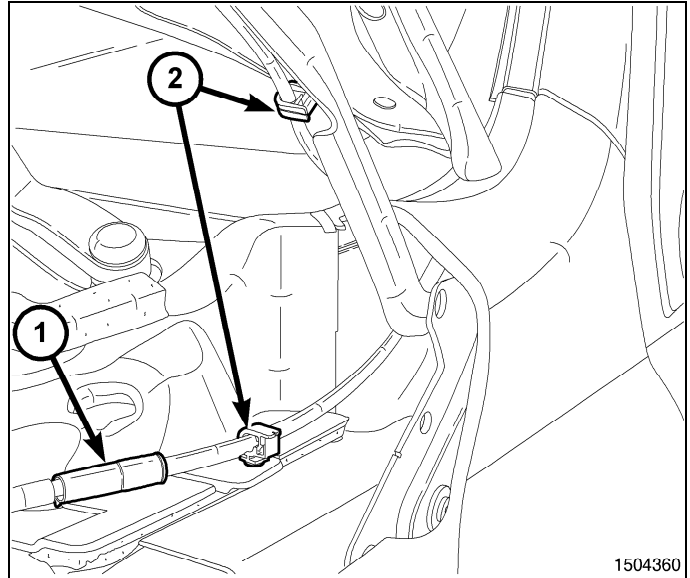

2. If equipped, disconnect the underhood lamp connector (1) and release the wire harness from the retaining clips (2).

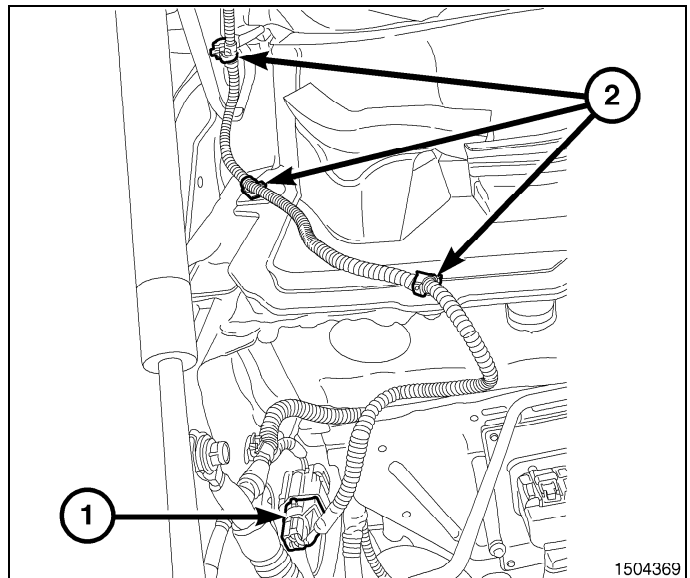

**CAUTION:** Be sure to not to damage the paint finish of the hood by placing the hood on non abrasive surface.

3. With the help of an assistant, remove the two nuts (1) from the hinge (2). Repeat steps on opposite side and remove the hood.

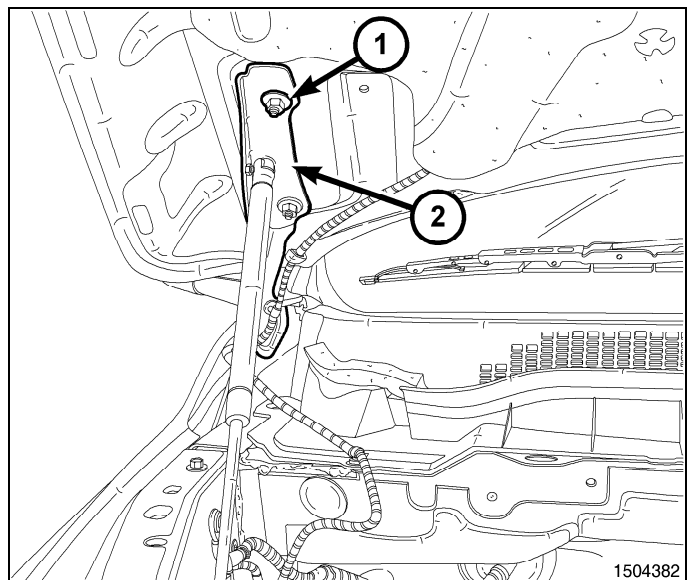

4. Remove the hood silencer pad by removing the seven retaining clips (4).

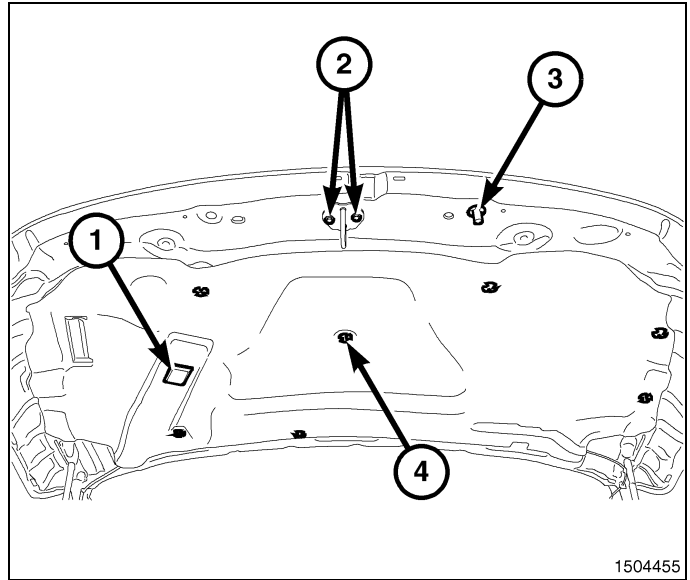

5. Disconnect the washer hose and washer nozzles by releasing the integral latch features of the washer nozzle by pushing the nozzle out through the mounting hole towards the top side of the hood. Install the nozzles on the new accessory hood.

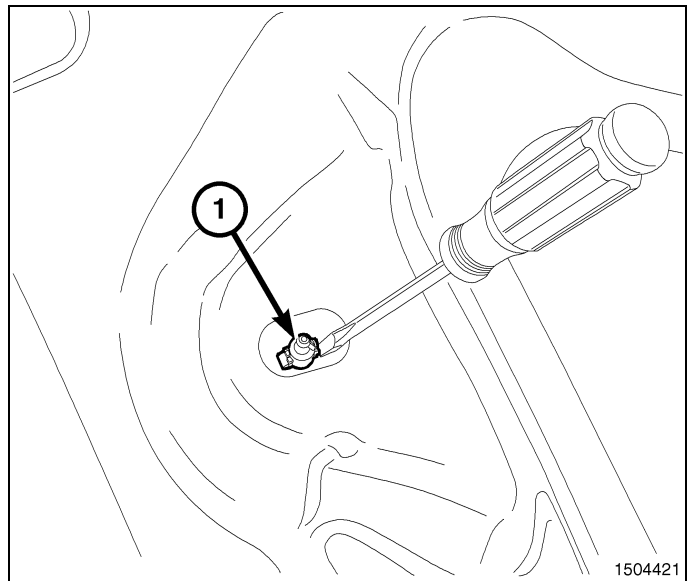

6. If equipped, transfer the underhood lamp (1) and remote starter plunger (3) to the new accessory hood.
7. Transfer the hood striker to the new accessory hood and tighten the bolts (2) to 17 N·m (12.5 ft. lbs.).
8. Install the hood silencer pad on the new accessory hood by pressing the seven retaining clips (4) into the new accessory hood.

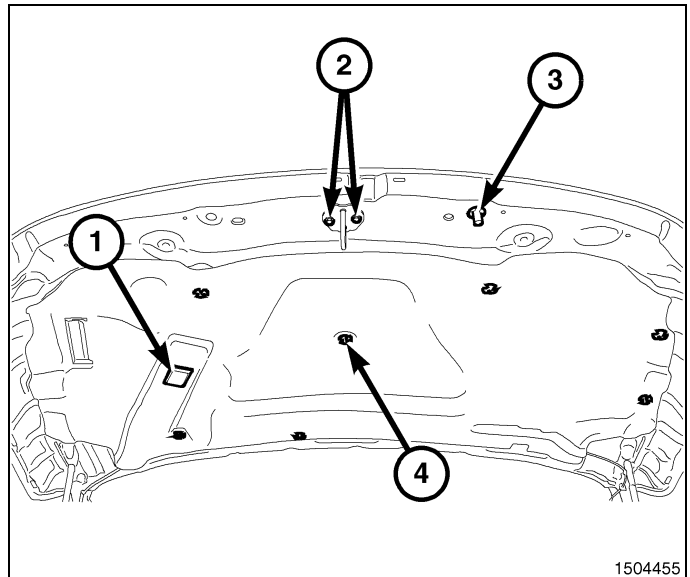

9. With the help of an assistant, position the hood onto the hood hinge (2) and loosely install the two nuts (1) that secure the hood to the hinge (2). Repeat steps for the opposite side.

**NOTE: Quad Cab shown in Fig. 1, Regular Cab and Crew Cab similar.**

10. Adjust the hood to the correct position, refer to Fig. 1 and the flushness chart. Once the hood is positioned properly, tighten the hood hinge nuts (1) to 18 N·m (13 ft. lbs.).

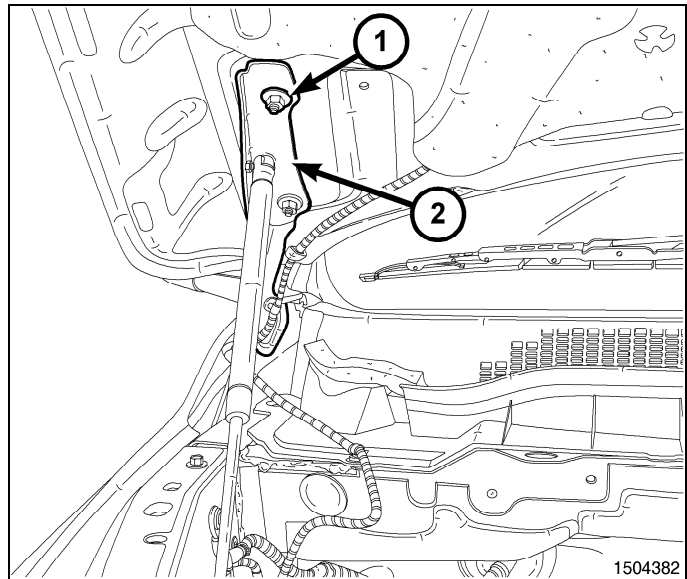

11. Connect the underhood lamp connector (1) and the wire harness retaining clips (2).

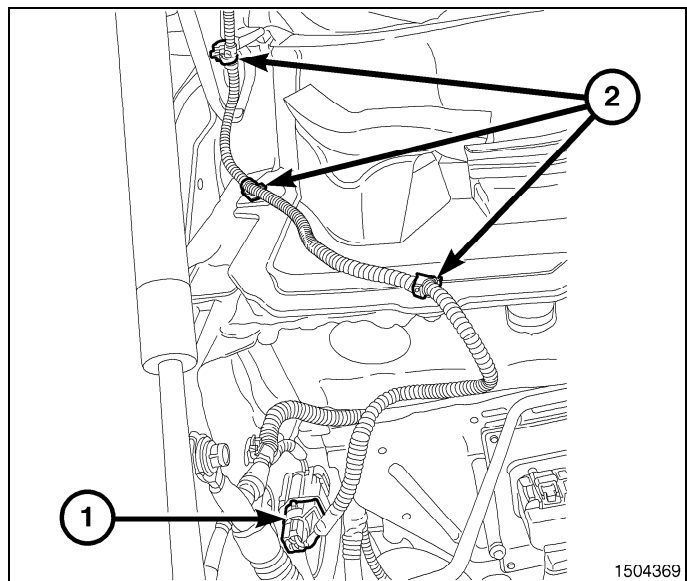

12. Connect the washer fluid hose (1) and the hose in the retaining clips (2).

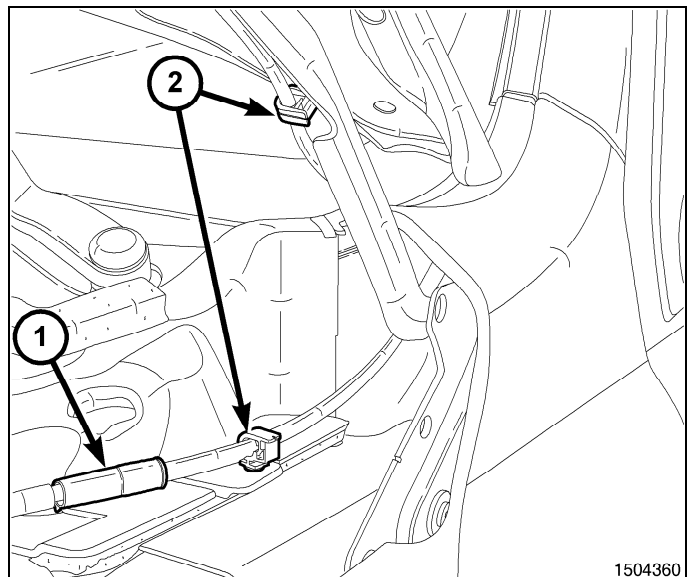

15. Install the bezel into the accessory hood.

- If the clip retainer openings are present on the hood, position the bezel into the accessory hood by loading the top edge first (1) then push downward in the center of the bezel (3) to engage the center clip. Continue pushing downward in the center and rearward (4) until all the clips are engaged. Repeat for the opposite side.

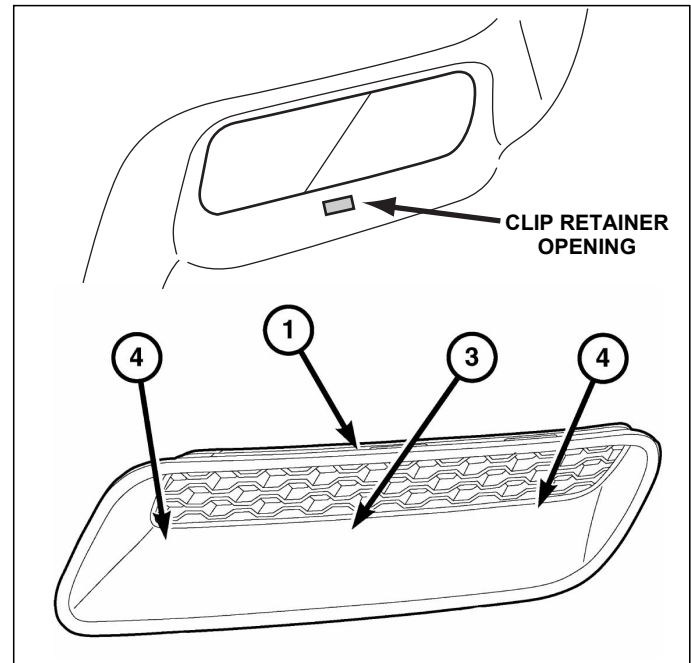

- If the clip retainer openings are NOT present on the hood, use alcohol to clean the hood surface where the adhesive will be mounted.

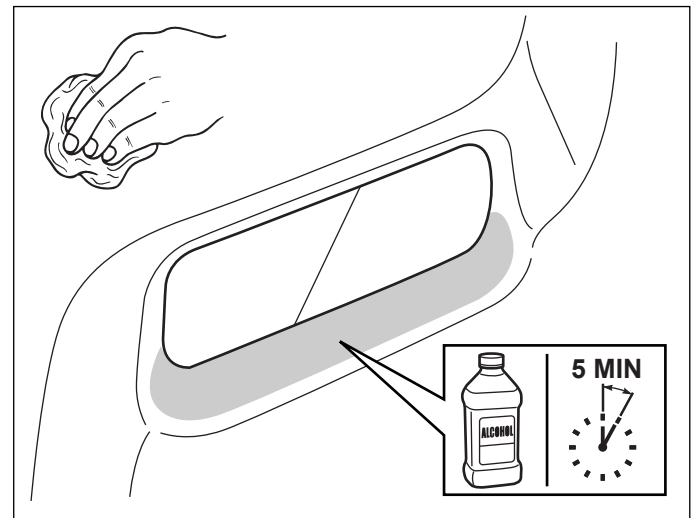
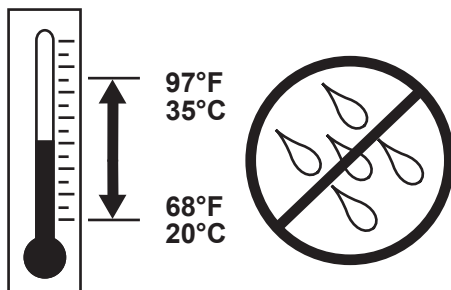

- Peel the tape protector (2) off at a 45 degree angle to expose the tape adhesive. Position the bezel into the accessory hood by loading the top edge first (1). Push downward in the center and rearward (4) until all the clips are engaged. Press down firmly for 30 seconds minimum to ensure good adhesion. Repeat for the opposite side.

**CAUTION: DO NOT DRIVE VEHICLE THROUGH AUTOMATIC OR HIGH PRESSURE CAR WASH FOR 48 HOURS AFTER INSTALLATION.**

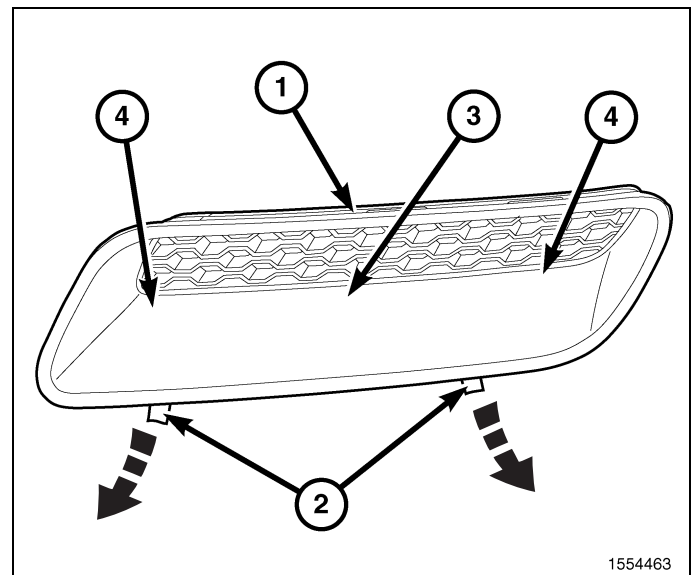

1554463

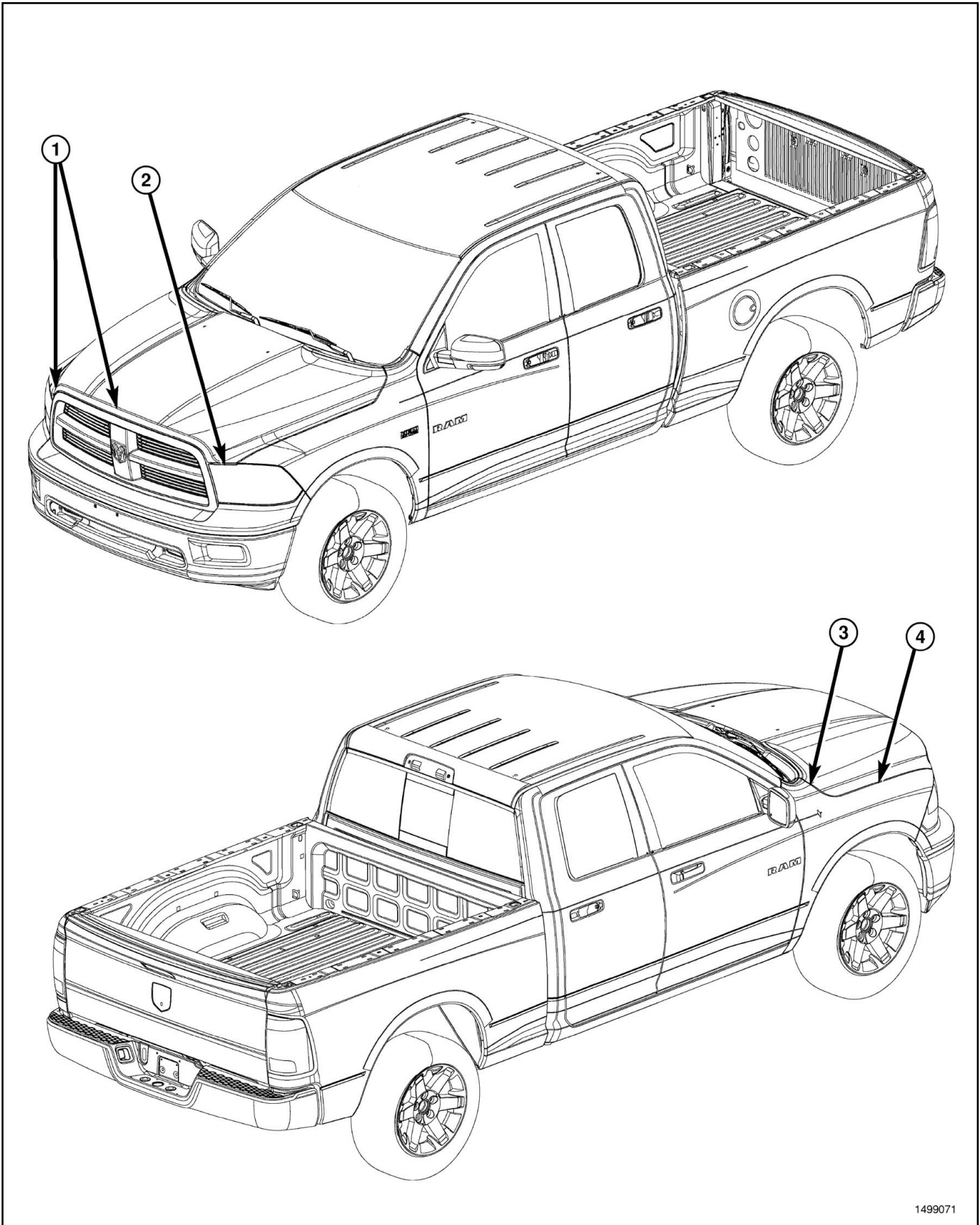

1499071

**Fig. 1 QUAD CAB**

## HOOD FLUSHNESS CHART

NOTE: All measurements are in millimeters. O/F = Over Flush, U/D = Up/Down U/F = Under Flush, F/A = Fore/Aft			
DIMENSION	DESCRIPTION	GAP	FLUSH
1	Hood to grille (along top)	7.0 +/- 2.0 transition to 4.5 after corner	Hood o/f 7.0 @ center to 5.5 @ corner to 1.0 around corner +/- 2.0
2	Headlamp to hood	7.0 +/- 2.0 Parallel within 2.0 Side to side within 3.0	Headlamp o/f 4.0 +/- 2.0 Parallel within 2.0 Side to side within 2.0
3	Fender to hood @ cowl	4.5 +/- 1.5 Parallel within 1.5 Side to side within 2.0	Fender u/d u/f 0.75 +/- 1.5 Cross/car 0.0 +/- 1.5
4	Fender to hood	4.5 +/- 1.5 Parallel within 1.5 Side to side within 2.0	Fender o/f 0.5 +/- 1.5