

- Please study these instructions carefully before installing your Cruise Control Adapter Kit.
- If you have any questions or problems, do not hesitate to contact our **Technical Hotline at:1-800-416-8628.**

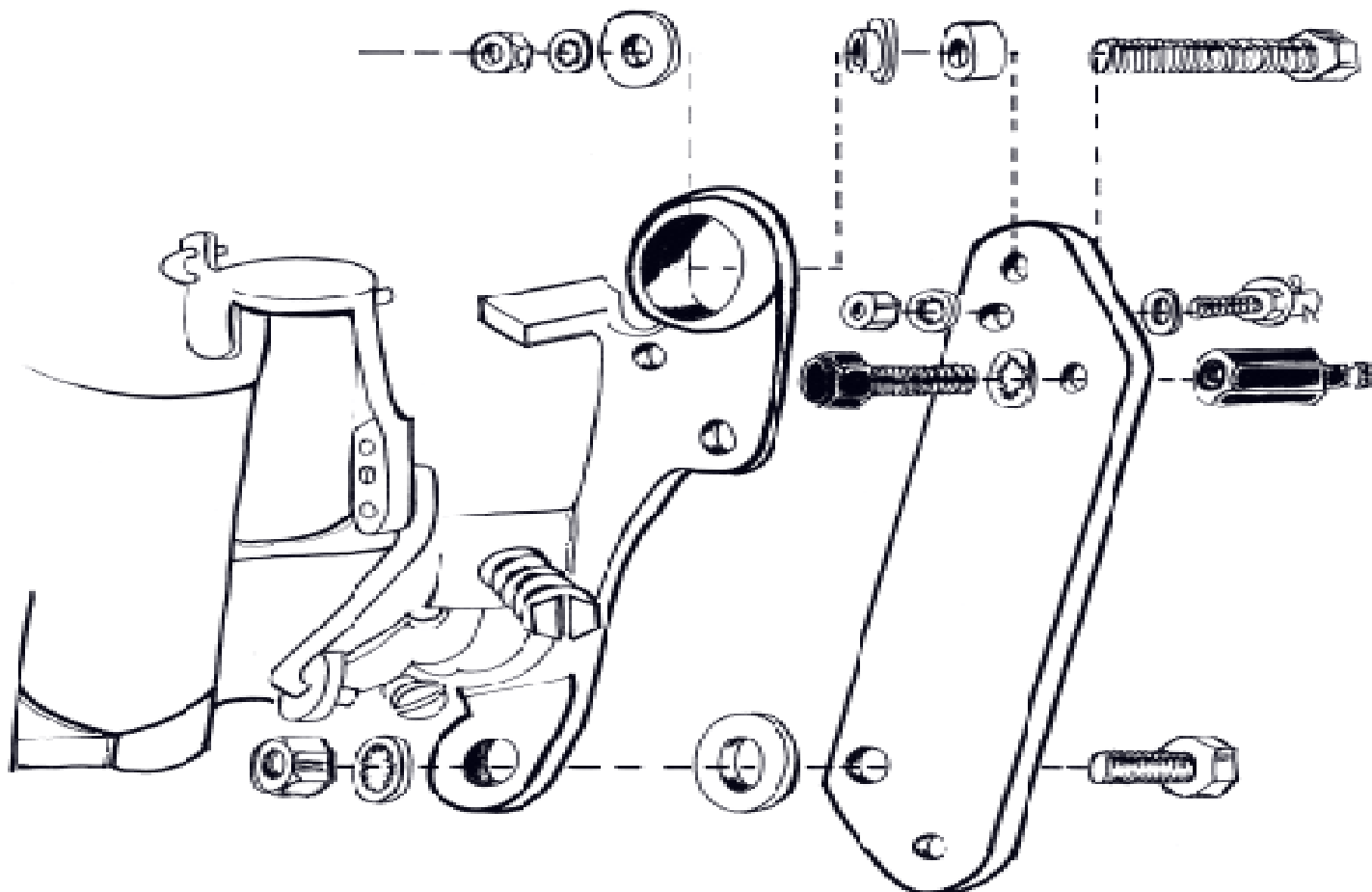

**Kit Contents:**

- |                          |                              |                       |                    |
|--------------------------|------------------------------|-----------------------|--------------------|
| 1—Cruise Control Bracket | 1—10-32x1" Hex Cap Screw     | 2—10-32 Hex Nuts      | 1—Step Washer      |
| 1—Bushing                | 2—1/4-20x3/4" Hex Cap Screws | 1—Throttle Cable Stud | 1—1/4" Thin Washer |
| 1—Cotter Pin             | 1—3/16" AN Washer            | 1—Large Flat Washer   | 2—10 Lockwashers   |
| 1—Cruise Control Stud    | 1—3/8" Thick Washer          | 1—1/4" x 20 Hex Nut   | 2—1/4" Lockwasher  |

**Installation of Adapter**

- A. Follow the PERFORMER SERIES CARBURETOR INSTALLATION INSTRUCTIONS included with the carburetor. During step 1 of the "PREPARATION OF CARBURETOR FOR INSTALLATION" section you should attach the Cruise Control Adapter to the existing throttle lever using the appropriate bolts, lockwashers, and nuts, making sure the adapter is secured properly.
- B. Continue to install the carburetor using the PERFORMER SERIES CARBURETOR INSTALLATION INSTRUCTIONS.