

# FLOWMASTER™

THE EXHAUST TECHNOLOGY COMPANY™

Congratulations on your purchase of a new Flowmaster™ *universal H-pipe kit.*

2¼" kit #15919

2½" kit #15920

3" kit #15921

We here at Flowmaster™ take pride in being *The Exhaust Technology Company™*, where our mission is to provide the most technologically advanced, highest quality exhaust products in the world.

**The following are some helpful tips when installing your system:**

For installation into an existing system, look at the system and locate a section of tubing with enough straight area and also enough clearance to allow you to cut 7.50" out of both exhaust pipes, this will allow you to slide the welded H-pipe onto one side of the cut out section and then slide it back to fill the gap. Also, before welding or clamping the T-connector into place, you will need to measure and possibly trim either the straight or the bent crossover for installation into the side assembly slip-fits. Be sure when installing the H-pipe that the entire assembly has enough clearance to prevent any damage to the vehicle, a minimum of ¾" is recommended.



15919	15920	15921
(2) 268TB T-CONNECTER	(2) 267TB T-CONNECTER	(2) 269TB T-CONNECTER
(1) TB299 CROSSOVER-STRAIGHT	(1) TB299 CROSSOVER-STRAIGHT	(1) TB306 CROSSOVER-STRAIGHT
(1) TB16090 CROSSOVER-BENT	(1) TB16090 CROSSOVER-BENT	(1) TB16162 CROSSOVER-BENT
(1) PK919 PARTS KIT	(1) PK920 PARTS KIT	(1) PK921 PARTS KIT
(2) MC200S 2" CLAMPS	(2) MC200S 2" CLAMPS	(2) MC250S 2-1/2" CLAMPS
(4) MC214S 2-1/4" CLAMPS	(4) MC250S 2-1/2" CLAMPS	(4) MC300G 3" CLAMPS

# UNIVERSAL H-PIPE KITS

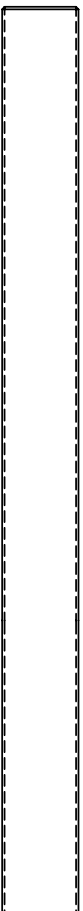
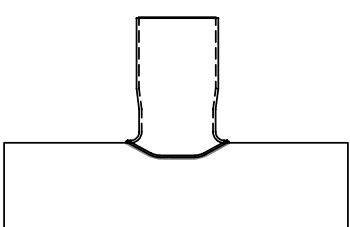
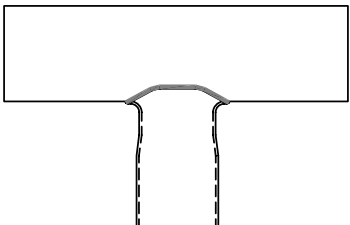

## PACKING LIST

### 2-1/4" KIT # 15919

- (2) 268TB T-CONNECTOR
- (1) TB299 CROSSOVER-STRAIGHT
- (1) TB16090 CROSSOVER-BENT
- (1) PK919 PARTS KIT
- (2) MC200S 2"CLAMPS
- (4) MC214S 2-1/4"CLAMPS

### 2-1/2" KIT # 15920

- (2) 267TB T-CONNECTOR
- (1) TB299 CROSSOVER-STRAIGHT
- (1) TB16090 CROSSOVER-BENT
- (1) PK920 PARTS KIT
- (2) MC200S 2"CLAMPS
- (4) MC250S 2-1/2"CLAMPS

### 3" KIT # 15921

- (2) 269TB T-CONNECTOR
- (1) TB306 CROSSOVER-STRAIGHT
- (1) TB16162 CROSSOVER-BENT
- (1) PK921 PARTS KIT
- (2) MC250S 2-1/2"CLAMPS
- (4) MC300G 3"CLAMPS