

6311231
2015 Chevrolet Silverado
2500/3500 HD



6311231
2015 Chevrolet Silverado
2500/3500 HD

2015 Chevrolet Silverado 2500/3500 HD Torch Series LED Light Grille 1pc

TOOLS REQUIRED:

Flat Head Screwdriver
Phillips Head Screwdriver
10mm Socket
Ratchet & Extensions
3/16" Drill Bit
Power Drill
Cutting Wheel

PARTS LIST

(6) #8x3/4" Screws
(6) #8 Flat Nuts
(6) Retaining Clips

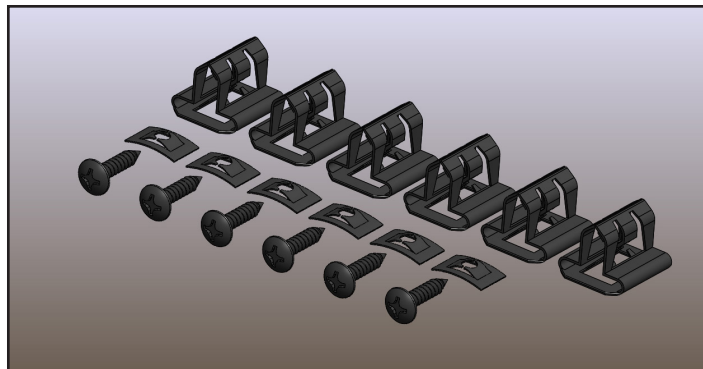

NOTE:

- We recommend painting all areas exposed behind grille black prior to installing for best results.

PLEASE READ AND UNDERSTAND ALL INSTRUCTIONS BEFORE INSTALLATION. Auto makers offer varied models to each vehicle and occasionally manufacture more than one body style of the same model. To assure your part is correct; our tech department can be contacted at tech@trexbillet.com to verify fitment or assist with tech questions. All other inquiries can be directed to info@trexbillet.com. In the event you do not have internet access please call 1-800-287-5900.

Step 1

Open hood and remove the 12 plastic push clips securing the plastic radiator shroud to the radiator core. Carefully use a flat head screwdriver to release the clip up, you can now remove the clips. Once all clips have been removed the plastic radiator shroud can be removed. (Fig 1)

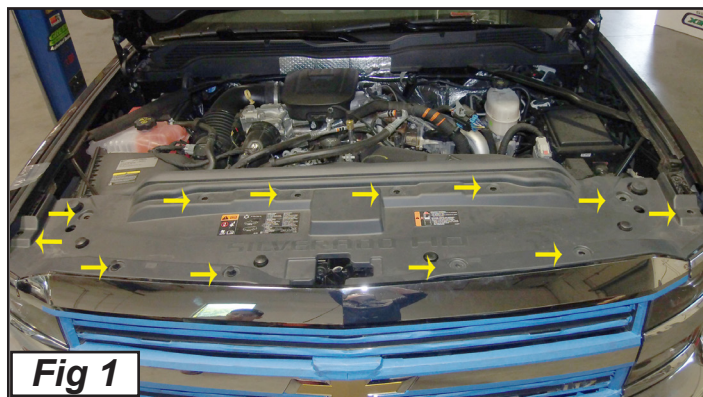

Step 2

Using your 10mm socket and ratchet remove the four (4) 10mm bolts securing the upper grille assembly to the radiator support. (Fig 2)





Step 3

Gently lift the top of grille assembly up while pulling back at the same time. Depress the four (4) release tabs located on the inside of the factory grille assembly with your flat head screwdriver. Firmly grasp the grille pulling away from the vehicle to remove it. (Fig 3)

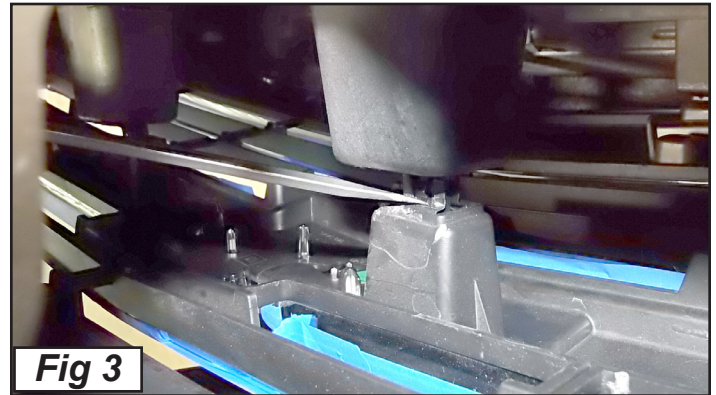

Fig 3

Step 4

Using a cutting wheel or saw, carefully cut the upper portion from the grille assembly. Discard lower portion of the grille. (Fig 4)

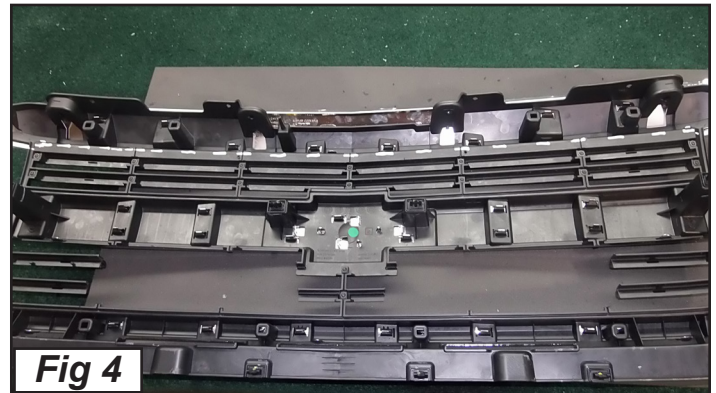

Fig 4

Step 5

Remove the two lights from the new grille assembly and set to the side. Position the new grille with the upper portion of the factory grille. Using the holes on the new grille as a guide, drill (6) holes into the factory grille. Use a pair of locking pliers to assist in drilling. (Fig 5)



Fig 5

6311231

2015 Chevrolet Silverado
2500/3500 HD



6311231

2015 Chevrolet Silverado
2500/3500 HD

Step 6

Attach the two grille pieces with the screws and flat nuts. On the two bars second from both ends, omit the flat nuts and screw these directly into the grille bars. (Fig 6). You can now reattach the LED lights removed in step 5.



Step 7

Attach the metal mounting clips to the bottom (4) tabs on the grille. (Fig 7)



Step 8

On the inner radiator shroud trim a small amount of plastic from the upper edges on both sides. This ensures the LED lights will clear. On some models trimming of the intake duct will also be necessary. (Fig 8)



Step 9

Your installation is now complete. Reattach the grille assembly back to the vehicle in reverse order of removal. Make sure you reconnect all disconnected wiring harness and reattach all clips and screws. Wire the LED Light Bar via our optional wiring harness kit (part# 639HAR1) or custom wiring harness. We recommends Torch Grilles be wired with our optional wiring harness kit (part#639HAR1). Light bars are installed flush with the grille from the factory. This may or may not be ideal for each light depending on the configuration of your vehicle and its options and or modifications. To adjust the angle of your Light Bar, rotate the Light Bar to adjust the angle, then tighten the hardware once the desired angle is achieved (please be careful not to over tighten the mounting hardware or scratch the finish of the grille). It is best to adjust the angle with the vehicle on level ground with lights facing a wall, garage door or other solid barrier. We recommend checking from a distance of 25'. Your installation is now completed. (Fig 9)

