

## INSTALLATION INSTRUCTIONS AND PARTS LIST

VEHICLE APPLICATION: MODEL 250740 (12.00" X 20.00") AND 250743 (12.00" X 23.00")  
**NO DRILL FRONT OR REAR RUBBER SPLASH GUARDS**  
2007 AND NEWER GM PICKUPS

1. READ INSTRUCTIONS COMPLETELY AND CHECK TO MAKE SURE THAT ALL REQUIRED PARTS (LISTED ON SERVICE PARTS LIST) ARE ON HAND BEFORE STARTING THE INSTALLATION.

### **MOUNTING 250740 OR 250743 SPLASH GUARDS ON THE FRONT: (SEE SHEET #2)**

2. INSTALL THE SPLASH GUARDS AS FOLLOWS:
  - 2.1 REMOVE TWO FACTORY HEX HEAD SEMS SCREWS (**THESE SCREWS ARE NOT REUSED**) AND THE BOTTOM INBOARD PLASTIC PUSH IN FASTENER THAT RETAIN THE WHEEL WELL LINER TO THE WHEEL WELL FLANGE.
  - 2.2 POSITION THE SPLASH GUARD AGAINST THE WHEEL WELL FLANGE AND FASTEN AS FOLLOWS. INSTALL TWO HEX HEAD SEMS SCREWS (ITEM #8) THRU THE TOP AND SECOND HOLE DOWN FROM THE TOP IN THE SPLASH GUARD. INSTALL A 1/4 X 1-1/4" SOCKET BUTTON HEAD SCREW (ITEM #5), 1/4" FENDER WASHER (ITEM #7) AND 1/4-20 SERR FLANGE NUT (ITEM #6) THRU THE BOTTOM INBOARD HOLE AS SHOWN.
  - 2.3 LOCATE THE SPLASH GUARD IN OR OUT AS DESIRED, LEVEL THE SPLASH GUARD AND TIGHTEN THE FASTENERS.

### **MOUNTING 250740 OR 250743 SPLASH GUARDS ON THE REAR WITH NO DRILL CLIPS: (SEE SHEET #3)**

3. TAKE THE NO DRILL CLIPS (ITEM #5) AND MULTI THREAD U-NUTS (ITEMS #6) AND A SPLASH GUARD AND ASSEMBLE AS FOLLOWS:
  - 3.1 ASSEMBLE CLIPS (ITEM #5) AND U-NUTS (ITEM #6) TOGETHER.
  - 3.2 STARTING WITH THE BOTTOM HOLE (ROUND HOLE) ASSEMBLE THE SCREW AND WASHERS THROUGH THE SPLASH GUARD AND INTO THE CLIP. **DO NOT TIGHTEN ALL THE WAY.**
  - 3.3 POSITION THE SPLASH GUARD AGAINST THE WHEEL WELL FLANGE AND HOOK THE CLIP BEHIND IT WITH THE SERRATED EDGE ON THE WHEEL WELL FLANGE. TIGHTEN FINGER TIGHT.
  - 3.4 INSTALL THE REMAINING CLIPS (2) THE SAME AS BEFORE, THIS TIME USING THE TWO TOP (OBLONG) HOLES AND MAKING SURE CLIPS HOOK BEHIND WHEEL WELL FLANGE. **(AS IN THE PICTURE ON SHEET #3)** AND FINGER TIGHTEN.
  - 3.5 LOCATE THE SPLASH GUARD IN OR OUT AS DESIRED, LEVEL THE SPLASH GUARD AND TIGHTEN THE FASTENERS.

### **MOUNTING 250740 OR 250743 MUDGUARDS ON REAR WITH FENDER WELL LINER: DRILL APPLICATION**

1. HOLD MUDGUARD UP AND LINE HOLES UP WITH THE FENDER FLANGE SO THAT ALL 3 HOLES LINE UP ON CENTER OF FLANGE, MARK HOLES. DRILL 5/16" HOLES.
2. SLIDE U-NUT (ITEM# 6) ON EACH DRILLED HOLE, THEN PLACE MUDGUARD ON, LINING UP THE HOLES ON MUDGUARD WITH THE U-NUTS, FASTEN WITH SCREW AND WASHER (ITEMS#8 & 9).
3. LOCATE THE MUDGUARD IN OR OUT AS DESIRED, LEVEL THE MUDGUARD AND TIGHTEN THE FASTENERS.



(A LIVERNE Company)

1200 E. Birch St.

Brandon, SD 57005

REVISED 20OCT10 LVL B  
REVISED 27JUL09 LVL A  
550092 SHEET 1 OF 3 19FEB08

SERVICE PARTS LIST

2007 GM PICKUPS  
MODEL NO. - 250740 & 250743

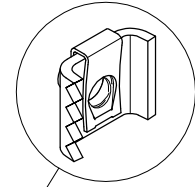

NOT USED IN FRONT APPLICATION

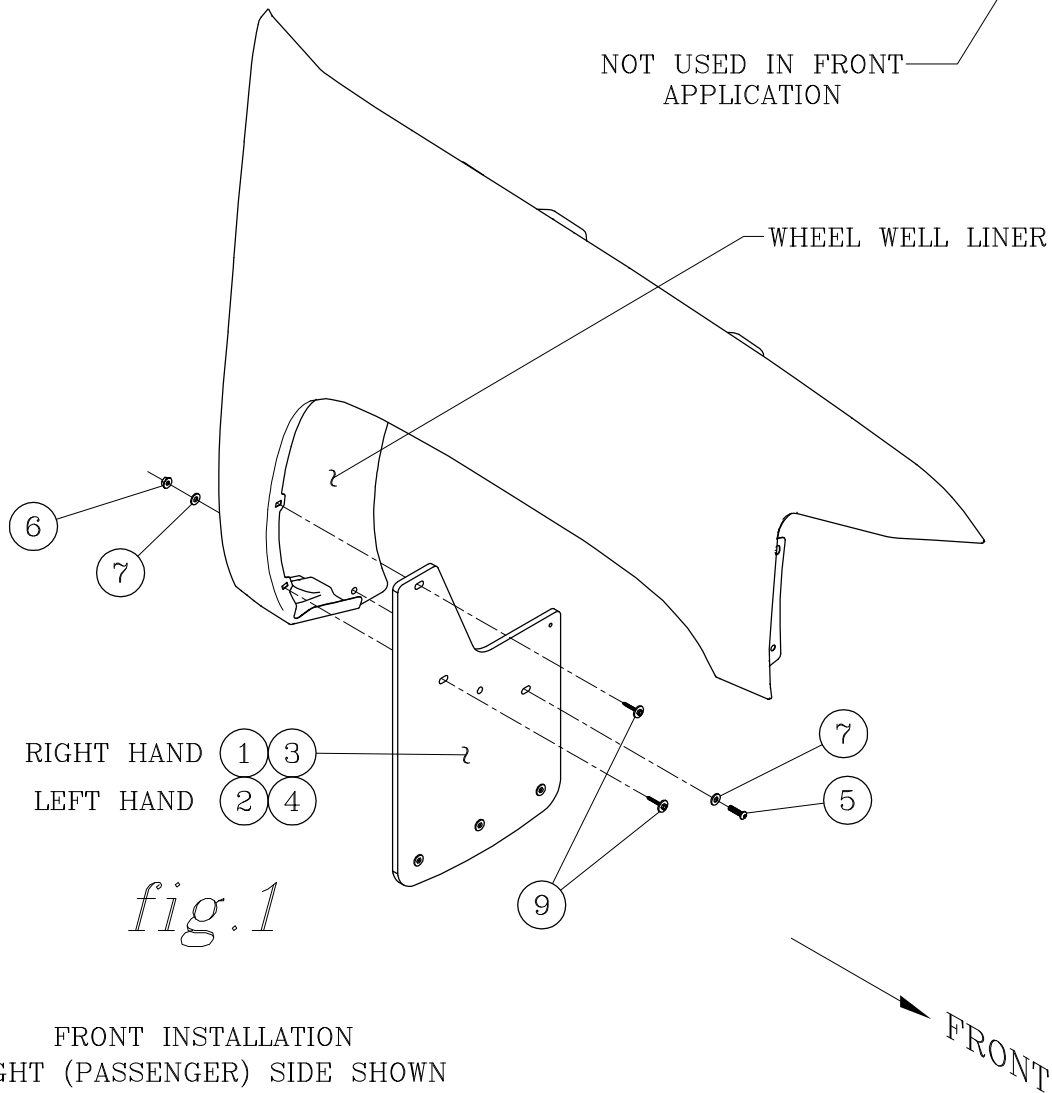

fig.1

FRONT INSTALLATION  
RIGHT (PASSENGER) SIDE SHOWN

ITEM	PART NO.	QTY	DESCRIPTION
1	550083	1	SPLASH GUARD-RUBBER,12 X 20,07,GM PICKUPS,RH
2	550084	1	SPLASH GUARD-RUBBER,12 X 20,07,GM PICKUPS,LH
3	550085	1	SPLASH GUARD-RUBBER,12 X 23,07,GM PICKUPS,RH
4	550086	1	SPLASH GUARD-RUBBER,12 X 23,07,GM PICKUPS,LH
5	108053	2	SCREW - BTN HD SOC, 1/4-20 X 1-1/4", SST, BZP
6	102366	2	NUT - HEX, SERR FLG,1/4-20, SST
7	108521	4	WASHER - FENDER, 1/4 X 1, SST, 18-8, BZP
8	105514	4	SCREW - SEMS, 7mm, HEX HD, M4.2-1.41 X 30mm



(A LUVERNE Company)

1200 E. Birch St.

Brandon, SD 57005

REVISED 20OCT10 LVL B  
REVISED 27JUL09 LVL A  
550092 SHEET 2 OF 3 19FEB08

SERVICE PARTS LIST

2007 GM PICKUPS  
MODEL NO. - 250740 & 250743

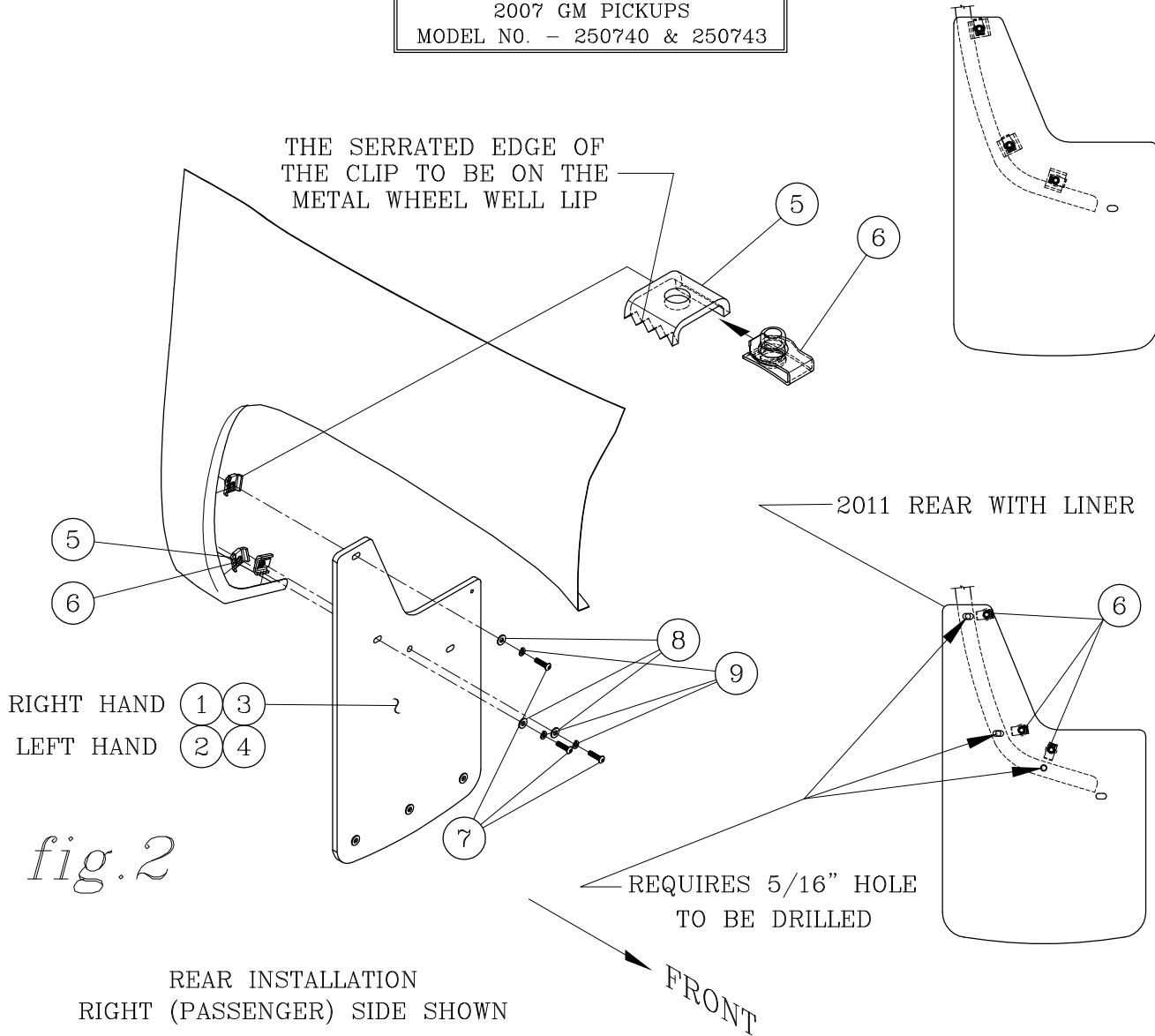

ITEM	PART NO.	QTY	DESCRIPTION
1	550083	1	SPLASH GUARD-RUBBER,12 X 20,07,GM PICKUPS,RH
2	550084	1	SPLASH GUARD-RUBBER,12 X 20,07,GM PICKUPS,LH
3	550085	1	SPLASH GUARD-RUBBER,12 X 23,07,GM PICKUPS,RH
4	550086	1	SPLASH GUARD-RUBBER,12 X 23,07,GM PICKUPS,LH
5	550058	6	BRACKET - NO DRILL CLIP, 07 GM PICKUP
6	106604	6	MULTI THREAD U-NUT - 1/4-20
7	108053	6	SCREW - BTN HD SOC, 1/4-20 X 1-1/4", SST, BZP
8	108521	6	WASHER - FENDER, 1/4 X 1, SST, 18-8, BZP
9	108522	6	WASHER - LOCK, 1/4, SST, 18-8, BZP

**LIVERNE**  
TRUCK EQUIPMENT

(A LIVERNE Company)

1200 E. Birch St.

Brandon, SD 57005

REVISED 20OCT10 LVL B  
REVISED 27JUL09 LVL A  
550092 SHEET 3 OF 3 19FEB08