

INSTALLATION INSTRUCTIONS AND PARTS LIST

MODEL 561512 BUMPER GRILLE INSERT

VEHICLE APPLICATION:
2015 AND NEWER CHEVROLET 2500 AND 3500 SERIES TRUCKS

READ INSTRUCTIONS COMPLETELY AND CHECK TO MAKE SURE THAT ALL REQUIRED PARTS (LISTED ON SERVICE PARTS LIST) ARE ON HAND BEFORE STARTING THE INSTALLATION

NOTE: FOR GAS VEHICLES INSTALL AS FOLLOWS

1. INSTALL THE 5/16"-18 U-NUT (ITEM #1) OVER THE HOLES LOCATED AT THE SIDES OF THE BUMPER OPENING WITH THE NUT PORTION FACING TOWARDS THE FRONT OF THE VEHICLE.
2. USING THE 5/16"-18 X .875" BOLTS (ITEM #2) AND 5/16" LOCK WASHERS (ITEM #3) INSTALL THE RH AND LH BRACKETS (ITEM #4, 5). CHECK THAT EVERYTHING IS STRAIGHT AND SQUARE AND TIGHTEN BOLTS.

NOTE: WHEN INSTALLED CORRECTLY THE MOUNTING HOLES FOR THE INSERT WILL BE AT THE BOTTOM OF THE BRACKET.

NOTE: FOR DIESEL VEHICLES INSTALL AS FOLLOWS

1. REMOVE THE BOLTS LOCATED AT THE SIDES OF THE BUMPER OPENING.
2. USING THE SAME BOLTS INSTALL THE RH AND LH BRACKETS (ITEM #4, 5). CHECK THAT EVERYTHING IS STRAIGHT AND TIGHTEN BOLTS.

NOTE: WHEN INSTALLED CORRECTLY THE MOUNTING HOLES FOR THE INSERT WILL BE AT THE BOTTOM OF THE BRACKET.

3. USING THE 1/4"-20 FLANGE NUTS (ITEM #6), 1/4"-20 BUTTON HEAD BOLT (ITEM #7) AND 1/4" LOCK WASHERS (ITEM #8) INSTALL THE GRILLE INSERT (ITEM #9).
4. ADJUST THE INSERT TO MAKE IT LEVEL AND TIGHTEN BOLTS.

SERVICE PARTS LIST

ITEM	PART NO.	QTY	DESCRIPTION
1	105541	4	U-NUT 5/16"-18
2	104281	4	SCR-CAP, HEX, STL, 5/16"-18 X .875"
3	100030	4	WASHER - LOCK, 5/16", ZP
4	552504	1	BRKT-MTG, RH, 561512
5	552503	1	BRKT-MTG, LH, 561512
6	102366	4	NUT-SERR FLG, 1/4"-20, SST
7	105543	4	SCR-BTN HD, SST, 1/4"-20 X 1.00"
8	100017	4	WASHER - LOCK, 1/4", ZP
9	552507	1	GRILLE INSERT, 561512



(A LIVERNE Company)

1200 E. Birch St.

Brandon, SD 57005

552505 SHEET 1 OF 2 13AUG14

SERVICE PARTS LIST

MODEL NO. - 561512

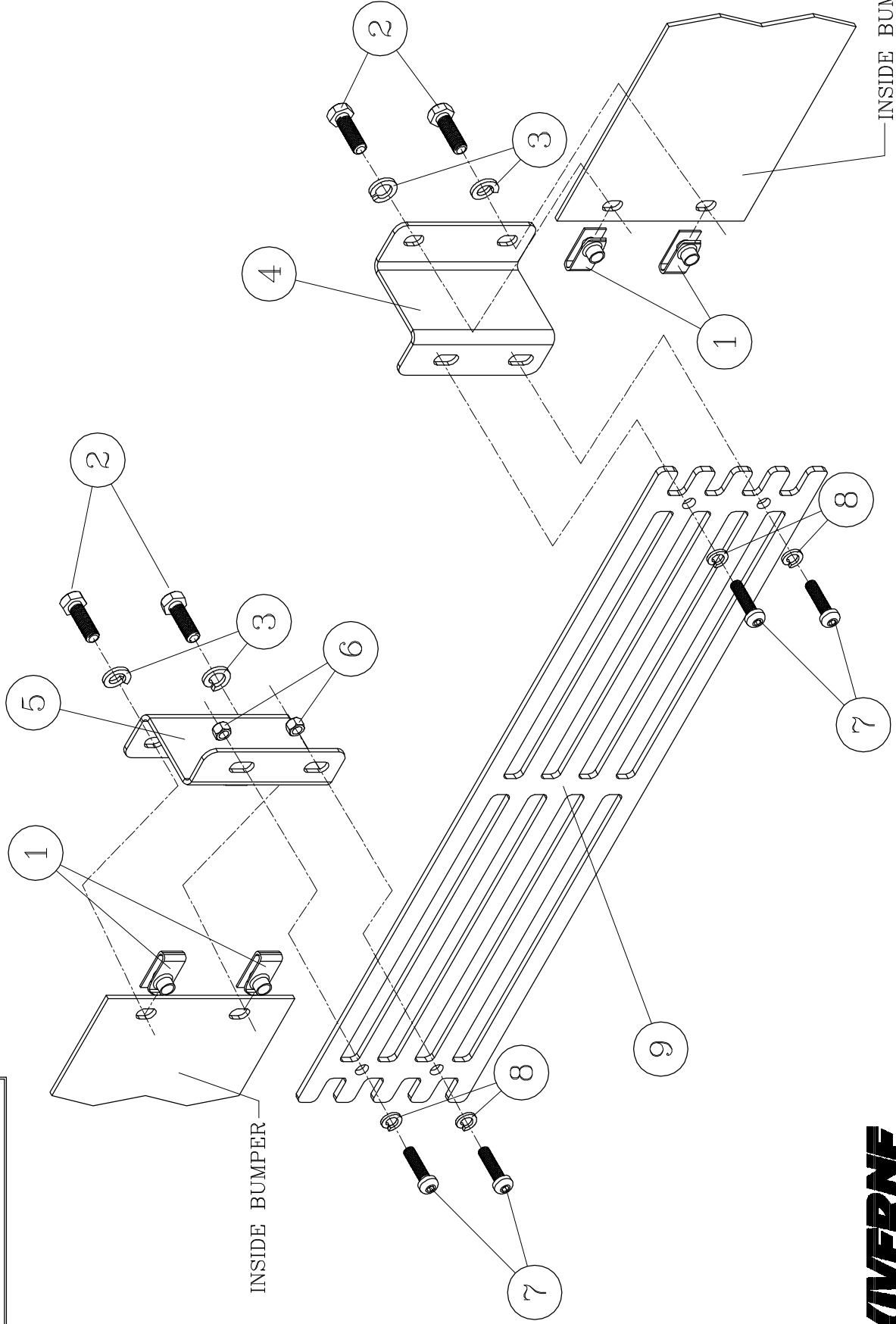

1200 E. Birch St.
Breckenridge, CO 80424