

# COMPETITION/PLUS<sup>®</sup>

U.S. PATENT NO. 3,216,274 & NO. 3,306,126

## FOUR SPEED FLOOR SHIFT INSTALLATION INSTRUCTIONS

CHECK NUMBERS STAMPED ON  
PARTS WITH NUMBERS SPECIFIED  
IN CONTENTS OF KIT

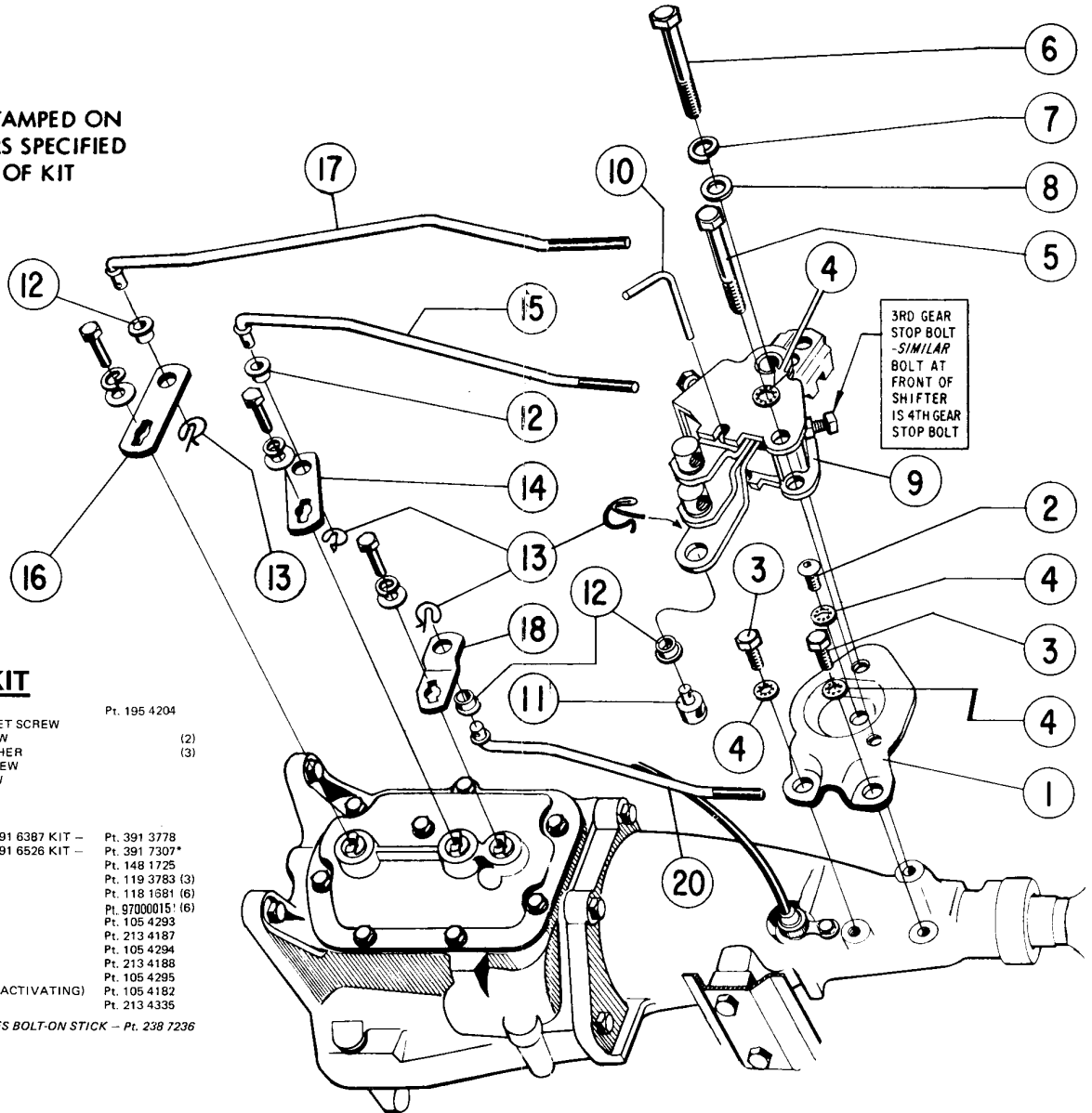

### CONTENTS OF KIT

- |  |                  |
|--|------------------|
| 1. MOUNTING PLATE                          | Pt. 195 4204     |
| 2. 3/8 - 16 x 5/8 BUTTON HEAD SOCKET SCREW |                  |
| 3. 3/8 - 16 x 5/8 HEX HEAD CAP SCREW       | (2)              |
| 4. 3/8" INTERNAL TOOTH LOCKWASHER          | (3)              |
| 5. 3/8 - 24 x 2 3/4 HEX HEAD CAP SCREW     |                  |
| 6. 7/16 - 20 x 3 HEX HEAD CAP SCREW        |                  |
| 7. 7/16" SPLIT LOCKWASHER                  |                  |
| 8. 7/16 FLATWASHER                         |                  |
| 9. SHIFTER ASSEMBLY                        |                  |
| 291 6387 KIT -                             | Pt. 391 3778     |
| 291 6526 KIT -                             | Pt. 391 7307*    |
| 10. NEUTRAL ALIGNMENT ROD                  | Pt. 148 1725     |
| 11. ROD ADJUSTING BUTTON                   | Pt. 119 3783 (3) |
| 12. BUSHING                                | Pt. 118 1581 (6) |
| 13. SPRING CLIP                            | Pt. 97000015 (6) |
| 14. ARM 1-2                                | Pt. 105 4293     |
| 15. ROD 1-2                                | Pt. 213 4187     |
| 16. ARM 3-4                                | Pt. 105 4294     |
| 17. ROD 3-4                                | Pt. 213 4188     |
| 18. ARM REVERSE                            | Pt. 105 4295     |
| 19. ARM (BACK-UP LIGHT SWITCH ACTIVATING)  | Pt. 105 4182     |
| 20. ROD REVERSE                            | Pt. 213 4335     |

\* Pt. 391 7307 SHIFTER ASSEMBLY USES BOLT-ON STICK - Pt. 238 7236  
BAGGED HARDWARE Pt. 154 4242

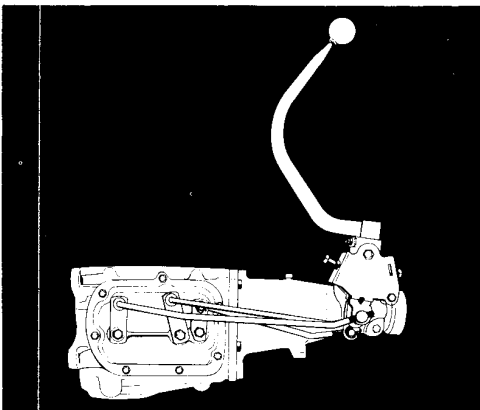

# 373 4297

