

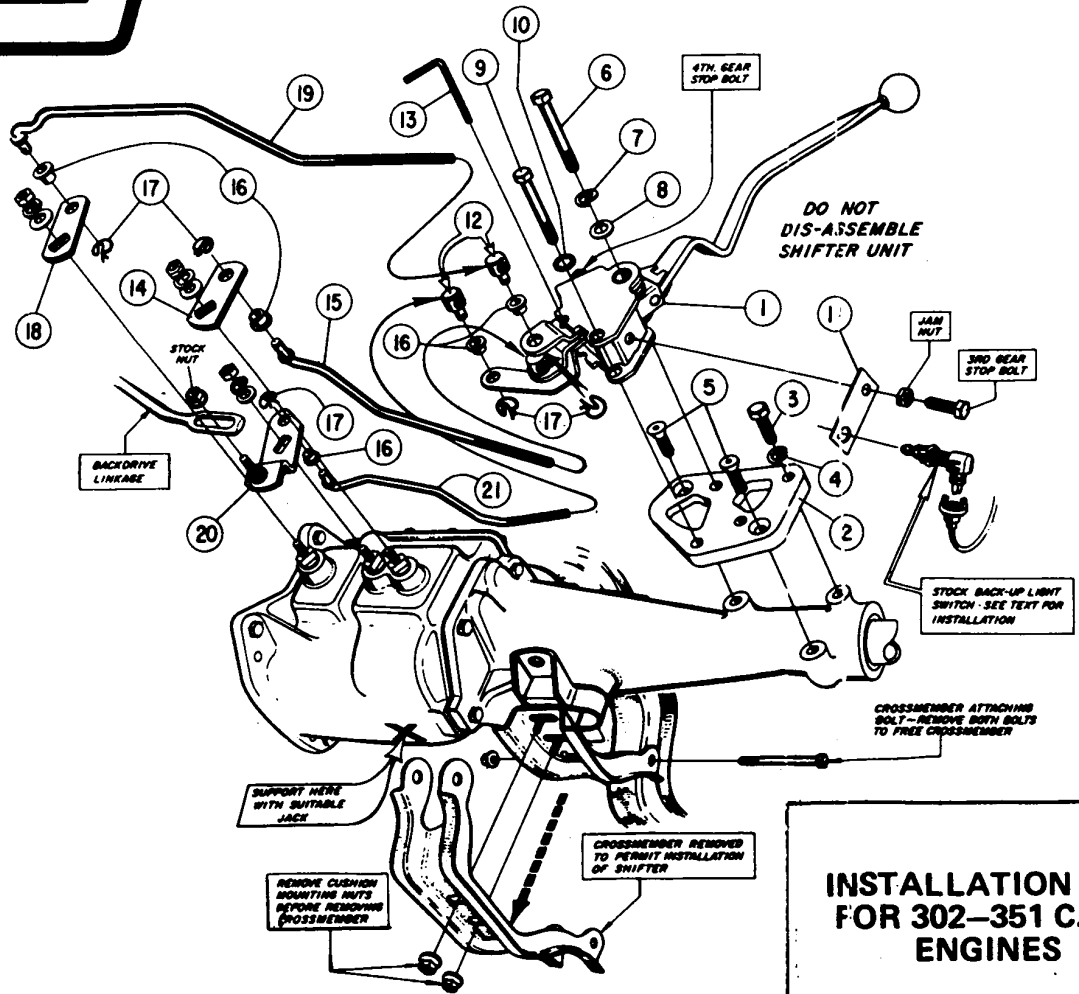

COMPETITION/PLUS®

U.S. PATENT NO. 3,216,274 & NO. 3,306,126



**INSTALLATION KIT
FOR 302-351 C.I.D.
ENGINES**

CONTENTS OF KIT

1. SHIFTER ASSEMBLY
2. MOUNTING PLATE
3. 5/16 - 18 x 1 HEX HEAD CAP SCREW
4. 5/16" SPLIT LOCKWASHER
5. 5/16 - 18 x 1 FLAT HEAD SOCKET SCREW
6. 7/16 - 14 x 3 HEX HEAD CAP SCREW
7. 7/16" SPLIT LOCKWASHER
8. 7/16" FLATWASHER
9. 3/8 - 16 x 2-3/4 HEX HEAD CAP SCREW
10. 3/8" INTERNAL TOOTH LOCKWASHER
11. BACK-UP LIGHT SWITCH BRACKET
12. ROD ADJUSTING BUTTON
13. ALIGNMENT ROD
14. ARM 1-2
15. ROD 1-2
16. NYLON BUSHING
17. SPRING CLIP
18. ARM 3-4
19. ROD 3-4
20. ARM REVERSE
21. ROD REVERSE

FM-4-70	FM-4-70-429
Pt. 373 7637	Pt. 373 7717
Pt. 391 3180	
Pt. 195 3176	Pt. 195 7719
	Not Used *
	(2)
Pt. 117 6889	
Pt. 119 3783	(3)
Pt. 148 1725	
Pt. 105 2723	
Pt. 213 1720	
Pt. 118 1681	(6)
Pt. 9700015	(6)
Pt. 105 2108	
Pt. 213 2774	
Pt. 105 7647	
Pt. 213 3207	

BAGGED HARDWARE Pt. 154 3183

*NOTE: This bolt (5/16 - 18 x 1 hex head cap screw) is not used with Bracket Pt. 195 7719. See exploded assembly view. Use stock Phillips flush head screw.

373 7637

