

Installation Instructions for Battery Box Kit 10260 and Replacement Battery Box 10261

1. Read All of the Instructions Before Beginning your Installation.
2. Locate a desirable position for the battery and box. Ideally the area behind the right rear tire is the best location for weight transfer. Make sure that the area beneath the selected location is clear of all brake lines, electrical wiring, frame, fuel cell (gas tank), fuel lines and spare tire before drilling.
3. Insert the battery into the box and install the **spacer block** to locate the battery within the box. Place the **H-frame hold down** over the top of the battery. Select a position to **slot the box** for the **90 degree tab** that slides into the **H-frame** (see **illustration 4**) and secures the **3/8" threaded bolts** which will be located outside of the battery box, preferably an offset location (see **illustration 2**). Use a center punch to dimple the trunk floor, once again checking for clearance as described in step 2 prior to drilling any holes.
4. Drill 11/32" holes. Secure the 3/8" threaded bolts with washers and the supplied lock nuts (see **illustration 1**). To be legal for competition the battery must be located behind a firewall in the trunk or hatch area.
5. Select a route for the **battery cables** avoiding objects that might damage the cables. Route the positive cable to the engine compartment. If necessary, drill an 11/16" hole to be used for a grommet to pass through the floor or firewall. Route the negative cable to the frame, roll bar or a tubing structure that protrudes into the trunk area in the same manner. Measure the desired length remembering to allow for any bends and for stripping the wire 3/4". Do not attach any of the connectors to the cable until the cable has been routed through the grommet(s).
6. Cut the cables to length, **strip the end 3/4"**, route through the grommet(s) and secure the cable end by soldering or crimping (see **illustration 3**).
7. Attach the negative cable to the frame or roll bar. Always remove any paint or debris and secure with supplied 3/8" bolt and star type washer. This will aid in charging and eliminate loosening from vibration transmitted through the frame.
8. Anchor the cables with the supplied **mounting clamps**.

Accessories that may assist you in the installation:

1. The Jeg's **Thru Panel Connector #555-10317** may be used instead of the rubber grommet to run the positive cable to the solenoid or starter. Our connector has a stud and nut on both sides for quick and easy installation.
2. An **engine ground strap**, if not already so equipped is recommended to help eliminate charging and starting problems. Jeg's **#555-10302 engine ground strap** is included in 555-10260 Battery Box Kit.
3. On race-only type vehicles we recommend the Jeg's Positive and Negative **Remote Charging Terminals #555-10315** and **555-10316** in addition to the **Jeg's Master Disconnect Switch and Faceplate #555-10305** and **555-10306**. Also see the new **billet switch handles** and **faceplates** in Jeg's catalog.

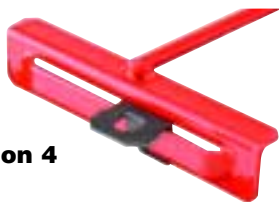

Illustration 4

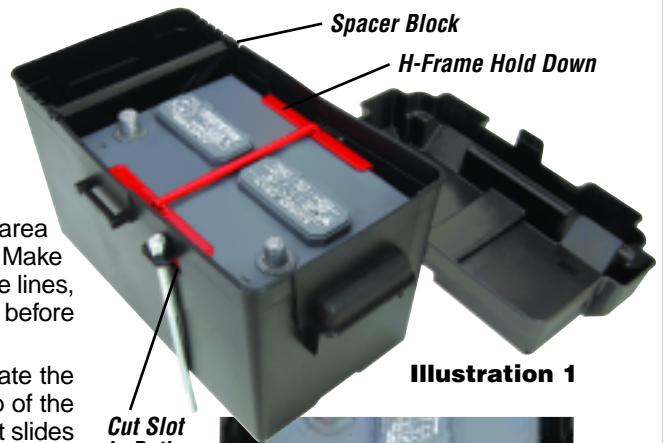

Illustration 1

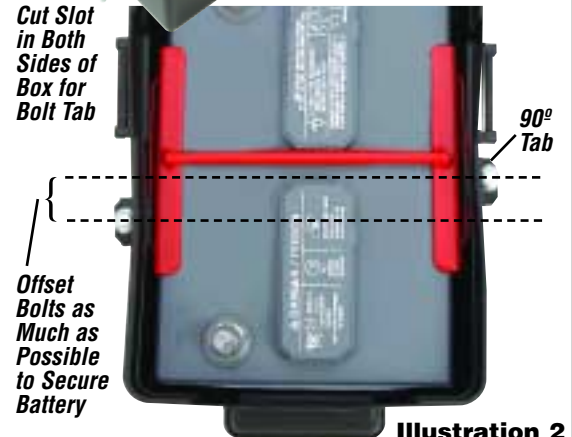
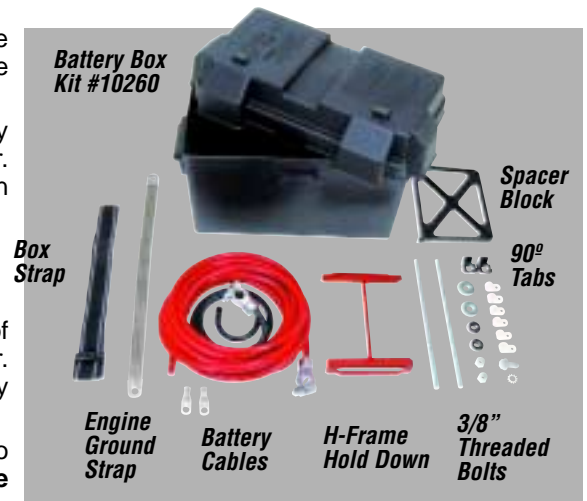

Illustration 2
Top View



Battery Box Kit #10260

Box Strap

Engine Ground Strap

Battery Cables

H-Frame Hold Down

3/8" Threaded Bolts

Spacer Block

90° Tabs

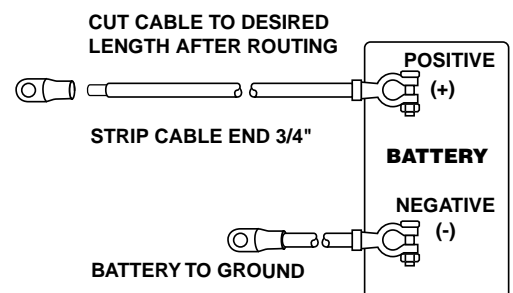

Illustration 3



1-800-345-4545

jegs.com