

Installation Instructions for Universal H-Pipe Kits 30650 (2-1/4"), 30651 (2-1/2"), 30652 (3")

Safety Guidelines

The installation begins with common sense! If the installation is not to be performed with the aid of a full size chassis lift, it is highly recommended that you support the vehicle with four heavy duty jack stands, one at each corner. The vehicle should be positioned on a hard, flat and level surface (asphalt in the summer can be very dangerous). NEVER use a bumper or scissor jack for support of your vehicle! ALWAYS use safety glasses.

Installation

1. Raise and secure the vehicle as described above.
2. Determine the best position for the H-pipe. Remember that each chassis is different and you will need to maintain adequate clearance between the automatic transmission shifter cable if so equipped, brake lines, crossmember, driveshaft, driveshaft safety loop, emergency brake cables and fuel lines. Two cross sections are included with the kit - a straight tube and a formed tube. If there is no obstruction between the exhaust pipes then use the straight tube. If there is an obstruction, use the formed tube.
3. Always check the clearances before cutting any of the pieces. Cut the exhaust pipes (manifolds or short headers) and slide the t-portion over the pipes or onto the reducers (long tube headers). Refer to the assembly diagram for one of the suggested installation locations.
4. Measure the distance between the fabricated t-portions. Add approximately 4" to 5" to this measurement to allow for the slip fit of the cross section tube. Cut the cross section tube to length. Remove both of the fabricated t-portions and slide the cross section tube into them. Then slide the assembled H-pipe onto the exhaust pipes (manifolds or short headers) or reducers (long tube headers) and install the front clamps and only tighten until snug. Then install the clamps on the cross section and only tighten until snug.
5. Reminder: If you're adding the H-pipe to an already existing exhaust system the fabricated t-portion will add between 4" to 9" to the overall length and will require trimming of the rear exhaust pipes to maintain the original system length. In either case, old system or new system, once the rear exhaust pipes have been cut to length slide them into the fabricated t-portion, install the clamps and only tighten until snug.
6. Start at the front of the H-pipe and tighten all of the clamps until secure. We recommend welding the finished assembly to minimize exhaust leaks and the periodic maintenance required. Once all of the seams are welded, remove the clamps. Test drive to check for any exhaust leaks. After the vehicle has gone through several heat cycles, go back and retighten the collector bolts and/or clamps.

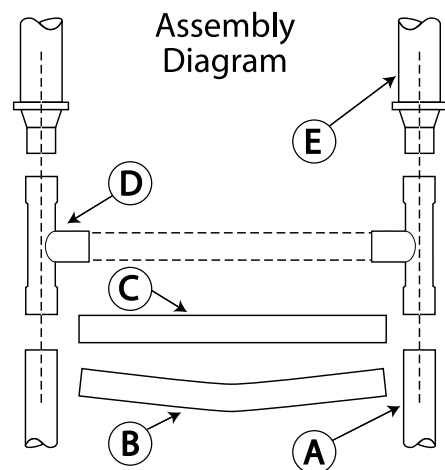

- (A) Exhaust Pipe
- (B) Formed Cross-Section Tube
- (C) Cross-Section Tube
- (D) Fabricated T-Portion
- (E) Collector

Disclaimer: For Off Road Use Only!

THE REGULATION OF EMISSION PRODUCTION, NOISE LEVELS AND SAFETY STANDARDS IS UNDERTAKEN BY THE FEDERAL GOVERNMENT, EACH OF THE FIFTY STATE LEGISLATURES AND BY MANY LOCAL MUNICIPALITIES, TOWNS AND COUNTRIES.



1-800-345-4545 jegs.com