

# Assembly Guide for 81245

## Gantry Crane

1-Ton Capacity



# Parts List

1	(24) Bolt [M15 x 35mm]
2	(28) Washer [M12]
3	(28) Lock Washer [M12]
4	(28) Nut [M12]
5	(8) Bolt [M14 x 40mm]
6	(8) Washer [M14]
7	(8) Lock Washer [M14]
8	(8) Nut [M14]
9	(4) Bolt [M12]
10	(2) Bolt [M10 x 180mm]
11	(4) Nut [M10]
12	(4) Bolt [M8 x 40mm]
13	(4) Nut [M8]
14	(4) Bolt [M12 x 100mm]
15	(16) Bolt [M10 x 30mm]
16	(16) Lock Washer [M10]
17	(16) Nut [M10]
18	(4) Pin
19	(1) Crossbeam
20	(4) Plate
21	(2) Inner Vertical Post
22	(4) Support Tube
23	(2) Outer Vertical Post
24	(2) Handle
25	(4) Pin
26	(2) Base Assembly
27	(4) Swivel Caster

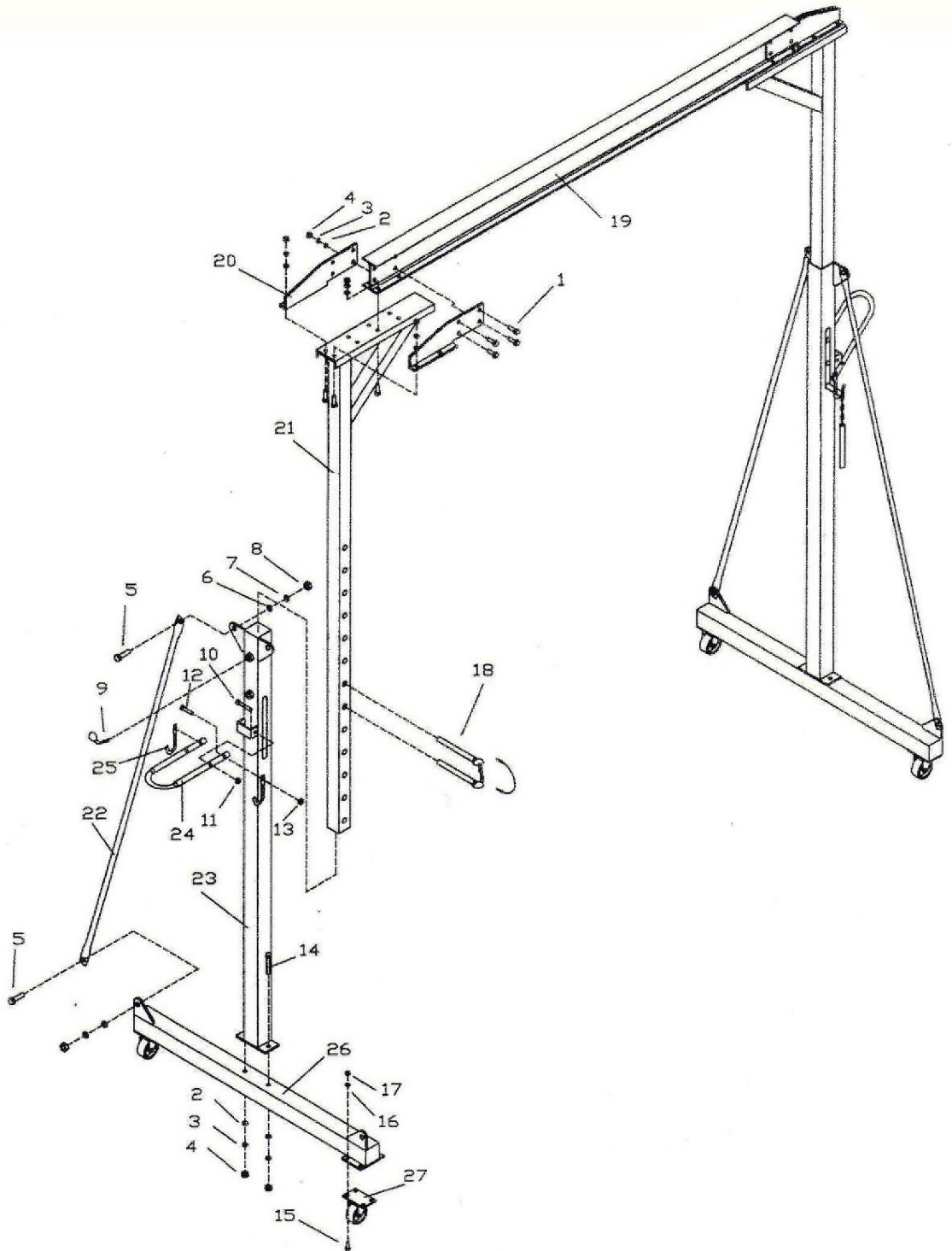

## Read Before Installation

Thank you for your purchase of this JEGS 1-Ton Gantry Crane.

Before assembly, please be sure to verify that all of the kit components have been received. Reference the parts list on the previous page. If any components are missing or damaged please contact customer service at: 1.800.345.4545.

Assembly of this kit can be done with basic hand tools. If you are having issues, or have questions regarding the assembly of this gantry crane, please contact our technical support department at: 1.800.345.4545.

If you are not comfortable assembling this kit on your own, please consult a professional. For your safety, the hazardous nature of this tool requires that it be assembled correctly.

The JEGS Gantry Crane does not come with a trolley (555-81247) or hoist (555-81249). These components are available separately at [www.jegs.com](http://www.jegs.com).

Do not operate this tool until you have read and understand this user guide. Always wear safety goggles and work gloves. Avoid loose fitting clothing and hanging jewelry and hair.

**Return Information:** Before modifying any of the parts in this kit, please trial fit all components. **Modified parts will not be accepted for return.**

## Assembly

Do not fully tighten hardware before final assembly. This allows everything fits properly.

1. Attach 2 plates (#20) to two sides on the one end of the Crossbeam (#19). Secure with 4 bolts (#1), 4 washers (#2), 4 spring washers (#3), and 4 nuts (#4). Repeat for another end.
2. Attach each Inner Vertical Post Assembly (#21) to the Crossbeam (#19), secure with 8 bolts (#1), 8 washers (#2), 8 spring washers (#3), and 8 nuts (#4)
3. Attach the 4 Swivel Casters (#27) to the Gantry Base Assembly (#26). Apply grease to the zerk fittings located on each caster for proper function.
4. Attach each Outer Vertical Post Assembly (#24) to each Base Assembly (#26) making certain that the slot at two sides of the Outer Vertical Post Assembly are facing to the castors direction. From the top, insert 2 Bolts (#14) through the base of the Outer Vertical Post Assembly, and into the Base Assembly. Slip on 2 Washers (#2), 2 Spring Washers (#3) and secure with 2 Nuts (#4).
5. Attach 2 Support Tubes (#22) to each Outer Vertical Post Assembly (#23). Insert 1 Bolt (#5) through the top of the Support Tube, and through the eyelet. Slip on 1 Washer (#6), 1 Spring Washer (#7) and secure with 1 Nut (#8). Attach the other end of support tube to the base assembly by bolts, washers, spring washers, and nuts. Repeat for all 4 Support Tubes.
6. Insert the Inner Vertical Post (#21) into the Outer Vertical Post (#23). Insert 1 Pin (#18)

Continued Onto Next Page →

## **Assembly Contd.**

of the Pins with Chain through the slot and the Inner Vertical Post hole so that it goes all the way through, let the other pin. Attach the Handle (#24) to the bracket on the side of Outer Vertical Post, insert 1 Bolt (#10) from the inside, slip on 1 Washer (#14), 1 Spring Washer (#15) and secure with 1 Nut (#11). Make sure the 2 hooks of the handle hold the two ends of the Pin (#18). Repeat for another post assembly.

7. Tighten all the Bolts and Nuts securely and make certain that the entire assembly is tight and secure.
8. At this time you can install your trolley and hoist, not included with this gantry.

## **User Guide**

### **Raising the Crossbeam**

1. Raising the crossbeam requires 2 people.
2. On the Outer Vertical Post Assemblies (#23) there are 2 Handles (#24) with hooks. With the handle in the raised position, place the hooks on either side of the lower pin and pull the handle downward. This will raise the Inner Vertical Post (#21) by one hole.
3. Insert the second pin into the newly exposed hole to hold the crossbeam at this height.
4. To raise another level, remove the upper pin and repeat the process rotating the pins as you go.
5. Repeat this process to continue raising the gantry. There are 13 positions.

### **Lowering the Crossbeam**

1. Lowering the crossbeam requires 2 people.
2. On the Outer Vertical Post Assemblies (#23) there are 2 Handles (#24) with hooks. With the handle in the raised position, place the hooks on either side of the upper pin and pull the handle downward. This will raise the Inner Vertical Post (#21) enough to remove the lower pin.
3. Slowly raise the handles and let the inner post slide downward until it rests on the pin.
4. To go another level lower, inset a second pin into the hole above the lower pin, reattach the handle hooks and repeat the above steps.
5. Repeat this process to continue lowering the gantry. There are 13 positions.

### **Lifting an Item**

1. Situate crane directly above the item that is to be lifted.
2. Lock the casters to prevent unwanted movement.
3. Adjust the gantry crossbeam height as needed
4. Carefully and securely attach the item to the crane using a trolley, and hoist.
5. Using either the trolley, hoist, or both, lift the item.