

V-Force Wiring Pin Outs**Part # 67027,67028****INFINITI**

<u>Year</u>	<u>Model</u>	<u>Engine</u>	<u>TPS WIRE Color</u>	<u>TPS Location</u>	<u>MAF/ MAP Wire Color</u>	<u>MAF/ MAP PIN TERM#</u>	<u>MAF/ MAP Location</u>	<u>Footnotes</u>
2008-2012	EX35	3.5L	YELLOW	1	LT BLUE	#3	J	(**)
2011-2012	FX35	3.5L	YELLOW	1	LT BLUE	#3	J	(**)
2009-2012	FX50	5.0L	BLUE	1	BLUE	#3	J	(**)
2000	G20	2.0L	YELLOW	1	WHITE	N/A	G	
2001-2002	G20	2.0L	YELLOW	1	BLUE	# 1	F	(**)
2011-2012	G25	2.5L	RED	1	WHITE	#3	I	(**)
2003	G35	3.5L	WHITE	1	LT GRN	# 1	F	(**)
2004-2007	G35 2 DOOR	3.5L	WHITE	1	ORANGE	# 4	F	(**)
2004-2007	G35 SEDAN	3.5L	YELLOW	1	LT BLU	N/A	F	(**)
2008-2012	G37	3.7L	RED	1	LT BLU	#3	J	(**)
2000-2001	I30	3.0L	BLU/WHT	1	WHITE	N/A	H	
2002-2004	I35	3.5L	WHITE	1	WHITE	# 1	F	(**)
2006-2008	M35	3.5L	WHITE	1	WHITE	# 4	E	(**)
2009-2010	M35	3.5L	ORANGE	1	BLUE	# 4	J	(**)
2011-2012	M37	3.7L	ORANGE	1	BLUE	N/A	H	
2003-2004	M45	4.5L	BLK/WHT	1	BLK/YEL	# 1	A	(**)
2005	M45	4.5L	BLACK	1	BLK/YEL	# 4	A	(**)
2006-2010	M45	4.5L	WHITE	1	WHITE	# 4	E	(**)
2011-2012	M56	5.6L	RED	1	RED	N/A	K	
2004-2010	QX56	5.6L	BLACK	1	WHITE	# 4	E	(**)
2011-2012	QX56	5.6L	RED	1	PURPLE	N/A	H	

NISSAN

<u>Year</u>	<u>Model</u>	<u>Engine</u>	<u>TPS WIRE Color</u>	<u>TPS Location</u>	<u>MAF/ MAP Wire Color</u>	<u>MAF/ MAP PIN TERM#</u>	<u>MAF/ MAP Location</u>	<u>Footnotes</u>
1995-1998	200SX	1.6L	YELLOW	1	GREEN	N/A	A	(**)
1995-1998	200SX	2.0L	YELLOW	1	ORANGE	N/A	A	(**)
1990-1998	240SX	ALL	WHITE	1	WHITE	N/A	A	(**)
1993-1997	300ZX	ALL	WHITE	1	WHITE	# B	A	(**)
1998-2000	300ZX	ALL	WHITE	1	WHITE	# 5	A	(**)
2003-2006	350Z	ALL	GREEN	1	ORANGE	# 4	A	(**)
2007-2009	350Z	ALL	BLUE/GRN	1	BLU/WHT	# 4	B	(**)
2009-2012	370Z	ALL	YELLOW	1	LT. BLUE	#3	B	(**)
1998-2001	ALTIMA	ALL	YELLOW	1	BROWN	# 1	A	(**)
1993-1997	ALTIMA	ALL	WHITE	1	ORANGE	# D	B	(**)

MAF/ MAF/ MAF/

<u>Year</u>	<u>Model</u>	<u>Engine</u>	<u>TPS WIRE</u> <u>Color</u>	<u>TPS</u> <u>Location</u>	<u>MAP Wire</u> <u>Color</u>	<u>MAP PIN</u> <u>TERM#</u>	<u>MAP</u> <u>Location</u>	<u>Footnotes</u>
2002-2006	ALTIMA	ALL	WHITE	1	YEL/GRN	# 5	A	(**)
2007-2009	ALTIMA	ALL	RED	1	ORANGE	# 3	B	(**)
2010-2012	ALTIMA	ALL	RED	1	GREY	#3	B	(**)
2004-2012	ARMADA	ALL	BLACK	1	WHITE	# 4	E	(**)
2009-2012	CUBE	ALL	LT. GREEN	1	GREEN	# 3	F	(**)
1990-1995	FRONTIER	ALL	BLUE	1	RED	# 4	A	(**)
2001-2005	FRONTIER	ALL	BLUE	1	RED	# 4	D	(**)
2006-2012	FRONTIER	ALL	WHITE	1	PINK	# 4	E	(**)
2011-2012	JUKE	ALL	GREEN	1	GREEN	# 4	F	(**)
1996-2003	MAXIMA	ALL	WHITE	1	WHITE	# B	A	(**)
1990-1995	MAXIMA	ALL	WHITE	1	WHITE	# 1	A	(**)
2004-2005	MAXIMA	ALL	WHITE	1	YEL/ORNG	# 2	A	(**)
2006-2008	MAXIMA	ALL	WHITE	1	GRN/ORG	#4	F	(**)
2009-2012	MAXIMA	ALL	RED	1	ORANGE	#3	F	(**)
2003-2009	MURANO	ALL	WHITE	1	GRN/WHT	# 4	E	(**)
2009-2012	MURANO	ALL	WHITE	1	ORANGE	#3	E	(**)
1996-1997	PATHFINDER	4 CYL	WHITE	1	WHITE	# C	96-C, 97-A	(**)
1990-1995	PATHFINDER	6 CYL	WHITE	1	WHITE	# C	A	(**)
1996-2000	PATHFINDER	6 CYL	WHITE	1	WHITE	# 1	C	(**)
2001-2002	PATHFINDER	ALL	RED	1	ORANGE	# 1	A	(**)
2003-2005	PATHFINDER	ALL	BROWN	1	ORANGE	# 4	A	(**)
2006-2012	PATHFINDER	ALL	WHITE	1	PINK	# 4	F	(**)
1990-1994	PICKUP	ALL	WHITE	1	WHITE	# C	A	(**)
1995-2000	PICKUP	ALL	WHITE	1	WHITE	# 1	A	(**)
2004-2007	QUEST	ALL	YELLOW	1	WHT/BLU	# 3	E	(**)
2008-2012	ROGUE	ALL	GREEN	1	GREEN	# 3	F	(**)
2000	SENTRA	ALL	YELLOW	1	GREEN	# 1	A	(**)
2001	SENTRA	1.6L	WHITE	1	GREEN	# 1	A	(**)
2001	SENTRA	1.8L	YELLOW	1	GREEN	# 1	A	(**)
2002	SENTRA	1.8L	YELLOW	1	GREEN	# 1	B	(**)
2002-2003	SENTRA	2.5L	WHITE	1	ORNG/BLU	N/A	E	(**)
2003	SENTRA	1.8L	WHITE	1	BLU/RED	N/A	E	(**)
2004-2006	SENTRA	ALL	WHITE	1	BLU/RED	N/A	E	(**)
2007-2009	SENTRA	ALL	YEL/BLK	1	VIOLET	# 4	F	(**)
2010-2012	SENTRA	ALL	GREEN	1	PURPLE	# 4	F	(**)
2004-2012	TITAN	ALL	BLACK	1	WHITE	# 4	E	(**)
2007-2012	VERSA	ALL	LT GREEN	1	GREEN	# 3	L	(**)
2001-2005	XTERRA	ALL	BLUE	1	RED	# 4	D	(**)
2006-2012	XTERRA	ALL	WHITE	1	PINK	# 4	E	(**)

Footnotes

(**) = Indicates you will be connecting to the Mass Air Flow Sensor (MAF) all others connect to Manifold Absolute Pressure Sensor (MAP)

TPS Locations

1 = On side of the throttle body , opposite the throttle linkage.

MAF/MAP Sensor Locations

A = On air inlet duct, behind air cleaner assembly

B = On air cleaner housing

C = On right side of engine, part of the air intake assembly

D = Near throttle body

E = Left front of engine compartment

F = On air intake housing

G = Center of firewall

H = On top left rear of engine

I = In left air intake duct

J = In right air intake duct

K = On top of engine

L = Left rear of engine compartment on air intake

<u>Oxygen Sensor Optional Connection</u>	<u>02 Sensor Signal</u>
<u>Vehicle/Connector type</u>	<u>Wire Color</u>
Acura/Honda 4 Wire Connector	Black
Alfa Romeo 3 Wires	Black
Audi 3 Wires	Black
BMW 3 Wires	Black
BMW 4 Wires	Black
Ford 3 Wires	Black
Ford 4 Wires	Black
Geo 4 Wires	Black
Mazda 4 Wires	Black
Mercury 3 Wires	Black
Mercury 4 Wires	Black
Mitsubishi 4 Wires	Black,Blue or Yellow
Nissan 3 Wires	Black
Nissan 4 Wires	Black
Subaru 3 Wires	Black
Suzuki 4 wires	Black

Package Contents:
(1) Self-adhesive dash or console pedestal mounting disc
(1) Alcohol cleaning pad

No Tools Required for installation.

***Note:** Adhesive disc is intended for semi-permanent installation and one time application. If disc needs to be removed, please see the removal instructions below.

Dash or Console Mounting Instructions

Step 1. Choose a suitable location for disc (and pedestal) installation. Do not place mount in or near an air bag deployment zone or where it will obstruct view of the road or hinder vehicle operation.

Step 2. Clean the dash or console surface area thoroughly with the included alcohol pad. Allow the area dry before applying the mounting disc.

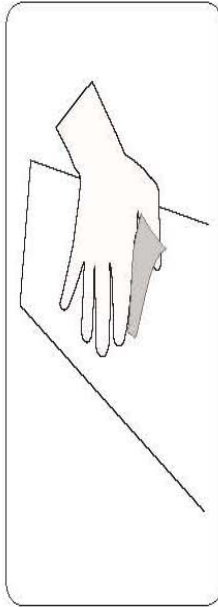

Step 3. Remove the paper backing of the disc and place on the cleaned surface. Press the top of the disc down firmly to allow the adhesive to stick to the surface. Allow 24 hours for the adhesive to cure to the surface before applying any pressure.

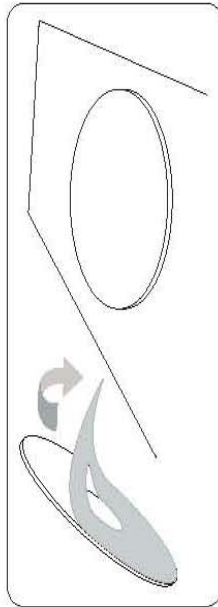

AP020 Disc
(Ø 90 mm)



AP013 Disc
(Ø 80 mm)



AP036 Disc
(Ø 70 mm)

Step 4. Place the suction cup of the pedestal (sold separately) firmly down on the center of the mounting disc and lower the securing lever.

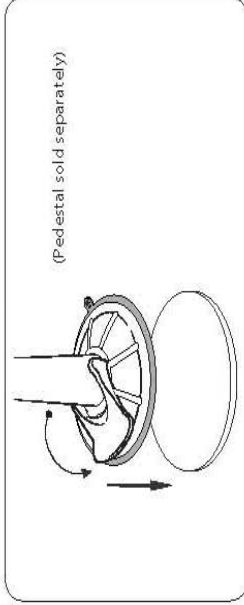

Disc Removal Instructions

Step 1. Prepare the surface around the disc by applying a generous amount of rubbing alcohol or similar adhesive removal product to the area with a cotton swab. Let the liquid saturate the adhesive area for about a minute.

Step 2. Take a long piece of dental floss in each hand and slowly work back and forth at the base of the adhesive disc. Gently use the dental floss to cut the adhesive from the dash or console until the black plastic disc is removed.

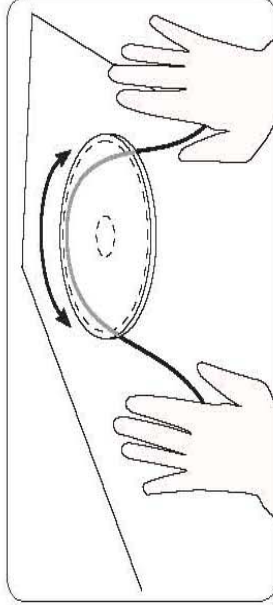

Step 3. If the sticky adhesive area breaks apart or does not come off completely, re-apply a small amount of alcohol (or adhesive removal liquid) and carefully lift off the remaining area by hand.

GN014-SBH | Mini Windshield Suction Swivel Mount



Package Contents:
(1) GN014 - Mini windshield mount
(1) Survival ball head assembly with dual T-Rab pattern



GN014-SBH
Windshield Mount with
Swivel Ball Head Assembly

Patent Pending

Windshield Mounting

- Step 1.** Find a safe location on the interior of the vehicle's windshield to mount the pedestal. Firmly push the suction base (A) against the windshield and flip the base lever down (B) to the locked position. See diagram below.
- Step 2.** Adjust the angle of the pedestal arm by tightening the angle adjustment knob (C) at the base to the desired angle.

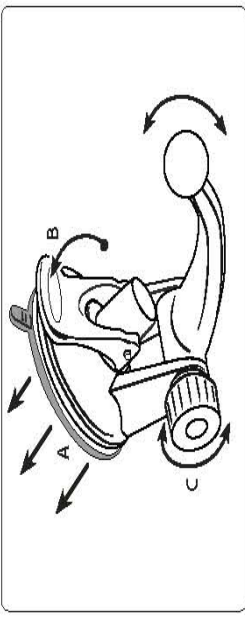

Swivel Ball Head Assembly Attachment

- Step 1.** Slip the tightening ring (D) over the pedestal ball. Snap the dual-T head adapter plate (E) on to the pedestal ball (F). Screw the tightening ring over the adapter plate until securely holding the plate. Adjust the angle as needed.

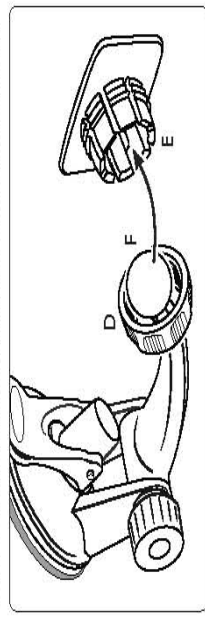

- (I) GN014 - Mini windshield mount
(J) Swivel ball head assembly with dual T-tab pattern adapter plate and tightening ring.

Compatible with:

- All Arkon dual T-tab pattern phone cradles and adapter plates
- Most Garmin 17mm ball connections. (See website for full list.)

! Do not place mount in or near an air bag deployment zone or where it will obstruct view of the road.

Attach Cradle or Device to Pedestal

- Step 1.** To attach your cradle or device (not included, sold separately) to the dual T-head, insert the dual T-tabs (G) into the dual T-slots (H) on the back of the cradle or device.

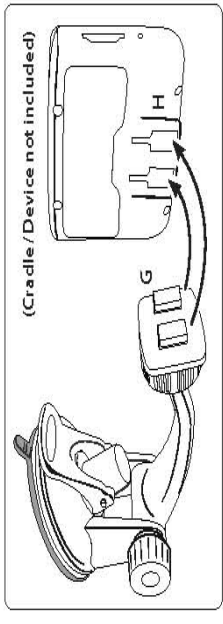

Attaching a Garmin Device to Pedestal

- Step 1.** Do not attach the swivel ball head assembly. Attach your Garmin device (not included, sold separately) to the ball head by firmly inserting the ball head (I) into the cavity (J) in the back of the device.

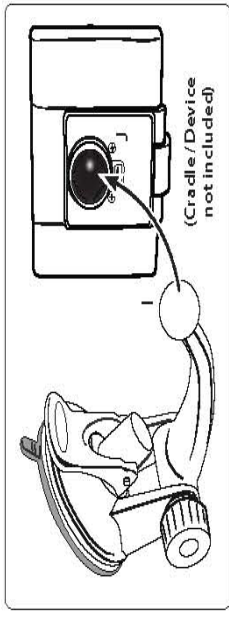

All brand names and product names are trademarks or registered trademarks of their respective owners.



The Mobile Mounting Specialists™

Consumer Hotline:
USA (800) 841-0884
INT'L (626) 254-9005
 Monday - Friday 9am - 5pm, PST
www.arkon.com
 Arcadia, CA 91006 USA
 Designed in USA | Made in China and Taiwan
 © Copyright 2009, Arkon Resources, Inc.



Safety Precautions

Follow all manufacturer safety guidelines for operating your device. Failure to practice safe usage of GPS device while driving may result in damage, injury, or death. Arkon is not responsible for any damages caused to your car, your device, or yourself due to the installation or use of this pedestal mount.