



INSTALLATION INSTRUCTIONS

PART NUMBER: AEM-29-0011WR

2015-2019	Subaru	WRX STI	2.5L Turbo
2015-2019	Subaru	WRX	2.0L Turbo

PARTS LIST

	Description	Qty.	Part Number
1	FRONT STRUT BAR, 2014	1	AEM-83045

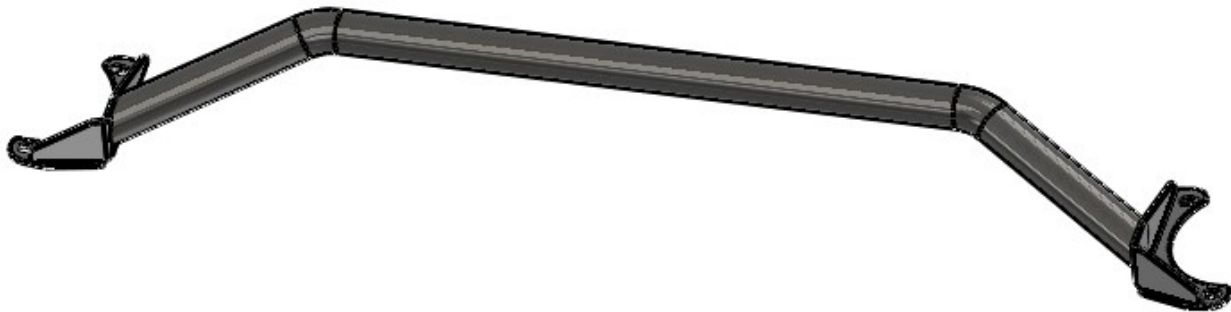

Read and understand these instructions **BEFORE** attempting to install this product. Failure to follow installation instructions and not using the provided hardware may damage the strut bar.

1. Preparing Vehicle

- a. Make sure vehicle is parked on a level surface.
- b. Set parking brake.
- c. If engine has run in the past two hours, let it cool down.
- d. Do not discard stock components after removal of the factory system.

2. Removal of stock parts

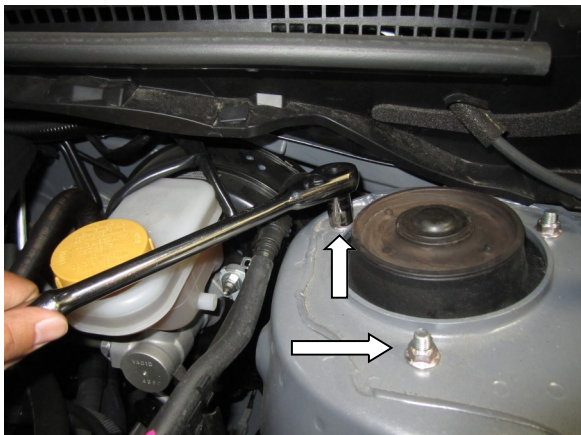

- a. Remove the 2 Strut Tower nuts from each side needed to install the AEM Strut Tower bar.

3. Installation of AEM Strut Bar



- a. Install the AEM Strut Tower Bar, replace the original strut tower nuts, and tighten.

AEM Strut Tower Bar Warranty Policy

AEM® warrants that its Strut Tower Bars will last for the life of your vehicle. AEM will not honor this warranty due to mechanical damage (i.e. improper installation or fitment), damage from misuse, or accidents. AEM will not warrant its powder coating if the finish has been cleaned with a hydrocarbon-based solvent. The powder coating should only be cleaned with a mild soap and water solution. Proof of purchase of the AEM Strut Tower Bar is required for redemption of a warranty claim.

This warranty is limited to the repair or replacement of the AEM part. In no event shall this warranty exceed the original purchase price of the AEM part nor shall AEM be responsible for special, incidental or consequential damages or cost incurred due to the failure of this product. Warranty claims to AEM must be transportation prepaid and accompanied with dated proof of purchase. This warranty applies only to the original purchaser of product and is nontransferable. Improper use or installation, or an accident, abuse, unauthorized repairs or alterations voids this warranty. AEM disclaims any liability for consequential damages due to breach of any written or implied warranty on all products manufactured by AEM.

Warranty returns will only be accepted by AEM when accompanied by a valid Return Merchandise Authorization (RMA) number. Credit for defective products will be issued pending inspection. Product must be received by AEM within 30 days of the date RMA is issued.

If you have a warranty issue, please call (800) 992-3000 and our customer service department will assist you. A proof of purchase is required for all AEM warranty claims.

For technical inquiries e-mail us at sales@aemintakes.com or call us at 800.992.3000