



# INSTALLATION INSTRUCTIONS

## 57-1511-2

**Dodge**  
**1994-2001 Ram**  
**V8-5.2L**  
**1994-01 Ram 1500**  
**V-8-5.9L**  
**1994-02 Ram 2500**  
**V8-5.9L**

NOTE: This kit was not designed to fit vehicles with a body lift

### TOOLS NEEDED:

- Flat blade screwdriver
- Pair of side cutters
- 4mm allen wrench
- 5mm allen wrench
- 1/8" allen wrench
- ratchet
- Socket extension
- 13mm socket
- 7/16" socket
- 10mm wrench
- 7/16" wrench
- 5/8" wrench

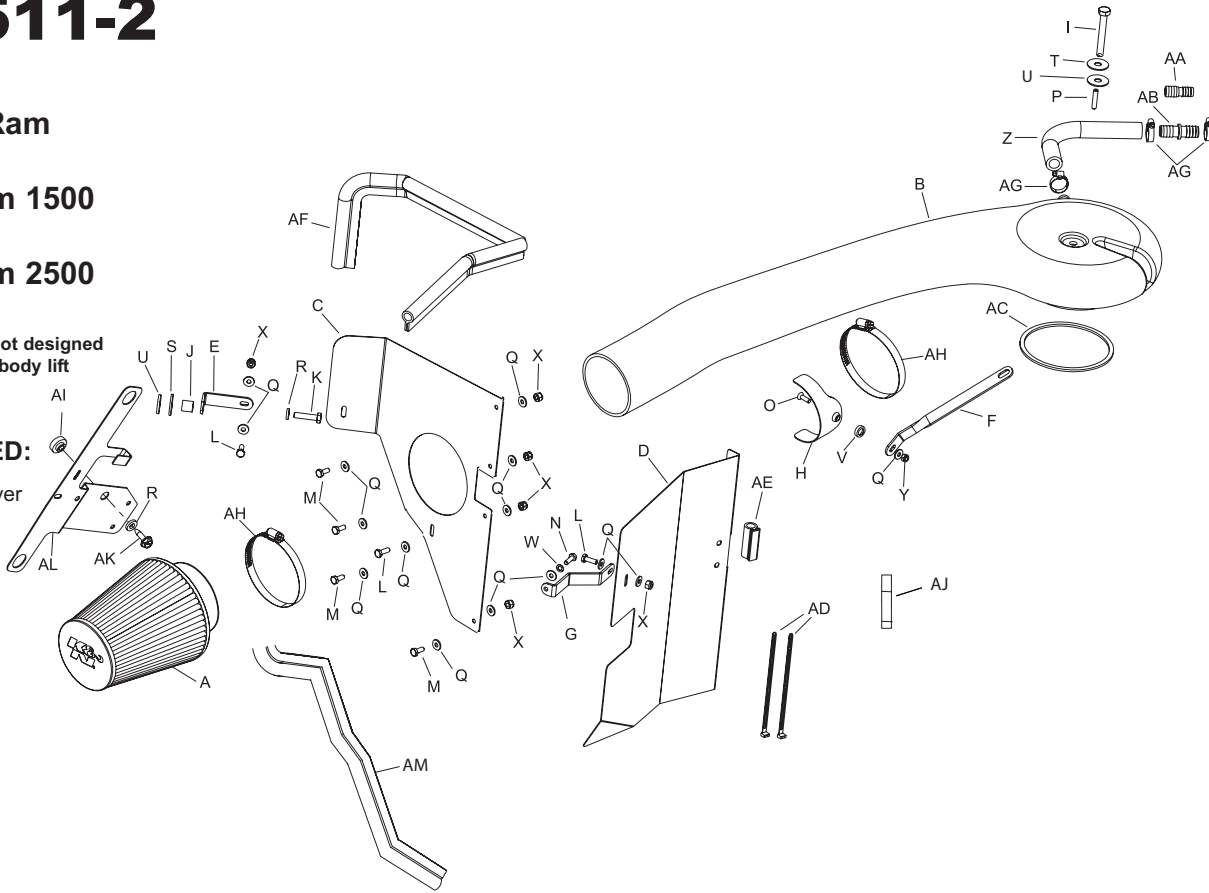

### PARTS LIST:

Description	Qty.	P/N
A	1	RC-4680
B	1	087152
C	1	07472
D	1	07420
E	1	070632
F	1	070840
G	1	070652
H	1	078855
I	1	08241
J	1	07849
K	1	07784
L	3	08386
M	4	08315
N	1	07818
O	1	08376
P	1	07800
Q	15	08275
R	2	08276
S	1	08130
T	1	08126
U	2	21708
V	1	08180
W	1	08174
X	6	07517
Y	1	07553
Z	1	08725
AA	1	08726
AB	1	08048
AC	1	09989
AD	2	21591
AE	1	102497
AF	1	102493
AG	3	08410
AH	2	08648
AI	1	21694
AJ	1	482
AK	1	07742
AL	1	08028
AM	1	102500

**NOTE: FAILURE TO FOLLOW INSTALLATION INSTRUCTIONS AND NOT USING THE PROVIDED HARDWARE MAY DAMAGE THE INTAKE TUBE, THROTTLE BODY AND ENGINE.**

### TO START:

1. Turn the ignition OFF and disconnect the vehicle's negative battery cable.



2. Loosen the hose clamp on the air cleaner at the throttle body.

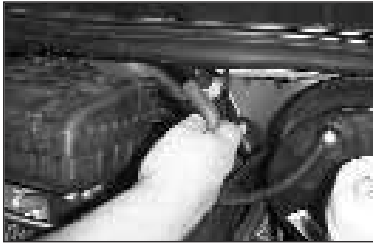

3. Disconnect the crankcase vent line from the air cleaner.



4. Pull firmly upwards to remove the air cleaner away from the throttle body.



5. Detach the air inlet duct from the inner fender and remove the entire air cleaner assembly.

NOTE: Remove the OE gasket as it will not be used. Also K&N recommends that you do not discard your factory air intake.



6. Mount the "Z" bracket to the existing hole in the radiator core support.



7. Remove the EVAP canister purge solenoid from the EVAP assembly bracket located on the inner fender as shown.

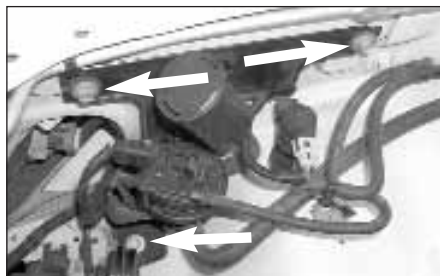

8. Loosen and remove the three bolts that secure the EVAP assembly bracket to the inner fender as shown.



9. Loosen and remove the EVAP canister vent from the EVAP assembly bracket as shown.



10. Loosen and remove the three screws that secure the EVAP canister to EVAP assembly bracket as shown.



11. Remove the EVAP assembly bracket from the vehicle as shown.



12. Remove the two upper stock metal stand-offs and the stock grommets from the stock EVAP assembly bracket and install them into the new EVAP assembly bracket as shown.



13. Install the provided step bushing into the hole on the backside of the EVAP assembly bracket as shown.



14. Install the EVAP canister onto the EVAP assembly bracket using the original screws removed in step 10.



15. Installing the EVAP canister onto bracket first using the provided hardware. Then install bracket onto vehicle using the two stock bolts and the provided sheet metal screw, secure the EVAP bracket and "L" bracket to the inner fender as shown.

**NOTE: Due to manufacturer inconsistencies, a 5/16" hole may need to be drilled into the inner fender for the sheet metal screw.**



16. Remove the rubber mounted locating bracket from the purge control solenoid as shown.



17. Install the purge control solenoid onto the EVAP assembly bracket as shown.

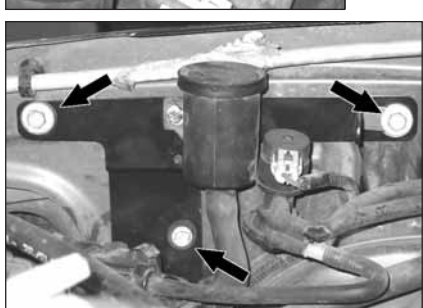

18. Using the two stock bolts and the provided sheet metal screw, secure the EVAP bracket and "L" bracket to the inner fender as shown.

**NOTE: Due to manufacturer inconsistencies, a 5/16" hole may need to be drilled into the inner fender for the sheet metal screw.**



19. On 94-97 models, install the long "L" bracket to the existing hole on the inner fender. Secure with provided spacer and hardware as shown.



20. Install and secure heat shield "B" to the "Z" bracket.

**NOTE: Do not tighten completely at this time.**



21. Apply the 18" long edge trim to heat shield as shown. Trim if needed.



22. Install and secure heat shield "A" to the long "L" bracket.

**NOTE: Do not tighten completely at this time.**



23. Secure heat shield "A" and "B" together.



24. Using one of the provided zip ties, secure the A/C line and heater hose together as shown.

**Note: When installing the intake tube, check the two hoses for clearance under the intake tube and adjust for best fit.**

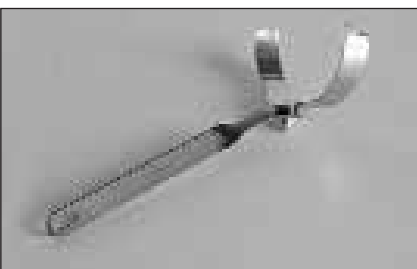

25. Assemble the saddle bracket assembly as shown.

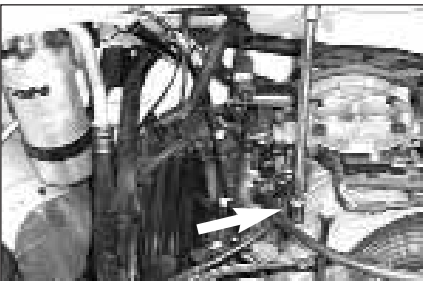

26. Loosen and remove the bolt that retains the fuel rail bracket.

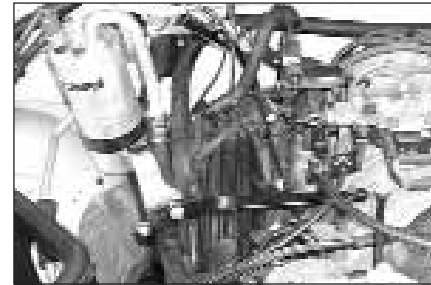

27. Install the saddle bracket assembly using the bolt removed in step #26.

**NOTE: Do not tighten completely.**



28. Apply the new provided gasket on the throttle body as shown.

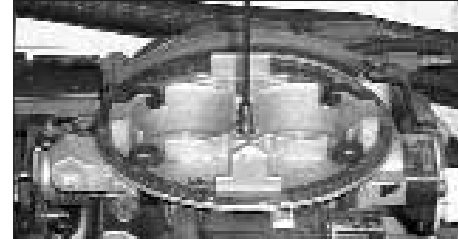

29. Install the provided stud into the throttle body as shown.

**NOTE: Apply two drops of thread locker to the throttle body stud. Use only the provided stud; failure to follow the above instructions may damage the intake tube, throttle body and engine.**



30. Slide the intake tube through the hole in the heat shield as shown.



31. Install the intake tube onto the throttle body and secure the plenum with the provided nut extension and washer.



32. Secure the saddle bracket to the intake tube with the provided hose clamp as shown, then tighten the bolt at the fuel rail (see arrow). Position the heat shield for best fit and clearance.



33. Assemble the appropriate hose mender and the provided vent hose.

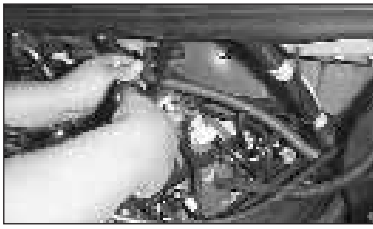

34. Cut the factory crankcase vent hose for best fit.



35. Attach the existing crankcase vent hose to the vent assembly.



36. Attach the crankcase vent hose assembly to the vent tube on the intake tube.



37. Align the heat shield for best clearance and tighten the two brackets.

38. It will be necessary to readjust the brackets and the saddle bracket assembly for best clearance. Retighten all hardware.

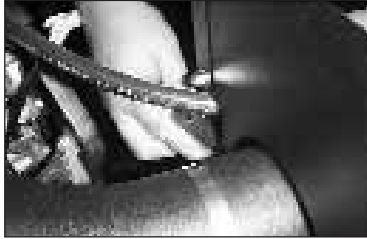

39. Install the side location trim seal onto the slot on the heat shield.



40. Secure the a/c line to the heat shield with the provided zip tie.



41. Install the top location trim seal onto the heat shield.  
**NOTE: It will be necessary to trim and cut for best fit.**



42. Install the air filter element onto the intake tube and secure with a hose clamp.

43. Reconnect the vehicle's negative battery cable. Double check to make sure everything is tight and properly positioned before starting the vehicle.

44. The C.A.R.B. exemption sticker, (attached), must be visible under the hood, so that an emissions inspector can see it when the vehicle is required to be tested for emissions. California requires testing every two years, other states may vary.

45. It will be necessary for all K&N® high flow intake system to be checked periodically for realignment, clearance and tightening of all connections. Failure to follow the above instructions or proper maintenance may void warranty.

#### ROAD TESTING:

1. Start the engine with the transmission in neutral or park, and the parking brake engaged. Listen for air leaks or odd noises. For air leaks secure hoses and connections. For odd noises, find cause and repair before proceeding. This kit will function identically to the factory system except for being louder and much more responsive.

2. Test drive the vehicle. Listen for odd noises or rattles and fix as necessary.

3. If road test is fine, you can now enjoy the added power and performance from your kit.

4. K&N Engineering, Inc., suggests checking the Air filter element periodically for excessive dirt build-up. When the element becomes covered in dirt (or once a year), service it according to the instructions on the Recharger service kit part number 99-5050 or 99-5000.

**50-STATE STREET LEGAL**  
**K&N CARB EXEMPT K&N**

\* FREE K&N® decal To register your warranty, please see us online at [knfilters.com/register](http://knfilters.com/register). FREE K&N® decal \*