



# AIRCHARGER

## INSTALLATION INSTRUCTIONS

### 63-1094 DODGE / CHRYSLER 2006 DURANGO 2007 ASPEN V8-5.7L HEMI

NOTE: This kit was not designed to fit vehicles with a body lift.

#### TOOLS NEEDED:

Flat Blade Screwdriver  
4mm Allen Wrench  
10mm Wrench  
13mm Wrench  
Ratchet  
Extension  
10mm Socket  
13mm Socket  
9/16" Socket

NOTE: FAILURE TO FOLLOW INSTALLATION INSTRUCTIONS AND NOT USING THE PROVIDED HARDWARE MAY DAMAGE THE INTAKE TUBE, THROTTLE BODY AND ENGINE.

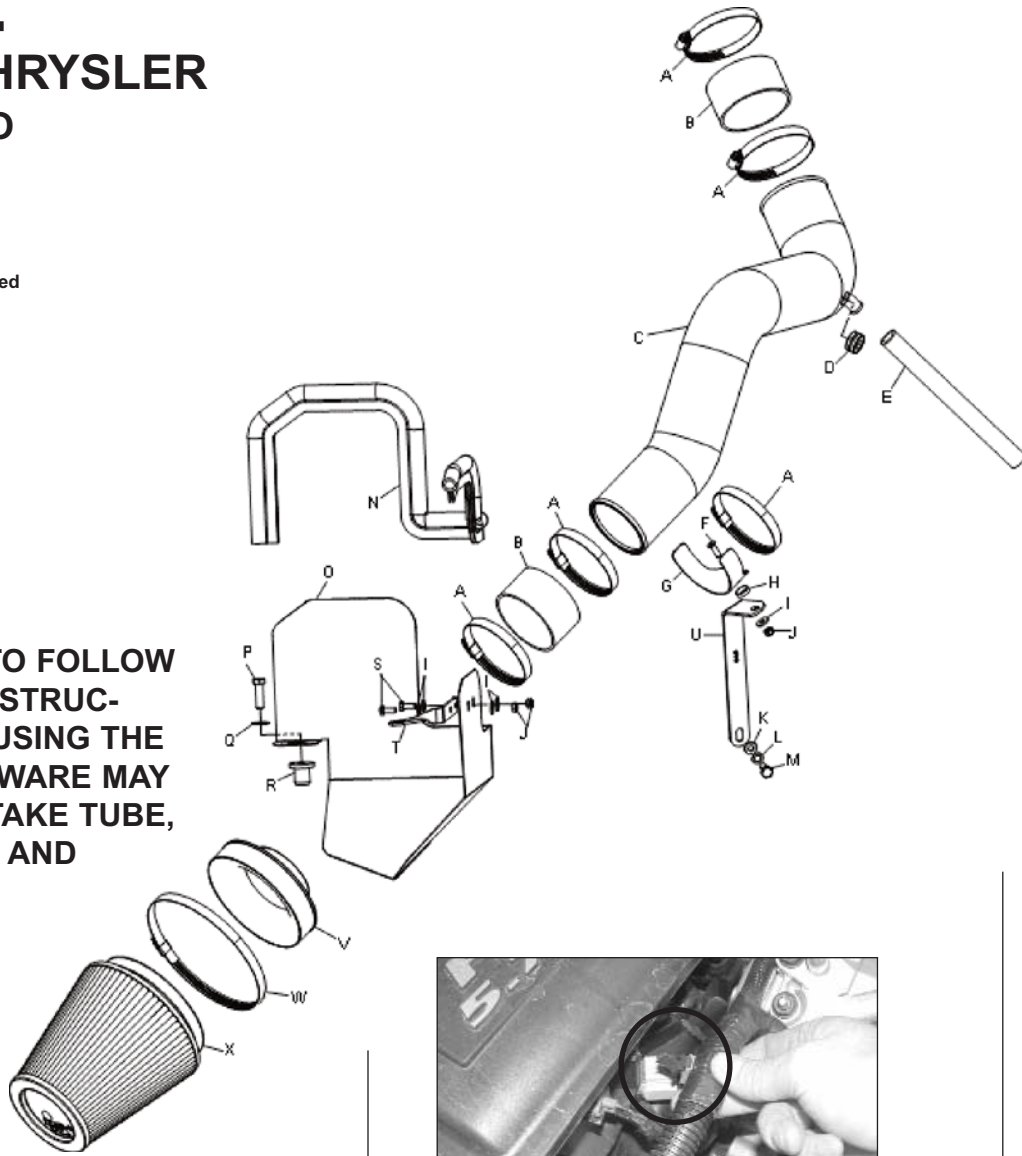

#### PARTS LIST:

Desc.	QTY.	Part #
A hose clamp #56	5	08620
B silicone hose	2	08630
C intake tube (DU)	1	087116
D grommet; 1"od x .5"id	1	08064
E silicone hose 5/8"x 9 3/4" L	1	084047
F bolt; f/h/a 6mm-1.00	1	08376
G saddle bracket	1	078855
H conical washer	1	08180
I washer; 1/4"idx5/8"od	5	08275
J nylock nut; 6mm-1.00	3	07553
K flat washer; 5/16"idx5/8"od	1	08276
L wave washer 8mm	1	08239
M bolt; 8mm-1.25x16mm	1	07844
N edge trim 35"	1	102471
O heat shield	1	074023
P bolt; 3/8"-16x1.25	1	07779
Q flat washer; 3/8"id ss	1	08134
R nut insert; 3/8"-16	1	08163
S bolt; 6mm-1.00x16mm	2	07703
T bracket	1	07197
U bracket "L"	1	07196
V filter adaptor #380	1	21512
W hose clamp #104	1	08697
X air filter	1	RF-1041

#### TO START:

1. Turn the ignition OFF and disconnect the vehicle's negative battery cable.



2. Disconnect the crank case vent hose at the oil filler stand off as shown.



3. Loosen the intake tube hose clamps and remove the intake tube assembly from the vehicle.

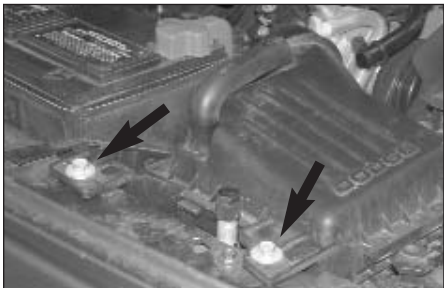

4. Remove the two airbox retaining bolts.



5. Pull up firmly to dislodge the air box from the mounting grommet, and remove the air box from the vehicle.



6. Unclip the engine wire harness clip from the resonator box as shown.



7. Depress the locking tab on the air temp sensor and disconnect its electrical connection.



8. Remove the two 10mm resonator retaining bolts, then remove the resonator from the vehicle.  
NOTE: K&N recommends that customers do not discard factory air intake.



9. Remove the resonator silicone gasket from the throttle body.



10. Assemble the saddle clamp to the tube bracket with the provided hardware as shown.



11. Install the tube bracket assembly as shown using the hardware provided.

NOTE: The bracket retaining bolt will thread into the hole in the belt tensioner mount.



12. Install the heat shield bracket (07197) onto the heat shield with the provided hardware.



13. Install the provided edge trim onto the heat shield. Trim if necessary.



14. Remove the core support mounting bolt shown with a 13mm wrench, and pull out the stock air box mounting grommet shown.



15. Install the 3/8" threaded insert provided into the air box mounting grommet hole vacated in step #14.



16. Install the K&N heat shield assembly and secure the mounting bracket to the radiator core support with original bolt removed in step #13. Secure the rear of the heat shield to the 3/8" threaded insert with the provided hardware.



17. Install the silicone hose (08630) onto the throttle body and secure with the provided hose clamp.

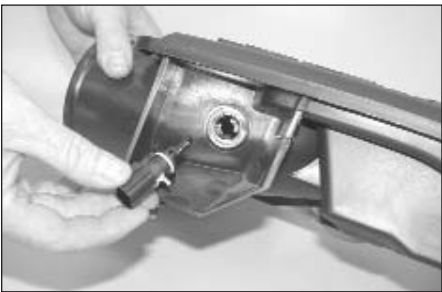

18. Twist the temp sensor counter clockwise to unlock and remove the temp sensor from the resonator.

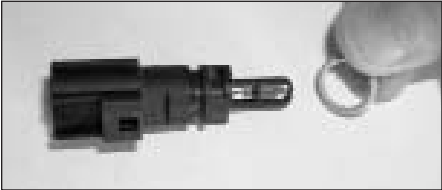

19. Remove the O-ring from the air temp sensor as shown.

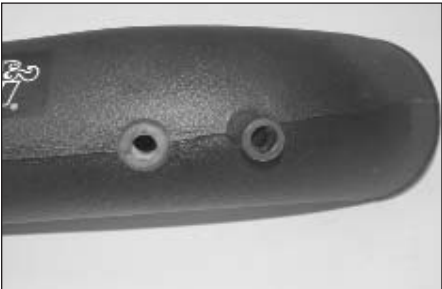

20. Install the provided grommet into the K&N intake tube as shown.



21. Install the air temp sensor into the K&N intake tube as shown.



22. Install the intake tube onto the throttle body and secure with the provided hose clamp.



23. Using the provided hose clamp, secure the K&N intake tube to the saddle bracket assembly as shown.



24. Reconnect the temp sensor electrical connection.



25. Connect the provided silicone hose to the crank case vent on the valve cover, then connect to the K&N intake tube.



26. Install the provided radiuses filter adapter into the K&N air filter and secure with the provided hose clamp.



27. Install the silicone hose (08630) onto the K&N filter charge assembly and secure with the provided hose clamp.



28. Install the K&N air filter assembly onto the K&N intake tube and secure with the provided hose clamp.



29. Reconnect the vehicle's negative battery cable. Double check to make sure everything is tight and properly positioned before starting the vehicle.

30. It will be necessary for all Aircharger's to be checked periodically for realignment, clearance and tightening of all connections. Failure to follow the above instructions or proper maintenance may void warranty.

#### ROAD TESTING:

1. Start the engine with the transmission in neutral or park, and the parking brake engaged. Listen for air leaks or odd noises. For air leaks secure hoses and connections. For odd noises, find cause and repair before proceeding. This kit will function identically to the factory system except for being louder and much more responsive.
2. Test drive the vehicle. Listen for odd noises or rattles and fix as necessary.
3. If road test is fine, you can now enjoy the added power and performance from your kit.
4. K&N suggests checking the Air filter element periodically for excessive dirt build-up. When the element becomes covered in dirt (or once a year), service it according to the instructions on the Recharger service kit, part number 99-5050 or 99-5000.