



AIRCHARGER®

HIGH-FLOW INTAKE KITS

NOT LEGAL FOR SALE OR USE ON ANY POLLUTION CONTROLLED MOTOR VEHICLE IN CALIFORNIA OR STATES ADOPTING CALIFORNIA EMISSION PROCEDURES.

See knfilters.com for CARB status on each part for a specific vehicle

INSTALLATION INSTRUCTIONS

63-2611
FORD
2017-18 Edge
L4-2.0L Ecoboost

TOOLS NEEDED:

- flat blade screw driver
- 14mm wrench
- 10mm wrench
- cutters
- pliers
- ratchet
- extension
- 7mm socket
- 13mm socket
- 4mm allen key

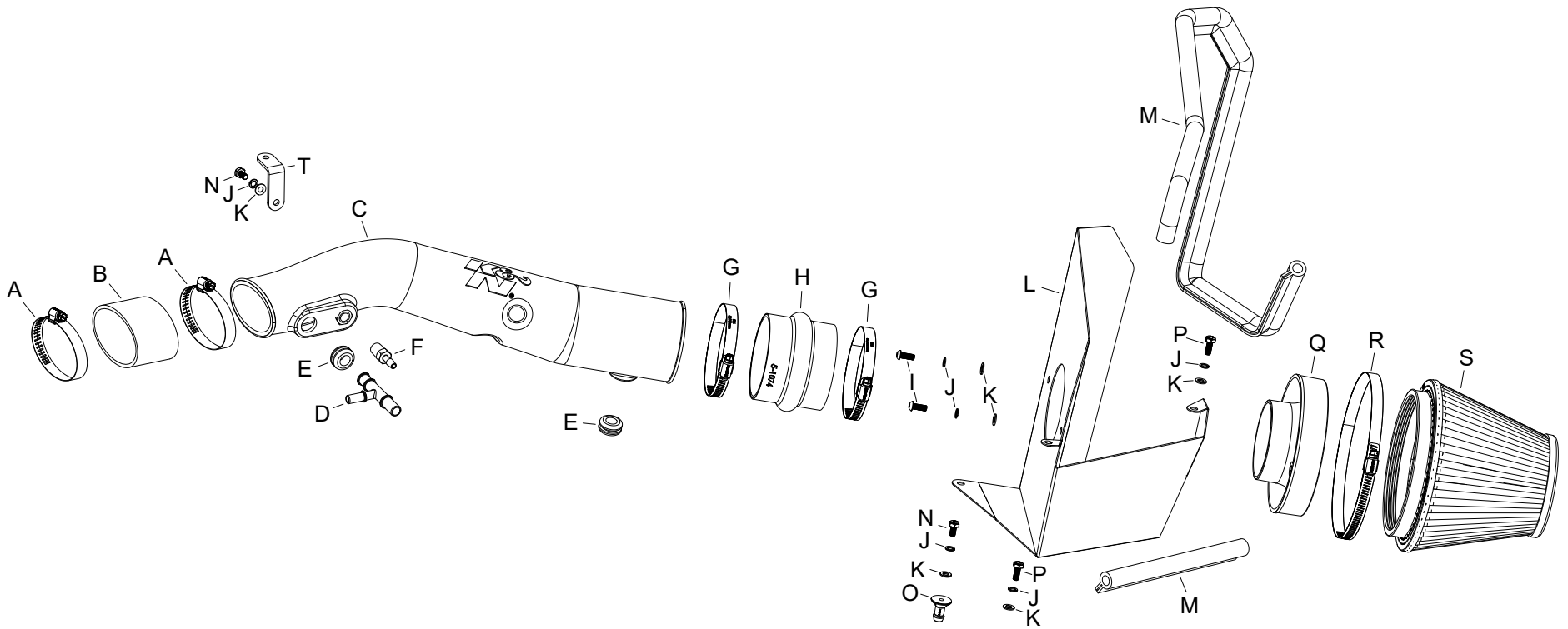

PARTS LIST:

Description	Qty.	Part #	Description	Qty.	Part #	Description	Qty.	Part #
A HOSE CLAMP; #52	2	08610	H HOSE; HUMP 3.5" X 3"	1	5-1074	O MOUNT, PLASTIC AIRBOX	1	8-186-1
B HOSE; 3.25"ID X 2"L REIN.	1	08690	I BOLT; M6 X 1.00 X 16MM, SS	2	07730	P BOLT; M6 X 1.00" X 20MM HEX	2	07795
C TUBE; AIRCHARGER, XLHDPE	1	087430	J WASHER; M6 SPLIT LOCK ZINC	6	1-3025	Q ADAPTER; UNIVERSAL, 6"	1	21512-1
D VENT; EJECTOR TEE, CCV	1	08529	K WASHER; 6MM FLAT, SS	6	08269	R HOSE CLAMP; #104	1	08697
E GROMMET; 1"OD, 1/2"ID, 1/2"	2	08064	L HEAT SHIELD; 63-2611, MILKD	1	073284	S 6"FLG, 7-1/2"B, 4-1/2"T, 6"H	1	RF-10480
F VENT; STRT, 1/4"HOSE	1	08046	M EDGE TRIM; 3/4" BULB, TOP	1	102480A	T BRACKET; "L", 57-3514, SM	1	08025A
G HOSE CLAMP; #56	2	08620	N BOLT; M6-1.00 X 12MM, SS	2	07727			

If you need any assistance please call 1-800-858-3333 to speak with a representative in our Customer Service Center before returning the product.

NOTE: FAILURE TO FOLLOW INSTALLATION INSTRUCTIONS AND NOT USING THE PROVIDED HARDWARE MAY DAMAGE THE INTAKE TUBE, THROTTLE BODY AND ENGINE.

TO START:

1. Turn off the ignition and disconnect the negative battery cable.
NOTE: Disconnecting the negative battery cable erases pre-programmed electronic memories. Write down all memory settings before disconnecting the negative battery cable. Some radios will require an anti-theft code to be entered after the battery is reconnected. The anti-theft code is typically supplied with your owner's manual. In the event your vehicles anti-theft code cannot be recovered, contact an authorized dealership to obtain your vehicles anti-theft code.



2. Lift off the decorative engine cover.



3. Loosen the hose clamp that secures the intake tube to the air filter housing.



4. Disconnect the inlet air temperature electrical connection and then unhook the wiring harness from the air filter housing.



5. Disconnect the three EVAP and CCV vent lines from the intake tube, then loosen the hose clamp that secures the intake tube to the turbo inlet tube.



6. Remove the bolt that secures the intake tube to the engine.



7. Remove the intake tube from the vehicle.



8. Remove the two bolts that secure the fresh air duct to the core support. These bolts will be reused in a later step.



9. Lift the air filter housing assembly up to dislodge it from the mounting grommets and then remove it from the vehicle.

NOTE: K&N Engineering, Inc., recommends that customers do not discard factory air intake.



10. Install the provided edge trim onto the heat shield as shown.

NOTE: Some trimming of the edge trim will be necessary.

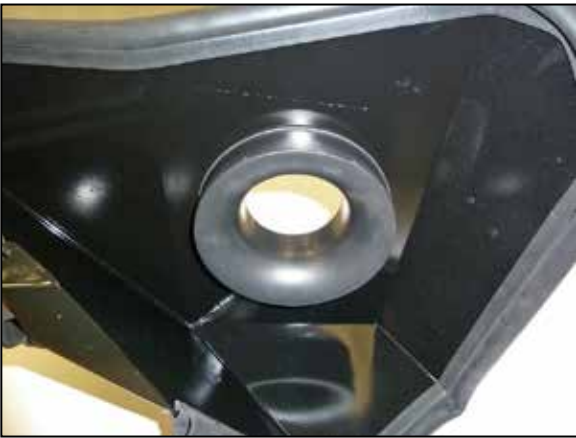

11. Install the filter adapter into the heat shield and secure with the provided hardware.



12. Install the mounting stud onto the heat shield using the provided hardware.



13. Install the heat shield into the vehicle so the mounting stud inserts into the factory mounting provided hardware.



14. Install the provided coupler hose (08690) onto the turbo inlet pipe and secure with the provided hose clamp.



15. Install the provided hump coupler (5-1074) onto the filter adapter and secure with the provided hose clamp.



16. Remove the inlet air temperature sensor from the factory housing and remove the o-ring from the sensor. Install it into the K&N® intake tube using the provided grommet.



17. Install the vent fitting and ejector fitting using the provided grommet into the K&N® intake tube. **NOTE: Plastic NPT fittings are easy to cross thread. Install the vent fitting "hand" tight, then turn it two complete turns with a wrench.**



18. Install the provided tube bracket onto the K&N® intake tube and secure with the provided hardware.



19. Install the K&N® intake tube into the couplers and adjust for best fit. Secure the tube with the provided hose clamps.



20. Route the inlet air temperature sensor wiring harness under the heat shield and reconnect the electrical connection to the sensor.



21. Connect the EVAP and CCV lines to the fittings install into the K&N® intake tube as shown.



22. Secure the vent line to the bracket installed onto the intake tube as shown.



23. Reinstall the decorative engine cover.



24. Install the K&N® air filter and secure with the provided hose clamp.

NOTE: Drycharger® air filter wrap; part # RF-1048DK is available to purchase separately. To learn more about Drycharger® filter wraps or look up color availability please visit <http://www.knfilters.com>®.



25. Reconnect the vehicle's negative battery cable. Double check to make sure everything is tight and properly positioned before starting the vehicle.

26. It will be necessary for all K&N® high flow intake systems to be checked periodically for realignment, clearance and tightening of all connections. Failure to follow the above instructions or proper maintenance may void warranty.

ROAD TESTING:

1. Start the engine with the transmission in neutral or park, and the parking brake engaged. Listen for air leaks or odd noises. For air leaks secure hoses and connections. For odd noises, find cause and repair before proceeding. This kit will function identically to the factory system except for being louder and much more responsive.

2. Test drive the vehicle. Listen for odd noises or rattles and fix as necessary.

3. If road test is fine, you can now enjoy the added power and performance from your kit.

4. K&N Engineering, Inc., requires cleaning the intake system's air filter element every 100,000 miles. When used in dusty or off-road environments, our filters will require cleaning more often. We recommend that you visually inspect your filter once every 25,000 miles to determine if the screen is still visible. When the screen is no longer visible some place on the filter element, it is time to clean it. To clean and re-oil, purchase our filter Recharger® service kit, part number 99-5050 or 99-5000 and follow the easy instructions.

NOT LEGAL FOR SALE OR USE ON ANY POLLUTION CONTROLLED MOTOR VEHICLE IN CALIFORNIA OR STATES ADOPTING CALIFORNIA EMISSION PROCEDURES.

See knfilters.com for CARB status on each part for a specific vehicle