

INSTALLATION INSTRUCTIONS

69-4517

CHEVROLET
2005-07 COBALT SS
I4-2.4L

Tools

Ratchet
Extension
10mm Socket
10mm Wrench
3mm Allen Wrench
Phillips Screwdriver
Flat Blade Screwdriver

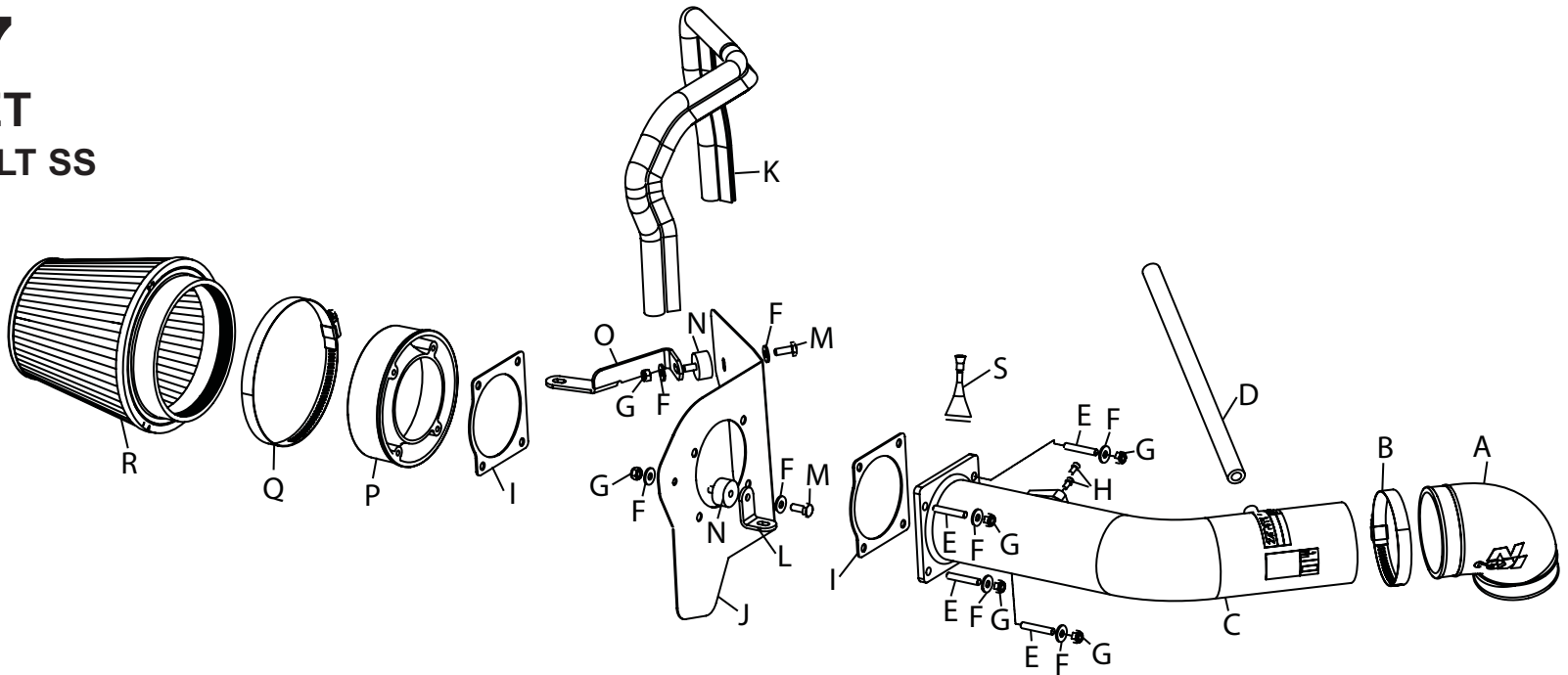

Parts list

Desc.	Qty.	Part#	Desc.	Qty.	Part#	Desc.	Qty.	Part#
A	1	084087	H	2	07733	O	1	26642
B	1	08560	I	2	09202	P	1	21510
C	1	27185	J	1	07641	Q	1	08601
D	1	08412	K	1	102488	R	1	RU-5147
E	4	08220	L	1	070066	S	1	11201
F	8	08269	M	2	07863			
G	6	07553	N	2	070228			

NOTE: FAILURE TO FOLLOW INSTALLATION INSTRUCTIONS AND NOT USING THE PROVIDED HARDWARE MAY DAMAGE THE INTAKE TUBE, THROTTLE BODY AND ENGINE.

TO START:

1. Turn the ignition OFF and disconnect the vehicle's negative battery cable.



2. Remove the engine oil cap and then lift the engine cover to dislodge it from the mounting grommets and then remove the engine cover assembly.

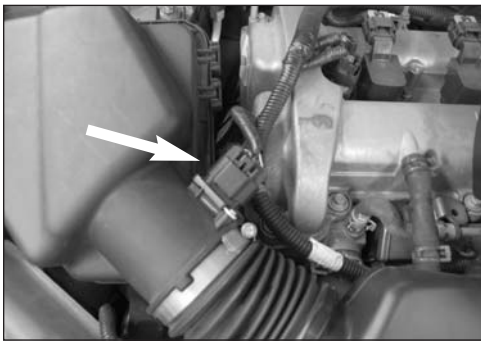

3. Disconnect the mass air sensor electrical connection.



4. Using a small screw driver, release the plenum locking clip by prying the center of the plenum locking clip.

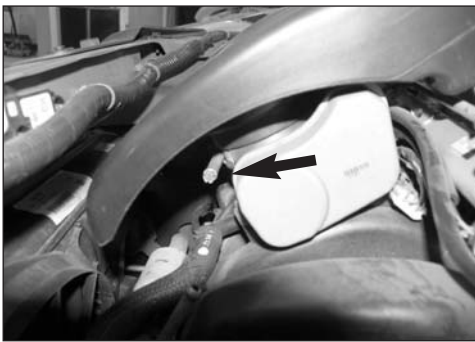

5. Loosen the hose clamp which secures the plenum to the throttle body.



6. Using pliers loosen the clamp which secures the crank case vent hose to the valve cover vent port and then disconnect the crank case vent hose as shown.

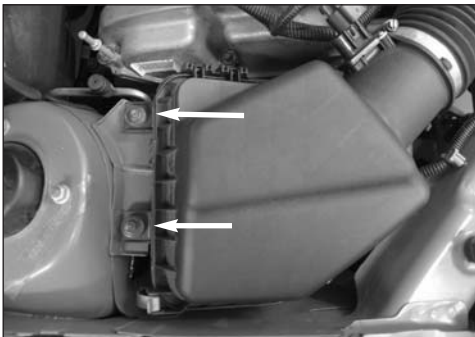

7. Remove the two nuts which secure the air box to the inner fender.
NOTE: One of the nuts will be reused in a later step.



8. Lift the intake tract assembly off of the throttle body and then remove the complete assembly from the vehicle.



9. Install the silicone hose (084037) onto the throttle body as shown and secure with the provided hose clamp.

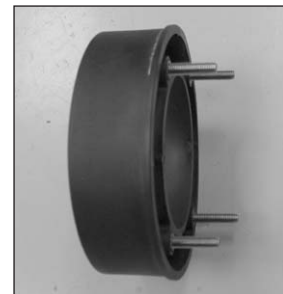

10. Install the four m6 studs into the threaded inserts in the filter adapter as shown.
NOTE: Be sure to apply the provided "LOCTITE" to the threads of the studs.



11. Install the supplied edge trim onto the heat shield as shown.

NOTE: Some trimming of the edge trim may be necessary.



12. Install one of the supplied rubber mounted stud onto the heat shield as shown and secure with the provided hardware.



13. Install the remaining rubber mounted stud onto the heat shield as shown and secure with the provided hardware.



14. Install the "L" bracket (070066) onto the rubber mounted stud as shown and secure with the provided hardware.

NOTE: The none slotted hole is to be attached to the rubber mounted stud.



15. Apply one of the supplied gaskets to the filter adapter studs and then pass the studs through holes in the heat shield to install the filter adapter as shown.



16. Install the K&N intake tube to the filter adapter studs with the remaining gasket and then secure with the provided hardware.

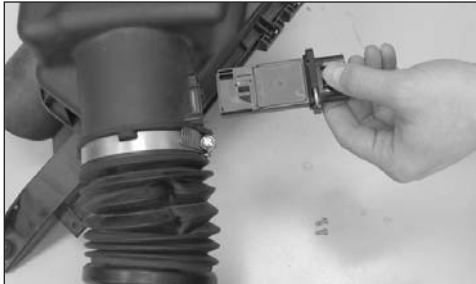

17. Remove the two screws that secure the mass air sensor and then remove the mass air sensor from the stock intake tube as shown.



18. Install the mass air sensor into the K&N intake tube and secure with the provided bolts.



19. Install the K&N filter onto the filter adapter and secure with the provided hose clamp.



20. Install the provided crank case vent hose onto the K&N intake tube as shown.



21. Install the K&N intake tube into the silicone hose at the throttle body and align the "L" bracket with the inner air box mounting stud as shown.



22. Remove the headlight mounting bracket bolt shown.

NOTE: This bolt will be reused.

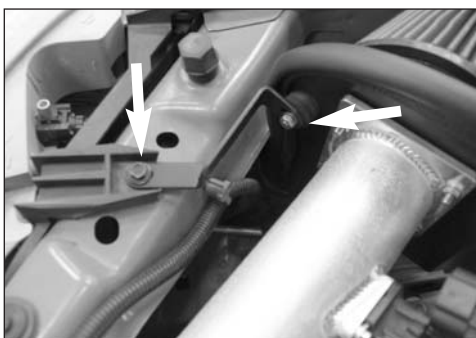

23. Install the "Z" bracket onto the headlight mounting bracket and rubber mounted stud as shown. Secure with the factory bolt removed in step #22 and the provided hardware.

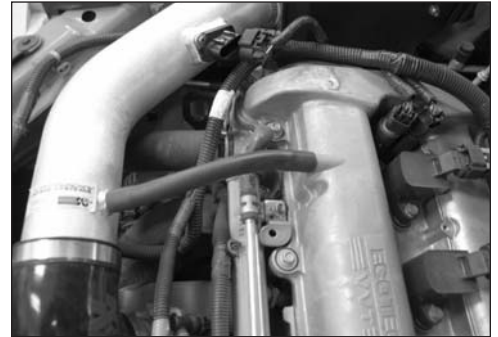

24. Install the crank case vent hose onto the vent fitting on the valve cover.

NOTE: Some trimming of the vent hose may be necessary.



25. Reconnect the mass air sensor electrical connection.



26. Reinstall the engine cover and oil cap.



27. Re-connect the negative battery cable and double check that everything is tight and properly positioned before starting the vehicle.

28. It will be necessary for all Typhoons to be checked periodically for realignment, clearance and tightening of all connections. Failure to follow the above instructions or proper maintenance may void warranty.

ROAD TESTING:

1. Start the engine with the transmission in neutral or park, and the parking brake engaged. Listen for air leaks or odd noises. For air leaks secure hoses and connections. For odd noises, find cause and repair before proceeding. This kit will function identically to the factory system except for being louder and much more responsive.

2. Test drive the vehicle. Listen for odd noises or rattles and fix as necessary.

3. If road test is fine, you can now enjoy the added power and performance from your kit.

4. K&N suggests checking the Air filter element periodically for excessive dirt build-up. When the element becomes covered in dirt (or once a year), service it according to the instructions on the Recharger service kit, part number 99-5000 or 99-5050.