



TYPHOON INTAKE SYSTEMS®

INSTALLATION INSTRUCTIONS

69-7081-1

Infiniti

2003-06 G35 Sedan

V6-3.5L

NOTE: E.O.# D-269-32
APPLIES TO 2003-2005

Tools Needed:

- Ratchet
- Pliers
- 4" Extension
- 10mm Socket
- 9/64" Allen Wrench
- Flat Blade Screwdriver

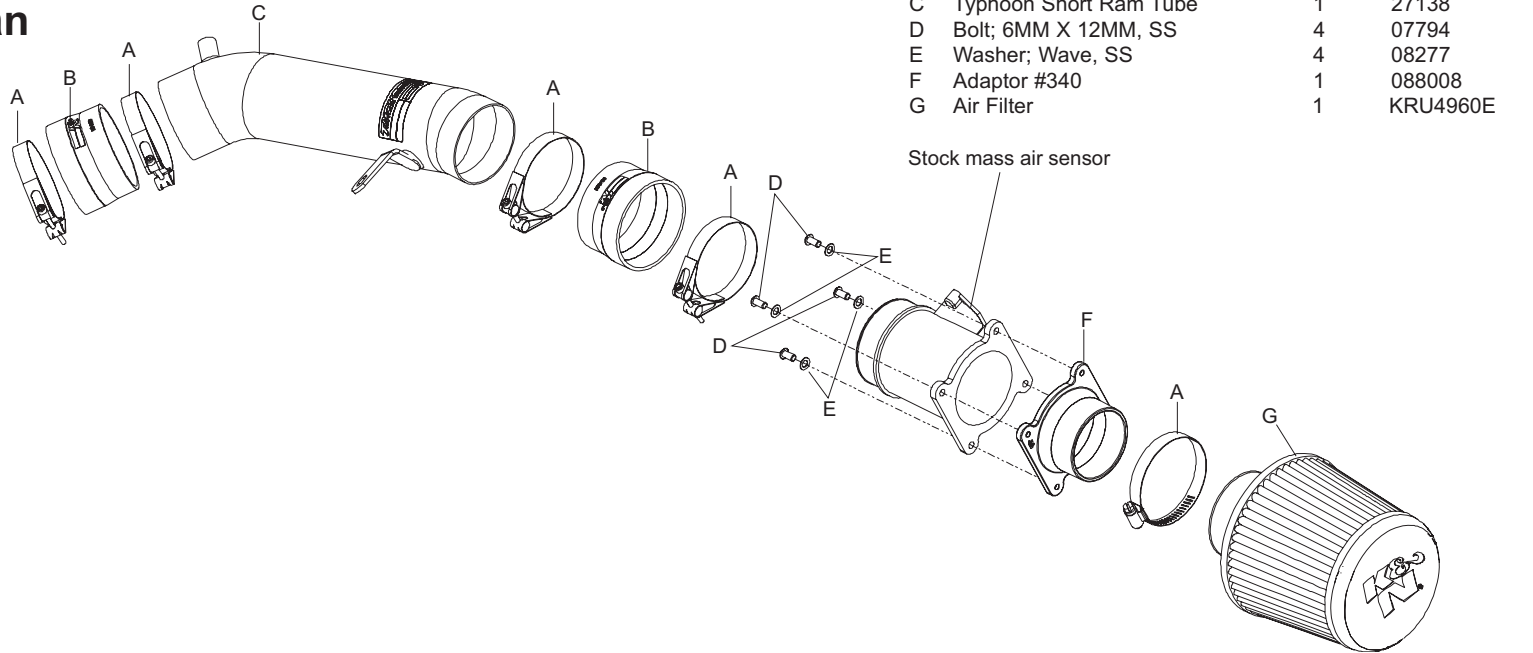

Parts List:

Description	Qty.	P/N
A Hose Clamp #45	5	08560
B Hose; Step, Black	2	084031
C Typhoon Short Ram Tube	1	27138
D Bolt; 6MM X 12MM, SS	4	07794
E Washer; Wave, SS	4	08277
F Adaptor #340	1	088008
G Air Filter	1	KRU4960E

NOTE: FAILURE TO FOLLOW INSTALLATION INSTRUCTIONS AND NOT USING THE PROVIDED HARDWARE MAY DAMAGE THE INTAKE TUBE, THROTTLE BODY AND ENGINE.

TO START:

1. Turn the ignition OFF and disconnect the vehicle's negative battery cable.



2. Remove the engine cover as shown.



3. Disconnect the crank case vent hose as shown.



4. Loosen the hose clamps at the throttle body and at the mass air sensor, then, loosen and remove the bolt that secures the resonator to the intake manifold.



5. Remove the stock intake tube as shown.



6. Disconnect the mass air sensor electrical connection as shown.

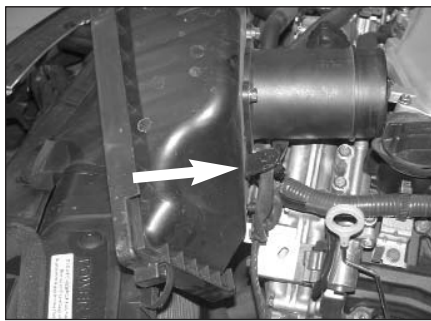

7. Unclip the air cleaner lid, then, loosen and remove the single bolt that secures the air cleaner lid to the fender. Rotate the air cleaner lid, then, unclip the mass air sensor electrical connection to remove the air cleaner lid as shown.



8. Disengage the two plastic rivets, then, remove the stock air inlet duct as shown.



9. Pull firmly upwards to release the air cleaner base from the factory grommets, then remove the air cleaner base as shown.



10. Loosen and remove the four hex bolts to remove the mass air sensor from the stock air cleaner lid as shown.

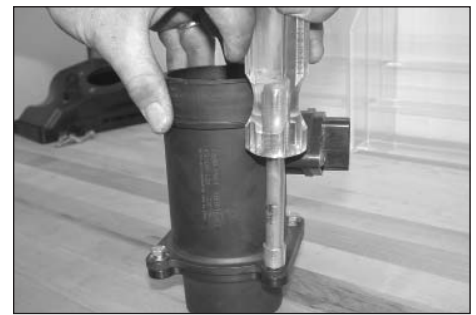

11. Assemble the provided mass air adapter onto the stock mass air sensor using the provided hardware as shown.

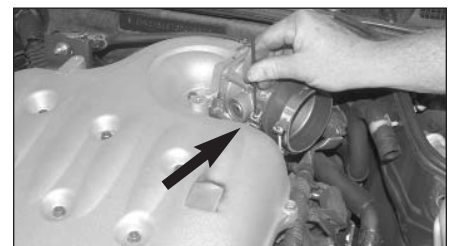

12. Install the provided silicone hose and hose clamps onto the throttle body and tighten.

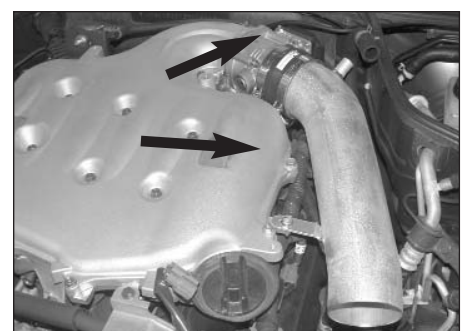

13. Install the K&N Typhoon intake tube into the silicone hose on the throttle body, then, line up the tube bracket with the threaded hole on the intake manifold and secure it with the bolt from step 4.

NOTE: Before installing the intake tube, inspect the inside of the tube for any debris, then clean the inside out with water and a towel. Inspect the tube one more time before proceeding to the next step.

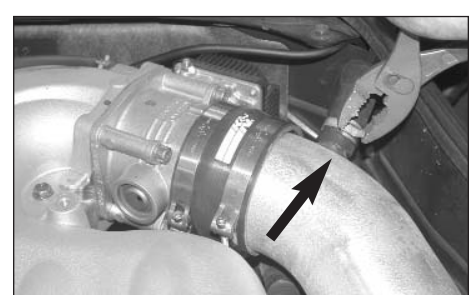

14. Reconnect the crank case vent hose as shown.



15. Install the silicone hose and hose clamps onto the mass air sensor and tighten.



16. Slide the mass air sensor assembly onto the intake tube and tighten the hose clamp.



17. Install the K&N Air filter and secure with the provided hose clamp as shown.

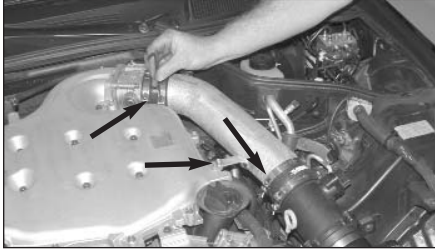

18. Adjust the assembly for best fit and clearance and tighten all hose clamps and hardware.



19. Reconnect the mass air sensor electrical connection as shown.



20. Reinstall the engine cover and the air inlet duct as shown.



21. Reconnect the negative battery cable and double check to make sure everything is tight and properly positioned before starting the vehicle.

22. The C.A.R.B. exemption sticker, (attached), must be visible under the hood, so that an emissions inspector can see it when the vehicle is required to be tested for emissions. California requires testing every two years, other states may vary.

23. It will be necessary for all Typhoon's to be checked periodically for realignment, clearance and tightening of all connections. Failure to follow the above instructions or proper maintenance may void warranty.

ROAD TESTING:

1. Start the engine with the transmission in neutral or park, and the parking brake engaged. Listen for air leaks or odd noises. For air leaks secure hoses and connections. For odd noises, find cause and repair before proceeding. This kit will function identically to the factory system except for being louder and much more responsive.

2. Test drive the vehicle. Listen for odd noises or rattles and fix as necessary.

3. If road test is fine, you can now enjoy the added power and performance from your kit.

4. K&N suggests checking the Air filter element periodically for excessive dirt build-up. When the element becomes covered in dirt (or once a year), service it according to the instructions on the Recharger service kit, part number 99-5000 or 99-5050.