

**Warning:** Please follow these installation instructions carefully. The K&N Drycharger included in this kit must be installed on the K&N air filter when used with a K&N Typhoon Cold Air Intake System. The K&N Typhoon Intake System is a performance product that can be used safely during mild weather conditions. During hard and inclement weather conditions, you must convert your Cold Air Intake System into a short ram configuration, or return your vehicle to the stock OEM airbox and intake tract configuration. Failure to follow these instructions can void your warranty.

## INSTALLATION INSTRUCTIONS

**69-7501**  
**PEUGEOT**  
**2000-2004, 206**  
**1.6L L4 16v 110 PS**

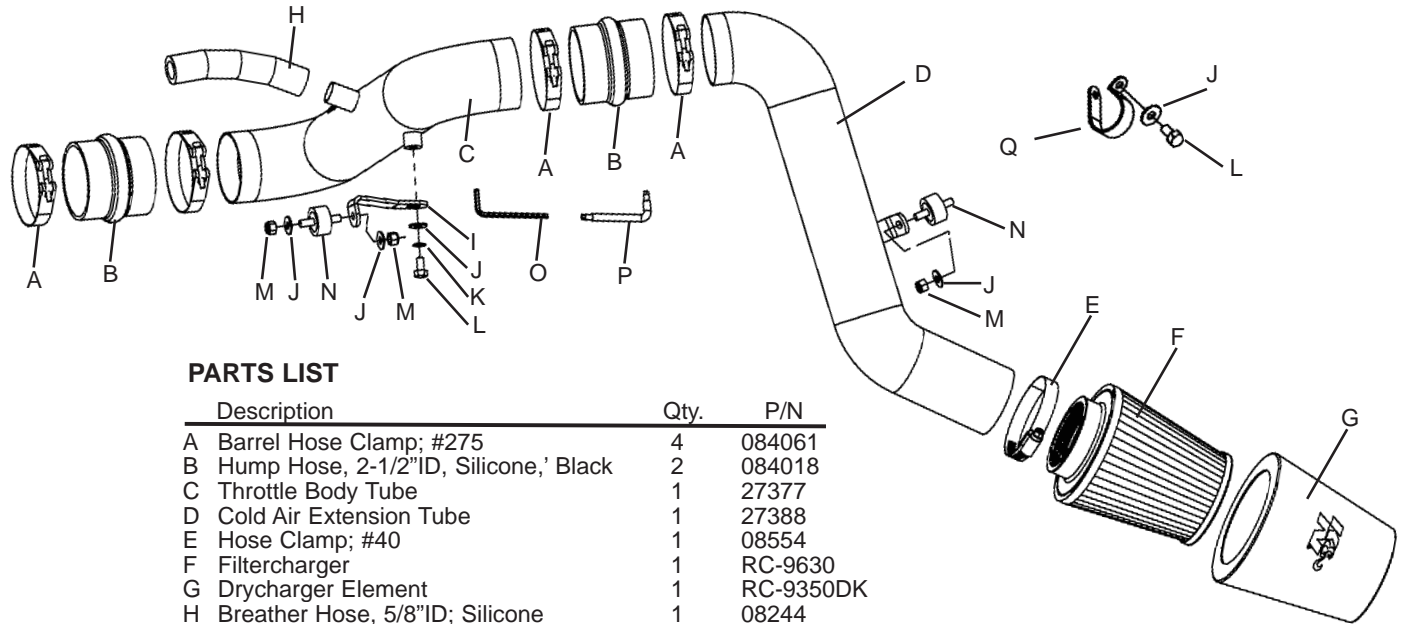

**Tools Needed:**

- 10 mm ring spanner
- 10 mm spanner
- car jack
- pair of axle stands
- 7mm socket spanner
- box cutter
- flat blade screwdriver

**PARTS LIST**

Description	Qty.	P/N
A Barrel Hose Clamp; #275	4	084061
B Hump Hose, 2-1/2"ID, Silicone, Black	2	084018
C Throttle Body Tube	1	27377
D Cold Air Extension Tube	1	27388
E Hose Clamp; #40	1	08554
F Filtercharger	1	RC-9630
G Drycharger Element	1	RC-9350DK
H Breather Hose, 5/8"ID; Silicone	1	08244
I Bracket, "L"; 69-7501	1	06468
J Washer; 6 mm, Flat	5	08269
K Washer; 6mm, Wave	1	08277
L Bolt, M6 x 12 mm, SS	2	07277
M Nut; M6, Nylock	3	07512
N Vibration Mount; M6, Male/Male	2	07027
O Wrench; 9/64, Allen	1	69802
P Wrench; T20, Torx	1	69801
Q P-clip	1	16705

**TO START:**

1. Turn the ignition OFF and disconnect the vehicle's negative battery terminal.

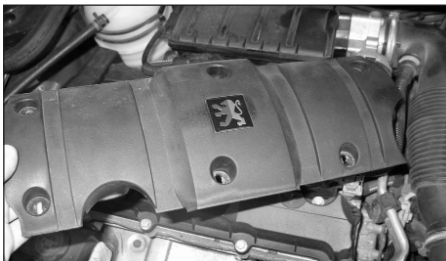

2. Unbolt and remove the engine cover from the vehicle.



3. Remove the breather assembly from the vehicle as shown; press the yellow tabs to release.



4. Unclip and remove the intake hose from between the throttle body and air box.



5. Remove the complete air box assembly from the vehicle by pulling it firmly upwards.

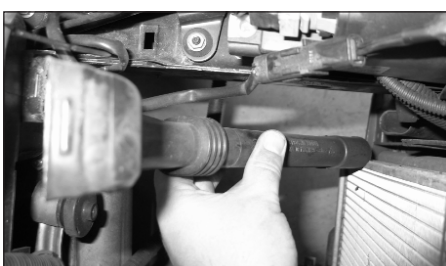

6. Remove the battery air breather tube from the vehicle as shown.



7. Taking the necessary safety precautions raise the front of the vehicle as shown and support the vehicle with axle stands.



8. Remove the wheel arch liner from the vehicle as shown by removing the clips and 2 Torx screws using the small wrench provided.



9. Unclip the indicated hose clamp securing the intake snorkel to the resonator box.



10. Remove the resonator box from the vehicle as shown by pulling it backwards.



11. Carefully remove the cold air intake snorkel from the inner wing as shown.

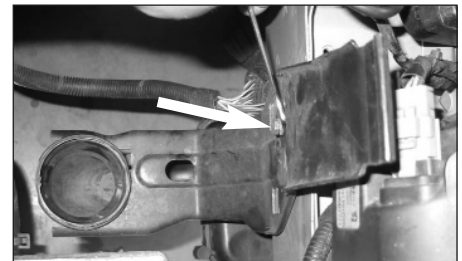

12. Remove the bolt securing the air box mounting bracket to the vehicle.



13. Remove the complete airbox mounting bracket by pulling it upwards.



14. Screw the rubber vibration stud provided into the threaded air box mounting point from step 12 as shown.

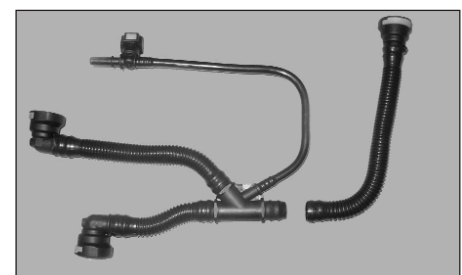

15. Carefully remove the breather pipe from the breather assembly as shown; it may be necessary to gently warm the pipe to do so.

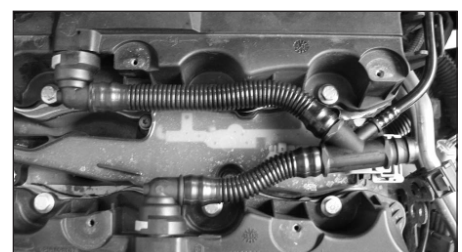

16. Re-install the breather assembly onto engine.

Continued on reverse side!



17. Fit the silicone hump hose onto the throttle body as shown, and secure using a #275 barrel clamp supplied. To secure the clamp, use the small Allen wrench provided.

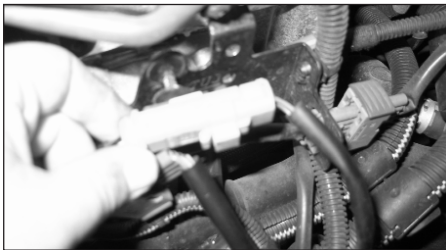

18. Remove the indicated (yellow) electronic connector from the bracket and insert it into another hole in the bracket as shown.



19. Mount the rubber vibration stud onto the wiring loom bracket using an M6 nylock nut and washer as shown.

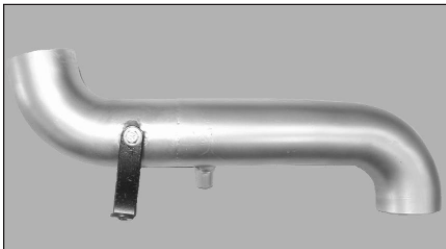

20. Mount the bracket onto the A-tube using an M6 bolt, washer and wavy washer supplied. Do not fully tighten yet!  
**NOTE:** Before installing, clean the inside with water and a towel.



21. Feed the A-tube into the silicone hump hose and secure it with a #275 barrel clamp supplied. Do not fully tighten yet!



22. Align the bracket the A-tube with the rubber vibration stud and secure it using an M6 Nylock nut and flat metal washer supplied. Do not fully tighten yet!

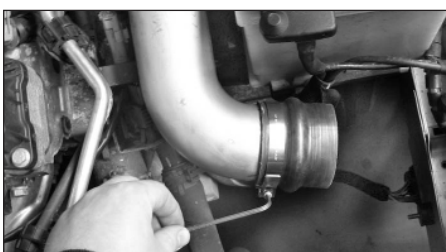

23. Secure the silicone hump hose onto the A-tube using a #275 barrel clamp supplied.

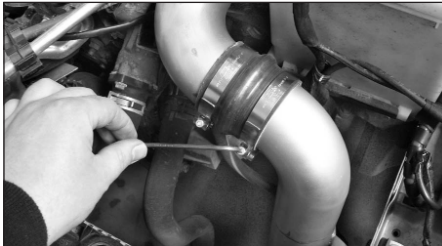

24. Feed the B-tube into the silicone hump hose and secure using a #275 barrel clamp supplied. Do not fully tighten yet!

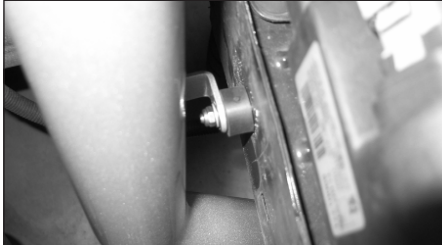

25. Align the welded-on bracket on the B-tube with the rubber vibration stud and secure using an M6 nylock nut and washer. Do not fully tighten yet!



26. Align the A- and B-tube for best fit and clearance; now firmly tighten all hose clamps and hardware.



27. Fit the Drycharger onto the filter as shown.  
**NOTE:** The Drycharger's water repellent properties will last up to two years. See the parts list to re-order Drycharger if necessary.



28. Fit the filter/drycharger assembly onto the B-tube using the #40 hose clamp supplied.



29. Fit the P-clip supplied around the wiring loom and mount it onto the inner fender as shown using the M6 bolt and washer supplied. **(Only on the 2002 and later models.)**



30. Re-install the wheel arch liner to the vehicle using the original hardware.



30. Fit the supplied silicone breather hose between the breather assembly and the breather pipe of the A-tube as shown.



31. Re-install the engine cover to the engine, using the original hardware.



32. Reconnect the negative battery terminal. Installation is now complete.



33. This Typhoon kit has been designed to be used in two different configurations. In case of inclement weather, the filter element can be clamped directly onto the A-tube to prevent water ingestion.



34. Double check to make sure everything is tight and properly positioned before starting the vehicle.

35. It will be necessary for all Typhoons to be checked periodically for realignment, clearance and tightening of all connections. Failure to follow the above instructions or proper maintenance may void warranty.

#### ROAD TESTING:

1. Start the engine with the transmission in neutral or park, and the parking brake engaged. Listen for air leaks or odd noises. For air leaks secure hoses and connections. For odd noises, find cause and repair before proceeding. This kit will function identically to the factory system except for being louder and much more responsive.

2. Test drive the vehicle. Listen for odd noises or rattles and fix as necessary.

3. If road test is fine, you can now enjoy the added power and performance from your kit.

4. K&N suggests checking the Filtercharger element periodically for excessive dirt build-up. When the element becomes covered in dirt (or once a year), service it according to the instructions on the Recharger service kit available from your K&N dealer, part number 99-5000 or 99-5050