

# TYPHOON INTAKE SYSTEMS®

BY 

## INSTALLATION INSTRUCTIONS

### 69-8250

### Seat

### Leon 1999-2004

### 2.8L V6

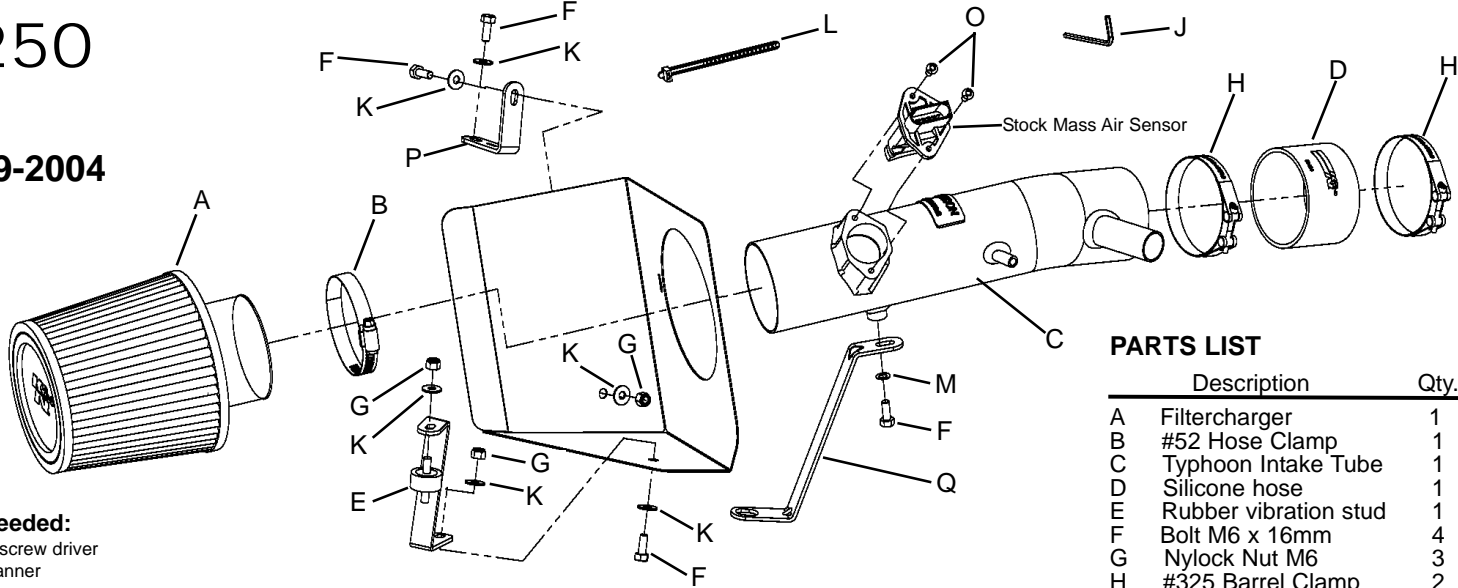

#### Tools Needed:

Flat Blade screw driver  
10 mm Spanner  
18 mm Spanner  
Pliers  
10 mm Socket wrench & Extension  
5Spline torx bit T20

#### PARTS LIST

Description	Qty.	P/N
A Filtercharger	1	KRU4990E
B #52 Hose Clamp	1	08610
C Typhoon Intake Tube	1	27383
D Silicone hose	1	08434
E Rubber vibration stud	1	07027
F Bolt M6 x 16mm	4	07812
G Nylock Nut M6	3	07512
H #325 Barrel Clamp	2	084063
I Heat Shield	1	07330
J Wrench; 9/64 Allen	1	69802
K M6 Washer	6	08269
L Cable tie	1	21589
M M6 Waved Washer	1	08277
N Bracket "Z"	1	010069
O Bolt: M5 Allen	2	07734
P Bracket "L"	1	010070
Q Bracket "Z"	1	A2122-209

#### TO START:

1. Turn the ignition OFF and disconnect the vehicle's negative battery terminal.

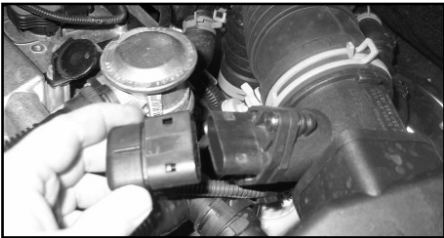

2. Disconnect the mass air sensor (MAS) electrical connection as shown.



3. Depress the hose clamp to remove the intake tube from the MAS.



4. Remove the two bolts securing the air box and remove the complete airbox.



5. Remove the small breather hose from the intake tube as shown.



6. Disconnect the crank case vent switch and the crank case hose from the intake tube as shown.



7. Depress the throttle body hose clamp and remove the complete intake tube from the vehicle as shown.



8. Remove the nut that secures the air inlet duct and remove the air inlet duct from the vehicle as shown.



9. Remove the gear mounting bolt as shown.



10. Mount the "Z" bracket onto the gear box mount using its original bolt. (do not fully tighten yet!)

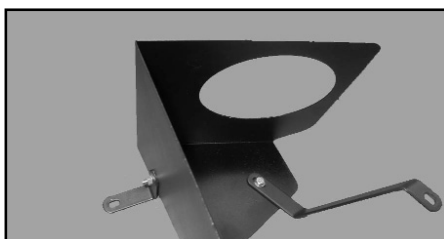

11. Mount the two brackets onto the heat shield using the hardware supplied. (do not fully tighten yet!)



12. Mount the rubber vibration stud onto the airbox support bracket.

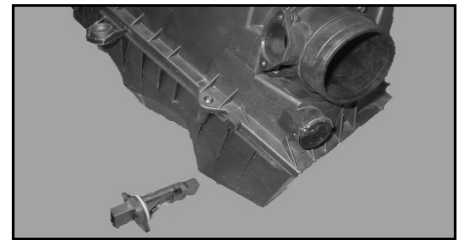

13. Remove MAS from air box.



14. Mount the MAS onto the new intake tube using the two M5 bolts supplied. **NOTE:** Before installing, inspect the inside of the tube for any debris, then clean the inside out with water and a towel.



15. Install the silicone hose onto the throttle body using the #325 barrel clamp supplied.



16. Fit the new intake tube into the silicone hose using the #325 barrel clamp supplied. (do not fully tighten at this moment.)

Continued on reverse side!

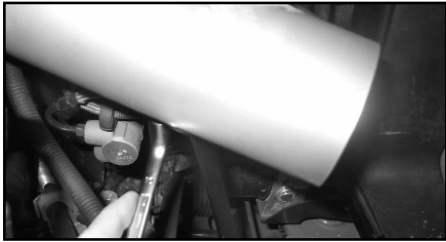

17. Fit the intake tube onto the bracket using the hardware supplied.

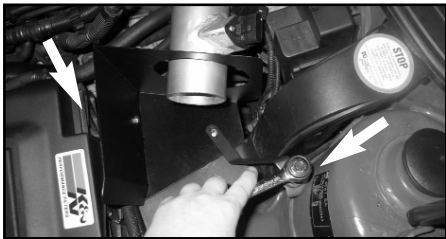

18. Mount the heat shield onto the air box support points using the hardware supplied. (do not fully tighten yet!)



19. Align the tube and the bracket for best clearance. Now remove the heat shield assembly, keeping the tube and bracket in place.

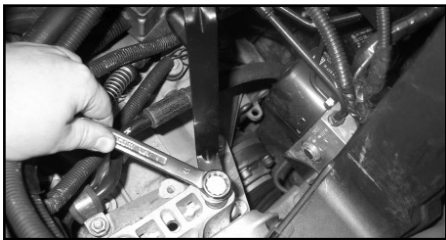

20. Now firmly tighten the gear box mounting bolt and the M6 bolt on the intake tube.

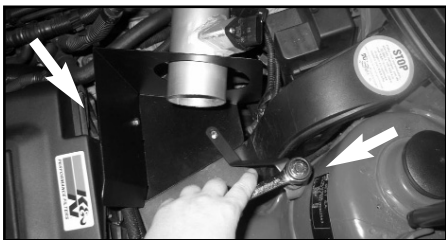

21. Mount the heat shield back on the air box support points using the hardware supplied.



22. Fit the small breather onto the intake tube.

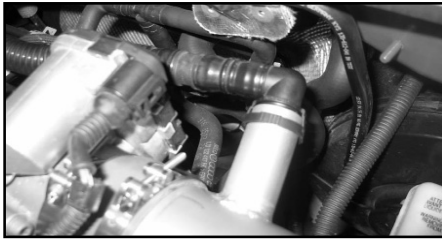

23. Reconnect the crank case vent hose to the intake tube.



24. Reconnect the MAS electrical connection as shown.



25. Zip tie the crank case vent switch connection to the throttle control connection using the provided cable tie as shown.

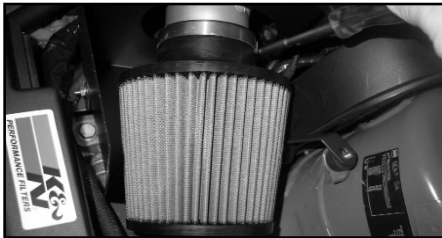

26. Fit the filter onto the intake tube using the hose clamp supplied.



27. Reconnect the vehicle's negative battery terminal.

28. Double check to make sure everything is tight and properly positioned before starting the vehicle.

29. It will be necessary for all Typhoon's to be checked periodically for realignment, clearance and tightening of all connections. Failure to follow the above instructions or proper maintenance may void warranty.



#### ROAD TESTING:

1. Start the engine with the transmission in neutral or park, and the parking brake engaged. Listen for air leaks or odd noises. For air leaks secure hoses and connections. For odd noises, find cause and repair before proceeding. This kit will function identically to the factory system except for being louder and much more responsive.

2. Test drive the vehicle. Listen for odd noises or rattles and fix as necessary.

3. If road test is fine, you can now enjoy the added power and performance from your kit.

4. K&N suggests checking the Filtercharger element periodically for excessive dirt build-up. When the element becomes covered in dirt (or once a year), service it according to the instructions on the Recharger service kit (99-5000 or 99-5050) available from your K&N dealer.