

# S5340

2016-UP TOYOTA TACOMA DUAL SIDE  
EXIT

**MBRP**  
INC.  
PERFORMANCE EXHAUST

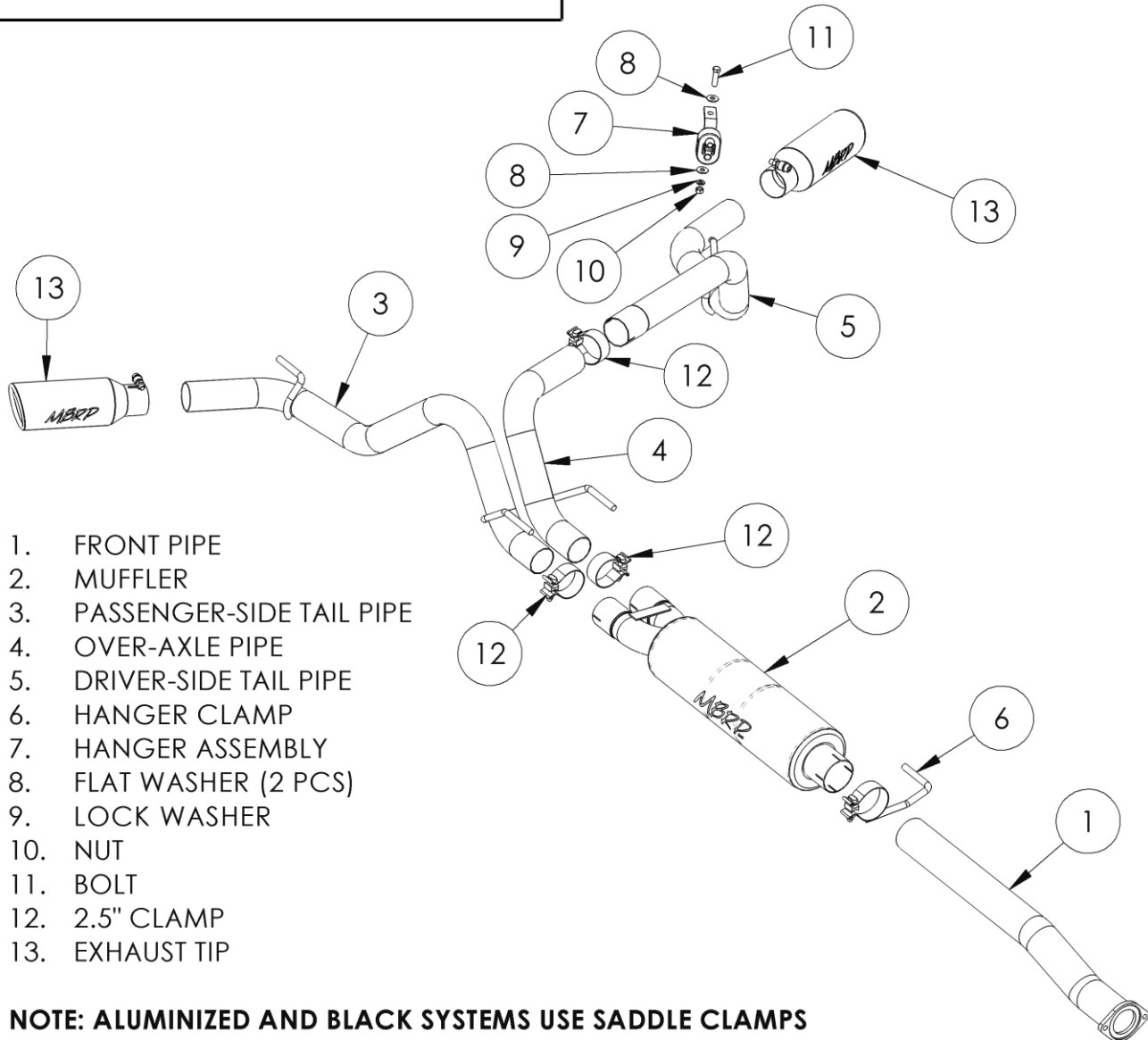

1. FRONT PIPE
2. MUFFLER
3. PASSENGER-SIDE TAIL PIPE
4. OVER-AXLE PIPE
5. DRIVER-SIDE TAIL PIPE
6. HANGER CLAMP
7. HANGER ASSEMBLY
8. FLAT WASHER (2 PCS)
9. LOCK WASHER
10. NUT
11. BOLT
12. 2.5" CLAMP
13. EXHAUST TIP

**NOTE: ALUMINIZED AND BLACK SYSTEMS USE SADDLE CLAMPS**

## PLEASE READ BEFORE STARTING INSTALLATION

**While MBRP Inc. has made every effort to ensure that all components of this system are of superior quality and properly packaged, it is the installer's responsibility to ensure the following before removal of the factory exhaust:**

- that ALL components shown above are present.
- that ALL mating components fit together.
- that there are no damaged components.
- that the system you have purchased is appropriate for your vehicle year, model and configuration.
- that the system will not interfere with any modifications previously installed or planned.
- that you have read and understand these instructions.

If you have any questions or are uncertain about any aspect of the installation of this system to your vehicle please contact your dealer before commencing installation.

### Removal of Stock System:



**Figure 1**

1. Apply a penetrating lubricant liberally to all exhaust fasteners, hangers and rubber insulators.

2. Support the factory Y-pipe and remove the bolts holding the front flange together and disconnect exhaust system. Do not discard this hardware as it is used for the installation. Ensure the factory gasket remains in place.

**Refer to Figures 1 & 2.**



**Figure 2**

3. Remove the hangers from the rubber insulators and remove the exhaust from the vehicle. If a hoist or hydraulic lift is not being used the tail pipe may need to be cut to clear the rear axle.

### Installation of MBRP Inc. Performance Exhaust:



**Figure 3**

1. Attach the **Front Pipe** to the flange using the factory fasteners.  
**Refer to Figure 3.**

Note: The **Front Pipe** will need to be trimmed on some models. Refer to the illustration below.

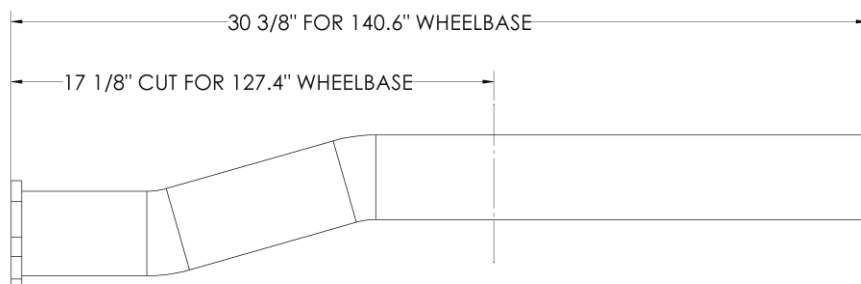

**Figure 4**

2. Install the **Muffler** onto the **Front Pipe** using the **Hanger Clamp**. Then install the hanger into the factory rubber insulator. Do not tighten the **Hanger Clamp** at this time.

**Refer to Figure 4.**



**Figure 5**

3. Loosely install the **Over-Axle Pipe**, connecting it to the **Muffler** driver-side outlet with a **2.5" Clamp**. Install the hanger into the rubber insulator located above the **Over-Axle Pipe**.

**Refer to Figure 5.**



**Figure 6**

4. Place the **Hanger Assembly** onto the **Driver-Side Tail Pipe** hanger. **Refer to Figure 6.**



**Figure 7**

5. Using a **2.5" Clamp**, connect the expanded end of the **Driver-Side Tail Pipe** to the **Over-Axle Pipe**, keeping brake flex lines in front of the pipe. **Refer to Figure 7.**

**Note: You will need to tie the flex lines back from the pipe for adequate clearance. Ensure the flex lines will not be stressed during suspension movement.**



**Figure 8**

6. Move the **Driver-Side Tail Pipe** into approximate position. Using the factory hole provided in the frame located directly above the tail pipe hanger, attach the **Hanger Assembly** using the **supplied hardware**.

**Refer to Figure 8.**



**Figure 9**

7. Loosely install the **Passenger-Side Tail Pipe** into the passenger-side muffler outlet using a **2.5" Clamp**.  
**Refer to Figure 9.**



**Figure 10**

8. Install the **Passenger-Side Tail Pipe** hangers into the insulators located above them.  
**Refer to Figures 9 and 10.**



**Figure 11**

9. Install and adjust the **Exhaust Tips** to suit. Tighten the lock bolt located on each **Exhaust Tip**.  
**Refer to Figures 11 and 12.**



**Figure 12**

10. Make sure that the exhaust is properly in place before tightening clamps. Start at the front of the exhaust system and begin tightening all connections. Verify that the fit is good and fully tighten all the clamps.

11. Check along the whole length of the exhaust system to ensure that there is adequate clearance around the spare tire, fuel and brake lines or any wiring. If any interference is detected relocate or adjust. Pay particular attention to the brake flex lines and ABS wiring. Most often these can be kept clear of the exhaust by loosely tying them back. Different configurations may require a different method. It is the installer's responsibility to ensure there is enough clearance to prevent damage.

**Congratulations!** You are ready to begin experiencing the improved power, sound and driving excitement of your **MBRP Inc.** performance exhaust system. We know you will enjoy your purchase.