

# S6285

2004-2007 FORD E250/350, 6.0L DIESEL,  
CAT BACK SINGLE

**MBRP**  
INC.  
PERFORMANCE EXHAUST

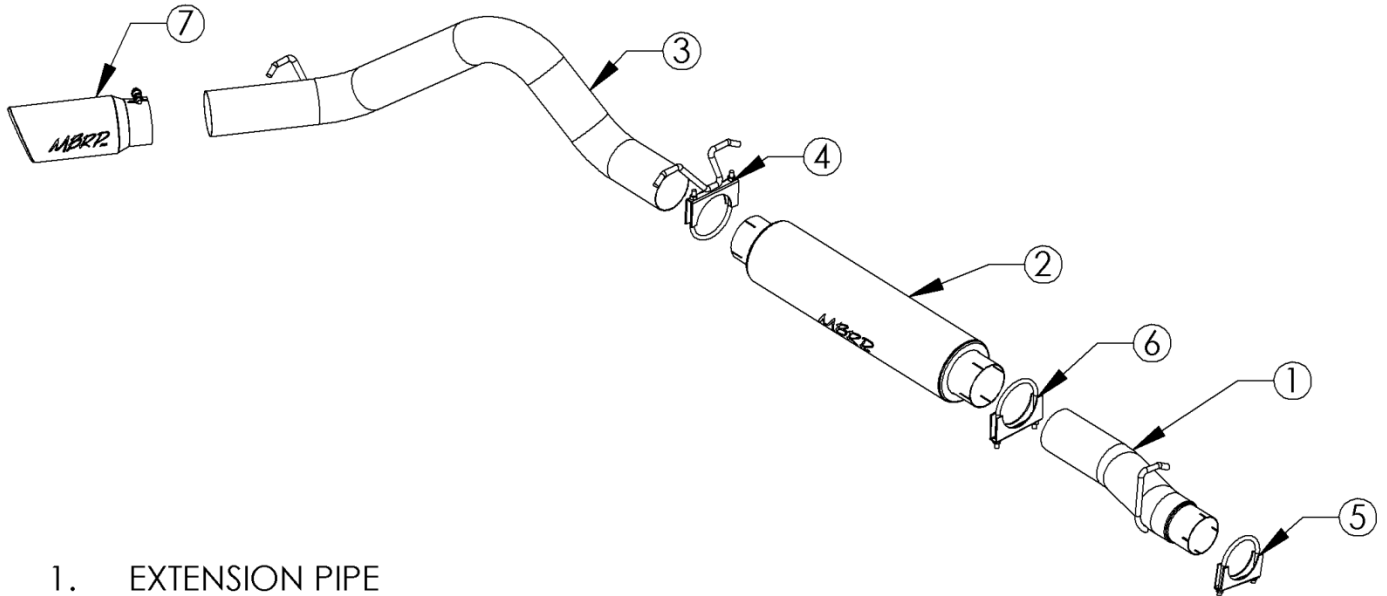

1. EXTENSION PIPE
2. MUFFLER
3. TAIL PIPE
4. HANGER CLAMP
5. 3 1/2" CLAMP
6. 4" CLAMP
7. EXHAUST TIP

## PLEASE READ BEFORE STARTING INSTALLATION

While MBRP Inc. has made every effort to ensure that all components of this system are of superior quality and properly packaged, it is the installer's responsibility to ensure the following before removal of the factory exhaust:

- that ALL components shown above are present.
- that ALL mating components fit together.
- that there are no damaged components.
- that the system you have purchased is appropriate for your vehicle year, model and configuration.
- that the system will not interfere with any modifications previously installed or planned.
- that you have read and understand these instructions.

If you have any questions or are uncertain about any aspect of the installation of this system to your vehicle please contact your dealer before commencing installation.

## Removal of Stock System

1. Apply a penetrating lubricant liberally to all exhaust fasteners, hangers and rubber insulators. **Refer to Figure 1 & 2.**
2. Remove the clamp just after the catalytic convertor.
3. Remove the stock exhaust from the existing rubber isolators and remove the system from the vehicle. **Refer to Figure 1 & 2.**



**Figure 1**



**Figure 2**



**Figure 3**



**Figure 4**

## Installation of MBRP Inc. Performance Exhaust

1. Install the **Extension Pipe** onto the catalytic converter using the **3 1/2" Clamp**. Insert the hanger into the existing rubber insulator. Leave all clamps loose enough for adjustment. **Refer to Figure 3.**
2. Install the **Muffler** over the **Extension Pipe**. A 4" Clamp is used at the connection between the **Muffler** and the **Extension Pipe**. Install the **Hanger Clamp** into the two existing rubber insulators located above the **Muffler**.



**Figure 5**



**Figure 6**

3. Install the **Tail Pipe** from the rear of the truck, over the axle and attach to the **Muffler** outlet. Install the tail pipe hanger into the existing rubber insulator.

4. Install and adjust the **Exhaust Tip** to suit.

6. Align the exhaust as required. Starting at the front of the exhaust, tighten all clamps and connections.

7. Check along the whole length of the exhaust system to ensure that there is adequate clearance around the spare tire, fuel and brake lines or any wiring. If any interference is detected relocate or adjust.

**Congratulations!** You are ready to begin experiencing the improved performance and driving pleasure of your MBRP Inc. performance exhaust system. We know *you will enjoy your purchase.*