

# INSTALLATION INSTRUCTIONS

## FUEL FILTER MOUNT

MITSUBISHI LANCER EVOLUTION X

Support: [info@radiumauto.com](mailto:info@radiumauto.com)

Document# 19-0128

**WARNING: DO NOT EXPOSE WORK AREA TO ANY SPARKS OR FIRE. DO NOT SMOKE WHILE WORKING ON THE FUEL SYSTEM. CLEAN UP ALL FUEL SPILLS IMMEDIATELY. WORK IN A WELL VENTILATED AREA.**

1. Remove the rear bench seat. Find the fuel pump access panel on the left hand side under the lower seat cushion. To remove, first disconnect the electrical loom clip (shown) then carefully pull upwards around the perimeter of the panel. It is fastened down with an adhesive caulking, but can be removed and reinstalled easily.

To depressurize the fuel system, first squeeze the tab and unplug the gray wiring connector on top of the pump housing (shown). Start the engine and allow it to stall. Remove the key from the ignition. Unscrew the gas tank filler cap temporarily to relieve any residual pressure.



2. Dislodge the battery panel in the trunk and disconnect the negative terminal of the battery with a 10mm socket wrench. CAUTION: Disconnecting the battery may cancel fault memories of some control units. Consequently, before disconnecting the car's battery, always interrogate the fault memories.



3. Safely raise the vehicle.

The metal shield near the front left tire that covers the hard lines needs to be removed temporarily. Using a 10mm socket wrench, remove the M6 screws and drop the shield down.

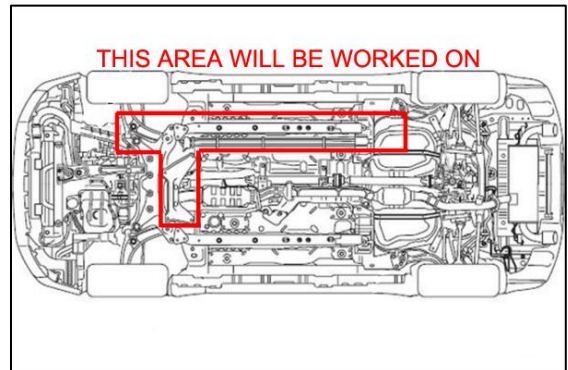

4. The center metal under tray brace (pictured) under the exhaust downpipe elbow and driveshaft needs to be removed temporarily. Remove the 4 bolts and drop the brace down.

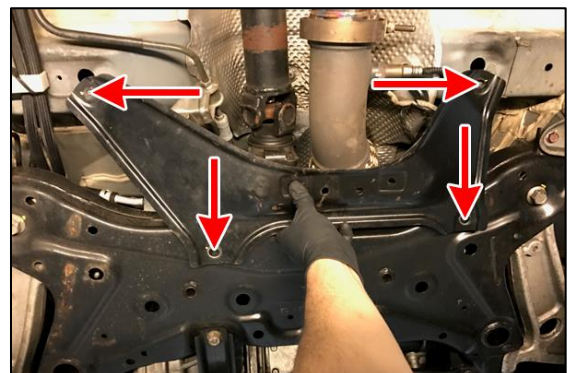

5. When installing the fuel filter bracket (shown in purple), note that the front OEM hard line shield will be reinstalled at the same time. The OEM shield will sit on top of the bracket on one side and underneath the bracket on the other side, as shown.

Use the included stainless steel hardware to secure the shield and bracket. The two M6 bolts require a 4mm Allen wrench.

**NOTE:**

Only install the M8 bolt now if the under tray brace will not be reused.

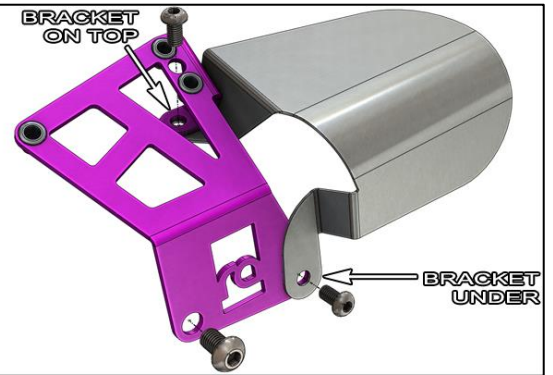

6. Using the included stainless steel hardware, install the lower portion of the fuel filter clamp (shown in red) to the bracket's rivet nuts.

The three M5 bolts require a 4mm Allen wrench.

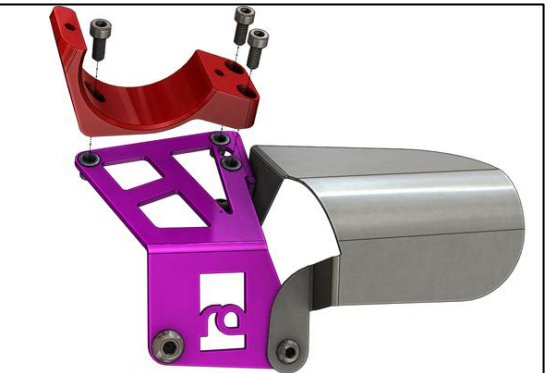

7. Temporarily install the Radium fuel filter (not included) and upper clamp to the lower mount using the 2 socket head screws and a 4mm Allen wrench. Do not torque these bolts yet.

**Make sure the filter is orientated so the outlet (denoted in green) is pointing towards the engine.**



8. From underneath the vehicle, pull and slide the fuel filter downwards out of the clamp. Torque the hose end (not included) to the green fuel filter outlet. Slide the fuel filter all the way back into place. Lineup the clamp to the filter, as shown. For hose end clocking purposes, allow the filter to rotate inside the clamp.

Next, torque the two fuel filter clamp bolts.



9. Make sure the fuel filter inlet hose end (not included) has sufficient ground clearance, as shown.



10. When reinstalling the center under tray brace, first check for clearance near the hose end to the fuel filter inlet. Grind if necessary.

The OEM under tray brace will sandwich the Radium fuel filter bracket. Three of the OEM under tray brace bolts will be reused. For the fuel filter area, use the longer stainless steel button head bolt (shown) included in the kit. Torque with a 5mm Allen hex wrench.



11. Reconnect the battery and turn the key to the ON position. Confirm the fuel pump(s) prime for a few seconds and check for leaks. If no leaks are found, start the vehicle. The engine may run rough for a few seconds until all the air is bled from the fuel system. Recheck for leaks.

Reinstall the OEM metal fuel pump cover plate and rear seat.

**Installation Complete**

