

Part #	Description	Qty.
7900	WHITE STEERING DAMPER	2
83540	UNVRSL DAUL MAIN BRKT JEEP	1
83541	UNVRSL TIE ROD BRKT JEEP	1
38X418X4U	3/8 X 4 1/8 X 4 U-BOLT SQ	1
516X1X134U	5/16 X 1 X 1 3/4 U-BOLT RD	2
38CTN	3/8-16 COARSE N/I LOCK NUT	2
38SAEW	3/8 SAE WASHER	2

Part #	Description	Qty.
516CTN	516-18 COARSE N/I LOCK NUT	4
516SAEW	5/16 SAE WASHER	4
STEM BUSH-SST	STEM BUSHING-STEERING STAB.	8
142120	STAB WASH PKG	4
BTIE	RED BOOT TIE	2
B10RS	RED BOOT	2
HSS	HYDRO SHOCK DECAL	2

1. Park the vehicle on level ground and place the wheel in a straight forward position. Set the emergency brake and block the rear tires.
2. Place main bracket on OUTSIDE of the passenger frame rails on CJ models. Mount on inside of frame rail on YJ models. Install the U-Bolt around the frame with nuts and washers. Do not tighten at this time.
3. Place tie rod bracket on drag link and slide it up towards the turn buckle next to pitman arm. Install U-bolts, nuts, and washers. Do not tighten at this time.
4. Mount stabilizers onto brackets using boots, bushings, and washers provided. Be sure main bracket is slightly forward of the drag link assembly and loosely tightened.
5. Roll drag link bracket toward the front bumper and align with the frame bracket. Extend both stabilizer shafts out 4", exactly half way. Loosely mount tie rod bracket at that point. On CJ models the bracket will mount on the turn buckle. Tighten all U-Bolts at this time.
6. Rotate tires left to right and check all hardware for adequate clearance. Re-tighten all hardware after the first 100 miles and periodically thereafter.

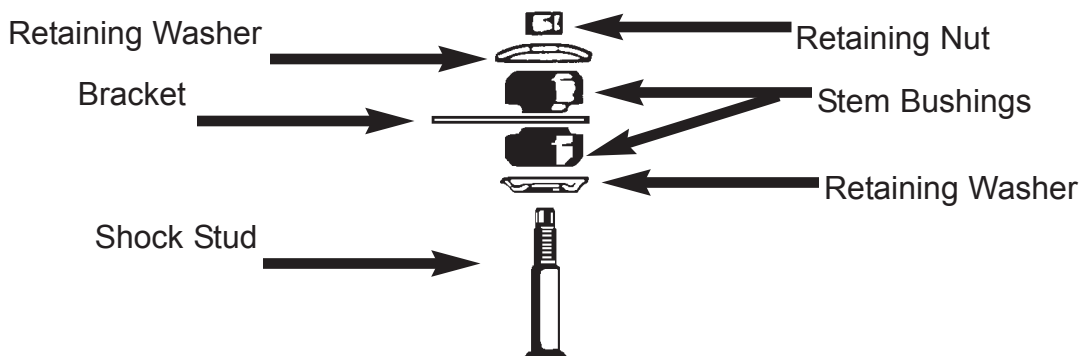

NOTE: Main bracket goes on the outside of frame for CJ models. For 1987 and up YJ models, the bracket will mount on the inside as shown.

