

**Chrysler 42RE, 42RH, 46RE,
46RH, 47RE, 47RH, 48RE, A727, A904**

**Reverse Servo
Piston Plug Kit**

**Part No.
22912-01K**

- Plug
- O-Ring
- Retaining Ring

CAUTION **NOTE:** The tip of Sonnax piston plug must be cut off when used in anything other than 47RH/RE (A618) or 48RE applications. Failure to modify the plug will result in incorrect reverse servo assembly height, resulting in no movement and/or burned reverse band.

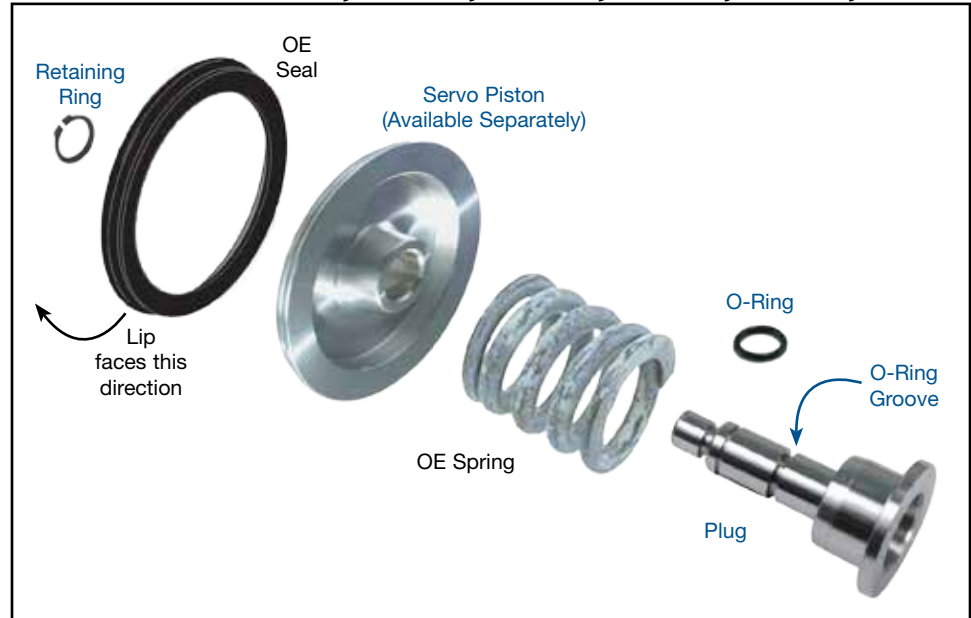

1. Disassembly

- Remove and discard OE plug.
- Examine the servo piston bore for wear and replace if necessary.

2. Installation & Assembly

CAUTION **NOTE:** If installing in 47RH/RE (A618) or 48RE application, no modification is necessary. Proceed to "Step C".
If installing in 40RH, 42RH, 42RE, 44RE (A500), 46RH/RE (A518), 36RH, 37RH (A727), or 30RH (A904) applications, the tip of the replacement plug **MUST** be cut off. Proceed to "Step A".

- At the indicated groove, use a band saw or hack saw to cut off the plug tip (**Figures 1, 2 & 3**).
- The small .010" step and any remaining cut-off burrs should be ground off flush to the new plug end to ensure proper travel and set-up. Failure to remove burrs and grind flush can lead to contamination problems and difficulty establishing correct servo assembly height (**Figure 1**).
- Install the o-ring in the indicated plug groove, and lubricate with assembly lube.
- Reassemble OE spring, piston and o-ringed plug using main photo as orientation guide.
- Use the included heavy-duty retaining ring to secure the o-ringed plug to the piston.
- Band and servo travel should be readjusted to OE specifications.

