

1-800-345-4545 VOICE
1-614-751-9873 FAX



Jeg's National Headquarters • 101 Jeg's Place • Delaware, OH 43015



Estimated build time is 2-3 days

Custom Driveshaft Order Form
All Orders Must Be Prepaid

| 1. Shipping Address <small>*We cannot deliver to PO box!</small> | |
|--|-----------------------|
| Home Phone _____ | |
| Name _____ | |
| Address* _____ | |
| City _____ | State _____ Zip _____ |

| 2. Credit Card Billing Address | |
|--------------------------------|-----------------------|
| Name on card _____ | |
| Address _____ | |
| City _____ | State _____ Zip _____ |
| Work Phone _____ | |

| 3. Billing Information | |
|--|--|
| <input type="checkbox"/> Credit Card # _____ | |
| Expiration Date _____ | |
| <input type="checkbox"/> Certified Check/Money Order | |

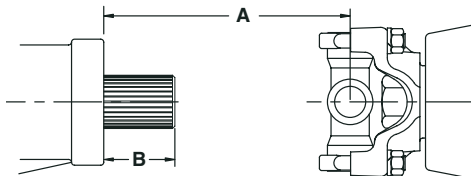

Figure #1

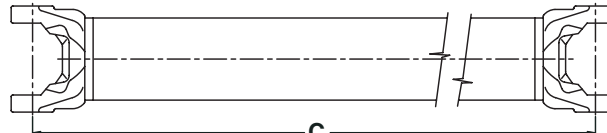
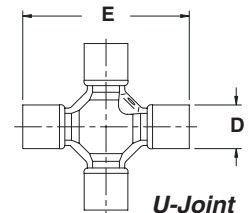

Figure #2



U-Joint

Figure #1 - Ordering driveshaft with a transmission yoke to be supplied by Strange Engineering.

A= _____ B= _____ To fit your rear-end yoke: D= _____ E= _____
 Transmission type: _____ Output shaft spline: _____
 Extension housing type: Bronze bushing Roller bearing

Figure #2 - Ordering driveshaft only, no transmission yoke.

To fit your transmission yoke: D= _____ E= _____ C= _____
 To fit your rear-end yoke: D= _____ E= _____

Parts required:

- D.O.M. (seamed) chrome-moly driveshaft, welded, balanced, with u-joints.*
- Seamless chrome-moly driveshaft, welded, balanced, with u-joints.*
- Seamless chrome-moly driveshaft, welded, balanced, with "high-impact" u-joints.
- With heavy-duty Spicer 1350 series transmission yoke.
- With severe duty Strange stainless steel 1350 series transmission yoke.
- With u-bolt kit for Strange 1350 series rear-end yoke.

* All Strange driveshafts have 1350 series weld ends installed unless otherwise specified.

D=1.1875, E=2.625. D.O.M. (seamed) chrome-moly shafts have Spicer weld ends, seamless chrome-moly shafts have forged Strange chrome-moly weld ends. If all mating pieces are 1350 series, Spicer heavy-duty (non-cross drilled) u-joints are used. An optional "high impact" 1350 Spicer u-joint is also available for Pro Mod. applications. If a conversion u-joint must be used to adapt to your transmission and/or rear-end yoke, it will be "cross-drilled" style u-joint.

Conversion u-joints available:

U-1645- D=1.125, E=3.625 (Uses inside c-clips, measured from outside of c-clips = 2.645)

U1646- D=1.0625, E=3.217 **U1647-** D=1.0625, E=3.625