

Please confirm that all parts are present according to the bill of materials before beginning the installation.

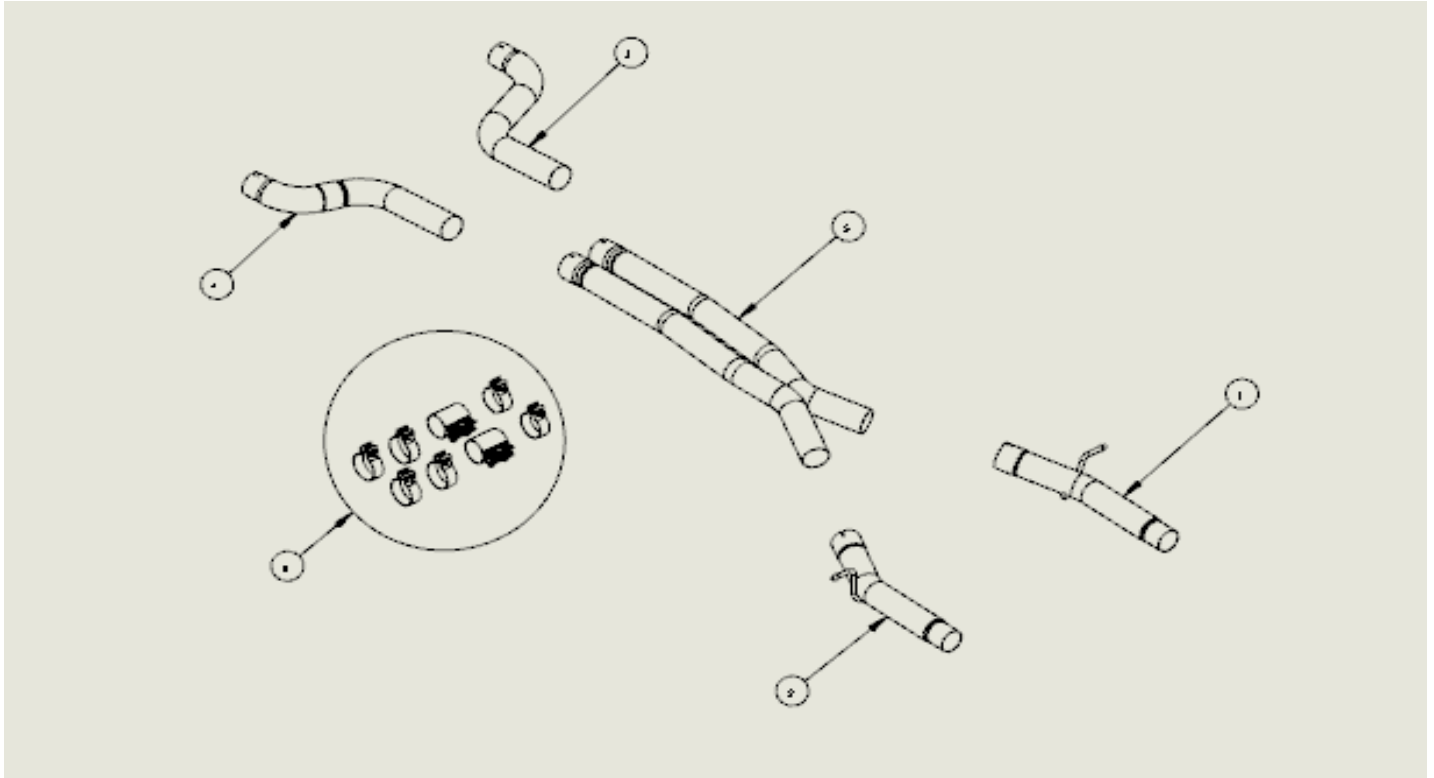

BILL OF MATERIALS

1.	Passenger Axle Pipe (16CM4028)	2.	Driver Axle Pipe (16CM4029)
3.	Passenger Head Pipe (16CM4052)	4.	Driver Head Pipe (16CM4053)
5.	Cat Connect Single X-Pipe (16CM4058)	6.	Hardware Kit (16CM7015)