

# INSTALLATION INSTRUCTIONS for JEGS 70606 on 70601 HEATER

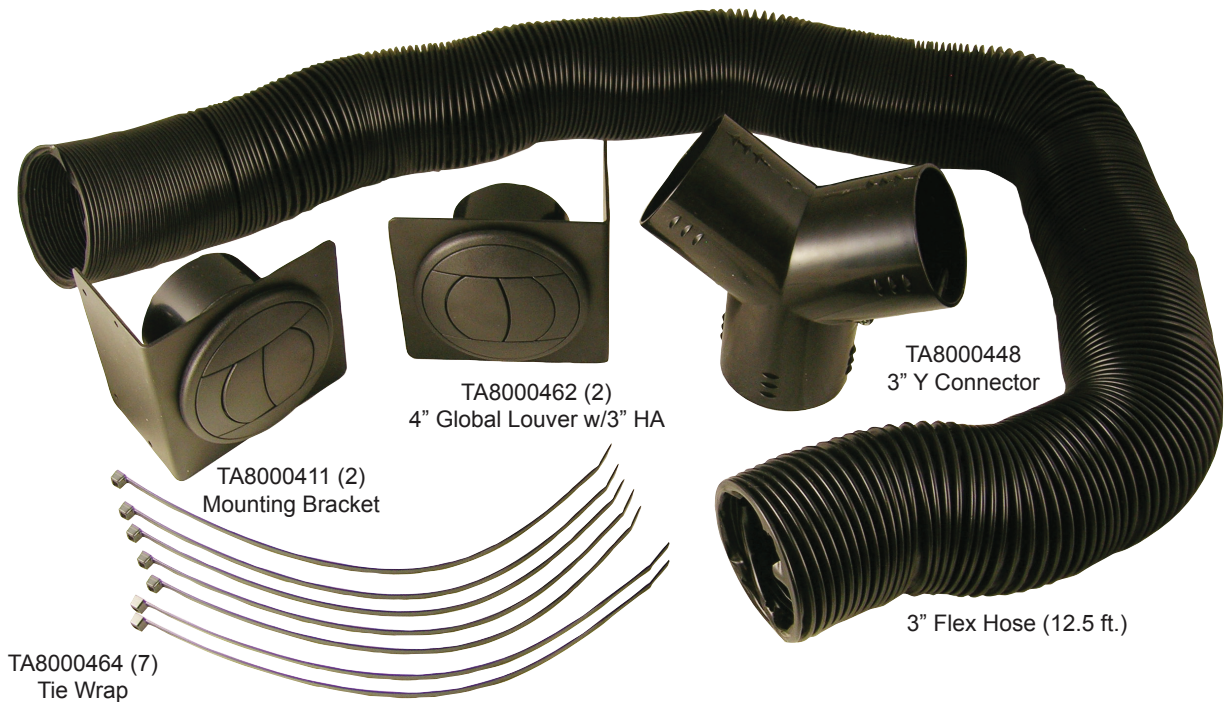

1. Cut 1 ft. of 3" Flex Hose (12.5 ft.) and attach to Heater Outlet with Tie Wrap (TA8000464). Other Outlet can remain uncovered for floor heat (or attach Defrost Kit 70605).
2. Attach 3" Y Connector (TA8000448) to 3" flex hose with tie wrap (TA8000464).
3. Cut remaining 3" Flex Hose accordingly and attach to 3" Y Connector (1892) with Tie Wraps (TA8000464)(2 times).
4. Snap 4" Global Louver w/3" HA (TA8000462) into Mounting Bracket (TA8000411)(2 times).
5. Attach 4" Global Louver w/3" HA (TA8000462) to 3" Flex Hose with Tie Wrap (TA8000464) (2 times).

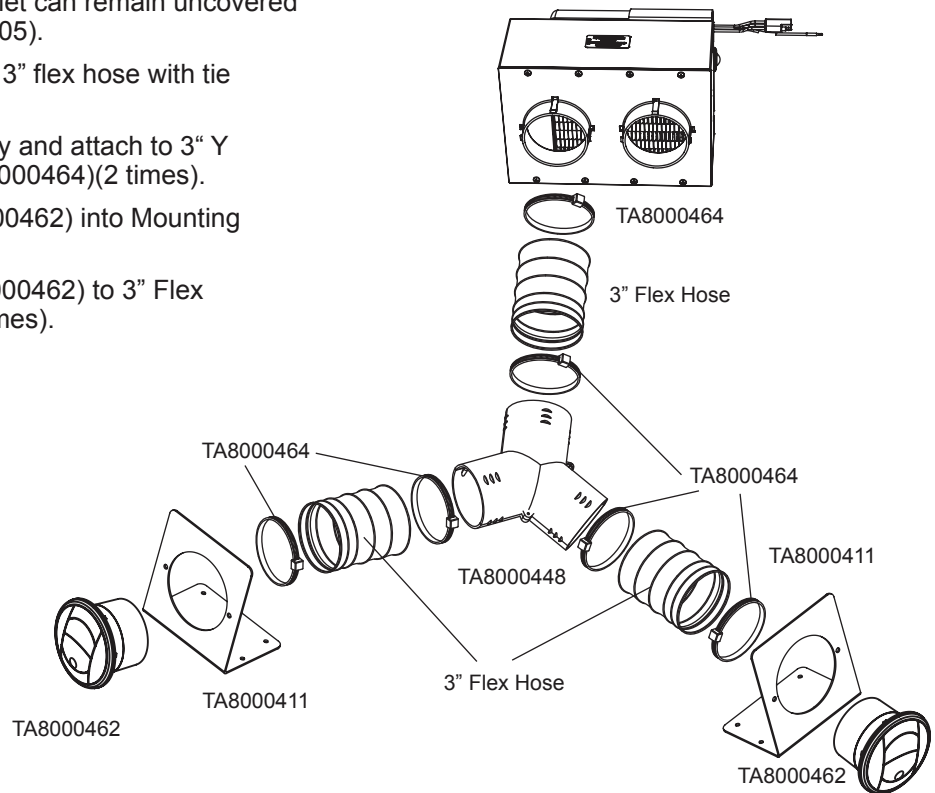

1-800-345-4545

JEGS.COM