

DIRECTION 373

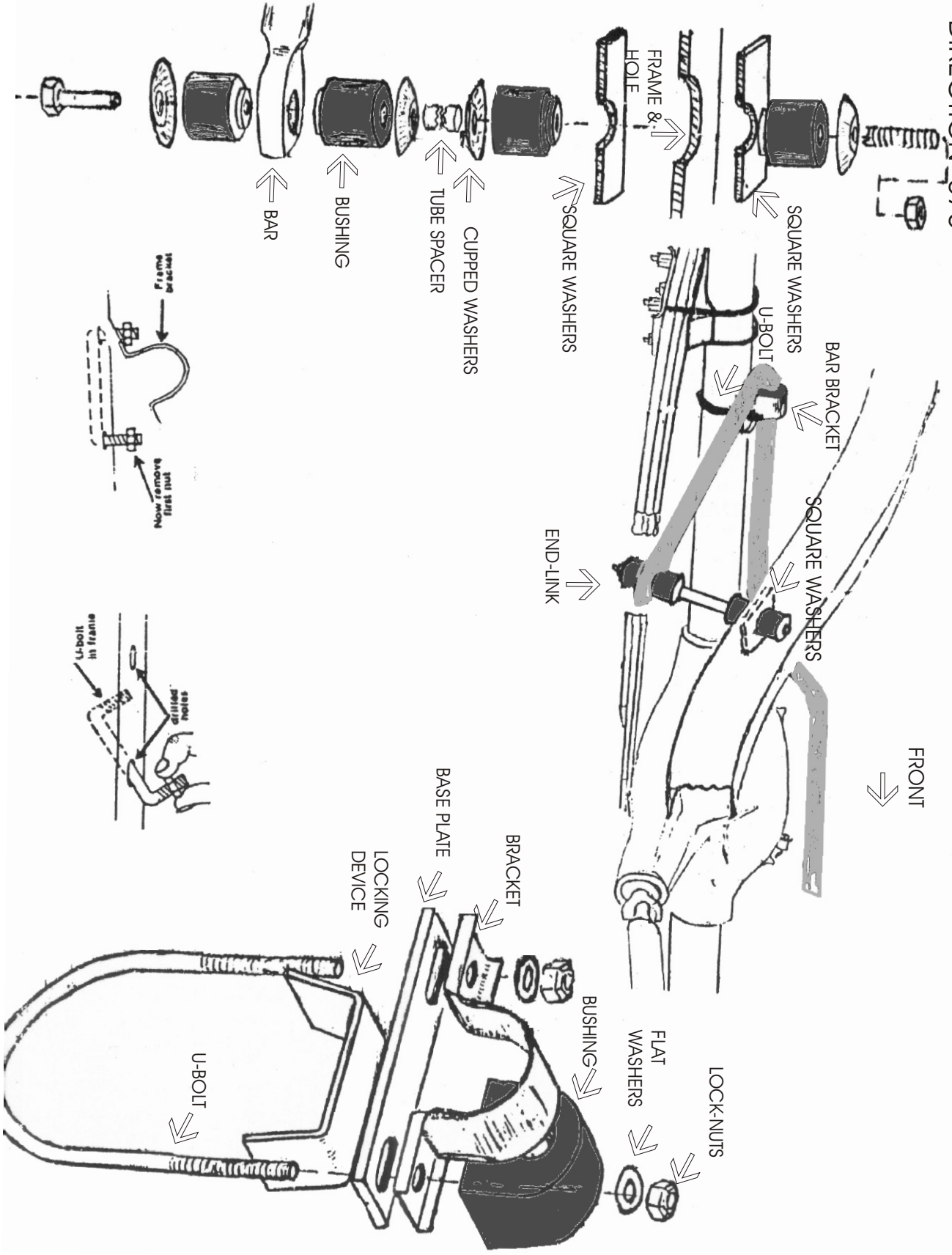

DIRECTIONS 373

- STEP #1.** Place the bar in position on top of the axle dip up, with the arms leading to the front. On top of the axle towards the shoulders of the bar, place the locking device and plate, which will now be between the axle and the bar. Place the bar bracket over the bar, aligning with the plate. Pass the large U-bolt up from below the axle through the holes in the plate, through the bar bracket and start the nuts. Be sure that the U-bolts and other parts are between the brake line and the axle so as not to crush them. Slightly pull the brake line away from the axle if needed.
- STEP #2.** Place the D-bushing on the bar mid-section and slide it under the bar bracket. Adjust the position of the bracket and U-bolts about the axle so that they give best clearance to the shocks, rear end breather, etc. Also so they hold the bar in the most suitable position along the top part of the axle. The bolts and bracket do not need to be equally spaced along the axle on the two sides. Tighten the U-bolt nuts sufficiently to keep the assembly in position during installation.
- STEP #3.** Assemble the end-links onto the bar ends as shown to connect the bar eye to the frame.
- STEP #4.** Have someone bounce the rear of the car so that you can check for clearance throughout the suspension travel distance. Tighten the nuts on the axle U-bolts to 10 ft/lb. Check to make sure they are holding securely. Test-drive the vehicle to accustom yourself to its new handling. As we cannot supervise your installation, or your driving, we cannot be held responsible for more than the cost of the kit.
NOTE: All of the nuts in this kit are lock-nuts that will need to be turned all the way with a wrench.

HARDWARE

2 RH 016	End-Links	2 RH 407	U-Bolts
2 RH 055	Locking Devices	2 RH 031	Plates
2 RH 508	D-Bushings	2 RH 046	Brackets
4 RH 104	Washers	4 RH 304	Lock-Nuts
4 RH 111	Washers		