



**Part #678**

**Ford Mustang Rear**

**8-23-2005**

**NOTE:** This bar does not mount like a factory bar. If your car is equipped with a factory bar, kit #990 is a direct replacement that will be easier to install than kit #678.

- Step 1.** Raise the rear axle just enough to allow the rear wheels to be removed. Support the axle so that the weight of the car remains on the springs. (Do not allow the rear axle to hang). Remove the right wheel and the bottom of the left side shock absorber.
- Step2.** Install the D-bushing on the bar center section. Insert the bar from the right side with the center section behind the axle for now. The shock absorber can be reconnected at this time.
- Step 4.** Tighten the end-link nut just enough to deform the bushings a slight amount. Raise the bar mid-section to meet the frame. Adjust the position of the D-bushings so that the flat side is against the frame. Adjust the position of the bar so that the end-links are near vertical from front to rear.
- Step 5.** Place the frame brackets around the D-bushing and mark the frame for drilling, through the holes in the bracket. **FOR YOUR SAFETY, ALWAYS USE CAUTION WHEN WORKING UNDER AN ELEVATED CAR AND WEAR EYE PROTECTION WHEN DRILLING.** Drill the frame using a 3/8" drill bit.
- Step 6.** Place a nut on one leg of each of the short leg U-bolts. Insert the other legs in the holes of the frame. Maneuver the U-bolts until the other legs drop out the other holes. Remove the nuts and install a base plate (one on each side) over the legs of the U-bolt. Install the D-bushing brackets and secure with the nut provided. Tighten all U-bolt nuts to 15 lbs./ft. Install the tire and lower the car.
- Step 7.** Road-test your car to familiarize yourself with its new handling. As we cannot supervise your installation or driving, we cannot be held responsible for more than the cost of the kit. For best balance, control and stability, this kit should be used in conjunction with one of our front kits.

**Hardware**

<b>2 RH 014 End-Links</b>	<b>2 RH 031 Base Plates</b>
<b>2 RH 041 Brackets</b>	<b>2 RH 040 Brackets</b>
<b>2 RH 508 Bushings</b>	<b>2 RH 403 U-Bolts</b>
<b>2 RH 402 Square U-Bolts</b>	<b>8 RH 304 Lock-Nuts</b>
<b>4 RH 104 Flat Washers</b>	

# DIRECTION 678

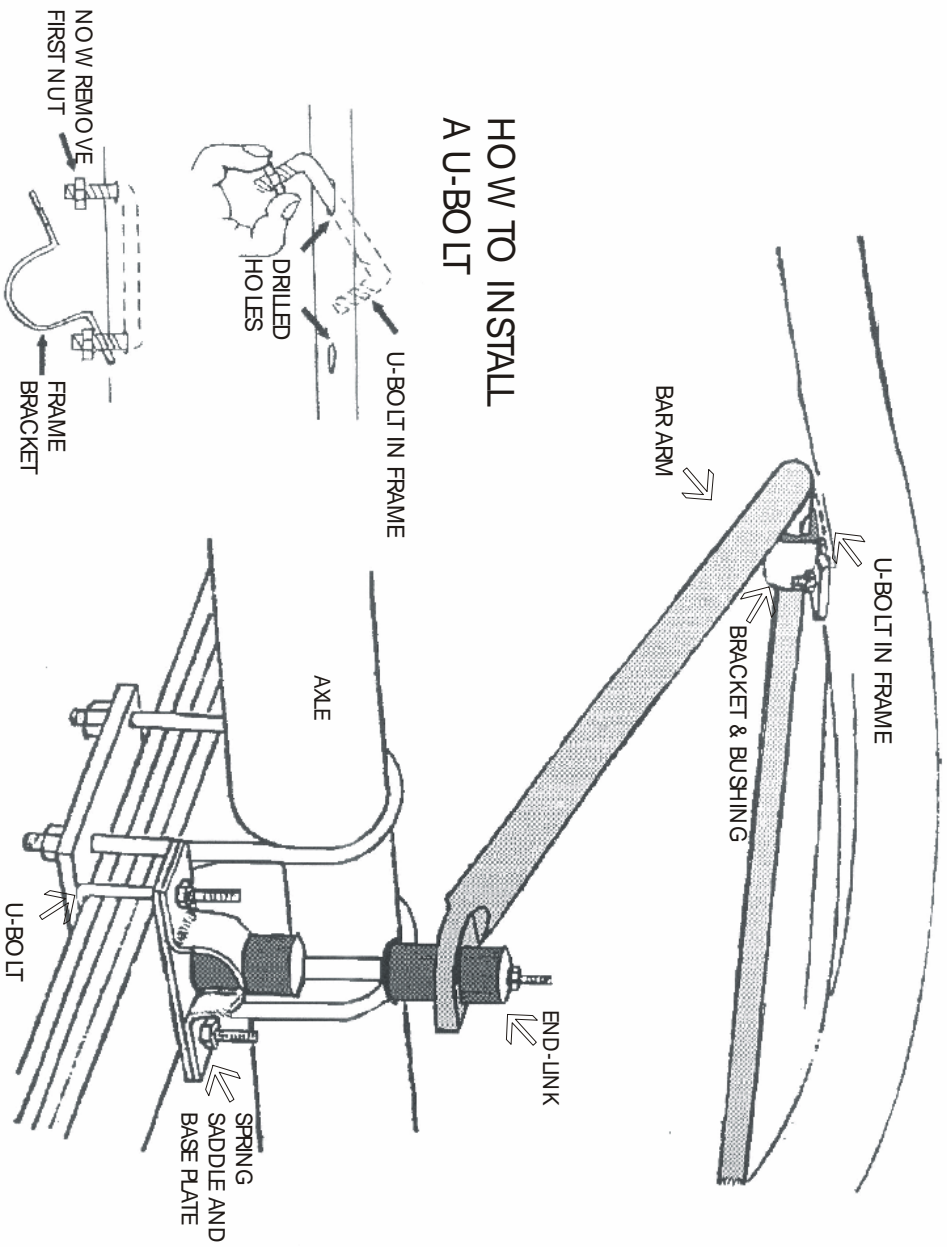

## HOW TO INSTALL A U-BOLT

