

# DIRECTION 765

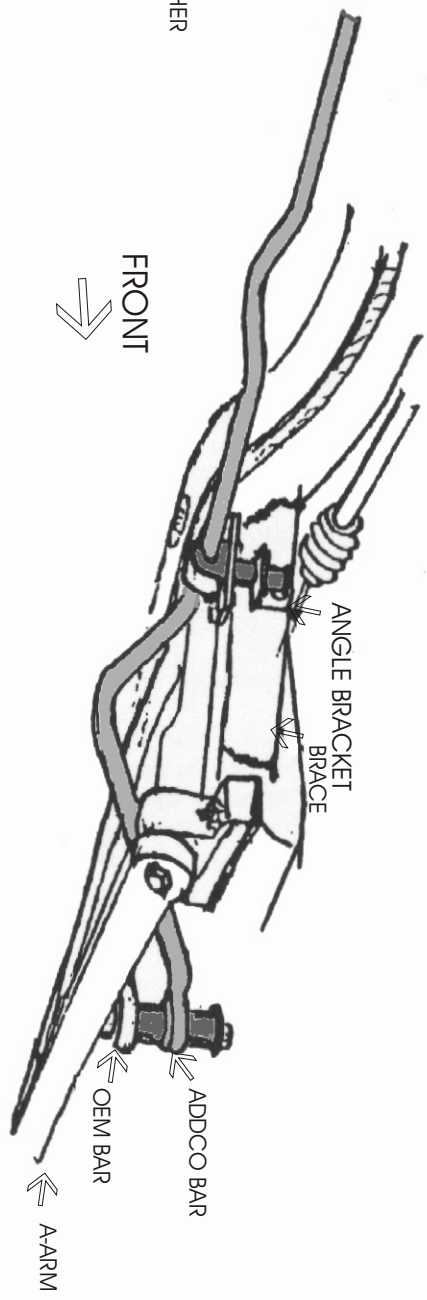
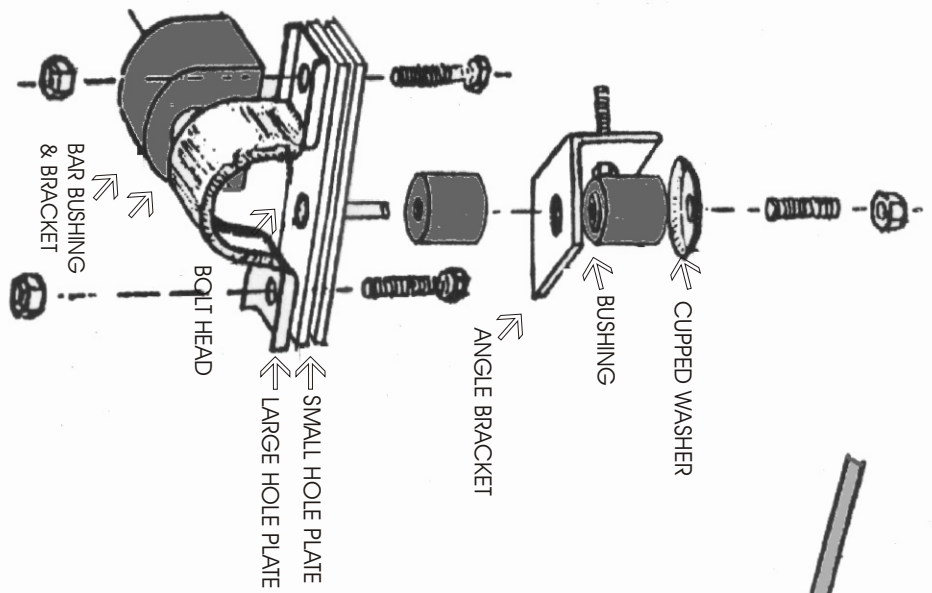

VIEW: LEFT FRONT

MID-SECTION DETAIL

**DIRECTIONS 765**

**HONDA CRX 1984-1987**

**NOTE:** This bar is not an O.E. replacement. It will work in conjunction with the O.E. bar, because of the difficulty of removing the O.E. bar.

**STEP #1.** Due to the low ground clearance it will be necessary to put the car on ramps. Do not raise the car off of the ground or allow wheels to hang. Car must be at normal ride height.

**STEP #2.** Remove O.E. end-link assembly on both sides. Replace with end-link supplied as shown in illustration. Connecting the bar with O.E. bar.

**NOTE:** Bar arms are designed to fit up in between lower control arms with dip down to clear exhaust. Tighten end-links until bushings bulge slightly.

**STEP #3.** Place the "D" bushings around the mid section of bar. Assemble the mid-section hanger assembly as shown, around the "D" bushing on the bar. Repeat for other side.

**STEP #4.** With hanger in place hold or clamp angle bracket to the side of the frame brace. The arms of the bar must be centered in the A-arms to avoid contact! Mark the brace to be drilled using a 3/8" drill bit. Always use caution when drilling and wear eye protection.

**STEP #5.** Remove angle bracket from hanger assembly and bolt angle to frame brace. Replace hanger assembly through 5/8" hole, place bushing, cupped washer and nut back on hanger center bolt. Tighten nut until bushings bulge slightly.

**STEP #6.** Installation is now complete. Have someone bounce the front of the car to check for proper clearance of all suspension parts. Road test your car to familiarize yourself with its new handling. As we cannot supervise your installation or your driving. We cannot be held responsible for more than the cost of the kit. For best balance and control, this kit should be used in conjunction with our kit # 394.

**Note:** Due to motor location there may be difficulty in drilling. Once proper positioning of brackets has been determined, you may also weld these brackets in place.

**HARDWARE**

2	RH 225 Bolts	2	RH 040 Brackets
2	RH 034 Plates	2	RH 034B Plates
2	RH 507 Bushings	2	RH 207 Bolts
14	RH 500 Bushings	2	RH 109 Washers
2	RH 022 Angles	7	RH 214 Bolts
8	RH 304 Nuts	2	RH 307 Lock-Nuts
8	RH 107 Washers	2	RH 060B Spacer Tubes