

Airaid

INSTALLATION INSTRUCTIONS

450-378 700-462 Airaid Oiled Media Filter

451-378 701-462 SynthaMax Dry Media Filter

2016-18 FORD Mustang Shelby GT350

V8-5.2L Supercharged

NOT LEGAL FOR SALE OR USE ON ANY POLLUTION CONTROLLED MOTOR VEHICLE IN CALIFORNIA OR STATES ADOPTING CALIFORNIA EMISSION PROCEDURES.

See Airaid.com for CARB status on each part for a specific vehicle

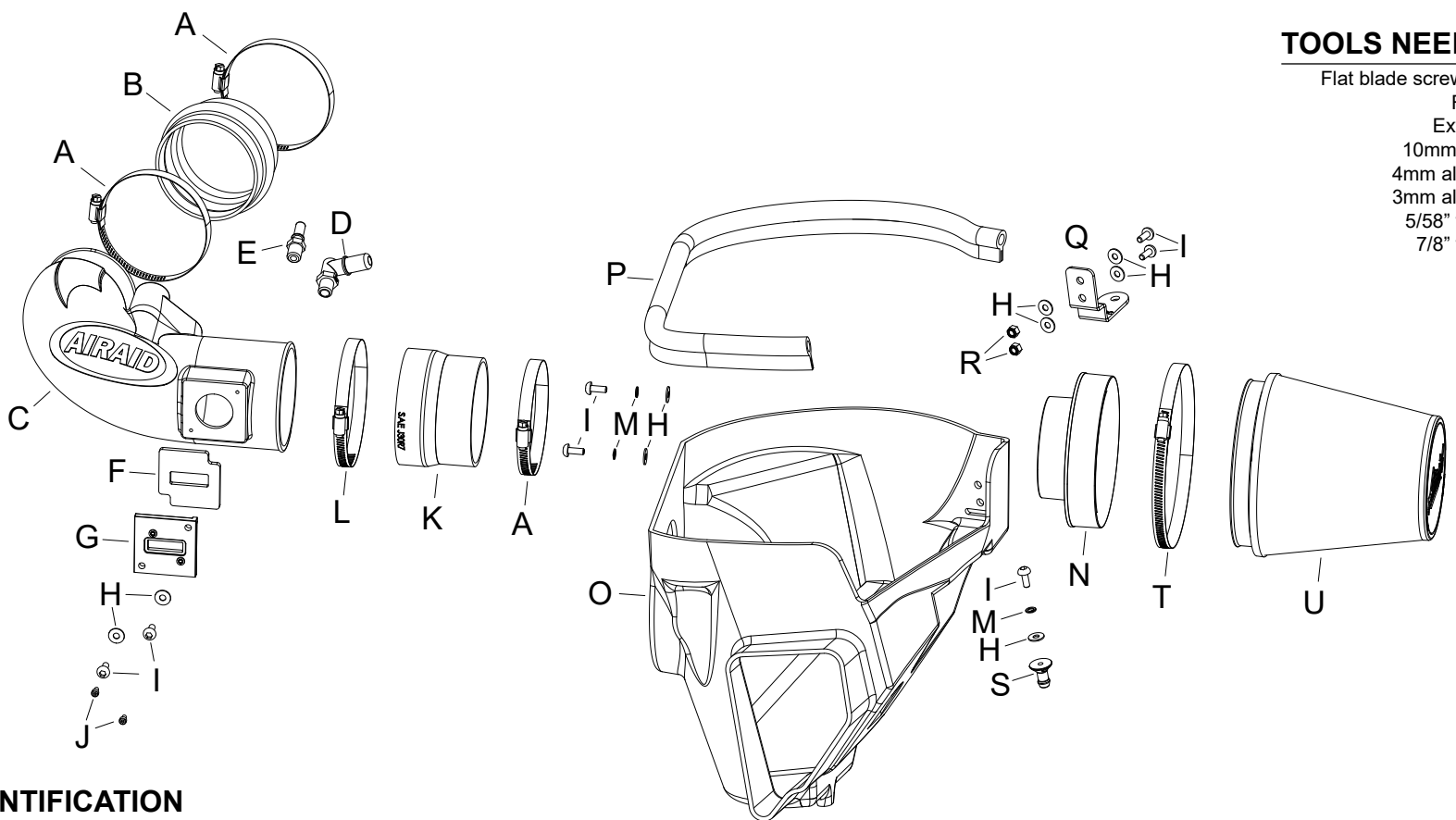

TOOLS NEEDED:

Flat blade screw driver
Ratchet
Extension
10mm socket
4mm allen key
3mm allen key
5/58" wrench
7/8" wrench

COMPONENT IDENTIFICATION

Description	Qty.	Part #	Description	Qty.	Part #	Description	Qty.	Part #
A HOSE CLAMP #64 STAINLESS	3	08645	H WASHER; 6MM FLAT, SS	9	08269	O AIR BOX; COLD AIR-45%-378	1	KIT378CAB
B HUMP HOSE; REDUCING 4"ID	1	KITHUMPHS35	I BOLT; M6 X 1.00 X 16MM, SS	7	07730	P EDGE TRIM (32")	1	102479
C TUBE; INTAKE, AIR-45%-378	1	KIT378	J BOLT; M4 - 0.7 8MM, A/H CAP	2	07733	Q BRACKET; AIR-KIT378BC	1	KIT378BC
D VENT; 90"D, 1/4"NPT, QUICK	1	82633	K REDUCER; 4.325"ID X 4" X 3"L	1	KITRDCR30	R NUT; 6MM NYLOCK, HEXHEAD	2	07512
E VENT; STRT, 1/4NPT QUICK	1	82630	L HOSE CLAMP; #72 SS	1	KITHS72	S MOUNT, PLASTIC AIRBOX	1	8-186-1
F GASKET; 3/16 PORON	1	09069	M WASHER, M6 SPLIT LOCK ZINC	3	1-3025	T CLAMP; #104, 9/16", SS	1	KITHS104
G ADAPTOR; MAF SENSOR	1	21515-1	N ADAPTOR; #454	1	27300	U FILTER	1	700/701-462

Full color instructions can be viewed on our web site at Airaid.com. If you need any assistance please call 1-800-498-6951 to speak with a representative in our Customer Service Center before returning the product.

TO START:

1. Turn off the ignition and disconnect the negative battery cable.

NOTE: Disconnecting the negative battery cable erases pre-programmed electronic memories. Write down all memory settings before disconnecting the negative battery cable. Some radios will require an anti-theft code to be entered after the battery is reconnected. The anti-theft code is typically supplied with your owner's manual. In the event your vehicles anti-theft code cannot be recovered, contact an authorized dealership to obtain your vehicles anti-theft code.



2. Disconnect the mass air sensor electrical connection and then unhook the harness retaining clips.



3. Remove the four nuts that secure the upper half of the factory heat shield and lip seal.



4. Loosen the hose clamp at the throttle body. Disconnect the vent lines attached to the intake tube and then remove the intake tube from the vehicle.



5. Remove the foam air dam, then remove the bolt that secures the factory lower air filter housing and then remove the housing from the vehicle.

NOTE: AIRAID recommends that customers do not discard factory air intake.



6. Install the provided filter adapter into the AIRAID® filter housing and secure with the provided hardware.

Continued...



7. Install the mounting bracket and mounting stud onto the air filter housing using the provided hardware.



8. Install the factory air box mounting bracket onto the mounting stud installed onto the AIRAID® air filter housing in the previous step.



9. Install the provided edge trim onto the AIRAID® filter housing as shown.

NOTE: Some trimming of the edge trim may be necessary.



10. Remove the fresh air intake duct from the factory air filter housing and install it onto the AIRAID® air filter housing.



11. Install the AIRAID® filter housing assembly into the vehicle and secure with the factory bolt used to secure the factory housing.



12. Reinstall the factory foam air dam.



13. Install the provided gasket onto the mass air sensor adapter. Remove the mass air sensor from the factory hosing and install it into the AIRAID® adapter and secure with the provided hardware.



14. Install the mass air sensor assembly into the AIRAID® intake and secure with the provided hardware.



15. Install the provided vent fittings into the AIRAID® intake tube as shown.
NOTE: Plastic NPT fittings are easy to cross thread. Install the vent fitting "hand" tight, then turn it two complete turns with a wrench.



16. Install the provided hump coupler onto the throttle body and straight coupler onto the filter adapter and then secure with the hose clamps provided.



17. Install the AIRAID® intake tube into the coupler at the heat shield and then the throttle body, adjust the tube for best fit and then secure with the provided hose clamps.



18. Install the AIRAID® air filter onto the filter adapter and secure with the provided hose clamp. Reconnect the mass air sensor electrical connection.



19. Connect the factory vent lines to the fittings installed into the AIRAID® intake tube.



20. Double check your work! Make sure there is no foreign material in the intake path. Make sure all clamps, hoses, bolts, and screws are tight. Double check the hood clearance! **Reconnect the negative battery cable!**

Thank you for purchasing the Airaid Intake System. Contact Airaid @ (800) 498-6951 8:00 AM - 5:00 PM MST weekdays for questions regarding fit or instructions that are not clear to you. Your Airaid Intake System was carefully inspected and packaged. Check that no parts are missing, or were damaged during shipping. If any parts are missing, contact Airaid. The air filter element is protected from direct exposure to water and debris; care should be taken not to drive through deep water. **WATER INGESTION IS THE DRIVERS RESPONSIBILITY!** The air filter is reusable and should be cleaned periodically.

For your Oiled media filter we offer the Airaid Tune Up Kit!



P/N 790-551 Aerosol Spray
P/N 790-550 Squeeze Spray



NOT LEGAL FOR SALE OR USE ON ANY POLLUTION CONTROLLED MOTOR VEHICLE IN CALIFORNIA OR STATES ADOPTING CALIFORNIA EMISSION PROCEDURES.

See Airaid.com for CARB status on each part for a specific vehicle

SynthaMax

Synthamax Air Filters do not require oil. Service air filter as needed by cleaning with common non-petroleum all-purpose household cleaner and water. Simple Green®, Formula 409® or equivalent works great. Apply cleaner to outside of air filter and allow to soak. Then flush filter clean from the inside out with a garden hose and repeat steps if necessary. Do not apply high pressure water or air to clean filter. Allow filter to air dry and reinstall.