

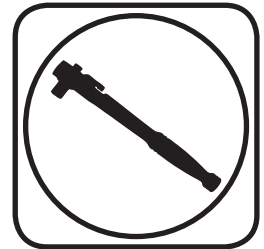

Part # 11227298 - GM A-Body & G-Body Differential R-Joint Bushing Installation

Recommended Tools



GM A-Body & G-Body Differential R-Joint Bushing Installation

Installation Instructions

Table of Contents

Page 2..... Included Components and R-Joint Installation

New R-Joints will be quite stiff (75-90 in/lbs breakaway torque) until they “break in” after a few miles of use. After the break in period they will move much more freely. Because the composite bearing race contains self lubricating ingredients, no additional lubrication is needed or desired. Any additional lubrication will only serve to attract more dirt and debris to the R-Joint and actually shorten its life.





Major ComponentsIn the box

Part #	Description	QTY
R-Joint Housing Components		
90002868	R-Joint Bushing Housing	2
70013776	Housing Snap Ring	2
70013784	R-Joint Spacers	4
R-Joint Components Installed In Housing		
70013275	R-Joint Center Ball	2
70013276	R-Joint Composite Center Ball Cage	2
70013279	Retaining Ring	2
70013280	Wavo Wave Spring	2

R-Joint Installation

It is important to not get the bushings crooked on installation.

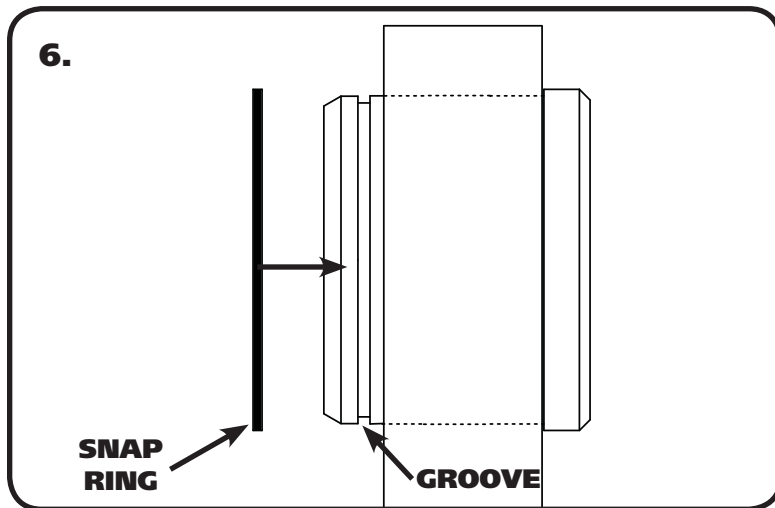

1. Install the R-Joint Housing into the OEM bushing hole, making sure it goes in straight. Next, install the supplied Snap Ring into the groove on the bushing housing.

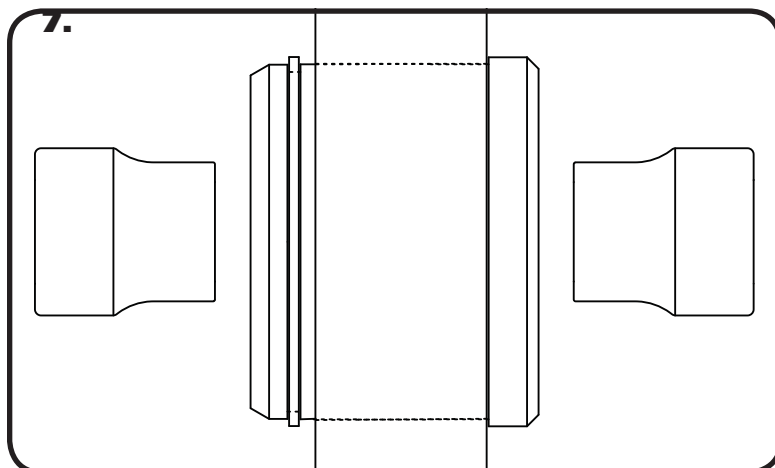

2. Install the Spacers by inserting the SMALL side of the SPACER into the Center Pivot Ball. Push them in until they bottom out and stop.

3. Install your Ridetech StrongArms. Refer to the instructions supplied with the StrongArms.