

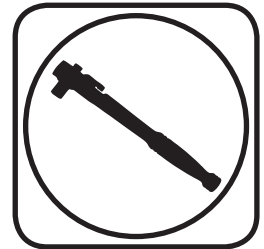

Part # 85000011 - Differential Bushing Removal/Installation Tool



Recommended Tools



Differential Bushing Removal/Installation Tool

Installation Instructions

Table of Contents

Page 2..... Included Components and Getting Started

Page 3-4..... Bushing Housing Installation





Major ComponentsIn the box

Part #	Description	QTY
90002560	1.875" ID x 1.00" Long Sleeve	1
90002880	1.825" OD Washer	1
90002566	2.625" OD Washer	1
90002559	2.375" ID x 2.375" Long Sleeve	1
99505003	1/2"-10 x 8" ACME Threaded Rod	1
99502013	1/2"-10 ACME Hex Nut	2
99503003	1/2" Flat Washer	2

Getting Started.....

This kit is designed to aid in the removal of the OEM bushings and installation of the Delrin R-Joint Axle Housing Bushing. This guide will show you how the kit is to be used. It is important to not get the bushings crooked on installation.

1.

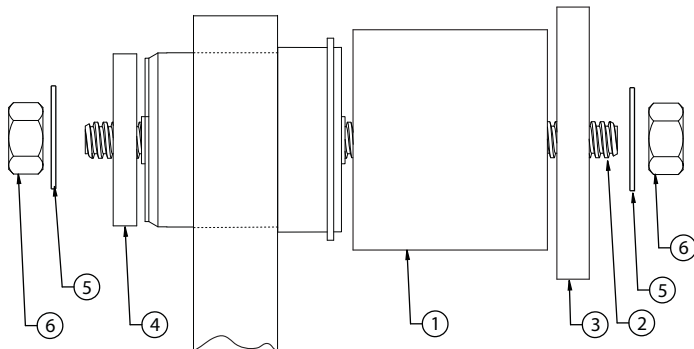

1. Start by sticking the 2 3/8" Sleeve(1) over the OEM bushing. Insert the 1/2"-10 x 8" Threaded Rod(2) into the OEM bushing. Install the Large 2 5/8" Diameter Washer(3) onto the threaded rod on the Sleeve side. Install the Small 1.825" Washer(4) on the threaded rod (on the side with the bushing sticking through the housing). Install a 1/2" washer(5) and nut(6) on each end of the threaded rod. Use **Images 1 & 2** as a reference.

2.

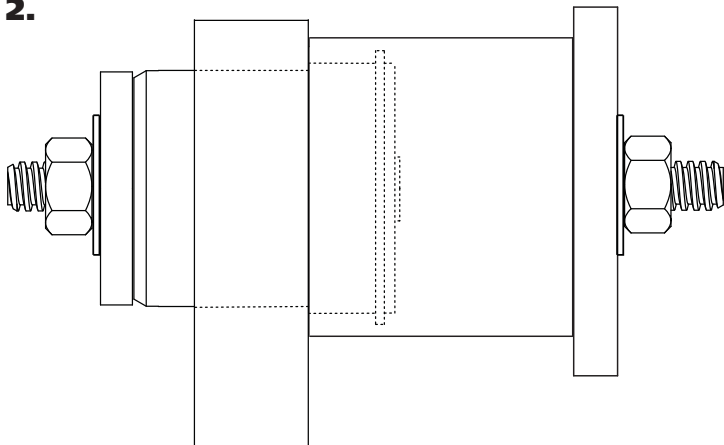

2. Tighten the 1/2" nuts, pushing the bushing out of the mount.



Bushing Housing Installation

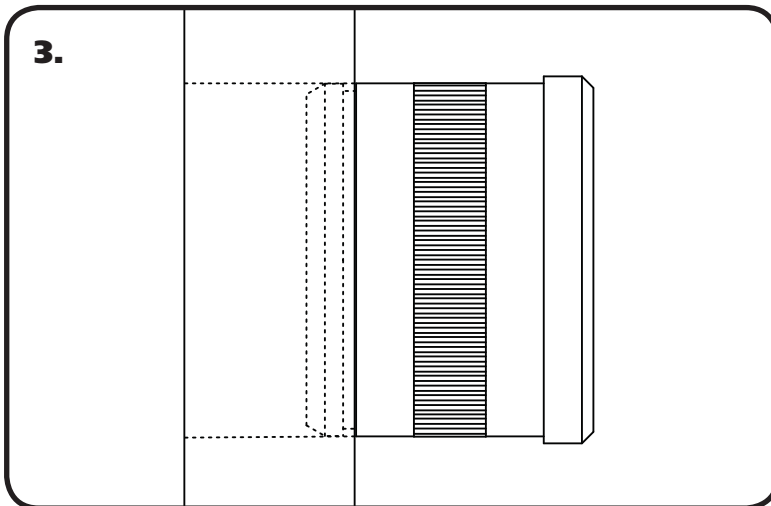

3. Start the R-Joint Housing into the OEM bushing hole by hand.

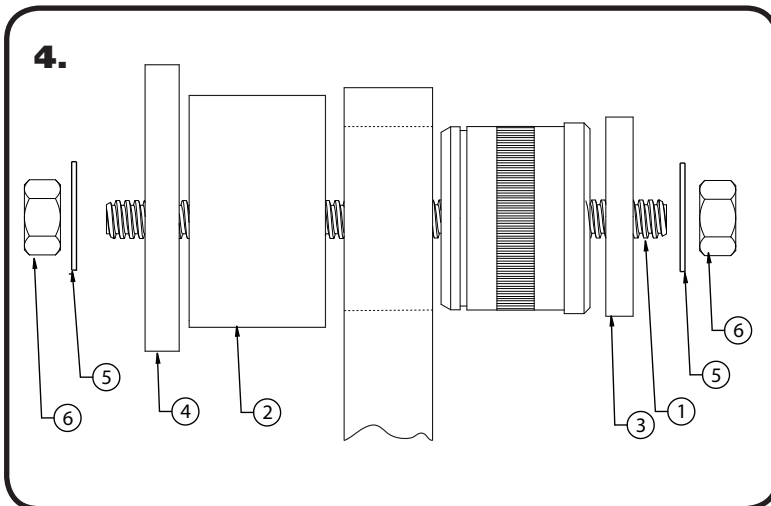

4. Insert the 1/2"-10 x 8" Threaded Rod(1) into the bushing. Install the 1 7/8" ID x 1" Long Sleeve(2) on the opposite side of the bushing. This sleeve will be centered over the bushing hole. Install the 1.825" Washer(3) on the stud (on the bushing side). Install the 2 5/8" Washer(4) on the 1 7/8" Sleeve side. Install a 1/2" washer(5) and nut(6) on each end of the threaded rod. Use **Images 4 & 5** as a reference.

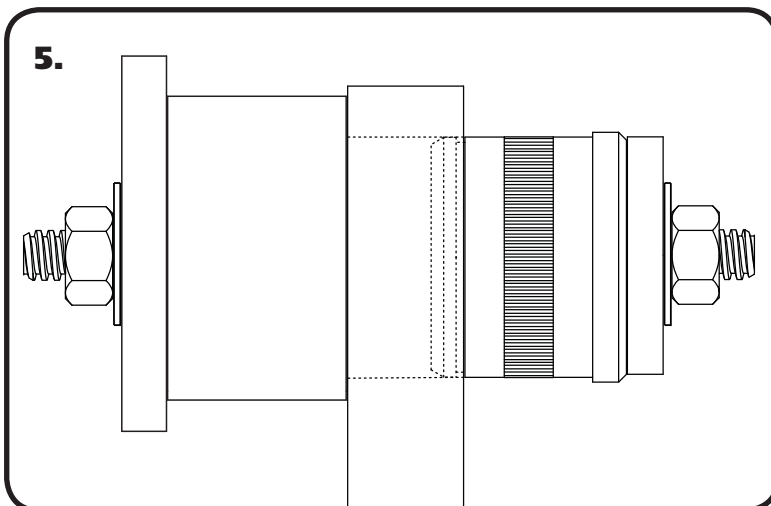

5. Snug down the nuts enough to hold the sleeve and washers in place. Check to make sure the sleeve is centered over the hole and the 1.825" washer is center on the bushing housing. Tighten the nuts to press the bushing housing into the axle housing. Tighten the nuts until the housing bottoms in the axle mount.



Bushing Housing Installation

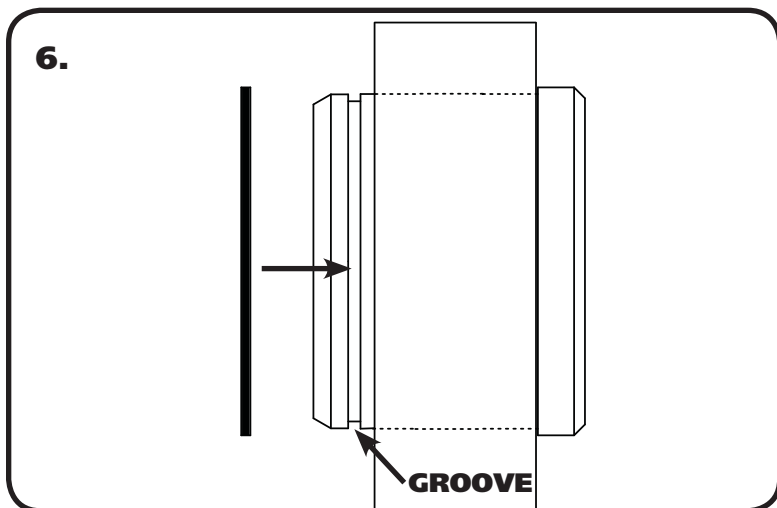

6. Install the supplied Snap Ring into the groove on the bushing housing.

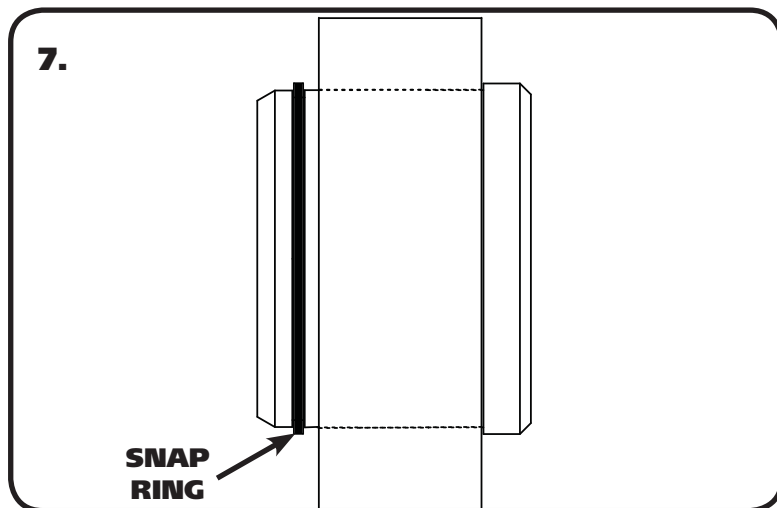

7. **Image 7** illustrates the bushing housing installed in the axle housing with the snap ring installed.

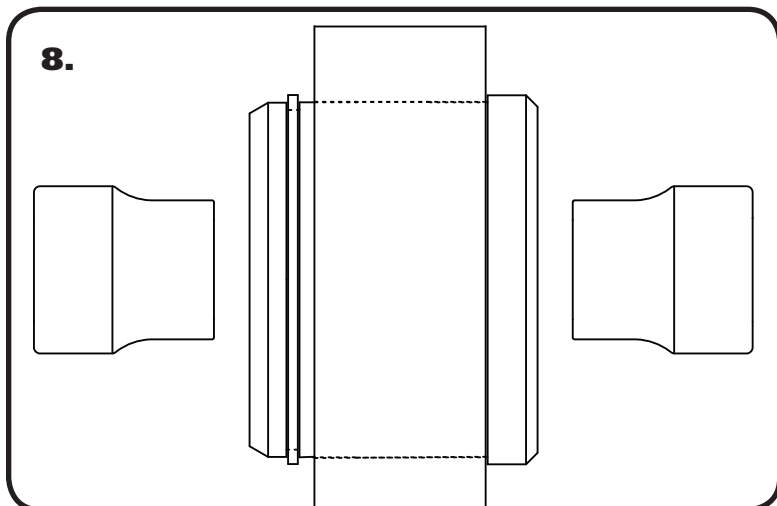

8. Install the Spacers by inserting the SMALL side of the SPACER into the Center Pivot Ball. Push them in until they bottom out and stop.

9. Install your Ridetech StrongArms. Refer to the instructions supplied with the StrongArms.