

For further instructions visit:
<https://www.holley.com/ultrapro/howto/>

ALWAYS use NEW olives when reusing a hose end.

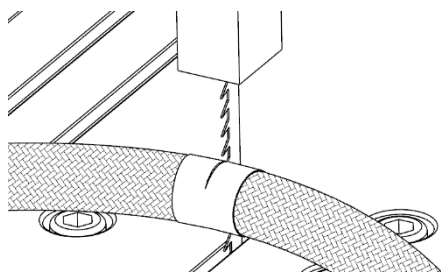

Stainless Steel Braid: To prevent excessive fraying, wrap duct tape tightly around the hose before cutting. Earl's recommends a professional model scalloped edge blade (D100ERL) or a band saw to perform the cut. Never use a hack saw or place convoluted hose in a vise to perform a cut.

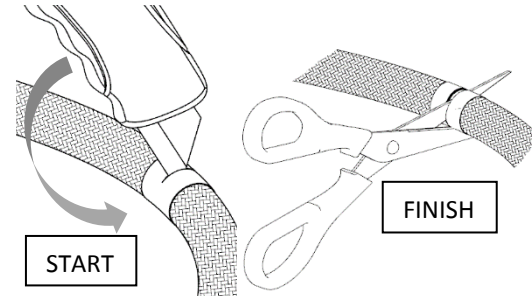

Polyester Braid: To prevent fraying, wrap PTFE thread tape tightly around the hose before cutting. Start cut with a sharp box cutter, once cut is about 90% complete **finish the cut with a pair of scissors.**

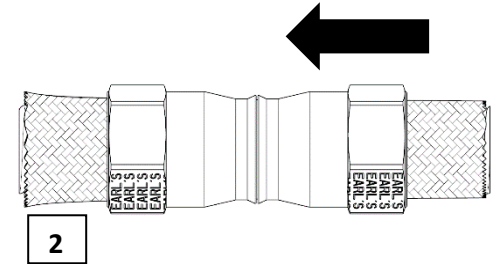

To properly funnel the braid, slide both sockets on back to back from the least frayed end.

199R11133

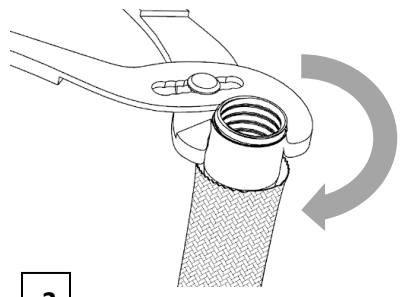

3 Gently pull back the braid to expose the inner liner of the hose, then thread the olive onto the hose until a minimum amount of is showing to make a clean cut. **Be careful not to crush the olive.**

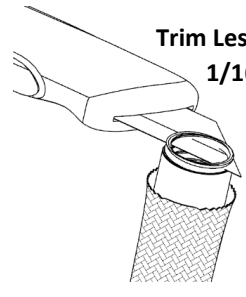

4 Trim the hose to be flush and square with the olive using a sharp blade. **Trim Less Than 1/16"**

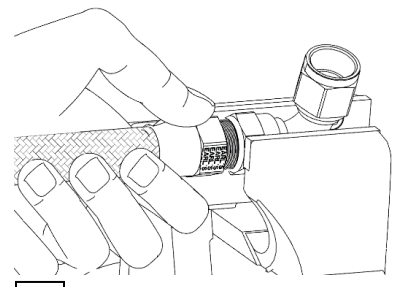

5 Place the fitting into a vise and apply a light coat of Earl's Assembly Lubricant™ onto the threads and nipple. Push the olive onto the nipple until it seats fully against the back of the nipple. Next pull the socket forward ensuring the braid does not protrude past the olive and into the threads. Finally, engage the threads and **screw together but only two or three threads.**

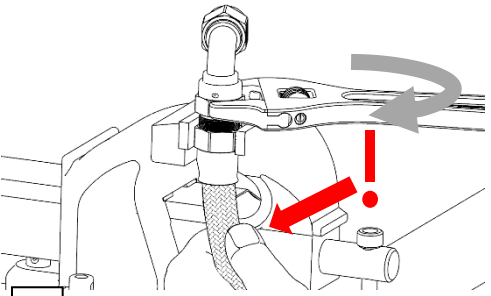

6 Reposition in vise being careful not to crush the socket. **While tightening the fitting, assure that the liner does not turn in the braid by lightly pinching the hose with your hand.**

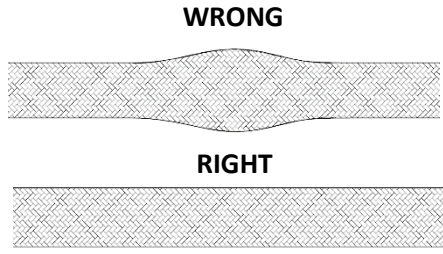

7 As you assemble the hose ends ensure that the braid is tight. Loose braids will cause the hose to fail prematurely.

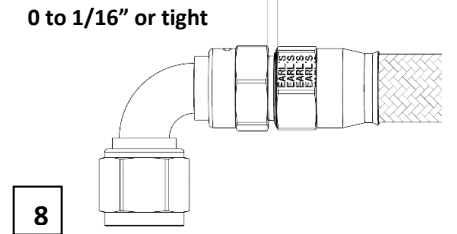

8 Pay careful attention to the torque being applied. When the seal is optimal you will feel the required torque suddenly increase. On metallic braid hoses this may occur before the socket-fitting gap is closed. This is acceptable.

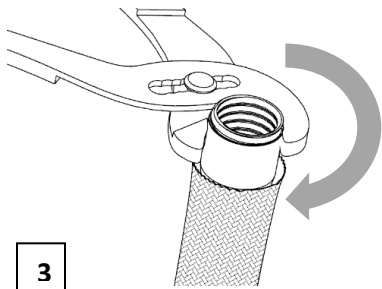

3

Gently pull back the braid to expose the inner liner of the hose, then thread the olive onto the hose until a minimum amount of is showing to make a clean cut. **Be careful not to crush the olive.**



4

Trim the hose to be flush and square with the olive using a sharp blade.

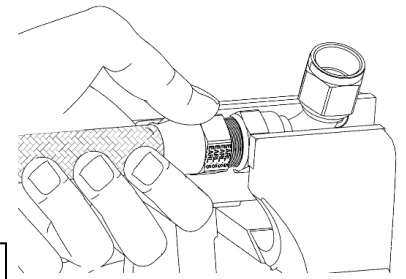

5

Place the fitting into a vise and apply a light coat of Earl's Assembly Lubricant™ onto the threads and nipple. Push the olive onto the nipple until it seats fully against the back of the nipple. Next pull the socket forward ensuring the braid does not protrude past the olive and into the threads. Finally, engage the threads and **screw together but only two or three threads.**

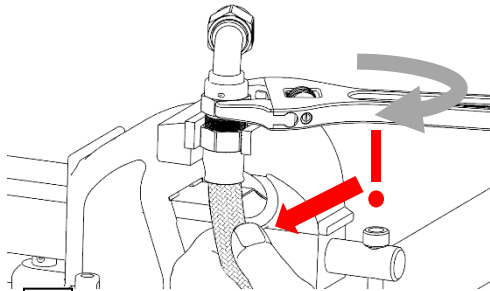

6

Reposition in vise being careful not to crush the socket. **While tightening the fitting, assure that the liner does not turn in the braid by lightly pinching the hose with your hand.**

WRONG

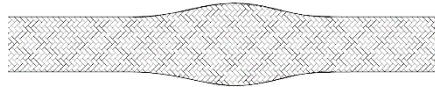

RIGHT



7

As you assemble the hose ends ensure that the braid is tight. Loose braids will cause the hose to fail prematurely.

0 to 1/16" or tight

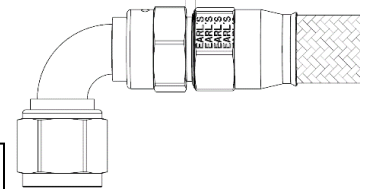

8

Pay careful attention to the torque being applied. When the seal is optimal you will feel the required torque suddenly increase. On metallic braid hoses this may occur before the socket-fitting gap is closed. This is acceptable.



ASSEMBLY INSTRUCTIONS FOR ULTRAPRO TWIST-ON HOSE ENDS

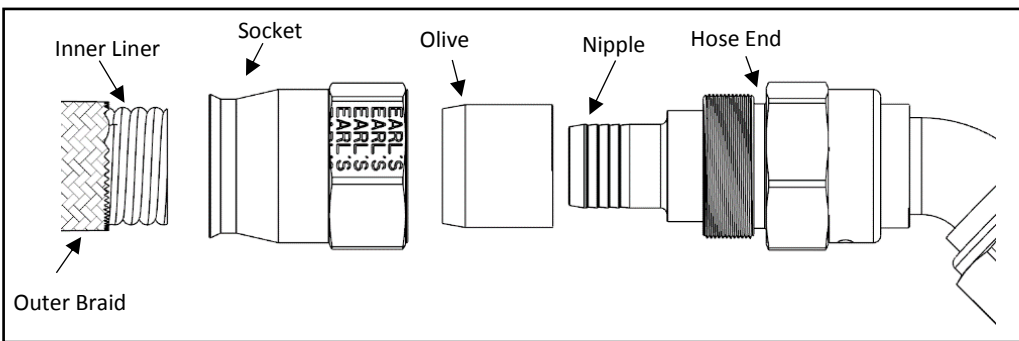

For further instructions visit:

<https://www.holley.com/ultrapro/howto/>

! ALWAYS use **NEW** olives when reusing a hose end. **!**

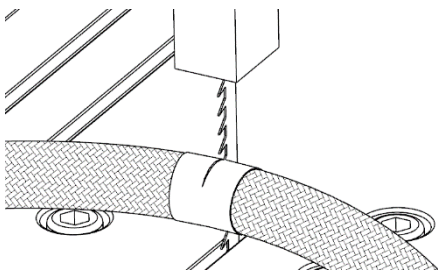

Stainless Steel Braid: To prevent excessive fraying, wrap duct tape tightly around the hose before cutting. Earl's recommends a professional model scalloped edge blade (D100ERL) or a band saw to perform the cut. Never use a hack saw or place convoluted hose in a vise to perform a cut.

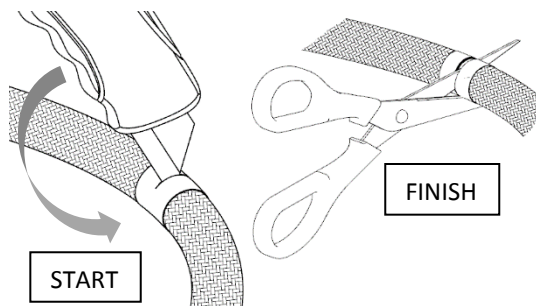

Polyester Braid: To prevent fraying, wrap PTFE thread tape tightly around the hose before cutting. Start cut with a sharp box cutter, once cut is about 90% complete **finish the cut with a pair of scissors.**

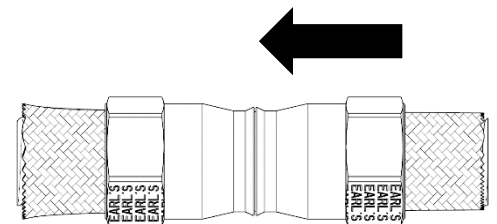

2

To properly funnel the braid, slide both sockets on back to back from the least frayed end.