

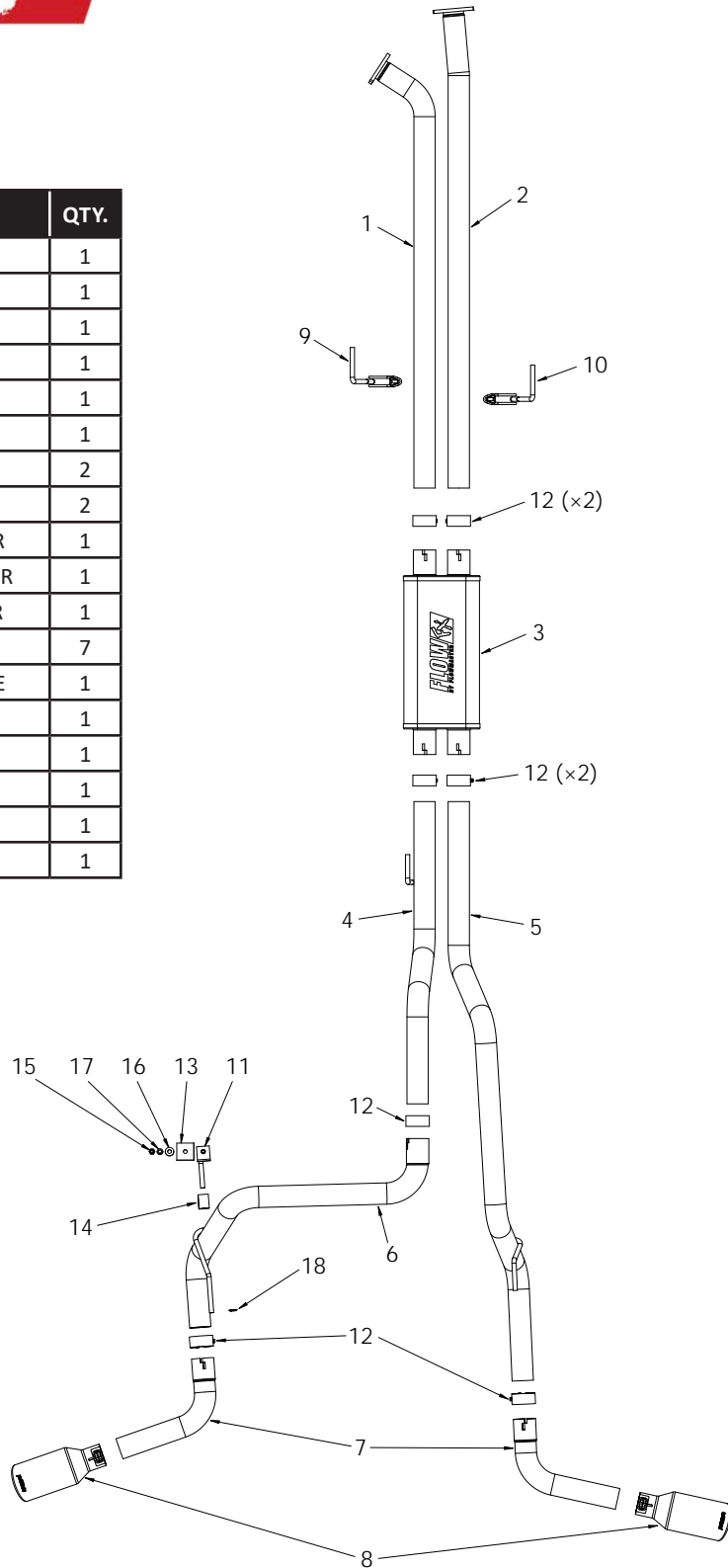

Installation Instructions
718106
 2007-2009 TOYOTA TUNDRA
 WITH 5.7L ENGINE

ITEM	PART NO.	DESCRIPTION	QTY.
1	86720M	LEFT INLET PIPE ASSY	1
2	86721M	RIGHT INLET PIPE ASSY	1
3	72468-Z	FLOWFX MUFFLER	1
4	86722M	LEFT OVER-AXLE PIPE	1
5	86723M	RIGHT OVER-AXLE PIPE	1
6	16544M	LEFT TAILPIPE	1
7	16547M	SIDE EXIT PIPE	2
8	ST507B	TIP, BLACK CERAMIC	2
9	352HA	LEFT INLET CLAMP HANGER	1
10	353HA	RIGHT INLET CLAMP HANGER	1
11	354HA	LEFT REAR FRAME HANGER	1
12	MC250BS	CLAMP, STAINLESS, 2-1/2"	7
13	HA566	BACKING PLATE, 2" SQUARE	1
14	HA168	HANGER, RED RUBBER	1
15	HW103	NUT, 3/8-16	1
16	HW303	FLAT WASHER, 3/8"	1
17	HW309	LOCK WASHER, 3/8"	1
18	HW503	HANGER KEEPER, 1/2"	1



NOTES

- Installation requires moderate mechanical skill. If this job is beyond your abilities, seek the services of a qualified technician.
- If you do not understand any part of these instructions, please call Flowmaster Technical Support at (866) 464-6553 for assistance.
- Use stands to support exhaust system components, both while removing the stock system, and during installation.
- Apply penetrating oil generously to clamps, pipes, and hanger rods to ease disassembly.

REVIEW THE INSTRUCTIONS & VERIFY THE KIT CONTENTS

Take a moment to read and understand these instructions before installing your Flowmaster FlowFX exhaust kit.

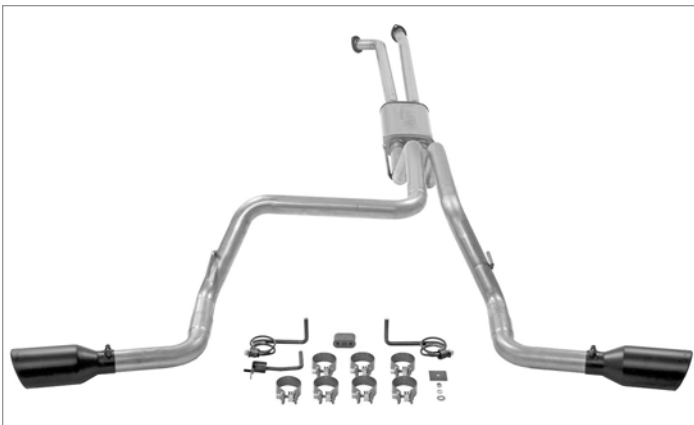

Use the parts drawing and list to verify your kit's contents. In the unlikely event that any parts are missing, please contact Flowmaster Technical Support for replacements.

REMOVE THE FACTORY EXHAUST SYSTEM

WARNINGS

- **AVOID BURNS!** Exhaust systems get extremely hot. Allow the vehicle to cool down fully before starting work.
- **AVOID SERIOUS INJURY OR DEATH BY CRUSHING!** Never work under a vehicle that is supported by jacks.

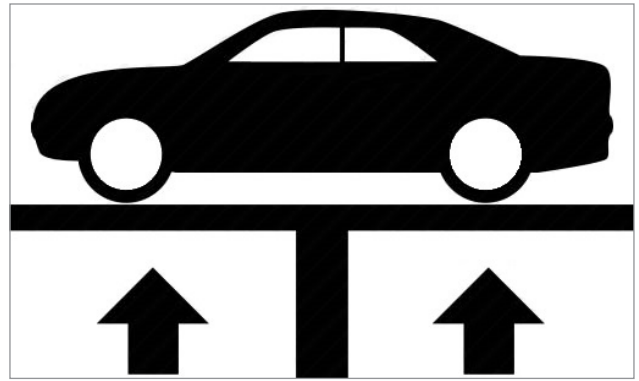

1. **Raise the vehicle** to working height on a lift. If you do not have a lift, securely support the vehicle on jack stands.

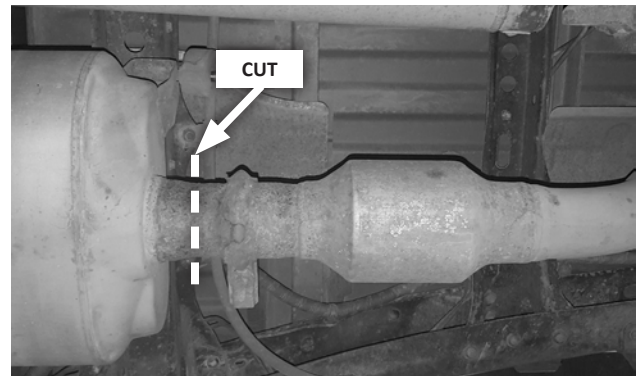

2. **Cut tailpipe at muffler exit.** Disassemble hanger wires from isolators and remove tailpipe section from vehicle.

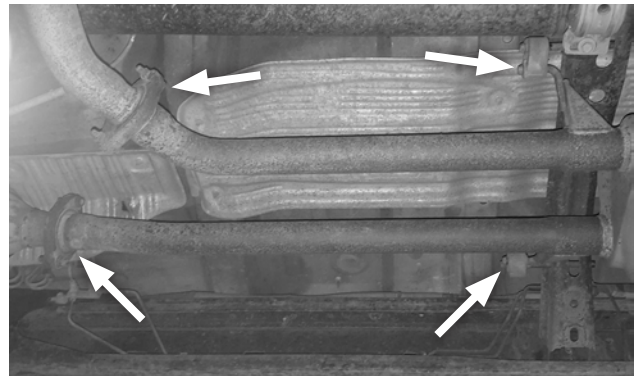

3. **Support muffler and disassemble wire hangers** from isolators. Remove and retain flange fasteners (apply heat as necessary), then remove muffler section from vehicle.

INSTALL YOUR FLOWMASTER EXHAUST SYSTEM



4. Remove the nuts from all of the clamps, apply anti-seize compound to the bolt threads, and re-install the nuts.

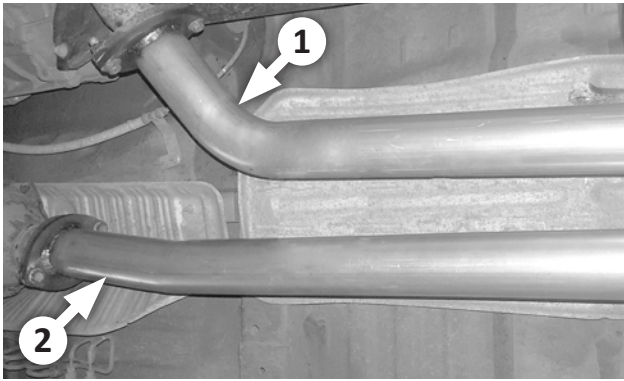

WHEEL BASE	MODIFICATION
165"	Use as received
146"	Cut 18-3/4" from both inlet pipes
127"	Cut 37-3/4" from both inlet pipes

5. If applicable to your truck's wheelbase, cut the inlet pipes back at the muffler-end. Then connect **left (1)** and **right (2)** inlet pipes to factory exhaust with the previously-removed flange fasteners, ensuring they are positioned properly.

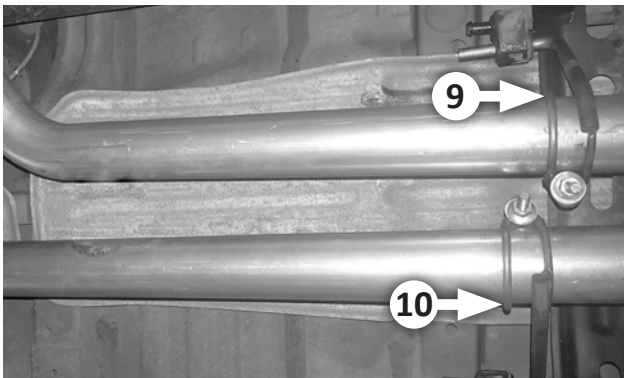

6. Place left (9) and right (10) inlet clamp hangers onto end of inlet pipes, then insert them in isolators as shown.

NOTE: Pipe-to-pipe slip-fit connections must seat **3" deep**, and pipe-to-muffler connections must seat **2" deep**. Mark the male ends of each pipe accordingly, to ensure proper insertion during assembly.

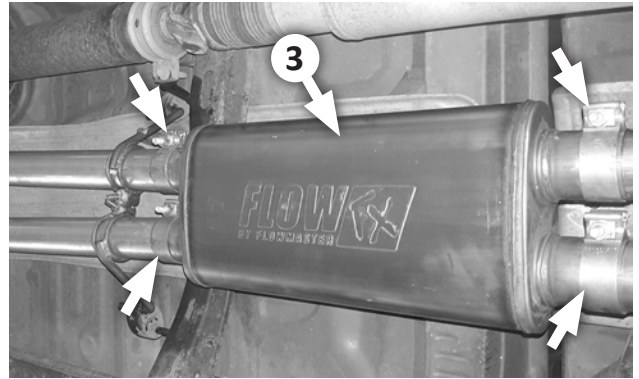

7. Place two clamps (12) onto muffler (3) then connect it to inlet pipes. Tighten clamps just enough to allow for adjustment then place **two clamps (12)** onto muffler outlets.

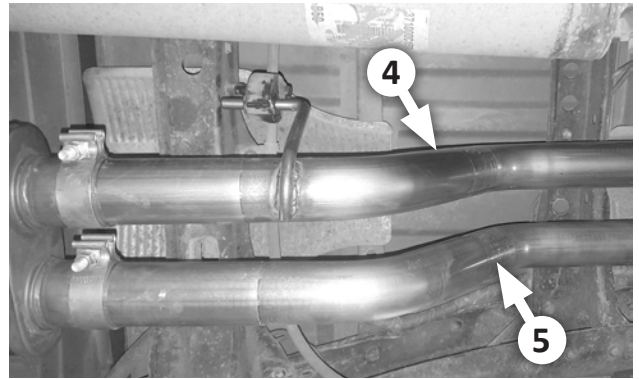

8. Route left (4) and right pipes (5) over axle, then connect them to muffler. Insert their wire hangers into isolators then tighten clamps just enough to allow for adjustment.

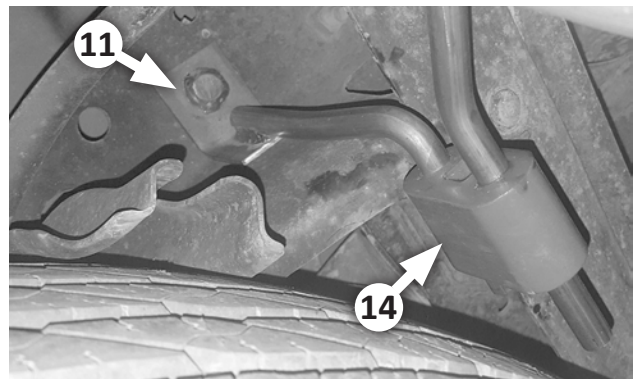

9. Fasten left rear frame hanger (11) on vehicle frame near spare tire (driver side) with bolt (on hanger), **backing plate (13)**, flat washer (16), lock washer (17) and nut (15). Install **rubber hanger (14)** on frame hanger rod.

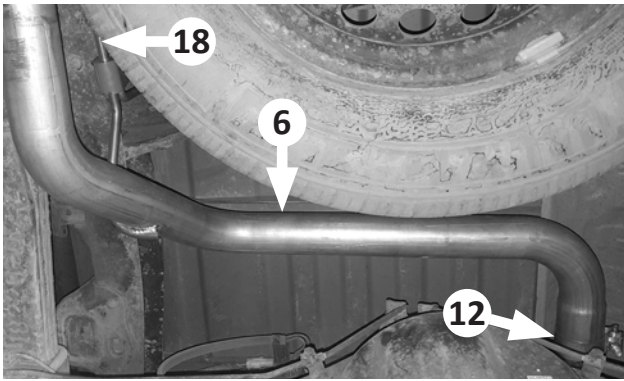

10. Place clamp (12) onto left tailpipe (6), then connect it to left over-axle pipe. Insert the pipe's hanger rod into rubber hanger then tighten clamp just enough to allow for later adjustment. Finally, slip hanger keeper (18) onto tailpipe hanger rod.

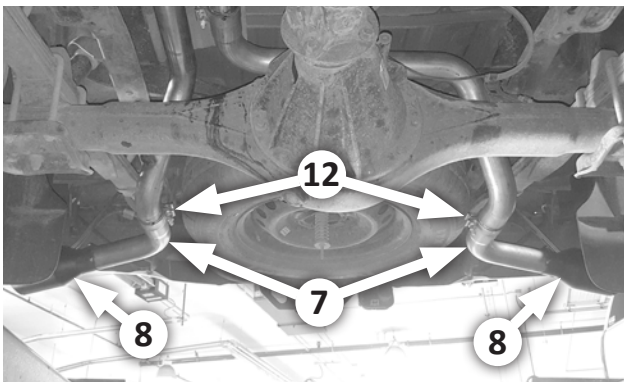

11. Place a clamp (12) onto each side exit pipe (7) (2 places). Connect the side exit pipes to the tailpipes, and tighten clamps just enough to allow for later adjustment. Place a tip (8) onto each side exit pipe, and tighten the tip clamps. Rotate exit pipes and tips to desired distance from body or bumper, so angled cuts on tips are positioned as desired.

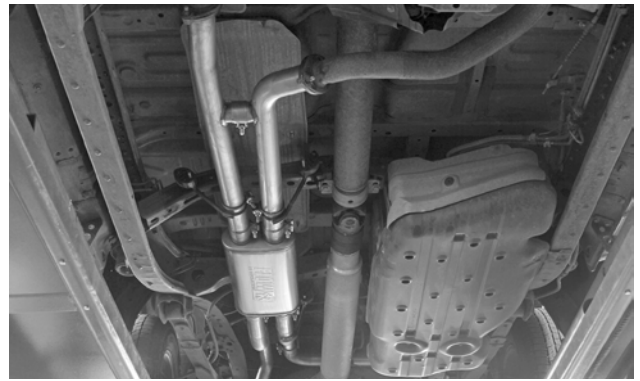

12. Adjust all components to obtain 1/2" to 3/4" clearance (a finger's width) around them, and to allow for suspension travel and vibration. When you are satisfied with the system's clearance and fit, tighten all seven clamps.

13. Recommended: Tack weld (approx. 1") the slip-fit connections for added security, then paint each weld with a coat of high-temp spray paint to protect against corrosion.



Congratulations, the installation of your Flowmaster FlowFX performance exhaust system is complete!

KEEP THESE INSTRUCTIONS FOR FUTURE REFERENCE

Flowmaster maintains a highly-trained technical service department to answer your technical questions, provide additional product information and offer various recommendations.



FLOWMASTER TECHNICAL SUPPORT: (866) 464-6553