

T-REX

Billet Grilles

55110

**07-08 CHEVY
SILVERADO**

55110

**07-08 CHEVY
SILVERADO**

UPPER CLASS SERIES BUMPER

Recommended Tools:

Phillips Screwdriver
Drill & 1/8" Drill Bit
Die Grinder or Jig-Saw (Optional)

Parts List / Hardware:

1 Upper Class Insert
6 #8 x 3/4 Phillips Screws
4 #8 Flat Nuts

Read and understand instructions before attempting installation



Step 1

Remove the license plate assembly from the vehicle. Test fit the grille into the bumper opening. The new grille has four mounting tabs welded to the back of the grille. Four screws will hold the grille to the air dam.

Center the grille; mark the mounting holes to the air dam. Use a 1/8" drill bit to drill a pilot hole at each mark. Re-center the grille. Use the #8 screws and flat nuts to secure the grille. If the license plate is to be re-installed, center the license plate and drill a 1/8" hole into the air dam (just above the mesh grille). Use the remaining #8 screws to secure the license plate.

Test fit the grille into the bumper opening. The grille has four tabs welded to the back; use the tabs as a guide to mark the holes onto the airdam. Drill four 3/16" holes at each mark. Re-center the grille. Insert a 1.5" screw into each tab; from behind the airdam, secure each screw using the #10 washers and lock nuts.

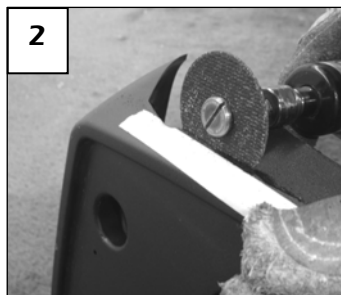
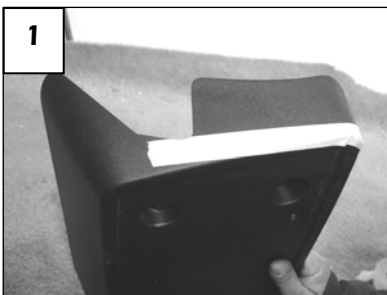

Step 2

The factory license plate mount can be modified to mount on the bumper billet. A portion of the license plate mount must be trimmed to re-install. As shown; apply a strip of masking tape to draw a line on each end (1). Use a die grinder to remove the excess material from the license plate mount (2). The last picture shows a profile view of the license mount after your cuts (3). Center the upper mounting holes on the plate mount to the factory holes in the air dam. Install the 2" machine screws and fender washers into the upper mounting holes; secure the screws from behind the air dam using the remaining #10 washers and nuts. ***Thank you for purchasing a T-Rex Billet Grille.***

1/25/07